

GENERAL NOTES:

- EXISTING CONDITIONS AND TOPOGRAPHICAL DATA OF THE SUBJECT PARCEL ARE COMPILED FROM A BOUNDARY SURVEY OF THE PROPERTY BY MELVIA A. GRAHAM, PLS AND A SUPPLEMENTAL TOPOGRAPHIC AND EXISTING CONDITIONS SURVEY BY TAYLOR LAND CONSULTANTS, PLLC. THE DATA SHOWN ON THIS DRAWING IS NOT THE RESULT OF A FIELD SURVEY BY SHIPMAN ENGINEERING, PLLC. ADDITIONAL EXISTING CONDITIONS DATA PROVIDED BY SUPPLEMENTAL DATA INCLUDING AERIAL PHOTOGRAPHY, HARNETT COUNTY GIS DATA, AND OTHER DATA SOURCES AS REQUIRED.
- REFER TO EROSION AND SEDIMENT CONTROL PLAN AND CONSTRUCTION SEQUENCE BEFORE PERFORMING ANY CLEARING, GRUBBING, OR DEMOLITION OPERATIONS.
- NO TITLE OPINION ON THIS PROPERTY HAS BEEN FURNISHED.
- AREAS COMPUTED BY THE COORDINATE METHOD.
- THE PROPERTY SHOWN HEREON IS SUBJECT TO ALL RIGHTS-OF-WAY, EASEMENTS, COVENANTS, AND RESTRICTIONS OF RECORD.
- ALL DISTANCES SHOWN ON THE SURVEY ARE HORIZONTAL GROUND DISTANCES.
- THE PROPERTY SHOWN IS LOCATED OUTSIDE OF ANY FLOOD HAZARD AREAS AS SHOWN ON FEMA FIRM 372060000J DATED OCTOBER 3, 2006.
- REFER TO SEALED TOPOGRAPHICAL SURVEY BY TAYLOR LAND CONSULTANTS, PLLC FOR HORIZONTAL AND VERTICAL DATUM INFORMATION AND OTHER SURVEY CONTROL DATA.
- ALL DIMENSIONS SHOWN ARE TO THE FACE OF CURB, UNLESS NOTED OTHERWISE.
- COORDINATE POWER, TELEPHONE, CABLE, AND OTHER UNDERGROUND UTILITY INSTALLATION WITH THE APPROPRIATE UTILITY PROVIDER AND HARNETT COUNTY AS NECESSARY.
- ALL PROPOSED SIGNAGE WILL COMPLY WITH THE HARNETT COUNTY UDD SIGN ORDINANCE.
- CONTRACTOR IS RESPONSIBLE FOR VERIFYING ALL GRADES PRIOR TO THE START OF CONSTRUCTION.
- MAXIMUM SIDEWALK CROSS SLOPE IS 2% (1/4 INCH PER FOOT).
- WETLANDS EXIST ON THE PARENT PARCEL BUT ARE NOT LOCATED WITHIN THE PROJECT AREA. A WETLAND DELINEATION WAS PERFORMED BY HAL OWEN AND ASSOCIATED ON 23 AUGUST, 2021.

ALL CONSTRUCTION SHALL BE IN ACCORDANCE WITH HARNETT COUNTY STANDARDS AND SPECIFICATIONS.

WETLAND NOTE:
WETLAND AREAS PROVIDED BY SCALED DRAWING FROM HAL OWEN AND ASSOCIATES AND SHOULD BE CONSIDERED APPROXIMATE IN NATURE. A SURVEY OF THE WETLAND FLAGS HAS NOT BEEN PERFORMED FOR THIS AREA. SHOULD FUTURE DEVELOPMENT OCCUR IN THE VICINITY OF THE EXISTING WETLAND, THE OWNER SHOULD ENGAGE A PROFESSIONAL LAND SURVEYOR TO LOCATE THE WETLAND TO AVOID IMPACTS. THE WETLAND IS SHOWN HEREON FOR REFERENCE ONLY.

ANIMAL WASTE NOTE:
ALL ANIMAL WASTE, EXCLUDING HOOF STOCK, IS PUT INTO AN ON-SITE DUMPSTER. HOOF STOCK WASTE IS COMPOSTED. SMALL PENS ARE LINED WITH PINE SHAVINGS AND CHANGED AS NEEDED. BEFORE CLEAN PINE SHAVINGS ARE LINED, THE USED SHAVINGS ARE TO BE REMOVED AND FLOOR MOPPED WITH 1:8 PARTS BLEACH AND AIR-DRIED.

SYMBOL	DATE	REVISIONS
1	09-06-22	PER HARNETT COUNTY COMMENT
2	09-30-22	PER INCDED COMMENT
3	10-16-22	PER DEMILE COMMENT
4	01-23-23	PER DEMILE COMMENT

SHIPMAN ENGINEERING
SHIPMAN ENGINEERING, PLLC
NCBELS LICENSE P-1963

SHIPMAN ENGINEERING
137 MIDDLEGREEN PLACE
HOLLY SPRINGS, NC 27540
919.500.0006

DESIGNED BY: WZS
DRAWN BY: WZS
CHECKED BY: WZS
DRAWING DATE: 12/19/21
SE PROJECT #: 2021-020

CAROLINA WILDLIFE CONSERVATION PARK
UPPER LITTLE RIVER TOWNSHIP
HARNETT COUNTY, NORTH CAROLINA
OVERALL SITE MAP & SHEET INDEX

SHEET NUMBER: **C-02**

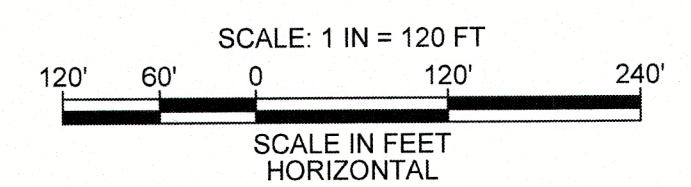
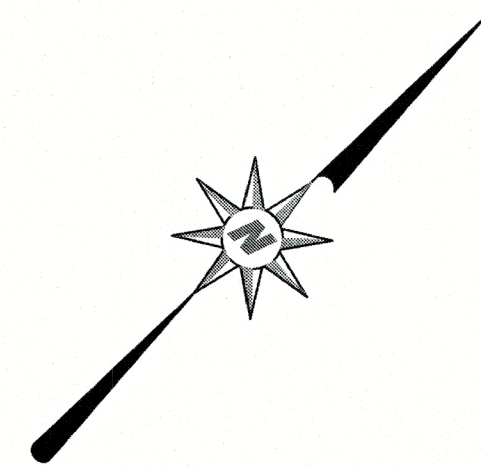
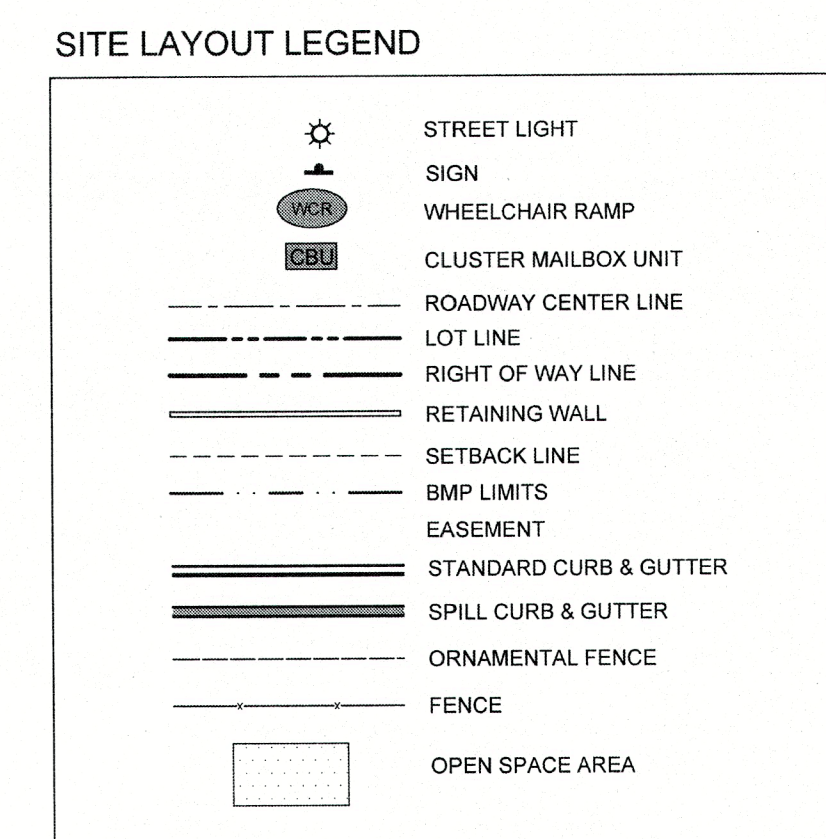
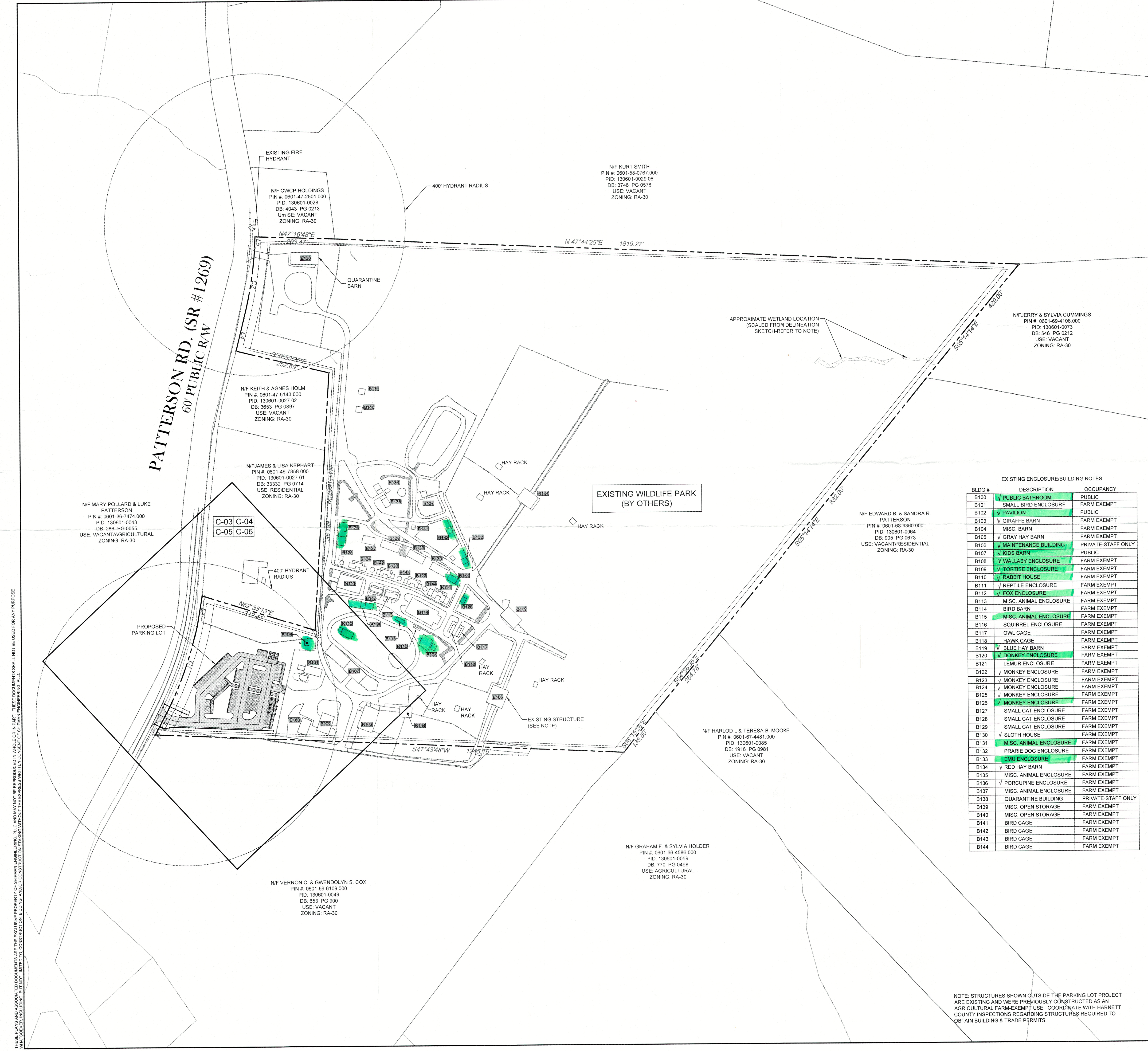

NOTE: STRUCTURES SHOWN OUTSIDE THE PARKING LOT PROJECT ARE EXISTING AND WERE PREVIOUSLY CONSTRUCTED AS AN AGRICULTURAL FARM-EXEMPT USE. COORDINATE WITH HARNETT COUNTY INSPECTIONS REGARDING STRUCTURES REQUIRED TO OBTAIN BUILDING & TRADE PERMITS.

THESE PLANS AND ASSOCIATED DOCUMENTS ARE THE EXCLUSIVE PROPERTY OF SHIPMAN ENGINEERING, PLLC AND MAY NOT BE REPRODUCED OR TRANSMITTED IN ANY FORM OR BY ANY MEANS, ELECTRONIC OR MECHANICAL, INCLUDING PHOTOCOPYING, RECORDING, OR BY ANY INFORMATION STORAGE AND RETRIEVAL SYSTEM, WITHOUT THE EXPRESS WRITTEN CONSENT OF SHIPMAN ENGINEERING, PLLC.