

IMPROVEMENT PERMIT

011510

Be it ordained by the Harnett County Board of Health as follows: Section III, Item B. "No Person shall begin construction of any building at which a septic tank system is to be used for disposal of sewage without first obtaining a written permit from the Harnett County Health Department."

Name: (owner) LA Scottie Johnson
Property Location: SR# NC 27
New Installation, Septic Tank, Repairs, Nitrification Line

Subdivision Longleaf AC Lot # 41

Tax ID # Quadrant #

Number of Bedrooms Proposed: 3 (28x64) Lot Size: .86 AC

Basement with Plumbing: Garage:

Water Supply: Well, Public, Community

Distance From Well: 50 ft.

Following is the minimum specifications for sewage disposal system on above captioned property. Subject to final approval.

Type of system: Conventional, Other ultra-shallow

Size of tank: Septic Tank: 1000 gallons Pump Tank: Must Bring in 8x12" of approved cover

Subsurface Drainage Field: No. of ditches 3 exact length of each ditch 120 ft. width of ditches 3 ft. depth of ditches 12 in.

French Drain Required: Linear feet

Date: 8-1-2000

This permit is subject to revocation if site plans or intended use change.

Signed: J. W. [Signature] Environmental Health Specialist

235

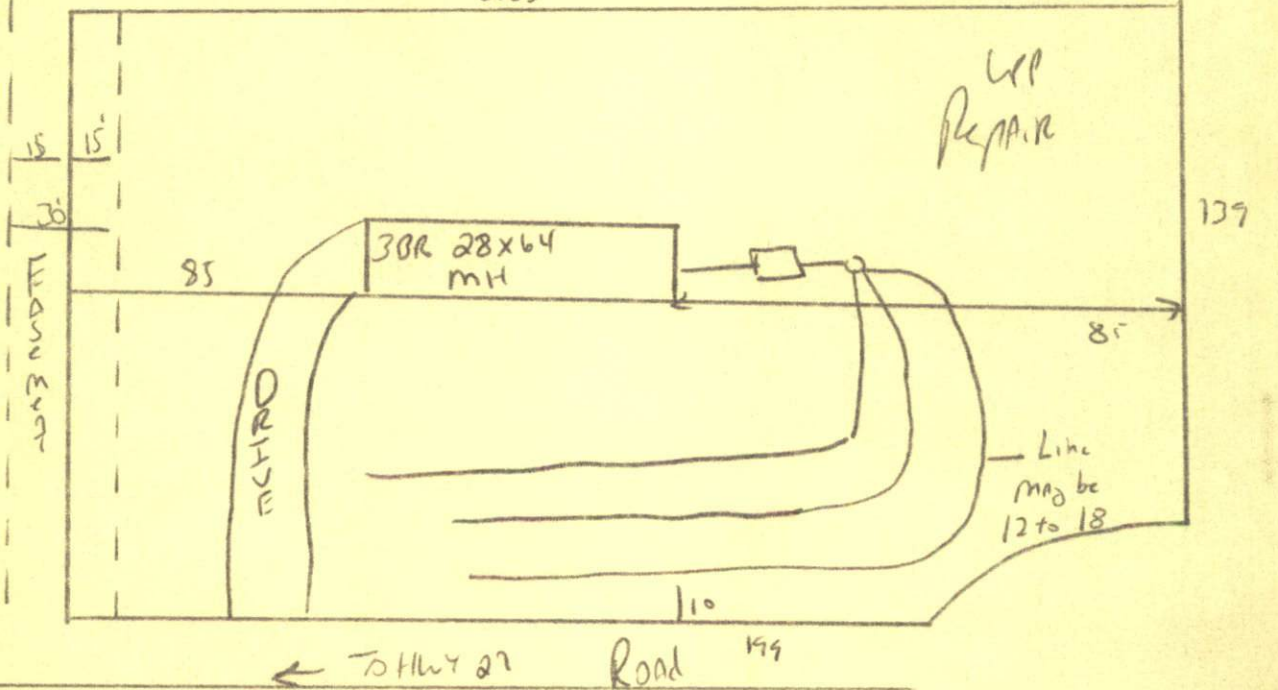

Meet onsite MAINTAIN ALL SETBACKS

Do NOT DRIVE OR PARK ON Septic system

HARNETT COUNTY HEALTH DEPARTMENT  
AUTHORIZATION TO CONSTRUCT

17353

Authorization is hereby given to construct a wastewater system to the specifications described by Harnett County Health Department Improvement Permit # 17353. This authorization shall be valid for a period not to exceed five (5) years from the date of issuance. This authorization will be invalid if ownership, site plans, or intended use change.

Owner or Authorized Agent La Scott Johnson

Name: \_\_\_\_\_ Telephone # 919-542-6828

Address: \_\_\_\_\_

Property Location: SR # M 27 Road Name \_\_\_\_\_

New Installation  Repair \_\_\_\_\_ Septic Tank  Nitrification Lines

Subdivision Longleaf AC Lot # 41

Number of Bedrooms Proposed: 3 (28x64) Lot size: .86 AC

Basement \_\_\_\_\_ With Plumbing \_\_\_\_\_ Without Plumbing \_\_\_\_\_

Water Supply: Well \_\_\_\_\_ Public  Minimum Well Setback: \_\_\_\_\_ ft.

Type of System: Conventional  Other \_\_\_\_\_

Tank Volume: Septic Tank 1000 gallons Pump Chamber \_\_\_\_\_ gallons

**Nitrification Field Specifications**

Number of fields 1 Number of Lines per Field 3 Length of lines 120

Width of ditches 3 ft. Depth of ditches 12 max inches

French Drain: Linear feet required \_\_\_\_\_ Depth of gravel \_\_\_\_\_

No wastewater system shall be covered or placed into use by any person until an inspection by the Harnett County Health Department has determined that the system has been installed according to the conditions of the improvement permit and that a valid operations permit has been issued.

Authorized Agent for Harnett County Health Department

Name: [Signature] Date: 8-1-200