

IMPROVEMENT PERMIT

Be it ordained by the Harnett County Board of Health as follows: Section III, Item B. "No Person shall begin construction of any building at which a septic tank system is to be used for disposal of sewage without first obtaining a written permit from the Harnett County Health Department."

Name: (owner) Sherry Avent

New Installation

Septic Tank

Property Location: SR# 1419 Aveny Spence

Repairs

Nitrification Line

Subdivision _____ Lot # _____

Tax ID # _____ Quadrant # _____

Number of Bedrooms Proposed: 3 Lot Size: 1 acre

Basement with Plumbing: Garage:

Water Supply: Well Public Community

Distance From Well: 50' ft.

Following is the minimum specifications for sewage disposal system on above captioned property. Subject to final approval.

Type of system: Conventional Other _____

Size of tank: Septic Tank: 1000 gallons Pump Tank: _____ gallons

Subsurface Drainage Field No. of ditches 3 exact length of each ditch 100 ft. width of ditches 3 ft. depth of ditches 18-22 in.

French Drain Required: _____ Linear feet

Date: 6-8-00

This permit is subject to revocation if site plans or intended use change.

Signed: James E. Manhart R.S.
Environmental Health Specialist

**Maintain all setbacks*

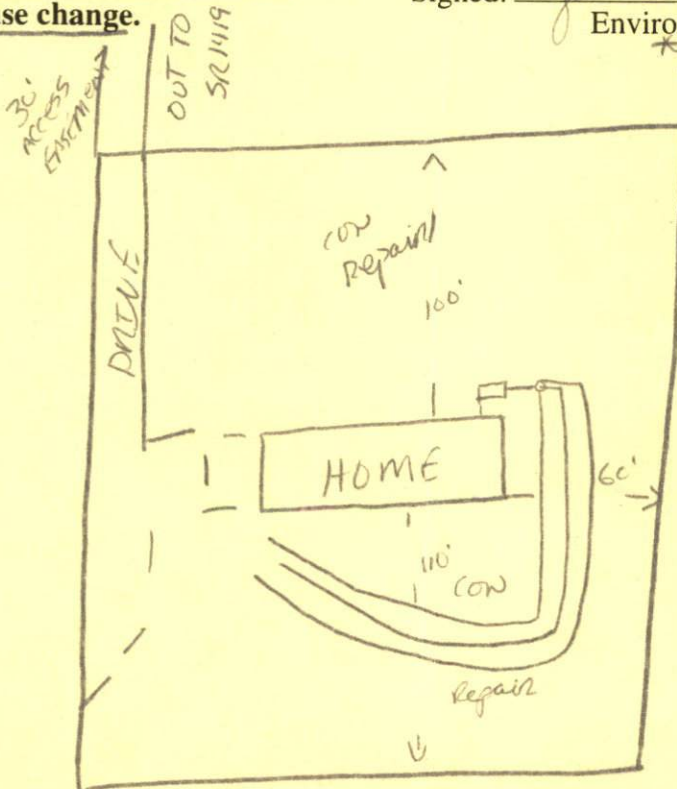

** FINAL Septic Layout May Change from what is pictured.*

