

OPERATIONS PERMIT

Name: (owner) Jimmy + Doree Lee ☒ New Installation ☒ Septic Tank
Property Location: SR# 1722 Three Bridge ROAD ☐ Repairs ☒ Nitrification Line
Subdivision - Lot # -
TAX ID# - Quadrant # -
Contractor: Harold Chappell Registration # -
Basement with Plumbing: ☐ Garage: ☐
Water Supply: ☐ Well ☒ Public ☐ Community
Distance From Well: 50' ft.

Following are the specifications for the sewage disposal system on above captioned property.

Type of system: ☒ Conventional ☐ Other -
Size of tank: Septic Tank: 1000 gallons Pump Tank: - gallons
Subsurface No. of exact length width of depth of
Drainage Field ditches 3 of each ditch 80 ft. ditches 3 ft. ditches 18-22 in.
French Drain: - Linear feet

Date: 6-7-00

PERMIT NO. 17145

Inspected by: James E. Marshall ⁴⁸
Environmental Health Specialist

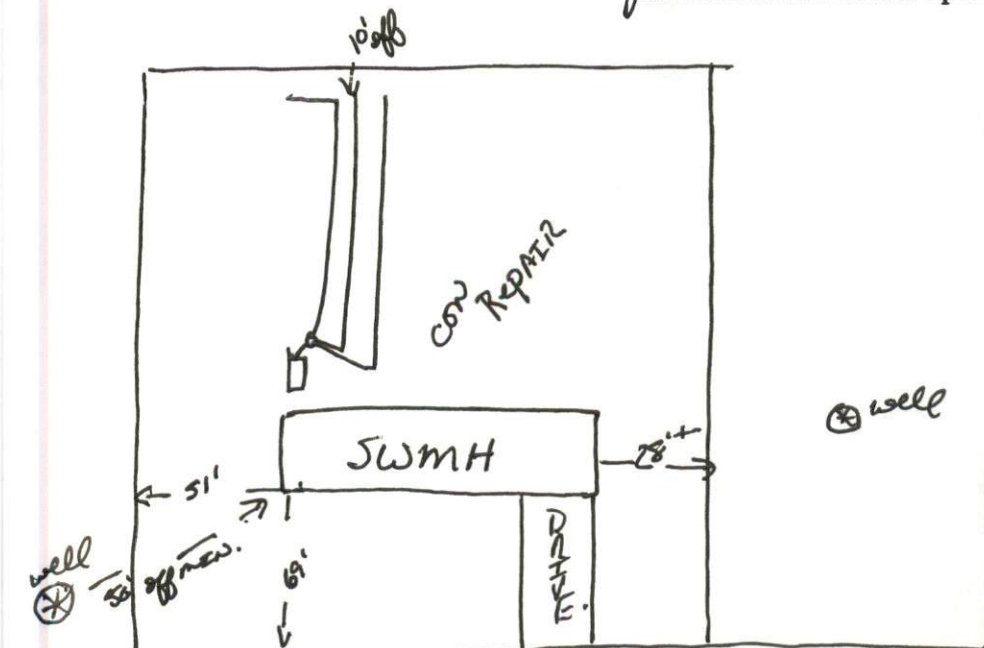

SR1722 THREE BRIDGE