

Initial Application Date: 5-17-2000

Application #00- 40000511

NETT LAND USE APPLICATION

#188 - 6/13/00

Planning Department 102 E. Front Street, Lillington, NC 27546

Phone: (910) 893-7525 Fax: (910) 893-2793

LANDOWNER: Associated Developers, LLC Address: 2543 Ravenhill Dr., P.O. Box 87066
City: Fayetteville, State: NC Zip: 28304 Phone #: 910-485-8865

APPLICANT: Same Address: _____
City: _____ State: _____ Zip: _____ Phone #: _____

PROPERTY LOCATION: SR #: Hwy 87 SR Name: Hwy 87
Parcel: 09-9566-02-0011-95 PIN: 9594-38-1586
Zoning: N/A Subdivision: Starwood at Overhills Lot #: 95 Lot Size: .35AC
Flood Plain: X Panel: 150 Watershed: N/A Deed Book/Page: 1208/0064 Plat Book/Page: F-706-D

DIRECTIONS TO THE PROPERTY FROM LILLINGTON: Hwy 210 South, take Nursery Rd. to Hwy 87,
T/R onto Hwy 87, approx 2 miles to Starwood, T/R into Starwood.

PROPOSED USE:
 Sg. Family Dwelling (Size 35x66) # of Bedrooms 3 Basement — Garage (excluded) 24x28 Deck —
 Multi-Family Dwelling No. Units _____ No. Bedrooms/Unit _____
 Manufactured Home (Size x) # of Bedrooms _____ Garage _____ Deck _____
Comments: _____

Number of persons per household Spec
 Business Sq. Ft. Retail Space _____ Type _____
 Industry Sq. Ft. _____ Type _____
 Home Occupation (Size x) # Rooms _____ Use _____
 Accessory Building (Size x) Use _____
 Addition to Existing Building (Size x) Use _____
 Other _____

Water Supply: County Well (No. dwellings _____) Other _____
Sewer: Septic Tank/ Existing: YES NO County Other _____
Erosion & Sedimentation Control Plan Required? YES NO _____
Structures on this tract of land: Single family dwellings 1 Manufactured homes — Other (specify) _____

Property owner of this tract of land own land that contains a manufactured home w/in five hundred feet (500') of tract listed above? YES NO

Required Property Line Setbacks:	Minimum	Actual	Minimum	Actual
Front	<u>35</u>	<u>35</u>	Rear	<u>75</u>
Side	<u>10</u>	<u>25</u>	Corner	<u>25</u>
Nearest Building	<u>10</u>	<u>—</u>		

Permits are granted I agree to conform to all ordinances and the laws of the State of North Carolina regulating such work and the specifications or plans submitted. I hereby swear that the foregoing statements are accurate and correct to the best of my knowledge.

[Signature]
Signature of Applicant

17 May 2000
Date

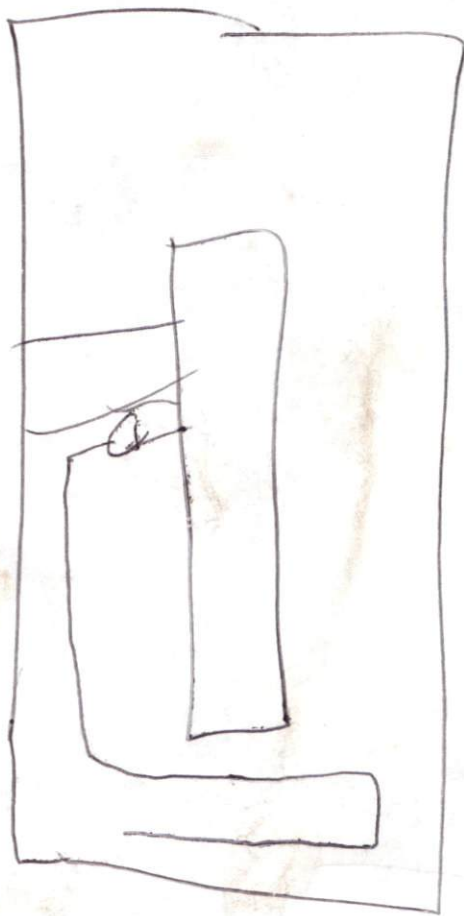

1x180
18-24