

00-400044

# OPERATIONS PERMIT

Name: (owner) Gene Smith

New Installation  Septic Tank

Property Location: SR# 2045

Repairs  Nitrification Line

7685  
Elliott Bridge  
Road

Subdivision Tradewinds

Lot # 16

TAX ID# \_\_\_\_\_

Quadrant # \_\_\_\_\_

Contractor: OTIS Strickland

Registration # \_\_\_\_\_

Basement with Plumbing:  Garage:

Water Supply:  Well  Public  Community

Distance From Well: 50 ft.

Following are the specifications for the sewage disposal system on above captioned property.

Type of system:  Conventional  Other \_\_\_\_\_

Size of tank: Septic Tank: \_\_\_\_\_ gallons Pump Tank: \_\_\_\_\_ gallons

Subsurface Drainage Field: No. of ditches 1 exact length 350 width of 3 depth of 18 ft. of each ditch \_\_\_\_\_ ft. ditches \_\_\_\_\_ ft. ditches \_\_\_\_\_ in.

French Drain: \_\_\_\_\_ Linear feet

PERMIT NO. 16594

Date: 22 May 2000

Inspected by: Vincent R. [Signature]  
Environmental Health Specialist

\* Old tank pumped, crushed and backfilled.

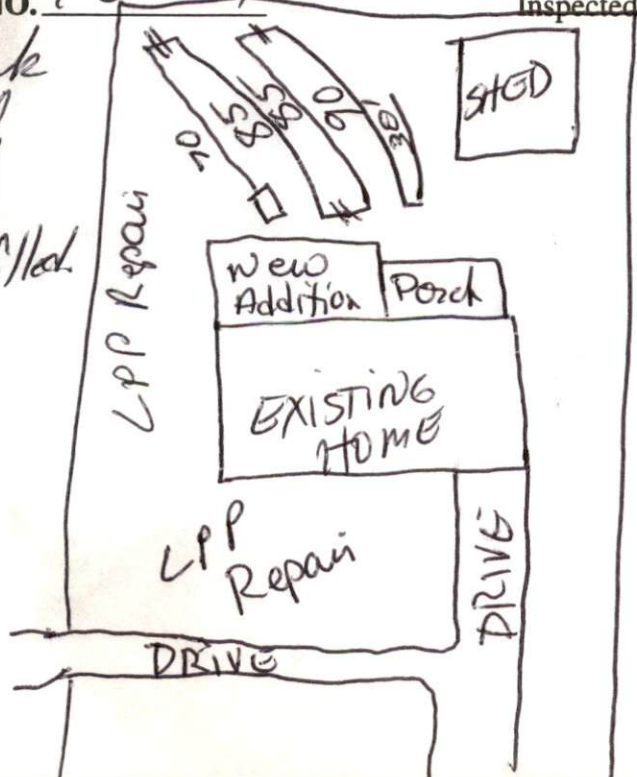

\* System installed for the construction of new room.  
 \* Foundation must be Steel from Septic tank.  
 Tank Info: BT-1000  
STB-103  
 Polylok Filter.