

00-40000 356

HARNETT COUNTY HEALTH DEPARTMENT

No 17780

IMPROVEMENT PERMIT

Be it ordained by the Harnett County Board of Health as follows: Section III, Item B. "No Person shall begin construction of any building at which a septic tank system is to be used for disposal of sewage without first obtaining a written permit from the Harnett County Health Department."

Name: (owner) Marcile Barajas

New Installation Septic Tank

Property Location: SR# 1461 Jasmine St.

Repairs Nitrification Line

Subdivision Captain's Landing Lot # 9M

Tax ID # _____ Quadrant # _____

Number of Bedrooms Proposed: 3 Lot Size: 100' x 200'

Basement with Plumbing: Garage:

Water Supply: Well Public Community

Distance From Well: 50 min ft.

Following is the minimum specifications for sewage disposal system on above captioned property. Subject to final approval.

Type of system: Conventional Other Polyethylene Aggregate Trench System Iwwb-95-7R

Size of tank: Septic Tank: 1000 gallons Pump Tank: _____ gallons

Subsurface Drainage Field No. of ditches 3 exact length of each ditch 80 ft. width of ditches 3 ft. depth of ditches 18 in. MAX

French Drain Required: _____ Linear feet

Date: 5/10/2000

This permit is subject to revocation if site plans or intended use change.

Signed: Bryan McJannet R.S.
Environmental Health Specialist

- * Maintain setbacks
- * Run lines on contour
- * Ditches to be NO DEEPER Than 18 inches

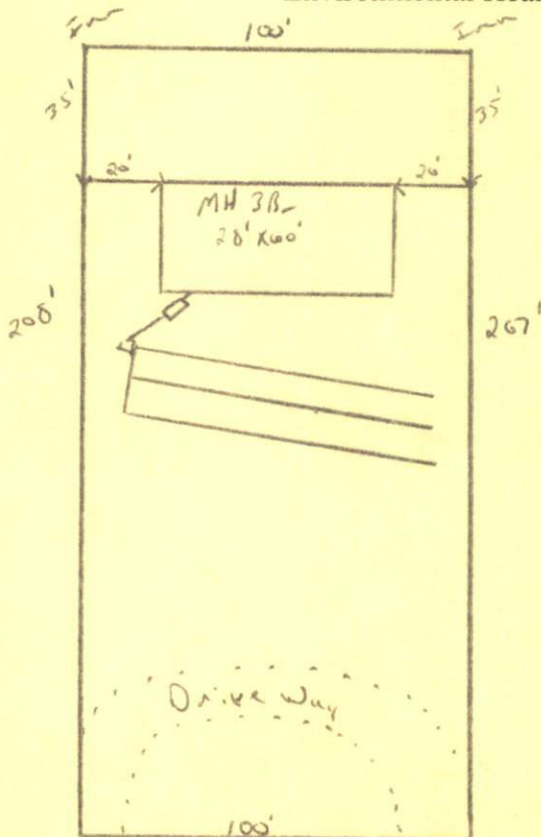

Rd.

HARNETT COUNTY HEALTH DEPARTMENT
AUTHORIZATION TO CONSTRUCT

Authorization is hereby given to construct a wastewater system to the specifications described by Harnett County Health Department Improvement Permit # 17780. This authorization shall be valid for a period not to exceed five (5) years from the date of issuance. This authorization will be invalid if ownership, site plans, or intended use change.

Owner or Authorized Agent _____

Name: Marcia Barajas Telephone # 919-557-8161
557-0749

Address: P.O. Box 183 Kipling, N.C. 27546

Property Location: SR # 1461 Road Name Jasmine St.

New Installation Repair Septic Tank Nitrification Lines

Subdivision Captain's Landing Lot # 9M

Number of Bedrooms Proposed: 3 Lot size: 100 x 200'

Basement With Plumbing Without Plumbing

Water Supply: Well Public Minimum Well Setback: 50 ft.

Type of System: Conventional Other Polystyrene Aggregate Trench System I WWS-45-3R

Tank Volume: Septic Tank 1000 gallons Pump Chamber _____ gallons

Nitrification Field Specifications

Number of fields 1 Number of Lines per Field 3 Length of lines 80 ft.

Width of ditches 3 ft. Depth of ditches 18 inches MAX

French Drain: Linear feet required _____ Depth of gravel _____

No wastewater system shall be covered or placed into use by any person until an inspection by the Harnett County Health Department has determined that the system has been installed according to the conditions of the improvement permit and that a valid operations permit has been issued.

Authorized Agent for Harnett County Health Department

Name: Bryan McJannet L.S. Date: 5/10/2000

(Revised 2/96)CNSTRCT.WPD