

IMPROVEMENT PERMIT

011347

Be it ordained by the Harnett County Board of Health as follows: Section III, Item B. "No Person shall begin construction of any building at which a septic tank system is to be used for disposal of sewage without first obtaining a written permit from the Harnett County Health Department."

Name: (owner) TROY Willett
Property Location: SR# 1279
New Installation
Septic Tank
Repairs
Nitrification Line

Subdivision Willett Acres Lot # 5(B)

Tax ID # Quadrant #

Number of Bedrooms Proposed: 3 (14x80) Lot Size: 1.93Ac

Basement with Plumbing: Garage:

Water Supply: Well Public Community

Distance From Well: 55 ft.

Following is the minimum specifications for sewage disposal system on above captioned property. Subject to final approval.

Type of system: Conventional Other

Size of tank: Septic Tank: 1000 gallons Pump Tank: gallons

Subsurface Drainage Field No. of ditches: 3 exact length of each ditch: 100 ft. width of ditches: 3 ft. depth of ditches: 18 in.

French Drain Required: Linear feet

Date: 4-18-2000

This permit is subject to revocation if site plans or intended use change.

Signed: [Signature] Environmental Health Specialist

VOID AFTER 5 YEARS

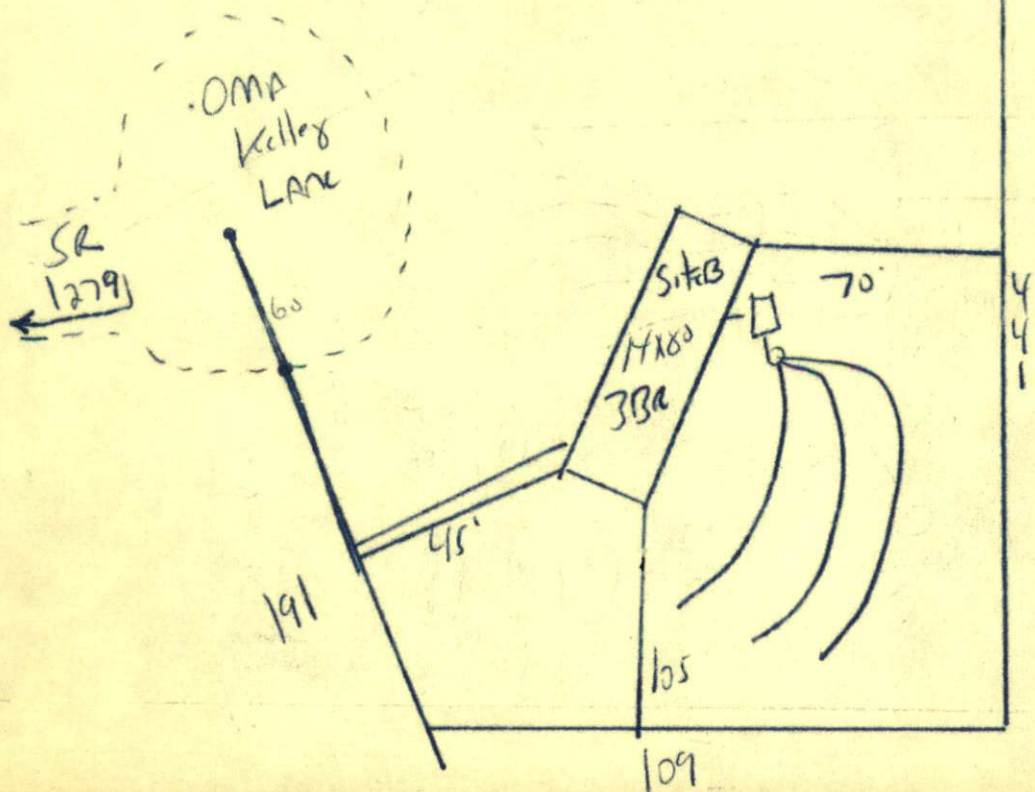

Meet on site for final layout MAINTAIN All set Back

HARNETT COUNTY HEALTH DEPARTMENT
AUTHORIZATION TO CONSTRUCT

Authorization is hereby given to construct a wastewater system to the specifications described by Harnett County Health Department Improvement Permit # 11439. This authorization shall be valid for a period not to exceed five (5) years from the date of issuance. This authorization will be invalid if ownership, site plans, or intended use change.

Owner or Authorized Agent Tray Willett

Name: _____ Telephone # 258-6098

Address: _____

Property Location: SR # 1279 Road Name _____

New Installation Repair _____ Septic Tank Nitrification Lines

Subdivision Willett Acres Lot # 5(B)

Number of Bedrooms Proposed: 3(14x80) Lot size: 1.93 AC

Basement _____ With Plumbing _____ Without Plumbing _____

Water Supply: Well _____ Public Minimum Well Setback: _____ ft.

Type of System: Conventional Other _____

Tank Volume: Septic Tank 1000 gallons Pump Chamber _____ gallons

Nitrification Field Specifications

Number of fields 1 Number of Lines per Field 3 Length of lines 60

Width of ditches 3 ft. Depth of ditches 18 inches

French Drain: Linear feet required _____ Depth of gravel _____

No wastewater system shall be covered or placed into use by any person until an inspection by the Harnett County Health Department has determined that the system has been installed according to the conditions of the improvement permit and that a valid operations permit has been issued.

Authorized Agent for Harnett County Health Department

Name: [Signature] Date: 4-18-2000