

APPLICANT NAME \_\_\_\_\_

DATE \_\_\_\_\_

FACTORS		PROFILES								
		1	2	3	4	5	6	7	8	9
LANDSCAPE POSITION	.1940									
SLOPE (%)	.1940									
HORIZON 1 DEPTH		0-6	0-12	0-12	0-12	0-8	0-8			
Texture Group	.1941(A)(1)	exp	LS	Muck	Muck	SL	SL			
Consistence	.1941			Black	Black					
Structure	.1941(A)(2)									
Mineralogy	.1941(A)(3)									
HORIZON 2 DEPTH		12-17	12-18	12-18	8-21	8-21				
Texture Group	.1941(A)(1)	CL	CL	CL	CL	CL				
Consistence	.1941	exp	exp	exp	exp	exp				
Structure	.1941(A)(2)									
Mineralogy	.1941(A)(3)									
HORIZON 3 DEPTH										
Texture Group	.1941(A)(1)									
Consistence	.1941									
Structure	.1941(A)(2)									
Mineralogy	.1941(A)(3)									
HORIZON 4 DEPTH										
Texture Group	.1941(A)(1)									
Consistence	.1941									
Structure	.1941(A)(2)									
Mineralogy	.1941(A)(3)									
SOIL WETNESS	.1942	0-6	12	0-12	0-12	8	8			
RESTRICTIVE HORIZON	.1944									
SAPROLITE	.1943/1956									
CLASSIFICATION	.1948									
LONG TERM ACCEPTANCE RATE	.1955	U	U	U	U	U	U			

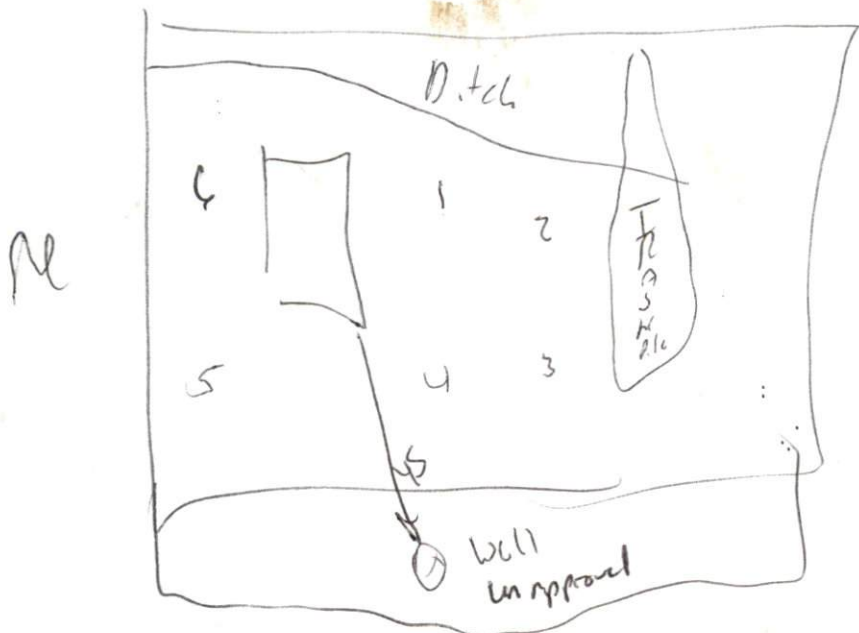

# Southeastern So. & Environmental Associates, Inc.

P.O. Box 9321  
Fayetteville, NC 28311-7696  
Phone/Fax (910) 822-4540

Elsie McCormick  
SR 1229

*[Handwritten signature]*

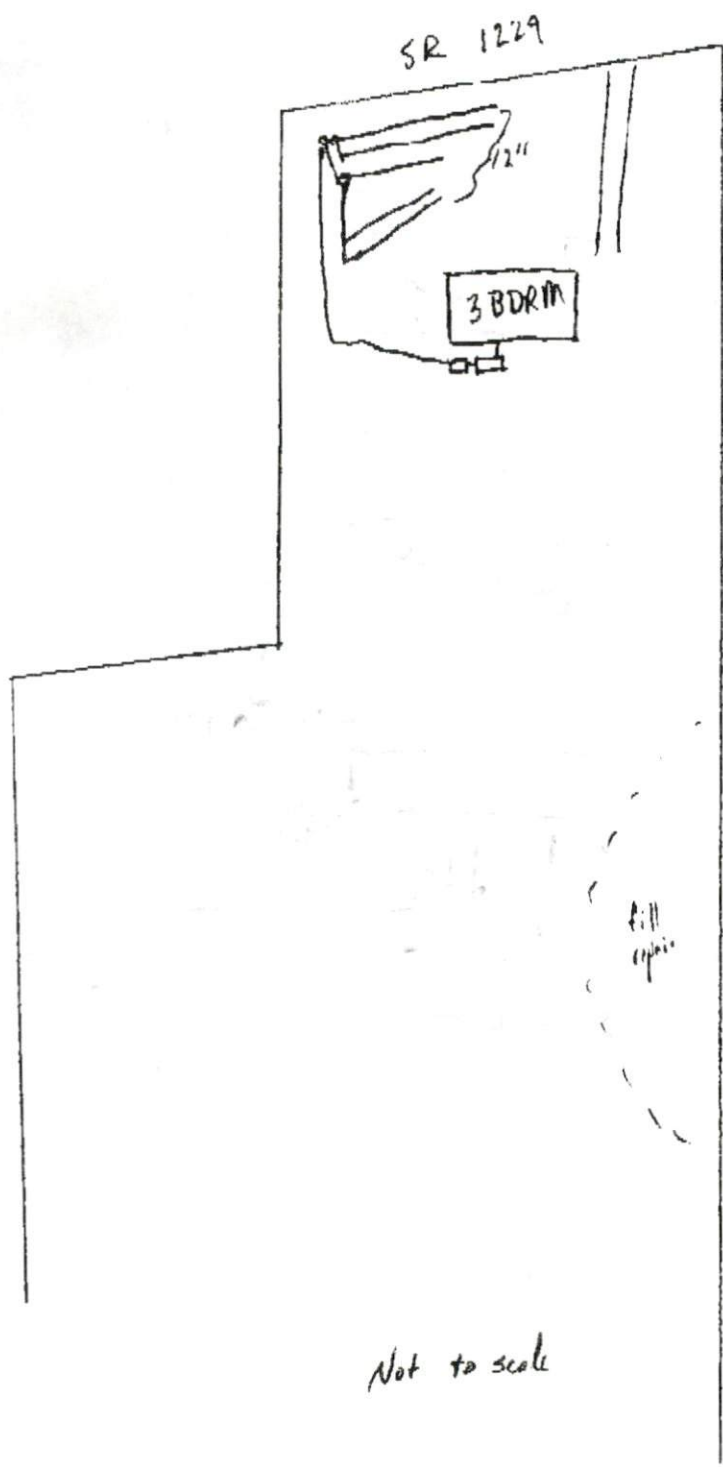

Pump to Polystyrene Aggregate

3 D-Boxes 2 x 90

Pump to 1st D-Box to split flow

2nd D-Box to ~~2 x 75'~~ 2 x 75'

3rd D-Box + ~~3 x 50'~~ 3 x 60

Ditches from 12" - 18" 12"

160  
5  
110  
15  
10

2x40 } EEE  
3x40 }

