

IMPROVEMENT PERMIT

40000126

Be it ordained by the Harnett County Board of Health as follows: Section III, Item B. "No Person shall begin construction of any building at which a septic tank system is to be used for disposal of sewage without first obtaining a written permit from the Harnett County Health Department."

Name: (owner) Cumberland Homes - Danny Morris

New Installation  Septic Tank

Property Location: SR# 1115

Repairs  Nitrification Line

Subdivision Peach Tree Lot # 44

Tax ID # \_\_\_\_\_ Quadrant # \_\_\_\_\_

Number of Bedrooms Proposed: 3 (33x48) Lot Size: .612 AC

Basement with Plumbing:  Garage:  Must meet on site

Water Supply:  Well  Public  Community Must use filter & make it

Distance From Well: 50 ft. 5/22/00

Following is the minimum specifications for sewage disposal system on above captioned property. Subject to final approval.

Type of system:  Conventional  Other \_\_\_\_\_

Size of tank: Septic Tank: 1000 gallons Pump Tank: \_\_\_\_\_ gallons

Subsurface Drainage Field No. of ditches 1 exact length of each ditch 180 ft. width of ditches 3 ft. depth of ditches 18-24 in. 5/2/00

French Drain Required: \_\_\_\_\_ Linear feet

This permit is subject to revocation if site plans or intended use change.

Revision Date: 02-24-2000

Signed: [Signature] Environmental Health Specialist

*Meconsk  
STUB out Plumbing  
Shallow  
Maintain All set Backs*

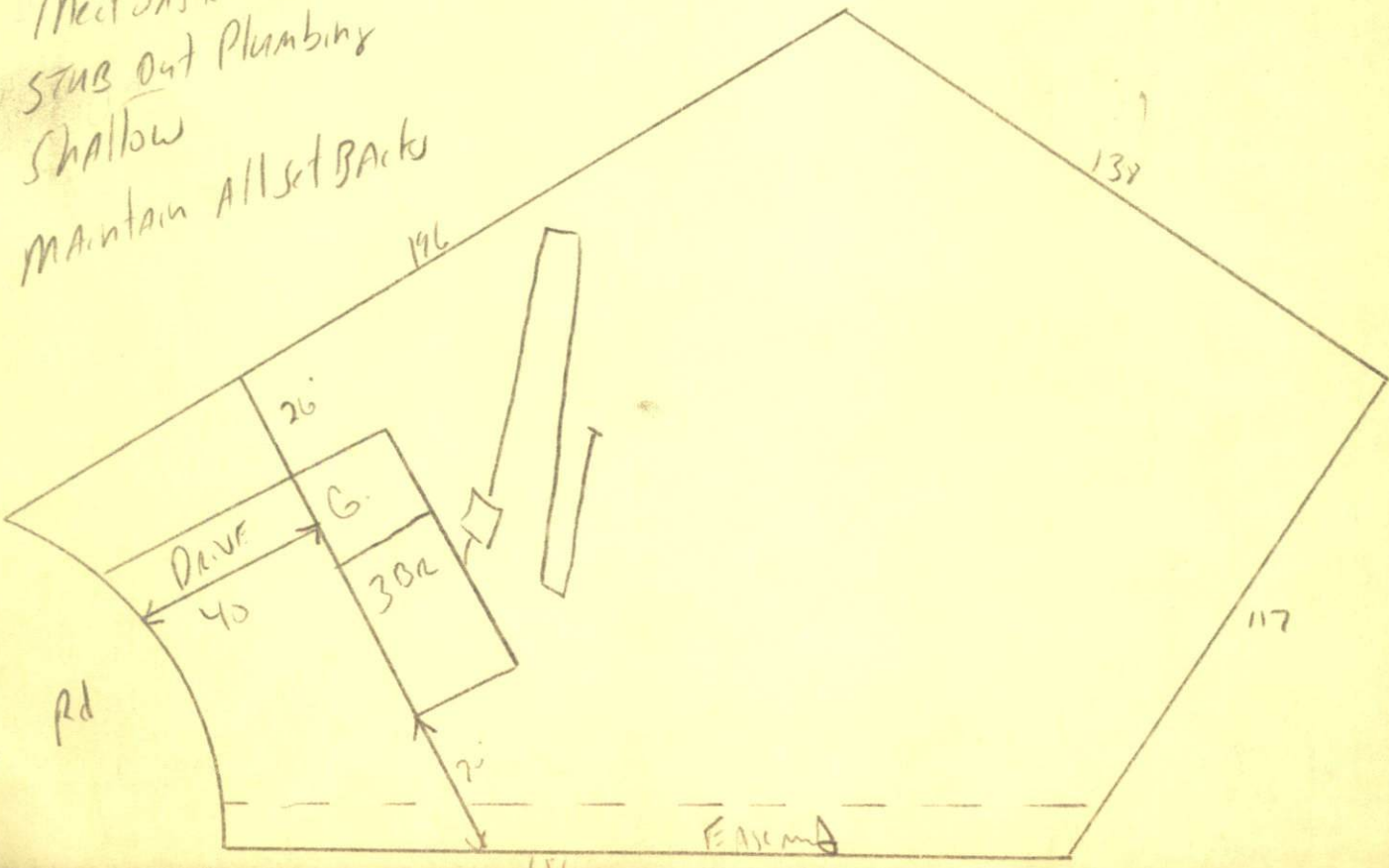

HARNETT COUNTY HEALTH DEPARTMENT  
AUTHORIZATION TO CONSTRUCT

Authorization is hereby given to construct a wastewater system to the specifications described by Harnett County Health Department Improvement Permit # 17204. This authorization shall be valid for a period not to exceed five (5) years from the date of issuance. This authorization will be invalid if ownership, site plans, or intended use change.

Owner or Authorized Agent Cumberland Homes - Danny Nieves

Name: \_\_\_\_\_ Telephone # 892-4345

Address: \_\_\_\_\_

Property Location: SR # 1115 Road Name \_\_\_\_\_

New Installation  Repair \_\_\_\_\_ Septic Tank  Nitrification Lines

Subdivision Peach Tree Lot # 44

Number of Bedrooms Proposed: 3 Lot size: 0.612 AC

Basement \_\_\_\_\_ With Plumbing \_\_\_\_\_ Without Plumbing \_\_\_\_\_

Water Supply: Well \_\_\_\_\_ Public  Minimum Well Setback: \_\_\_\_\_ ft.

Type of System: Conventional  Other \_\_\_\_\_

Tank Volume: Septic Tank 1000 gallons Pump Chamber \_\_\_\_\_ gallons

Nitrification Field Specifications

Number of fields 1 Number of Lines per Field 1 Length of lines 180

Width of ditches 3 ft. Depth of ditches 18 inches

French Drain: Linear feet required \_\_\_\_\_ Depth of gravel \_\_\_\_\_

No wastewater system shall be covered or placed into use by any person until an inspection by the Harnett County Health Department has determined that the system has been installed according to the conditions of the improvement permit and that a valid operations permit has been issued.

Authorized Agent for Harnett County Health Department

Name: [Signature] Date: 2-24-2000