

Southeastern Soil & Environmental Associates, Inc.

P.O. Box 9321
 Fayetteville, NC 28311-7696
 Phone/Fax (910) 822-4540

LONGLEAF Lot 15
 1.09 ACRES
 365 Pine Needles Drive

Required Property Line Setbacks

	Minimum	Actual
Front	<u>35</u>	<u>225</u>
Side	<u>10</u>	<u>40</u>
Corner	<u>—</u>	<u>—</u>
Rear	<u>25</u>	<u>05</u>
Nearest Building	<u>10</u>	<u>—</u>

SITE PLAN APPROVAL

DISTRICT N/A USE SNM/H
 #BEDROOMS 3
1-28-2000 D. Johnson
 Date Zoning Administrator

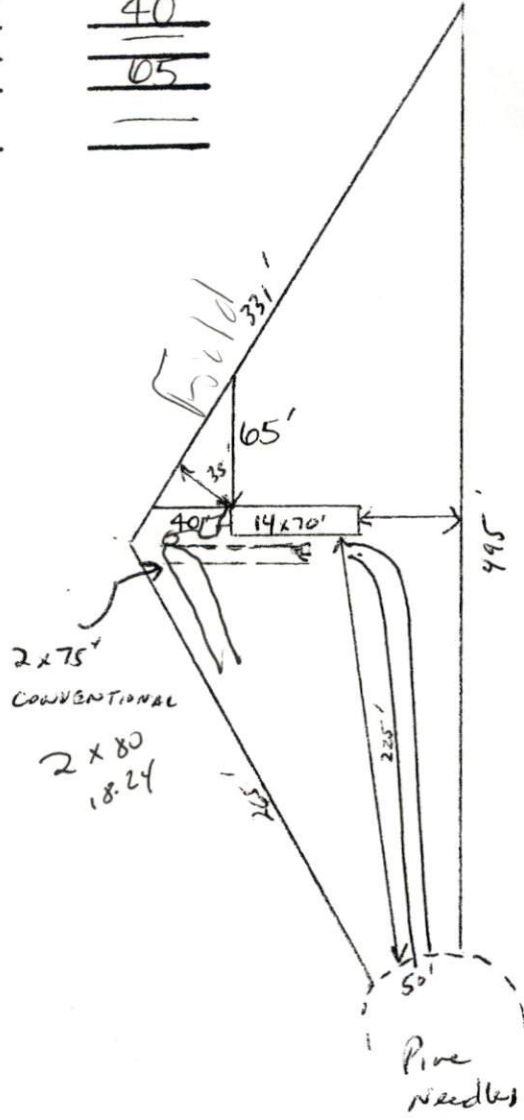

1" = 100'

Southeastern Soil & Environmental Associates, Inc.

P.O. Box 9321
 Fayetteville, NC 28311-7696
 Phone/Fax (910) 822-4540

LONGLEAF Lot 15

1.09 ACRES

365 Pine Needles Drive

Required Property Line Setbacks

	Minimum	Actual
Front	35	225
Side	10	40
Corner		
Rear	25	65
Nearest Building	10	

SITE PLAN APPROVAL

DISTRICT N/A USE SMUH

#BEDROOMS 3

1-28-2000 D. Johnson

Date Zoning Administrator

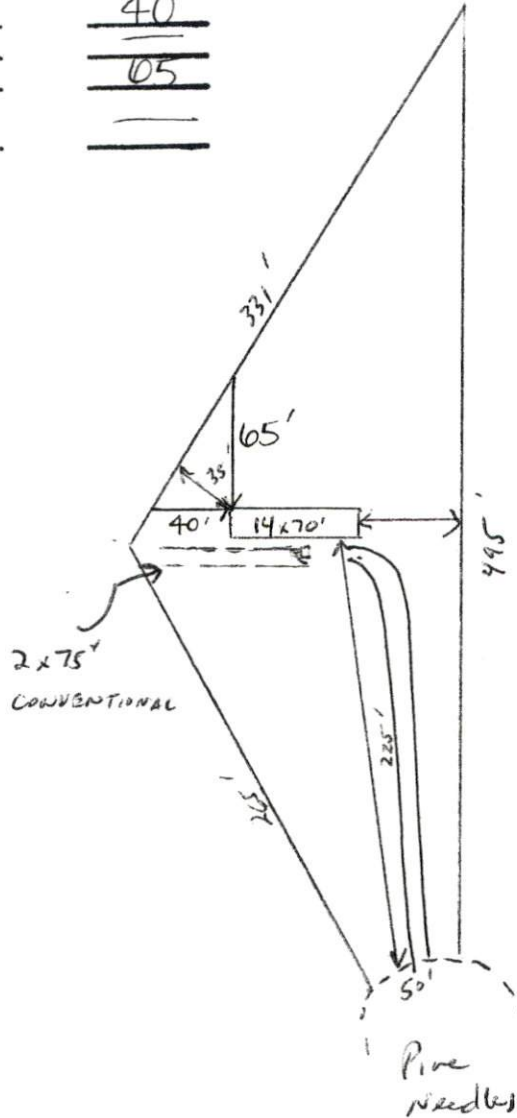

1" = 100'

Harnett County
102 EAST FRO ST
P O BOX 65
LILLINGTON NC 27546

DATE: 2/04/00
TIME: 14:44:45

RECEIPT #: 0000000606
CASHIER: AMCNEIL

APPLICATION NBR: 00-40000073
REFERENCE: 9553

ITEM DESCRIPTION	PAID
-----	-----
SEPTIC TANK APPL - NEW	100.00
TOTAL AMOUNT PAID:	100.00
PAYMENT TYPE: CHECK	
CHECK NBR: 000001059	

