

IMPROVEMENT PERMIT

40000035

Be it ordained by the Harnett County Board of Health as follows: Section III, Item B. "No Person shall begin construction of any building at which a septic tank system is to be used for disposal of sewage without first obtaining a written permit from the Harnett County Health Department."

Name: (owner) Timothy Wicker / Clyde Patterson New Installation Septic Tank
Property Location: SR# 1202 Repairs Nitrification Line

Subdivision TJP-II Lot # 13

Tax ID # _____ Quadrant # _____

Number of Bedrooms Proposed: 3 (28x44) Lot Size: 4.41 ac

Basement with Plumbing: Garage: NOTE change in house location must meet on site
Water Supply: Well Public Community
Distance From Well: 50 ft.

Following is the minimum specifications for sewage disposal system on above captioned property. Subject to final approval.

Type of system: Conventional Other _____
Size of tank: Septic Tank: 4000 gallons Pump Tank: _____ gallons
Subsurface Drainage Field: No. of ditches 4 exact length of each ditch 75 ft. width of ditches 3 ft. depth of ditches 18 in. MAX
French Drain Required: _____ Linear feet

Date: 6-1-2000
Signed: [Signature]
Environmental Health Specialist

This permit is subject to revocation if site plans or intended use change.

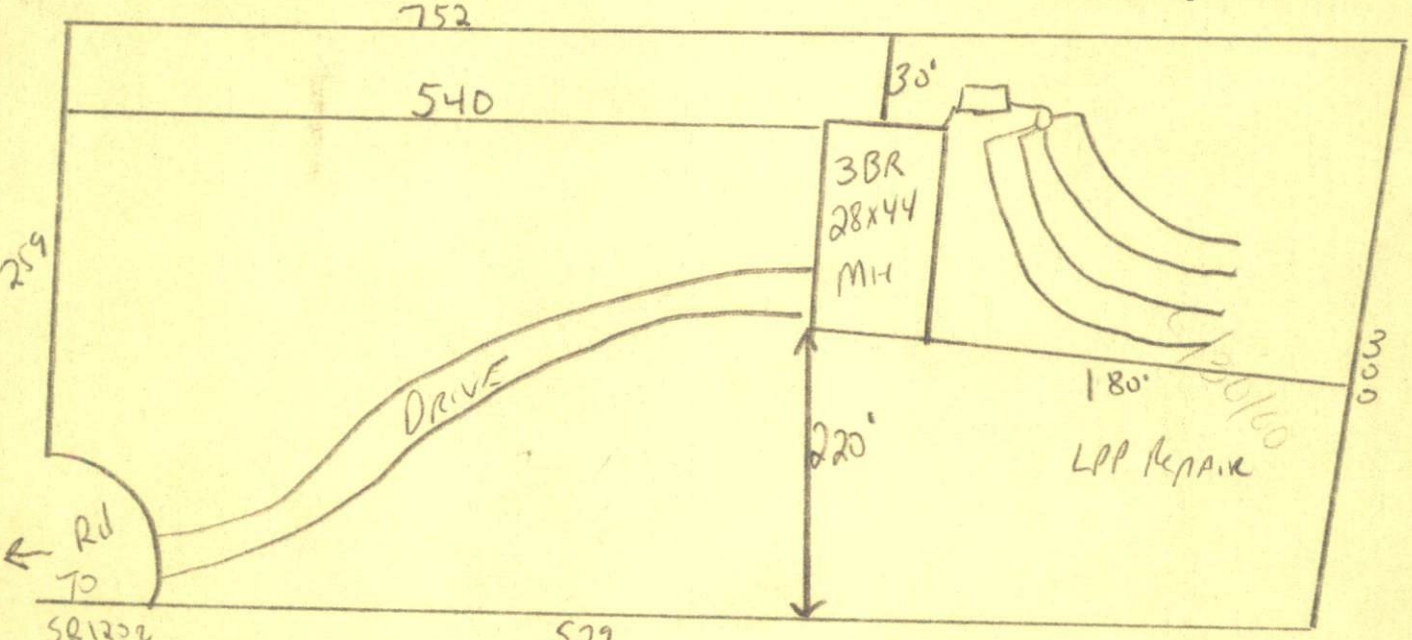

Meet on site Before Installing 18" max Ditch Depth
NOTE Change in house location -
DO NOT DRIVE OR PARK ON septic system
MAINTAIN all setbacks

HAR T COUNTY HEALTH DEPART NT
AUTHORIZATION TO CONSTRUCT

Authorization is hereby given to construct a wastewater system to the specifications described by Harnett County Health Department Improvement Permit # 17909. This authorization shall be valid for a period not to exceed five (5) years from the date of issuance. This authorization will be invalid if ownership, site plans, or intended use change.

Owner or Authorized Agent Timothy Wickar / Clyde Patterson

Name: _____ Telephone # 258-5538

Address: _____

Property Location: SR # 1202 Road Name _____

New Installation Repair _____ Septic Tank Nitrification Lines

Subdivision TJP-II Lot # 13

Number of Bedrooms Proposed: 3 (28x44) Lot size: 4.41 AC

Basement _____ With Plumbing _____ Without Plumbing _____

Water Supply: Well _____ Public Minimum Well Setback: _____ ft.

Type of System: Conventional Other _____

Tank Volume: Septic Tank 1000 gallons Pump Chamber _____ gallons

Nitrification Field Specifications

Number of fields 1 Number of Lines per Field 4 Length of lines 75

Width of ditches 3 ft. Depth of ditches 18 inches

French Drain: Linear feet required _____ Depth of gravel _____

No wastewater system shall be covered or placed into use by any person until an inspection by the Harnett County Health Department has determined that the system has been installed according to the conditions of the improvement permit and that a valid operations permit has been issued.

Authorized Agent for Harnett County Health Department

Name: [Signature] Date: 6-1-2000