



# Harnett County Emergency Services

Office of the Fire Marshal  
 PO Box 370  
 Lillington, NC 27546  
 (910) - 893 - 7580

Date: 7/11/22 Time:

Occupancy: Benhaven Fire Department Olivia Station  
 4023 NC 87  
 SANFORD, NC 27332

## Fuel Tank(s) Installation

On the above date and time, a Fuel Tank(s) Installation witnessed at the above location revealed no violations of the N.C. State Fire Code. Piping and Dispenser Tests will need to be conducted by our office once the fuel piping has been installed. Please call our office to schedule these appointments.

Contractor Installing Fuel Tank(s):

GAINES OIL COMPANY  
 9098 PHEBOND Goldston Rd  
 Goldston, NC 27252  
 JOEL THOMAS 919-352-2783 joel@gainesoil.com

Number of Tanks:

AGST  UGST

#1 Contents	Vol	UL#	Mfg	Air/Vacuum
ULSD	1,000 gallon	142		
#2 Contents	Vol	UL#	Mfg	Air/Vacuum
#3 Contents	Vol	UL#	Mfg	Air/Vacuum
#4 Contents	Vol	UL#	Mfg	Air/Vacuum

Notes:

Thank you for your cooperation.

Inspector

The Harnett County Fire Marshal's Division is committed to providing our community with a professional fire and life safety program through comprehensive fire protection plan reviews, informative occupancy inspections, effective fire and life safety code enforcement, and definitive fire origin and cause investigations in order to reduce the loss of life and property of the citizens of Harnett County. We will strive to maintain an unmatched level of professionalism and support to our community.



*"Quality Service Since 1948"*

9098 Pittsboro Goldston Rd.  
Goldston, NC 27252

**Joel Thomas**  
*Fuel Polishing Sales  
& Sr. Project Manager*  
Cell: 919-352-2783  
joel@gainesoil.com

Office: 919-898-2231  
Toll Free: 1-800-767-2231  
Fax: 919-898-2981  
gainesoil.com

**STI SP001 Certified Aboveground Tank  
Inspector AST-1987**

**Certified Healthcare Contractor  
KSHE#46625534-8494**

**NC Licensed General Contractor #79818**

Benhaven Emergency Services  
4023 N. Carolina Hwy 87 N. Sanford NC 27332

Seawell Rosser Rd

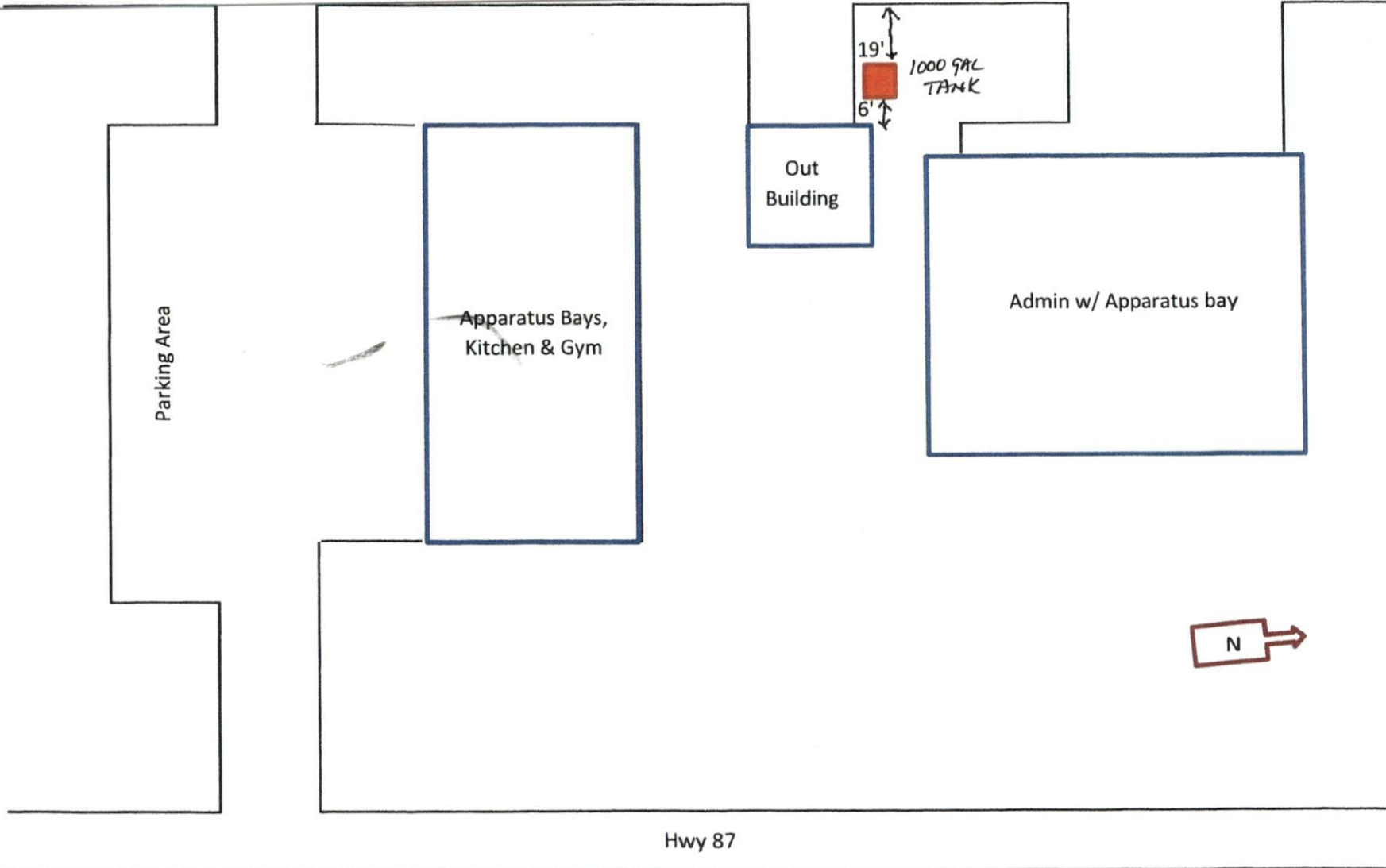

## QUALITY STANDARD TANK

- State of the Art Technology
- 500 - 1000 - 2000 gallon & larger upon request
- Double Wall Technology
- 24 Hour Wireless Monitoring
- Texting capabilities for fill/drain alerts
- Customer access to daily activity/fuel volumes
- High Volume/Metered pumps for better record keeping
- Unlimited Fuel Supply & Delivery
- Detachable quick connect power cord for extra security



- State of the Art Technology
- 500 - 1000 - 2000 gallon & larger upon request to include a gas powered pump if more volume is needed/skid mounted
- Wireless monitor/24 hour surveillance
- GPS/Alarm System
- Texting capabilities for fill/drain alerts
- Customer access to daily activity/fuel volumes
- High Volume/Metered pumps for better record keeping
- 10 micron filtration
- All compartments are welded for dependability
- Hidden locks for extra security & peace of mind
- Custom options also available
- Unlimited fuel supply & delivery

## QUALITY VAULTANK

Lock Safe & Secured



## QUALITY FUEL CUBE VAULTANK



- State of the Art Technology
- 500 - 1000 - 2000 gallon & larger upon request to include a gas powered pump if more volume is needed/skid mounted
- Wireless monitor/24 hour surveillance
- GPS/Alarm System
- Texting capabilities for fill/drain alerts
- Customer access to daily activity/fuel volumes
- High Volume/Metered pumps for better record keeping
- 10 micron filtration
- All compartments are welded for dependability
- Hidden locks for extra security & peace of mind
- Custom options also available
- Unlimited fuel supply & delivery

NOTE: ALL RIGHTS RESERVED. THIS DRAWING MUST NOT BE REPRODUCED IN ANY FORM WITHOUT THE WRITTEN PERMISSION OF HIGHLAND TANK. HIGHLAND TANK SHALL BE RESPONSIBLE ONLY FOR ITEMS INDICATED ON THIS FABRICATION DRAWING UNLESS OTHERWISE NOTED. CUSTOMER IS RESPONSIBLE FOR VERIFYING CORRECTNESS OF SIZE AND LOCATION OF FITTINGS, ACCESSORIES, AND COATINGS SHOWN ON THIS DRAWING.

TOUCH UP OF FINISHED PAINT IS REQUIRED BY INSTALLATION CONTRACTOR. TOUCH UP PAINT SHIPPED WITH TANK.

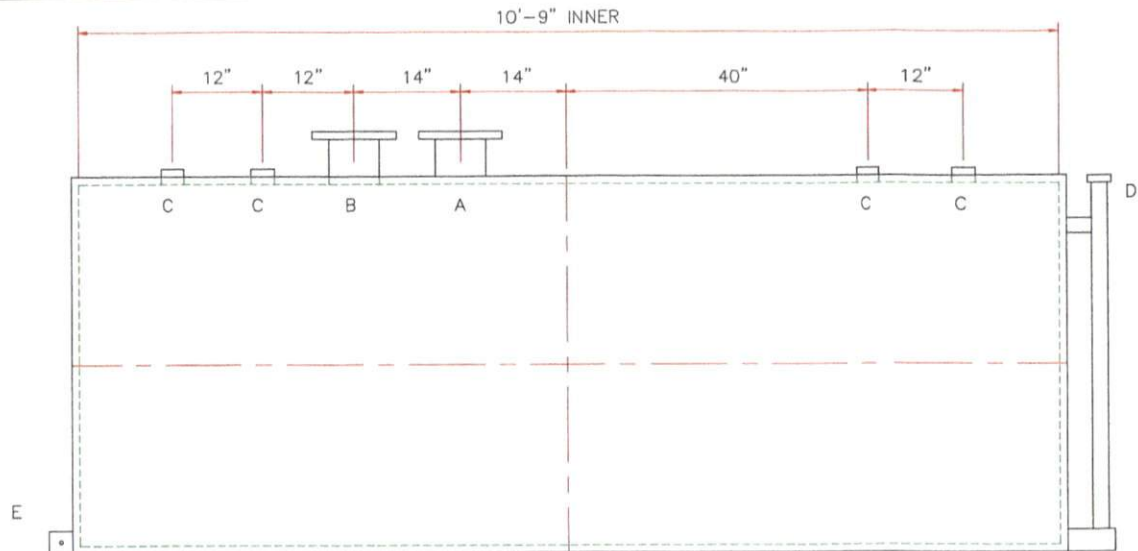
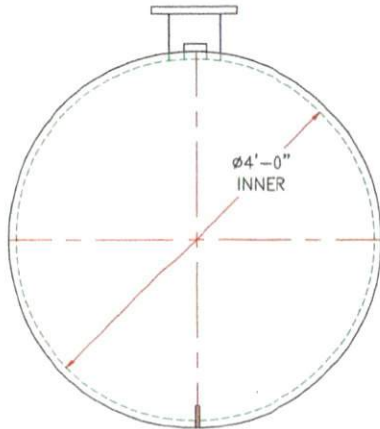

**DESIGN DATA**

CAPACITY - 1,000 GALLONS
TYPE - DOUBLE WALL - TYPE I
NO. REQ. - -
OPERATING PRESSURE - ATMOSPHERIC
SPECIFIC GRAVITY = 1.0
TANK MATERIAL - MILD CARBON STEEL
THICKNESS - INNER- HEADS: 10 GA SHELL: 10 GA
THICKNESS - OUTER- HEADS: 10 GA SHELL: 10 GA
CONSTRUCTION - INNER - LAP WELD OUTSIDE ONLY
OUTER - LAP WELD OUTSIDE ONLY
TANK TEST - INNER - 5 PSIG
OUTER - +3 PSIG OR 13"hg VACUUM
INT. FINISH - NONE
EXT. FINISH - SHOP PRIMER
LABEL - UL 142

**LEGEND**

A	6" FFSO 150# FLANGE THROUGH OUTER SHELL ONLY, MARK WITH SPECIAL WARNING LABEL INTERSTITIAL EMERGENCY VENT USE ONLY
B	6" FFSO 150# FLANGE - PRIMARY EMERGENCY VENT USE
C	2" FITTING
D	2" INTERSTITIAL MONITOR PIPE
E	3" FLAT BAR GROUNDING LUG WITH 1/2" $\phi$ HOLE ON CL
F	-

		<b>Highland Tank</b>	
UNLESS NOTED, TOLERANCES ARE +/- 1"			
1,000 GAL 48" $\phi$ AG DW HORIZONTAL			
CUSTOMER:			
PROJECT:			
QUOTE NO:		CHK'D BY:	
SCALE: 3/4"=1'-0"	DATE:	DWG. BY:	DWG. NO: 01000AHDW48GA10

01000AHDW487GA

Recommended Guide Specification for Aboveground Horizontal Double-wall Type I Steel Storage Tank

Short Form

Furnish an aboveground, horizontal, double-wall type I, steel storage tank. The tank shall be in conformance with the Underwriters Laboratories' UL-142 specifications and so labeled. Tank size will be noted on an attached reference drawing.

Long Form

Furnish a 1,000 gallon aboveground, horizontal, double-wall type I, steel storage tank 4'0" in diameter by 10'9" long. Tank shall be fabricated from mild carbon steel with flat-flanged heads. Minimum inner tank thickness 7 gauge head and shell. Minimum outer tank thickness 10 gauge head and shell. All items included with the tank shall be coated with red primer paint. The tank shall be manufactured in conformance with Underwriters Laboratories' UL-142 specifications and so labeled.

The tank shall be fabricated with the following threaded connections : 4 2 inch, 0 4 inch, 0 6 inch as located on attached drawing, AND/OR 2 150# flanged connections with flange protectors. Flange sizes as follows (qty-size): 6", \_\_\_\_\_, \_\_\_\_\_, with locations also indicated on drawing. Refer to Highland standard fitting location diagrams in literature for quantity, size and locations. Thread protectors shall be inserted in all threaded openings prior to shipment.

Highland tanks are air tested at the factory but MUST be retested at the jobsite by the installer prior to installation.

Options & Accessories:

- Manway(s) \_\_\_\_\_ inches in diameter with bolted and gasketed lid
- Support Saddles per drawing
- Emergency Vent
- External Ladder
- External Ladder & Platform
- External Stairway
- Pump Platform
- Walkway(s) with Handrails
- Commercial grit blast (SSPC-6), epoxy primer coat
- Exterior polyurethane paint \_\_\_\_\_
- Other exterior coating \_\_\_\_\_
- Internal Ladder(s)
- Internal coating \_\_\_\_\_ (Must include interior weld. Minimum size 500 gallon.)
- Level Sensing System(s)
- Overfill Containment Chamber

Warranty:

The subject tank is warranted by Highland Tank & Mfg. Co. to be free from defects in manufacturing, workmanship and materials. Highland Tank will repair or replace, at its sole discretion F.O.B. factory, within a period of one year after date of shipment, any item of our manufacture. All other items shall be warranted by their respective manufacturers. Liability hereunder is limited, as stated above, and does not include labor, installation costs, indirect or consequential damages of any kind. Tanks must be returned to the factory and if found to be defective upon examination, will be repaired, replaced or credit will be issued at our option.

Approved Manufacturer:

Tank to be manufactured by Highland Tank at one of the following locations: Stoystown, PA, Marheim, PA, Watervliet, NY, or Greensboro, NC.