

# KRIGEN PHARMA

## 800 EDWARDS BROTHERS DRIVE LILLINGTON, NORTH CAROLINA 27546 FIRE ALARM SYSTEM



KRIGEN PHARMA  
800 EDWARDS BROTHERS DRIVE  
LILLINGTON, NC 27546  
FIRE ALARM SYSTEM

### FIRE ALARM SYMBOL LEGEND

SYMBOLS	DEVICE
[FACP]	FIRE LITE ADDRESSABLE FIRE ALARM CONTROL PANEL
[FAA]	FIRE LITE FIRE ALARM REMOTE ANNUNCIATOR
[S <sub>p</sub> ]	FIRE LITE ADDRESSABLE PHOTO SMOKE DETECTOR
[AMM]	FIRE LITE ADDRESSABLE MONITOR MODULE
[F]	FIRE LITE ADDRESSABLE MANUAL PULL STATION
[H <sub>ROR</sub> ]	FIRE LITE ADDRESSABLE THERMAL HEAT DETECTOR RATE-OF-RISE
[PS]	PRESSURE / WATER FLOW SWITCH
[VS]	SPRINKLER TAMPER SWITCH
[HPS]	SPRINKLER AIR HIGH PRESSURE SWITCH

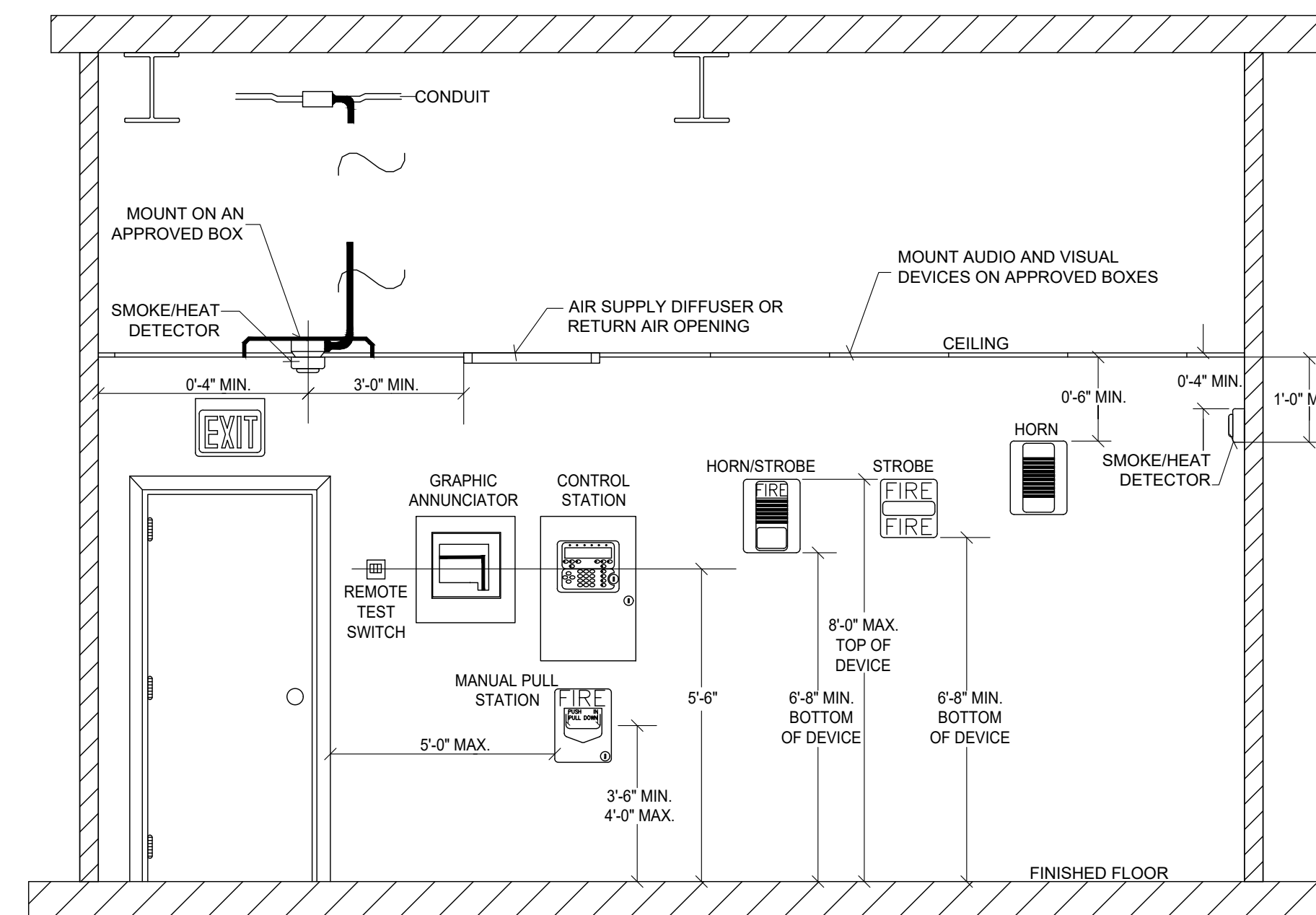

A  
FA-01  
FIRE ALARM DEVICE MOUNTING DETAILS  
NOT TO SCALE

### GENERAL NOTES:

- ALL WORK SHALL BE INSTALLED IN ACCORDANCE WITH THE LATEST EDITION OF THE FOLLOWING CODES AND STANDARDS INsofar AS THEY APPLY:
  - THE NATIONAL ELECTRICAL CODE, NFPA 70
  - THE NATIONAL FIRE ALARM CODE, NFPA 72
  - THE NATIONAL ELECTRICAL SAFETY CODE
  - UNDERWRITER'S LABORATORIES, INC. STANDARDS AND APPROVED LISTINGS
  - ELECTRICAL TESTING LABORATORIES STANDARDS
  - ALL LOCAL CODES AND ORDINANCES
  - ADA
  - THE PROJECT SPECIFICATIONS
  - MANUFACTURER'S RECOMMENDATIONS
- ALL WORK SHALL BE DONE WITH THE CONTRACT DOCUMENTS, IN A NEAT AND WORKMANLIKE MANNER CONSISTENT WITH RECOGNIZED GOOD PRACTICE. ALL ITEMS SHALL BE U.L. APPROVED AND LISTED & ISO9001 APPROVED WHERE APPLICABLE.
- FIRE ALARM CONTROL PANEL TO BE EQUIPPED WITH A BATTERY BACKUP CAPABLE OF POWERING THE PANEL FOR 24 HOURS.
- THE FIRE ALARM CONTROL PANEL CIRCUIT SHALL BE DEDICATED FOR FACP POWER ONLY AND THE CIRCUIT BREAKER SHALL BE LABELED IN RED "FIRE ALARM CIRCUIT."
- FIRE ALARM CIRCUIT BREAKER SHALL BE ACCESSIBLE TO AUTHORIZED PERSONNEL ONLY BY MEANS OF A LOCKABLE BREAKER, LOCKABLE PANEL DOOR, OR LOCKABLE ELECTRICAL ROOM.
- THE LOCATION OF THE FIRE ALARM CONTROL PANEL (FACP) CIRCUIT BREAKER SHALL BE PERMANENTLY IDENTIFIED AT THE FACP.
- ALL FIRE ALARM WIRING SHALL BE RUN IN EITHER 3/4" CONDUIT OR APPROVED MC CABLE.
- SEE SPECIFICATIONS FOR ADDITIONAL REQUIREMENTS AND FULL SEQUENCE OF OPERATIONS.

### SHEET LEGEND

SHEET NO.	DESCRIPTION
FA0.1	COVER SHEET, DEVICE MOUNTING DETAILS, MATRIX, GEN. NOTES, WIRE, SYMBOL, & SHEET LEGEND
FA1.1	FIRE ALARM FLOOR PLAN SECTION A
FA1.2	FIRE ALARM FLOOR PLAN SECTION B
FA1.3	FIRE ALARM FLOOR PLAN SECTION C & D
FA1.4	FIRE ALARM FLOOR PLAN MEZZ LEVEL & BATTERY CALCULATIONS

### WIRE LEGEND

NAME	TYPE
SLC	18-2 FPLP UNSHIELDED
NAC	16-2 FPLP UNSHIELDED
ANN	18-2 FPLP SHIELDED
ANN	16-2 FPLP UNSHIELDED PWR
120VAC	(2) #12 AWG, (1) #12G AWG TO DEDICATED 20A CIRCUIT.

SYSTEM INPUTS	BUILDING SYSTEM OUTPUTS																CENTRAL COMMUNICATOR						
	A	B	C	D	E	F	G	H	I	J	K	L	M	N	O	P		Q	R	S	T	U	V
1) FIRE ALARM SMOKE DETECTOR COMMON AREAS	•	•	•	•	•	•	•	•	•	•	•	•	•	•	•	•	•	•	•	•	•	•	•
2) FIRE ALARM PULL STATION	•	•	•	•	•	•	•	•	•	•	•	•	•	•	•	•	•	•	•	•	•	•	•
3) FIRE ALARM HEAT DETECTOR	•	•	•	•	•	•	•	•	•	•	•	•	•	•	•	•	•	•	•	•	•	•	•
4) SPRINKLER PRESSURE / WATER FLOW SWITCH	•	•	•	•	•	•	•	•	•	•	•	•	•	•	•	•	•	•	•	•	•	•	•
5) SPRINKLER TAMPER SWITCH	•	•	•	•	•	•	•	•	•	•	•	•	•	•	•	•	•	•	•	•	•	•	•
6) SPRINKLER HIGH PRESSURE AIR SWITCH	•	•	•	•	•	•	•	•	•	•	•	•	•	•	•	•	•	•	•	•	•	•	•
7) NOTIFICATION DEVICE SHORT CIRCUIT	•	•	•	•	•	•	•	•	•	•	•	•	•	•	•	•	•	•	•	•	•	•	•
8) GROUND FAULT	•	•	•	•	•	•	•	•	•	•	•	•	•	•	•	•	•	•	•	•	•	•	•
9) FIRE ALARM A.C. POWER FAILURE	•	•	•	•	•	•	•	•	•	•	•	•	•	•	•	•	•	•	•	•	•	•	•
10) FIRE ALARM SYSTEM LOW BATTERY	•	•	•	•	•	•	•	•	•	•	•	•	•	•	•	•	•	•	•	•	•	•	•

B  
FA-01  
FIRE ALARM SYSTEM MATRIX  
NOT TO SCALE

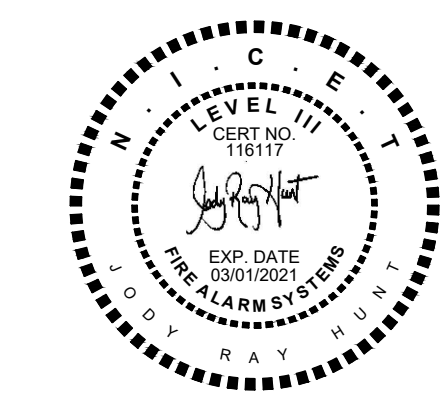

DRAWING TITLE:  
COVER SHEET, DEVICE MOUNTING  
DETAILS, MATRIX, GEN NOTES, WIRE  
SYMBOL, & SHEET LEGEND

DRAWN BY: JRH  
SALESMAN: TA  
PROJECT MGR: TA  
DATE: 10/29/2019  
SCALE: AS SHOWN ON DRAWINGS  
SHEET NO. 1 OF 5

DRAWING NO.  
**FA-01**

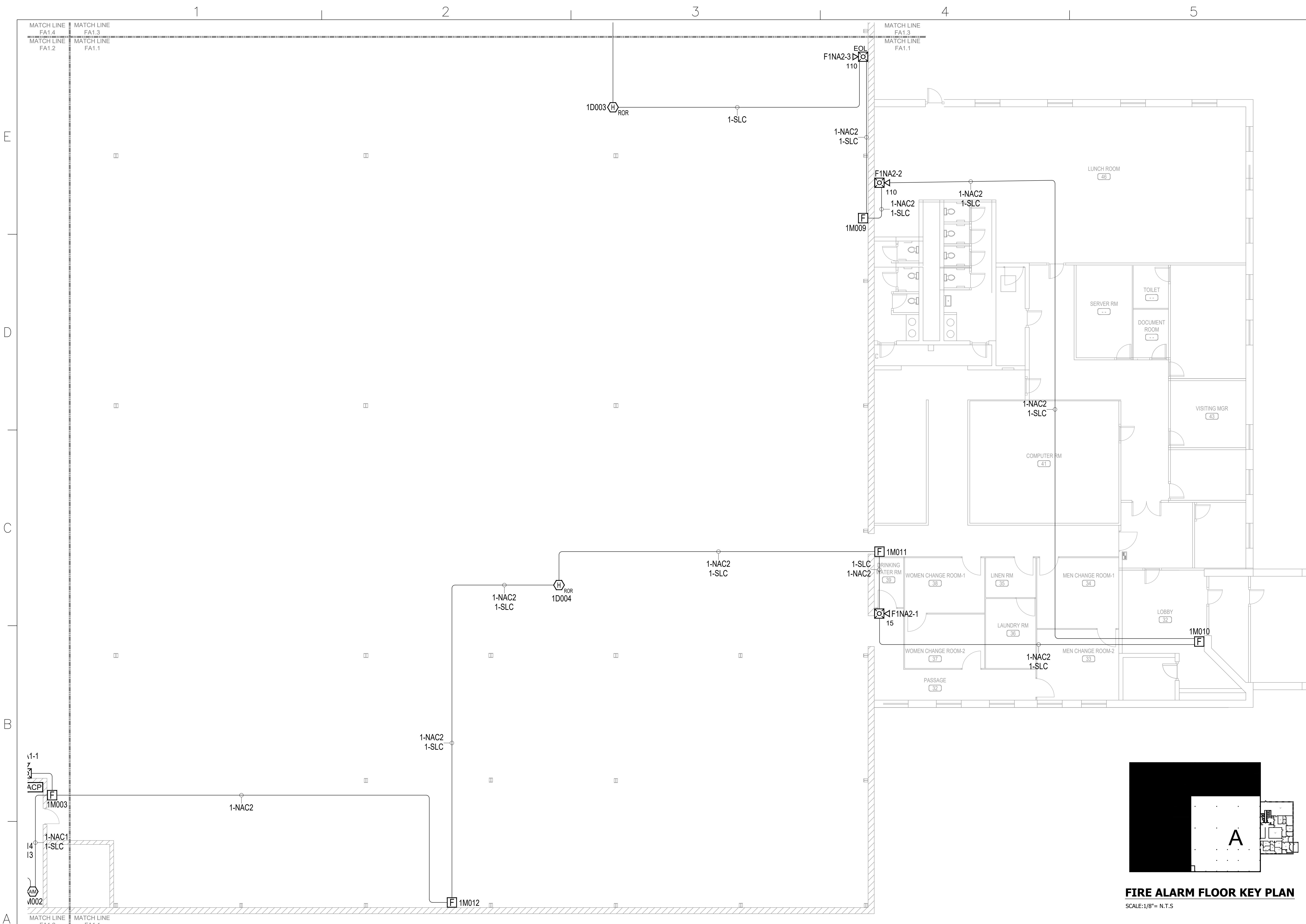

**FIRE ALARM FLOOR PLAN SECTION A**  
SCALE: 1/8" = 1'-0"

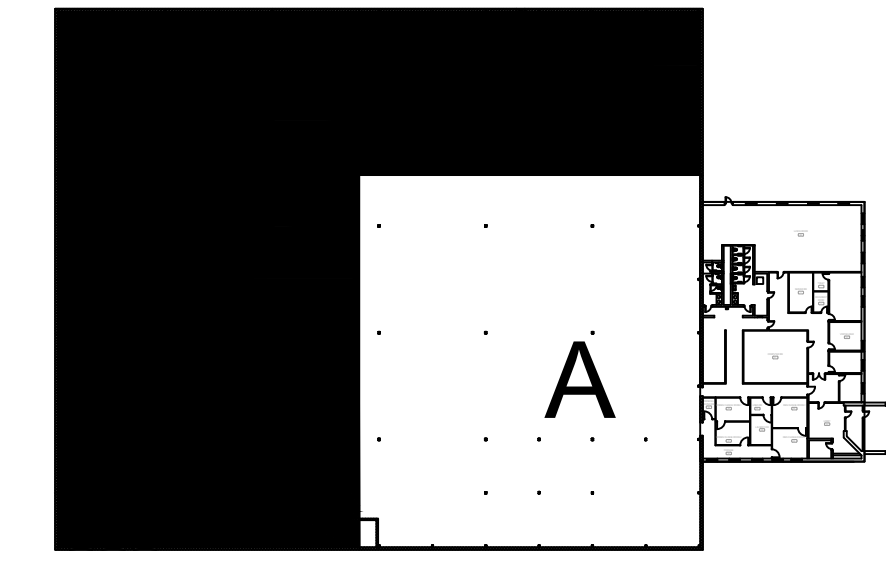

**FIRE ALARM FLOOR KEY PLAN**  
SCALE: 1/8" = N.T.S.

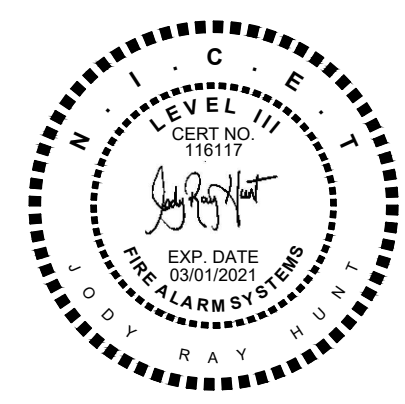
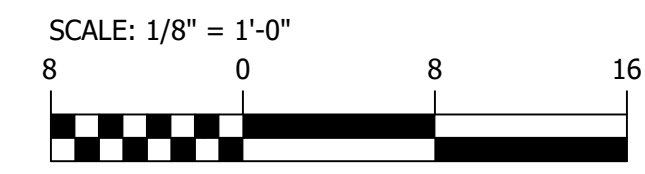

KRIGEN PHARMA  
800 EDWARDS BROTHERS DRIVE  
LILLINGTON, NC 27546  
FIRE ALARM SYSTEM

AFA SOUTHEAST, INC.  
SUBSIDIARY OF AFA PROTECTIVE SYSTEMS, INC.  
1135 FOUR LAKES DRIVE  
SUITE G  
MATTHEWS, NC 28105  
704-246-7920

**JRH**  
Fire Design & Consulting  
JRH FIRE DESIGN & CONSULTING, LLC.  
2315 HIGSTINE ROAD  
GARY, NC 27519  
JHUNT@JRHFIREDESIGN.COM

**SHOP DRAWINGS**  
PREPARED BY:  
JRH FIRE DESIGN & CONSULTING, INC.  
FROM THE DESIGNED DRAWINGS.

**INSTALLATION BY:**  
AFA SOUTHEAST INC.  
1135 FOUR LAKES DRIVE, SUITE G  
MATTHEWS, NORTH CAROLINA 28105  
704-246-7920  
TACKINS@AFAP.COM

JRH JOB NUM. 19-1151
REVISION: 00 DATE: 10/29/2019
INITIAL RELEASE
REVISION: DATE:
REVISION: DATE:
REVISION: DATE:
REVISION: DATE:
REVISION: DATE:
REVISION: DATE:
REVISION: DATE:
REVISION: DATE:
REVISION: DATE:

DRAWING TITLE:  
**FIRE ALARM FLOOR PLAN SECTION A**

DRAWN BY:	JRH
SALESMAN:	TA
PROJECT MGR:	TA
DATE:	10/29/2019
SCALE:	AS SHOWN ON DRAWINGS
SHEET NO. 2	OF 5

DRAWING NO.  
**FA1.1**

J:\AFA FOLDER\Design Folder\20181019-1151 Krigen Pharma\ENGINEERING\HOUSE (SHOP DRAWINGS)\SHOP DRAWINGS\DWG\19-1151-01-FA02.dwg, 11/30/2019 5:46:41 PM

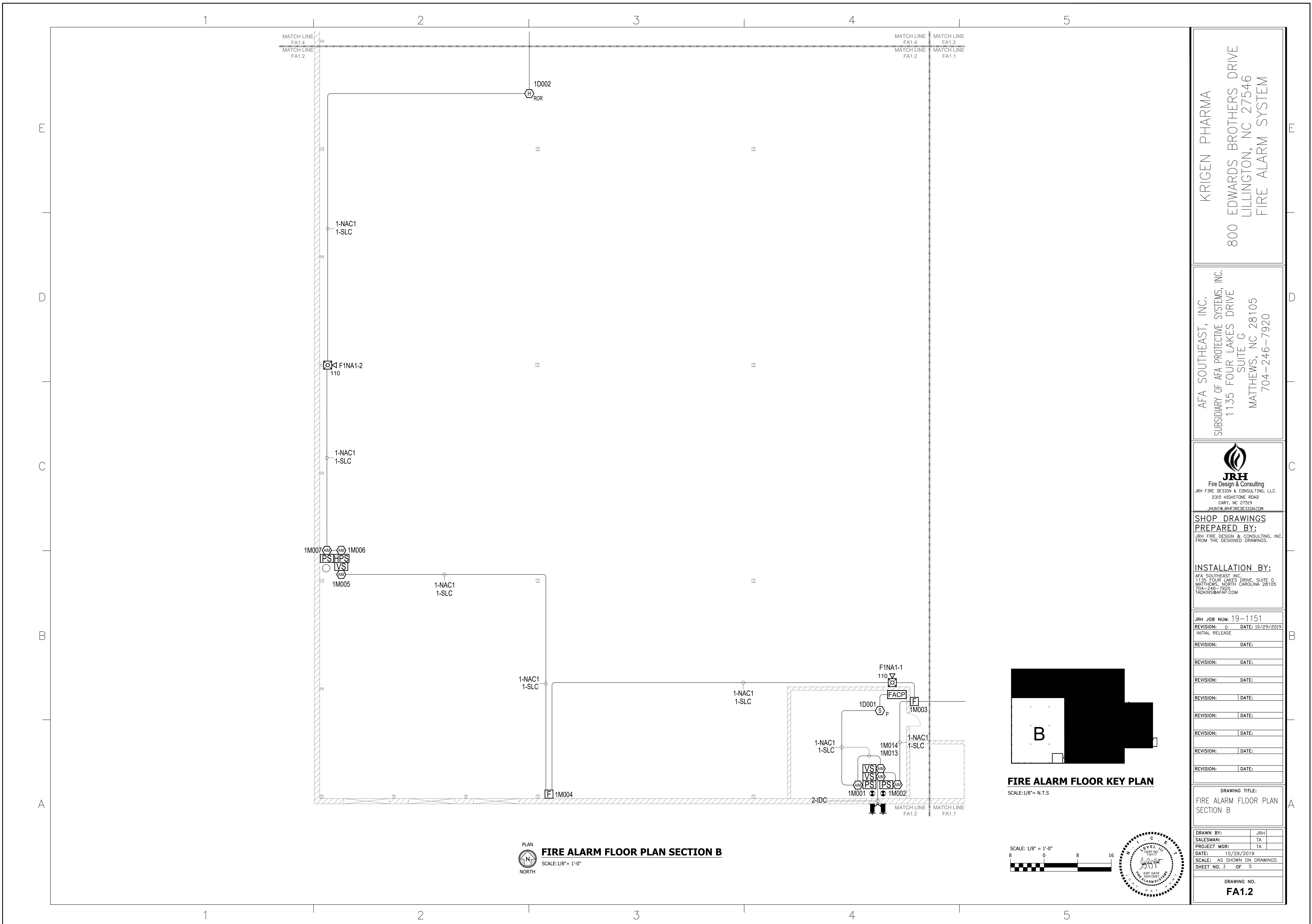

PLAN  
**FIRE ALARM FLOOR PLAN SECTION B**  
 SCALE: 1/8" = 1'-0"

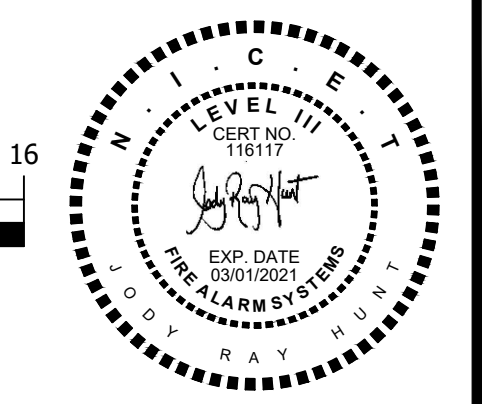
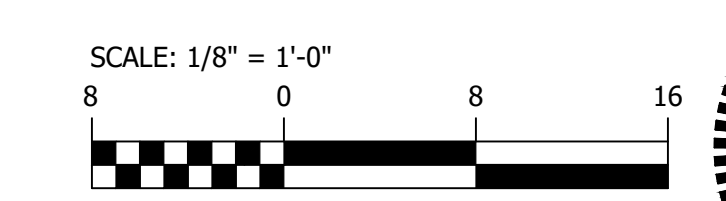
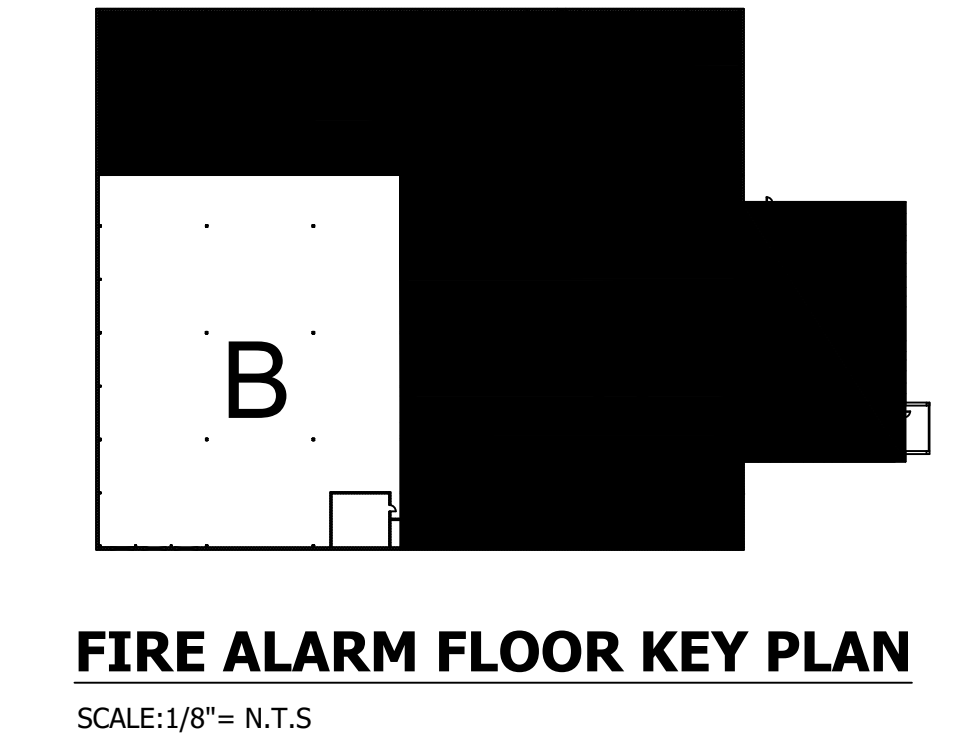

KRIGEN PHARMA 800 EDWARDS BROTHERS DRIVE LILLINGTON, NC 27546 FIRE ALARM SYSTEM
AFA SOUTHEAST, INC. SUBSIDIARY OF AFA PROTECTIVE SYSTEMS, INC. 1135 FOUR LAKES DRIVE SUITE G MATTHEWS, NC 28105 704-246-7920
 <b>JRH</b> Fire Design & Consulting JRH FIRE DESIGN & CONSULTING, LLC. 2315 HIGGESTONE ROAD CLAY, NC 27519 JHUNT@JRHFIREDESIGN.COM
<b>SHOP DRAWINGS</b> PREPARED BY: JRH FIRE DESIGN & CONSULTING, INC. FROM THE DESIGNED DRAWINGS.
<b>INSTALLATION BY:</b> AFA SOUTHEAST INC. 1135 FOUR LAKES DRIVE, SUITE G MATTHEWS, NORTH CAROLINA 28105 704-246-7920 TACKINS@AFAP.COM
JRH JOB NUM. 19-1151 REVISION: 00 DATE: 10/29/2019 INITIAL RELEASE REVISION: DATE: REVISION: DATE: REVISION: DATE: REVISION: DATE: REVISION: DATE: REVISION: DATE: REVISION: DATE: REVISION: DATE: REVISION: DATE:
DRAWING TITLE: <b>FIRE ALARM FLOOR PLAN SECTION B</b>
DRAWN BY: JRH SALESMAN: TA PROJECT MGR: TA DATE: 10/29/2019 SCALE: AS SHOWN ON DRAWINGS SHEET NO. 3 OF 5
DRAWING NO. <b>FA1.2</b>

J:\AFA FOLDER\Design Folder\20181019-1151 Krigen Pharma\ENGINEERING\HOUSE (SHOP DRAWINGS)\SHOP DRAWINGS\DWG\19-1151-01-FA02.dwg, 11/30/2019 5:46:42 PM

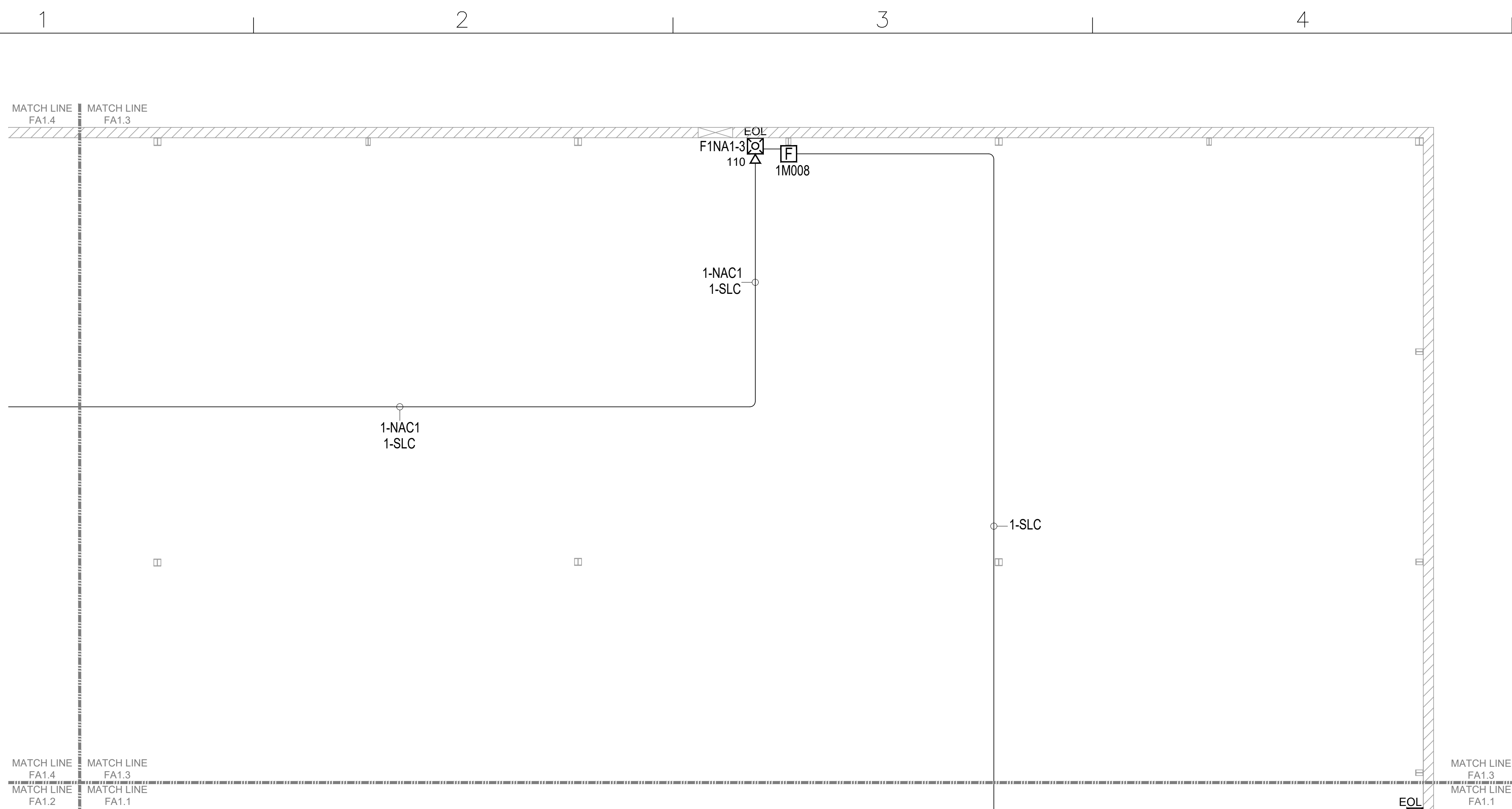

PLAN  
NORTH  
**FIRE ALARM FLOOR PLAN SECTION C**  
SCALE: 1/8" = 1'-0"

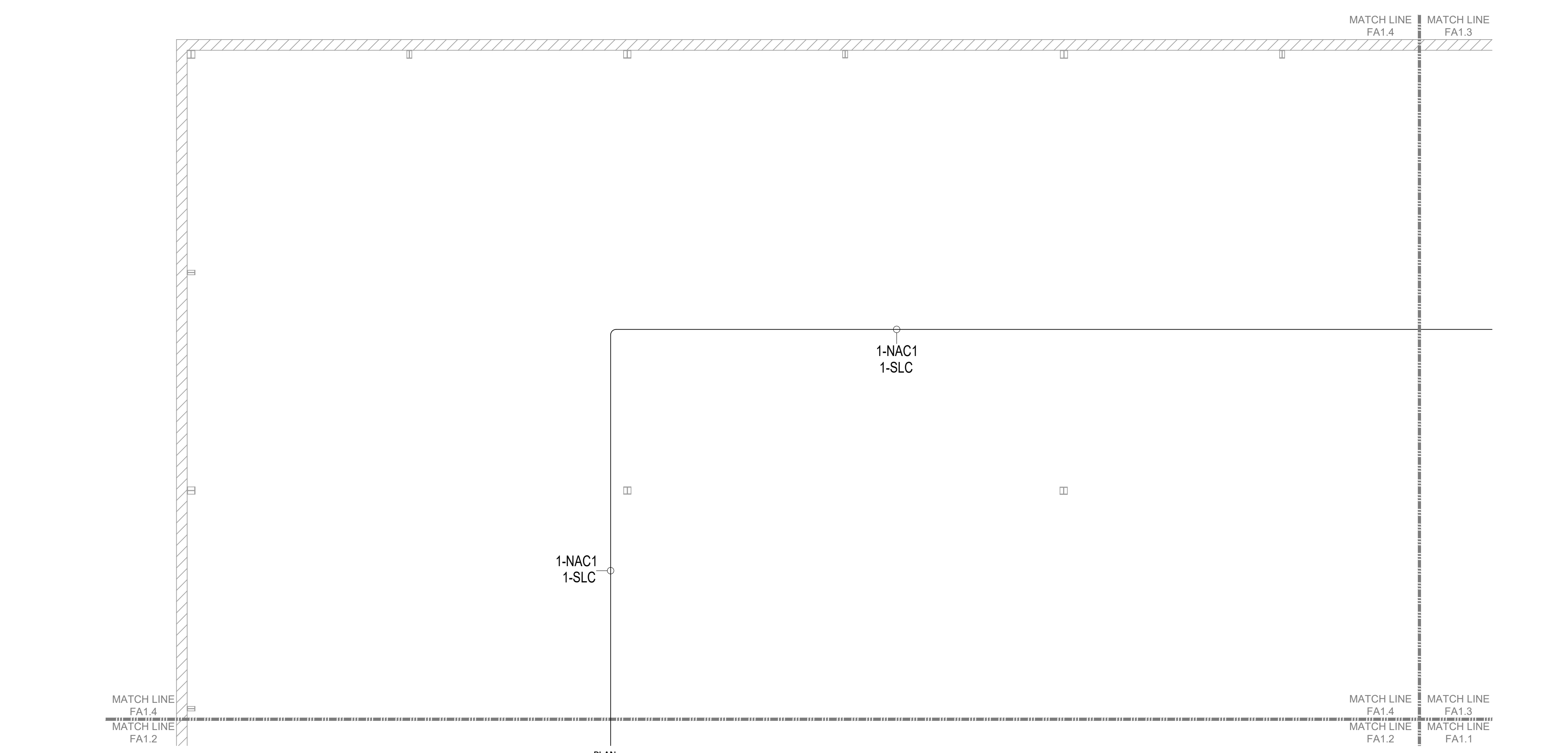

PLAN  
NORTH  
**FIRE ALARM FLOOR PLAN SECTION D**  
SCALE: 1/8" = 1'-0"

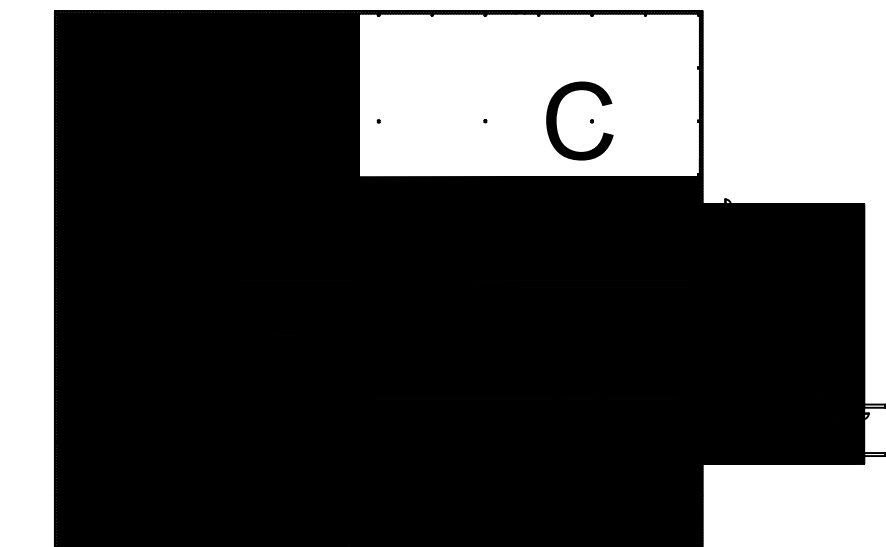

**FIRE ALARM FLOOR KEY PLAN**  
SCALE: 1/8" = N.T.S.

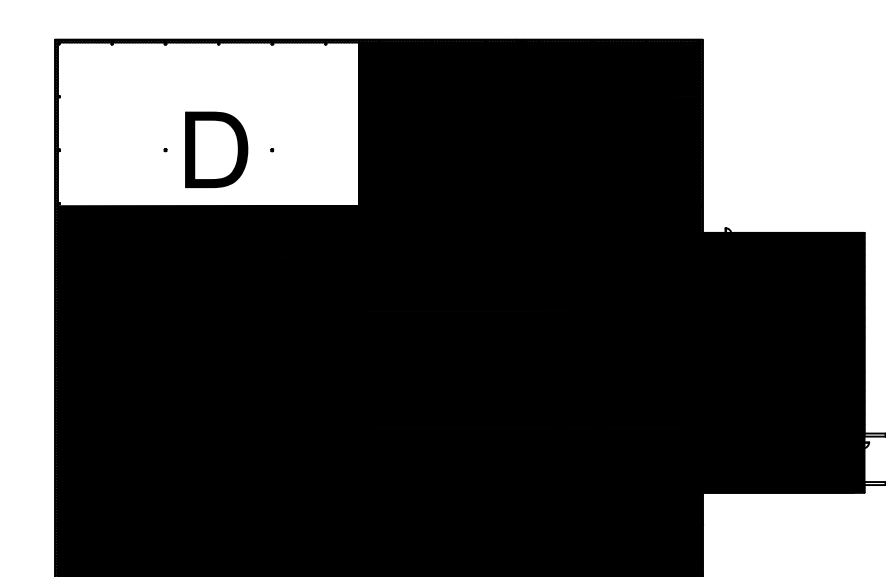

**FIRE ALARM FLOOR KEY PLAN**  
SCALE: 1/8" = N.T.S.

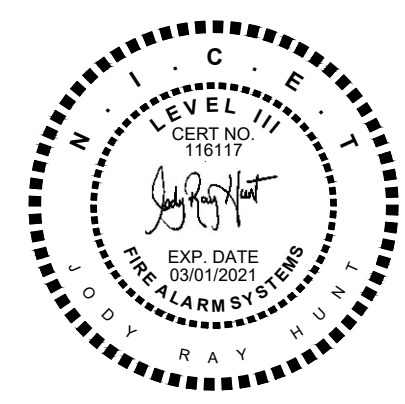
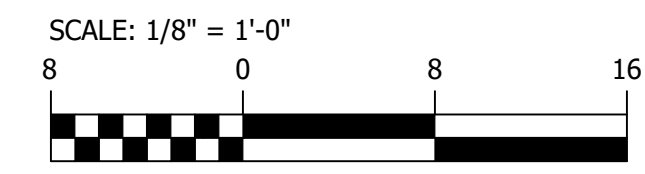

**KRIGEN PHARMA**  
 800 EDWARDS BROTHERS DRIVE  
 LILLINGTON, NC 27546  
**FIRE ALARM SYSTEM**

**AFA SOUTHEAST, INC.**  
 SUBSIDIARY OF AFA PROTECTIVE SYSTEMS, INC.  
 1135 FOUR LAKES DRIVE  
 SUITE G  
 MATTHEWS, NC 28105  
 704-246-7920

**JRH**  
 Fire Design & Consulting  
 JRH FIRE DESIGN & CONSULTING, LLC.  
 2315 HIGGESTONE ROAD  
 CARY, NC 27519  
 JHUNT@JRHFIREDESIGN.COM

**SHOP DRAWINGS**  
 PREPARED BY:  
 JRH FIRE DESIGN & CONSULTING, INC.  
 FROM THE DESIGNED DRAWINGS.

**INSTALLATION BY:**  
 AFA SOUTHEAST INC.  
 1135 FOUR LAKES DRIVE, SUITE G  
 MATTHEWS, NORTH CAROLINA 28105  
 704-246-7920  
 TACKINS@AFAP.COM

JRH JOB NUM.	19-1151
REVISION:	0 DATE: 10/29/2019
INITIAL RELEASE	
REVISION:	DATE:
REVISION:	DATE:
REVISION:	DATE:
REVISION:	DATE:
REVISION:	DATE:
REVISION:	DATE:
REVISION:	DATE:
REVISION:	DATE:
REVISION:	DATE:

DRAWING TITLE:  
**FIRE ALARM FLOOR PLAN SECTION C & D**

DRAWN BY:	JRH
SALESMAN:	TA
PROJECT MGR:	TA
DATE:	10/29/2019
SCALE:	AS SHOWN ON DRAWINGS
SHEET NO.	4 OF 5

DRAWING NO.  
**FA1.2**

J:\AFA FOLDER\Design Folder\2019\19-1151 Krigen Pharma\ENGINEERING\HOUSE (SHOP DRAWINGS)\HOUSE (SHOP DRAWINGS)\DWG\19-1151-01-FA02.dwg, 11/02/2019 5:46:43 PM

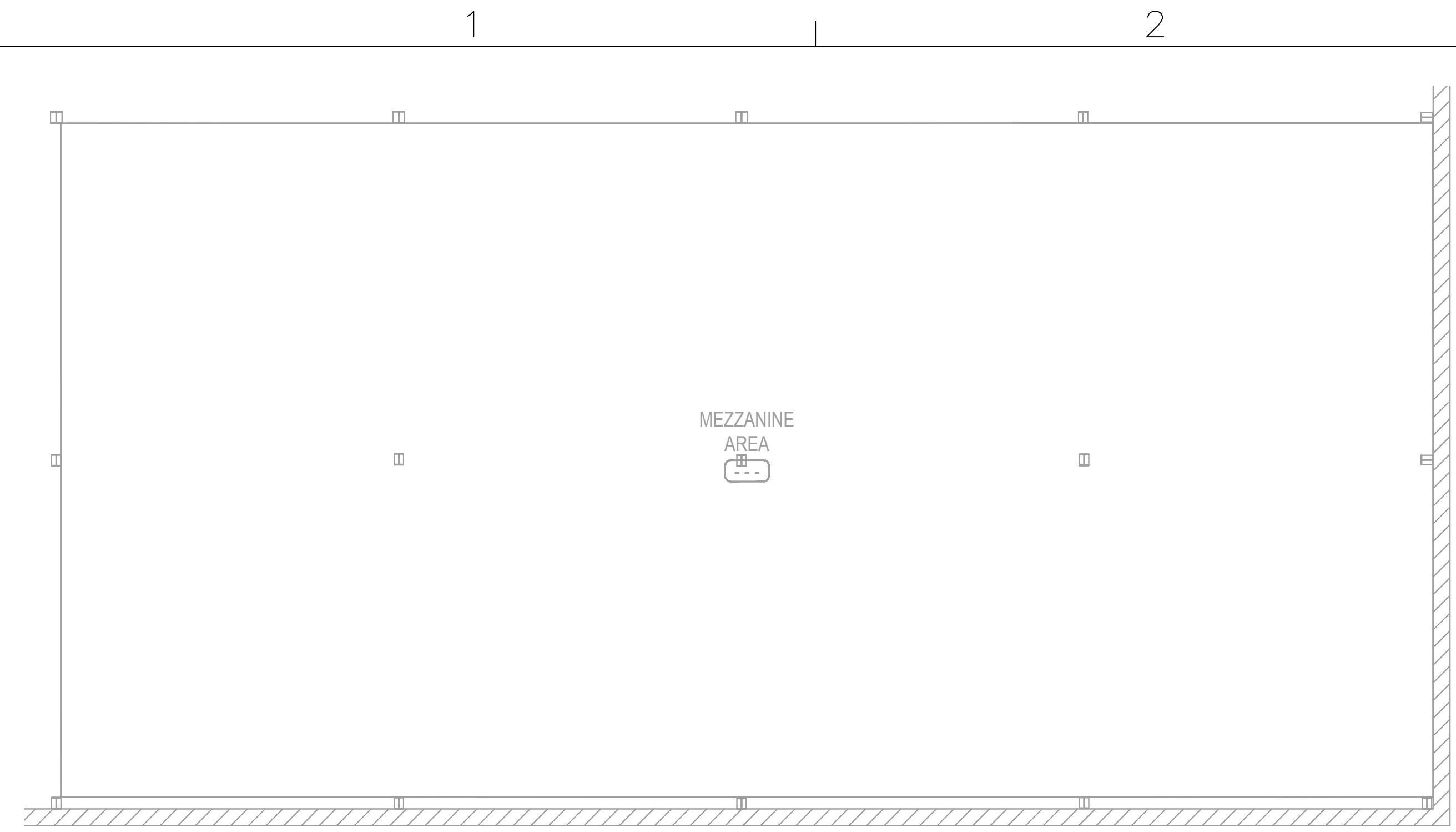

**PLAN**  
**FIRE ALARM FLOOR PLAN MEZZANINE AREA**  
SCALE: 1/8" = 1'-0"  
NORTH



**FIRE ALARM FLOOR KEY PLAN**  
SCALE: 1/8" = N.T.S.

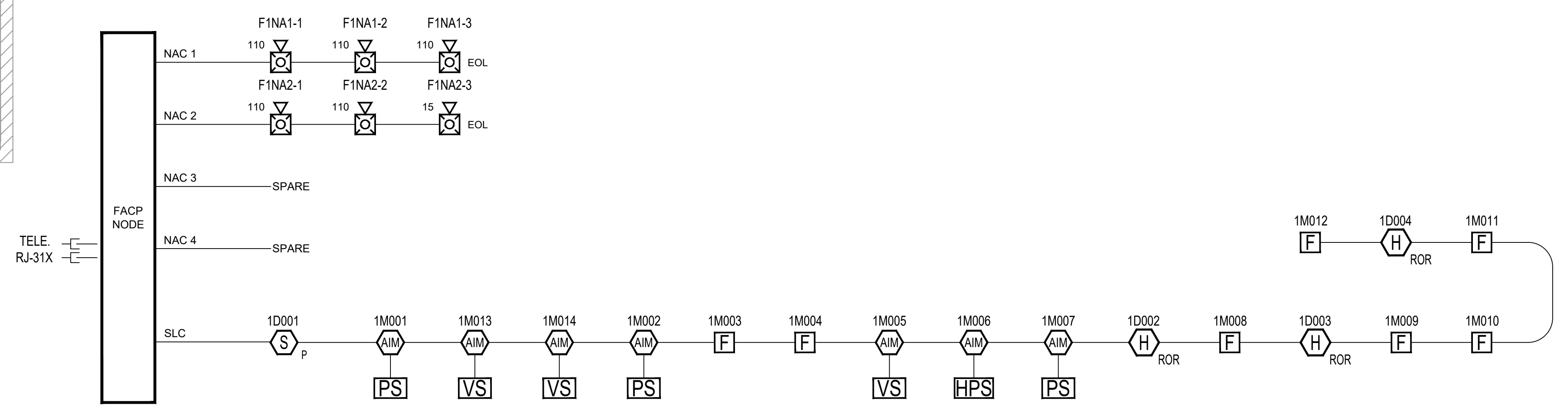

**A** FIRE ALARM RISER DETAILS  
FA-1.4 NOT TO SCALE

NAC CIRCUIT VOLTAGE DROP CALCULATIONS																	
System Voltage		Percentage Over	Wire Gauge	Ohm's per 1000													
SNAC1		19%	18 AWG	4.89													
NAC1				NAC2				NAC3				NAC4					
Device Num.	Device Number	Current	Distance	Drop from source	At device	Drop from source	At device	Drop from source	At device	Drop from source	At device	Drop from source	At device	Drop from source	At device		
1	P2RL-110 L-Series Horn/Stroke Wall Red	0.162	36	19.94	0.456	2.24%	P2RL-15 L-Series Horn/Stroke Wall Red	0.054	369	19.04	1.364	6.69%					
2	P2RL-110 L-Series Horn/Stroke Wall Red	0.162	274	18.64	1.756	9.62%	P2RL-110 L-Series Horn/Stroke Wall Red	0.162	247	18.12	2.217	11.56%					
3	P2RL-110 L-Series Horn/Stroke Wall Red	0.162	388	17.41	2.988	14.65%	P2RL-110 L-Series Horn/Stroke Wall Red	0.162	46	17.98	2.423	11.88%					
Totals		0.486	758		17.41		Totals		0.378	662		17.98					
METHOD Point to Point				METHOD End of Line				METHOD End of Line				METHOD Load Centering					
NAC1		0.486	758	2.99	17.41	14.65%	NAC1		0.486	758	3.60	17.41	17.68%				
NAC2		0.378	662	2.42	17.98	11.88%	NAC2		0.378	662	2.45	17.98	12.00%				
NAC3		0.000	0	0.00	20.40	0.00%	NAC3		0.000	0	0.00	20.40	0.00%				
NAC4		0.000	0	0.00	20.40	0.00%	NAC4		0.000	0	0.00	20.40	0.00%				
NAC1		0.486	758	1.80	17.41	8.63%	NAC1		0.486	758	1.80	17.41	8.63%				
NAC2		0.378	662	1.22	17.98	6.00%	NAC2		0.378	662	1.22	17.98	6.00%				
NAC3		0.000	0	0.00	20.40	0.00%	NAC3		0.000	0	0.00	20.40	0.00%				
NAC4		0.000	0	0.00	20.40	0.00%	NAC4		0.000	0	0.00	20.40	0.00%				

**B** FACP VOLTAGE DROP CALCULATIONS  
FA-1.4 NOT TO SCALE

ES-200X INTELLIGENT ADDRESSABLE FACP W/DACT BATTERY CALCULATION						
SECONDARY POWER SOURCE REQUIREMENTS						
DEVICE TYPE		SECONDARY NON-ALARM CURRENT (AMPS)		SECONDARY ALARM CURRENT (AMPS)		
QTY	CURRENT DRAW	TOTAL	QTY	CURRENT DRAW	TOTAL	
<b>SYSTEM</b>						
MAIN CIRCUIT BOARD	1 X	0.141	=	0.141	1 X	0.257 = 0.257
IPOTS-COM COMMUNICATOR	1 X	0.04	=	0.04	1 X	0.041 = 0.041
<b>ANN-BUS Devices</b>						
ANN-80(V)	1 X	0.015	=	0.015	1 X	0.04 = 0.04
<b>ADDRESSABLE DEVICES</b>						
SD355	1 X	0.0003	=	0.0003		
BG-12LX	7 X	0.0013	=	0.0091		
MMF-300	7 X	0.002	=	0.014		
H355R	3 X	0.0003	=	0.0009		
MAXIMUM ALARM DRAW FOR ALL ADDRESSABLE DEVICES: 0.4						
<b>5. NOTIFICATION APPLIANCES</b>						
NAC 1				1 X	0.486	= 0.486
NAC 2				1 X	0.378	= 0.378
NAC 3				1 X	0	= 0
NAC 4				1 X	0	= 0
<b>TOTAL STANDBY LOAD:</b> 0.22				<b>TOTAL ALARM LOAD:</b> 1.602		
<b>CALCULATION IN TOTALS</b>						
STANDBY LOAD CURRENT		0.22		REQUIRED STANDBY TIME IN HOURS		24
				REQUIRED ALARM TIME IN MINUTES		5
ALARM LOAD CURRENT		1.602		TOTAL CURRENT LOAD		5.415
				MULTIPLY BY THE DERATING FACTOR		1.2 = 1.2
				<b>TOTAL AMPERE HOURS REQUIRED</b>		6.50
RECOMMENDED BATTERIES: 7AH BATT NEEDED						

**C** FACP BATTERY CALCULATIONS  
FA-1.4 NOT TO SCALE

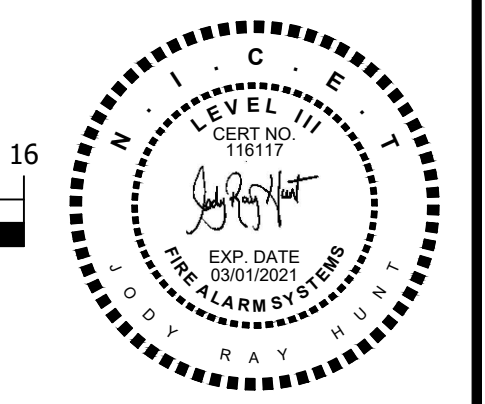
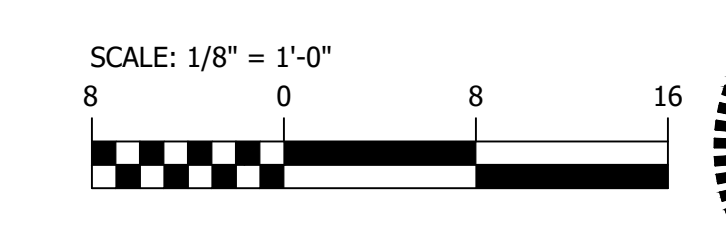

**KRIGEN PHARMA**  
800 EDWARDS BROTHERS DRIVE  
LILLINGTON, NC 27546  
FIRE ALARM SYSTEM

AFA SOUTHEAST, INC.  
SUBSIDIARY OF AFA PROTECTIVE SYSTEMS, INC.  
1135 FOUR LAKES DRIVE  
SUITE G  
MATTHEWS, NC 28105  
704-246-7920

**JRH**  
Fire Design & Consulting  
JRH FIRE DESIGN & CONSULTING, LLC.  
2315 HIGGESTONE ROAD  
CARY, NC 27519  
JRHUNT@JRHFIREDESIGN.COM

**SHOP DRAWINGS**  
PREPARED BY:  
JRH FIRE DESIGN & CONSULTING, INC.  
FROM THE DESIGNED DRAWINGS.

**INSTALLATION BY:**  
AFA SOUTHEAST, INC.  
1135 FOUR LAKES DRIVE, SUITE G  
MATTHEWS, NORTH CAROLINA 28105  
704-246-7920  
TACKINS@AFA.COM

JRH JOB NUM. 19-1151  
REVISION: 0 DATE: 10/29/2019  
INITIAL RELEASE  
REVISION: DATE:  
REVISION: DATE:  
REVISION: DATE:  
REVISION: DATE:  
REVISION: DATE:  
REVISION: DATE:  
REVISION: DATE:  
REVISION: DATE:  
REVISION: DATE:

**DRAWING TITLE:**  
FIRE ALARM FLOOR PLAN  
MEZZ LEVEL & BATTERY  
CALCULATIONS

DRAWN BY: JRH  
SALESMAN: TA  
PROJECT MGR: TA  
DATE: 10/29/2019  
SCALE: AS SHOWN ON DRAWINGS  
SHEET NO. 5 OF 5

**DRAWING NO.**  
**FA1.4**

J:\AFA FOLDER\Design Folder\2018\18-1151 Krigen Pharma\ENGINEERING\IN-HOUSE (SHOP DRAWINGS)\SHOP DRAWINGS\DWG\18-1151-01-FA02.dwg, 11/30/2019 5:46:43 PM

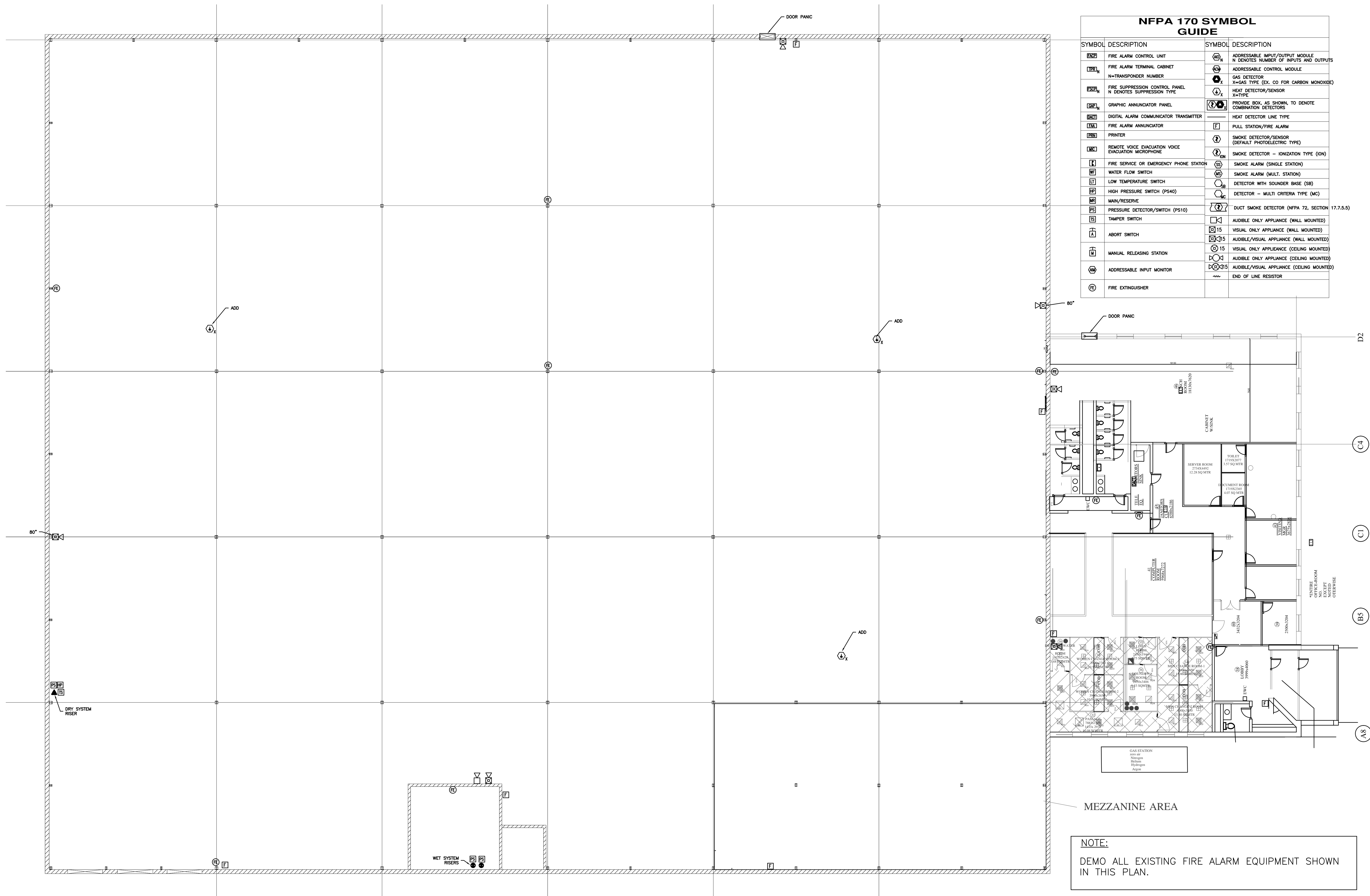

NFPA 170 SYMBOL GUIDE			
SYMBOL	DESCRIPTION	SYMBOL	DESCRIPTION
[FACU]	FIRE ALARM CONTROL UNIT	[AM]	ADDRESSABLE INPUT/OUTPUT MODULE N DENOTES NUMBER OF INPUTS AND OUTPUTS
[FATC]	FIRE ALARM TERMINAL CABINET N=TRANSPONDER NUMBER	[AMC]	ADDRESSABLE CONTROL MODULE
[FSCP]	FIRE SUPPRESSION CONTROL PANEL N DENOTES SUPPRESSION TYPE	[G]	GAS DETECTOR X=GAS TYPE (EX. CO FOR CARBON MONOXIDE)
[GAP]	GRAPHIC ANNUNCIATOR PANEL	[H]	HEAT DETECTOR/SENSOR X=TYPE
[DCA]	DIGITAL ALARM COMMUNICATOR TRANSMITTER	[P]	PROVIDE BOX, AS SHOWN, TO DENOTE COMBINATION DETECTORS
[FAP]	FIRE ALARM ANNUNCIATOR	[HDT]	HEAT DETECTOR LINE TYPE
[P]	PRINTER	[F]	PULL STATION/FIRE ALARM
[RVE]	REMOTE VOICE EVACUATION VOICE EVACUATION MICROPHONE	[S]	SMOKE DETECTOR/SENSOR (DEFAULT PHOTOELECTRIC TYPE)
[FES]	FIRE SERVICE OR EMERGENCY PHONE STATION	[S-I]	SMOKE DETECTOR - IONIZATION TYPE (ION)
[WFS]	WATER FLOW SWITCH	[SA]	SMOKE ALARM (SINGLE STATION)
[LTS]	LOW TEMPERATURE SWITCH	[MS]	SMOKE ALARM (MULT. STATION)
[HPS]	HIGH PRESSURE SWITCH (PS40)	[DWSB]	DETECTOR WITH SOUNDER BASE (SB)
[M/R]	MAIN/RESERVE	[MC]	DETECTOR - MULTI CRITERIA TYPE (MC)
[PDS]	PRESSURE DETECTOR/SWITCH (PS10)	[DSD]	DUCT SMOKE DETECTOR (NFPA 72, SECTION 17.7.5.5)
[TS]	TAMPER SWITCH	[AO]	AUDIBLE ONLY APPLIANCE (WALL MOUNTED)
[AS]	ABORT SWITCH	[AO-15]	VISUAL ONLY APPLIANCE (WALL MOUNTED)
[MRS]	MANUAL RELEASING STATION	[AO-15]	AUDIBLE/VISUAL APPLIANCE (WALL MOUNTED)
[AIM]	ADDRESSABLE INPUT MONITOR	[AO-15]	VISUAL ONLY APPLIANCE (CEILING MOUNTED)
[FE]	FIRE EXTINGUISHER	[AO-15]	AUDIBLE/VISUAL APPLIANCE (CEILING MOUNTED)
		[R]	END OF LINE RESISTOR

**FIRE ALARM - DEMO PLAN**

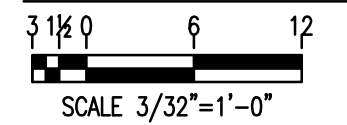

AFA SOUTHEAST, INC.  
 1135 FOUR LAKES DRIVE  
 SUITE G  
 MATTHEWS, NC 28105  
 704-246-7920

Drawing Title	Project No.	Drawn By	Scale	Date
FIRE ALARM DEMO PLAN	19043	AZ.	AS NOTED	10/29/2019

Job:	Owner:
KRIGEN PHARMA 800 EDWARDS BROTHERS DRIVE LILLINGTON, NC 27546	KRIGEN PHARMACEUTICALS 800 EDWARDS BROTHERS DRIVE LILLINGTON, NC 27546