

Building Code Summary

BASED ON THE 2018 NORTH CAROLINA BUILDING CODE

Occupancy Classification Based on Use

SECTION 303.1 - ASSEMBLY GROUP A
 ASSEMBLY GROUP "A" OCCUPANCY INCLUDES AMONG OTHERS, THE USE OF A BUILDING OR STRUCTURE, OR A PORTION THEREOF, FOR THE GATHERING OF PERSONS FOR THE PURPOSES SUCH AS CIVIC, SOCIAL, OR RELIGIOUS FUNCTIONS, RECREATION, FOOD OR DRINK CONSUMPTION OR AWAITING TRANSPORTATION.

SECTION 303.3 - ASSEMBLY GROUP A-2
 GROUP "A-2" OCCUPANCY INCLUDES ASSEMBLY USES INTENDED FOR FOOD AND/OR DRINK CONSUMPTION INCLUDING, BUT NOT LIMITED TO:

TAVERNS & BARS

SECTION 306.3 - LOW-HAZARD FACTORY INDUSTRIAL, GROUP F-2

FACTORY INDUSTRIAL USES THAT INVOLVE THE FABRICATION OR MANUFACTURING OF NONCOMBUSTIBLE MATERIALS THAT DURING FINISHING, PACKING OR PROCESSING DO NOT INVOLVE A SIGNIFICANT FIRE HAZARD SHALL BE CLASSIFIED AS F-2 OCCUPANCIES AND SHALL INCLUDE, BUT NOT LIMITED TO THE FOLLOWING:

BEVERAGES - UP TO AND INCLUDING 16-PERCENT ALCOHOL CONTENT

Building Heights and Areas

SECTION 504.3 - BUILDING HEIGHT (IN FEET)

OCCUPANCY CLASSIFICATION : GROUP "A"

SECTION 504.3 TABLE 504.3 - ALLOWABLE BUILDING HEIGHT IN FEET ABOVE GRADE PLANE

FOR GROUP "A" - NON SPRINKLERED TYPE-VB : 40' MAXIMUM BUILDING HEIGHT

SECTION 903.2 - MINIMUM THRESHOLDS FOR PROTECTION BY AN AUTOMATIC SPRINKLER SYSTEM FOR SPECIFIC OCCUPANCIES.

SECTION 903.2.2 - GROUP "A-2"
 AN AUTOMATIC SPRINKLER SYSTEM SHALL BE PROVIDED FOR FIRE AREAS CONTAINING GROUP "A-2" OCCUPANCIES AND INTERVENING FLOORS OF THE BUILDING WHERE ONE OF THE FOLLOWING CONDITIONS EXISTS:

1. THE FIRE AREA EXCEEDS 5,000 SQ. FT.
2. THE FIRE AREA HAS AN OCCUPANT LOAD OF 300 OR MORE, EXCEPT 100 OR MORE FOR NIGHTCLUBS.
3. THE FIRE AREA IS LOCATED ON A FLOOR OTHER THAN A LEVEL OF EXIT DISCHARGE SERVING SUCH OCCUPANCIES.

NOTE: OUR PROJECT DOES NOT MEET ANY OF THE ABOVE CONDITIONS THEREFORE FIRE SPRINKLERS ARE NOT REQUIRED

SECTION 506.2 - BUILDING AREA

OCCUPANCY CLASSIFICATION : GROUP "A" - TYPE "V-B"

SECTION 506.2 TABLE 506.2 - ALLOWABLE AREA IN SQUARE FEET

FOR AN "A-2" OCCUPANCY, TYPE "V-B" -NO SPRINKLERED BUILDING: MAXIMUM BUILDING AREA OF 6,000 SQ. FT.

NOTE: THE EXISTING BUILDING AREA (3,622 sq. ft.) IS LESS THAN THE MAXIMUM SQUARE FOOTAGE NOTED ABOVE

OCCUPANCY CLASSIFICATION : GROUP "F"

SECTION 504.3 TABLE 504.3 - ALLOWABLE BUILDING HEIGHT IN FEET ABOVE GRADE PLANE

FOR GROUP "F" - NON SPRINKLERED TYPE-VB : 40' MAXIMUM BUILDING HEIGHT

SECTION 903.2 - MINIMUM THRESHOLDS FOR PROTECTION BY AN AUTOMATIC SPRINKLER SYSTEM FOR SPECIFIC OCCUPANCIES.

SECTION 903.2.2 - GROUP "F-2"
 NOTE: THERE ARE NO REQUIREMENTS FOR REQUIRING AN AUTOMATIC SPRINKLER SYSTEM FOR AN "F-2" OCCUPANCY.

SECTION 506.2 - BUILDING AREA

OCCUPANCY CLASSIFICATION : GROUP "F" - TYPE "V-B"

SECTION 506.2 TABLE 506.2 - ALLOWABLE AREA IN SQUARE FEET

FOR AN "F-2" OCCUPANCY, TYPE "V-B" -NO SPRINKLERED BUILDING: MAXIMUM BUILDING AREA OF 13,000 SQ. FT.

NOTE: THE EXISTING BUILDING AREA (3,622 sq. ft.) IS LESS THAN THE MAXIMUM SQUARE FOOTAGE NOTED ABOVE

Types of Construction

SECTION 601 - FIRE-RESISTANCE RATING REQUIREMENTS FOR BUILDING ELEMENTS (HOURS)

TYPE V-B REQUIRES NO FIRE-RESISTANCE RATING REQUIREMENTS FOR ALL BUILDING ELEMENTS NOTED WITHIN CHART

SECTION 602 - FIRE-RESISTANCE RATING REQUIRED FOR EXTERIOR WALLS BASED ON FIRE SEPARATION DISTANCE.

FIRE SEPARATION DISTANCE: < 5 FEET FOR ALL TYPES OF CONSTRUCTION, GROUP "A-2": MINIMUM 1 HOUR REQUIRED

Means of Egress

SECTION 1004 - OCCUPANT LOAD

SECTION 1004.12 - AREAS WITHOUT FIXED SEATING

THE NUMBER OF OCCUPANTS SHALL BE COMPUTED AT A RATE OF ONE OCCUPANT PER UNIT OF AREA AS PRESCRIBED IN TABLE 1004.12.

PER TABLE 1004.12 - ASSEMBLY WITHOUT FIXED SEATS - UNCONCENTRATED (TABLE 4 CHAIRS) THE OCCUPANT LOAD FACTOR IS 15 SQ. FT. PER OCCUPANT (NET). REFER TO OCCUPANCY BREAKDOWN FOR TOTAL OCCUPANTS

Egress Based on Occupant Load and Common Path of Egress Travel Distance

Tavern/Bar Area

SECTION 1006.2.1 - TWO EXIST OR EXIT ACCESS DOORWAYS FROM ANY SPACE SHALL BE PROVIDED WHERE THE DESIGN OCCUPANT LOAD OR THE COMMON PATH OF EGRESS TRAVEL DISTANCE EXCEEDS THE VALUES LISTED IN TABLE 1006.2.1

TABLE 1006.2.1 - SPACES WITH ONE EXIT OR EXIT ACCESS DOORWAY

OCCUPANCY - GROUP "A", MAXIMUM 49 OCCUPANTS - (NON SPRINKLERED) WHEN MAXIMUM OCCUPANT LOAD IS >= 30 w/ A MAXIMUM TRAVEL DISTANCE OF 75 FEET.

NOTE: THIS PROJECT OCCUPANCY IS GREATER THAN 49 OCCUPANTS THEREFORE (2) EXITS ARE REQUIRED AND A MAXIMUM COMMON PATH OF EGRESS TRAVEL DISTANCE SHALL NOT EXCEED 75 FEET.

Brewery Area

SECTION 1006.2.1 - TWO EXIST OR EXIT ACCESS DOORWAYS FROM ANY SPACE SHALL BE PROVIDED WHERE THE DESIGN OCCUPANT LOAD OR THE COMMON PATH OF EGRESS TRAVEL DISTANCE EXCEEDS THE VALUES LISTED IN TABLE 1006.2.1

TABLE 1006.2.1 - SPACES WITH ONE EXIT OR EXIT ACCESS DOORWAY

OCCUPANCY - GROUP "F", MAXIMUM 49 OCCUPANTS - (NON SPRINKLERED) WHEN MAXIMUM OCCUPANT LOAD IS <= 30 w/ A MAXIMUM TRAVEL DISTANCE OF 75 FEET.

NOTE: THIS PROJECT OCCUPANCY IS EQUAL TO OR LESS THAN 49 OCCUPANTS THEREFORE A MINIMUM OF ONE EXIT WILL BE REQUIRED AND A MAXIMUM COMMON PATH OF EGRESS TRAVEL DISTANCE SHALL NOT EXCEED 75 FEET.

Building Code Summary

(cont.)

Exit Signs

SECTION 1031 - EXIT SIGNS

EXITS AND EXIT ACCESS DOORS SHALL BE MARKED BY AN APPROVED EXIT SIGN READILY VISIBLE FROM ANY DIRECTION OF EGRESS TRAVEL. THE PATH OF EGRESS TRAVEL TO EXITS AND WITHIN EXITS SHALL BE MARKED BY READILY VISIBLE EXIT SIGNS TO CLEARLY INDICATE THE DIRECTION OF EGRESS TRAVEL IN CASES WHERE THE EXIT OR PATH OF EGRESS TRAVEL IS NOT IMMEDIATELY VISIBLE TO THE OCCUPANTS.

EXCEPTIONS:

THE MAIN EXTERIOR EXIT DOORS OR GATES THAT ARE OBVIOUSLY AND CLEARLY IDENTIFIABLE AS EXITS NEED NOT HAVE EXIT SIGNS WHERE APPROVED BY THE BUILDING OFFICIAL.

SECTION 1033 - ILLUMINATION

EXIT SIGNS SHALL BE INTERNALLY OR EXTERNALLY ILLUMINATED.

EXCEPTIONS:

TACTILE SIGNS REQUIRED BY SECTION 1034 NEED NOT BE PROVIDED WITH ILLUMINATION

SECTION 1034 - ILLUMINATION

A SIGN STATING "EXIT" IN VISUAL CHARACTERS, RAISED CHARACTERS AND BRAILLE AND COMPLYING WITH ICC A117 SHALL BE PROVIDED ADJACENT TO EACH DOOR TO AN AREA OF REFUGE, AN EXTERIOR AREA FOR ASSISTED RESCUE, AN EXIT STAIRWAY OR RAMP, AN EXIT PASSAGEWAY AND THE EXIT DISCHARGE.

Occupancy Breakdown

Occupancy of Space (Lounge Area)

Room Names:	Area:	Occupancy Factor	No. of Occupants	Total Occupants
LOUNGE AREA	1038 sq. ft.	15 sq. ft. PER OCCUPANT	69 OCCUPANTS	= 89 OCCUPANTS
PRIVATE TASTING	262 sq. ft.	15 sq. ft. PER OCCUPANT	11 OCCUPANTS	
SERVICE AREA	110 sq. ft.	200 sq. ft. PER OCCUPANT	1 OCCUPANT	
STORAGE	114 sq. ft.	300 sq. ft. PER OCCUPANT	1 OCCUPANT	
WALK IN COOLER	200 sq. ft.	300 sq. ft. PER OCCUPANT	1 OCCUPANT	
HALL	72 sq. ft.	NOT USED FOR OCCUPANCY LOAD	-	
MEN'S RESTROOM	164 sq. ft.	NOT USED FOR OCCUPANCY LOAD	-	
WOMEN'S RESTROOM	175 sq. ft.	NOT USED FOR OCCUPANCY LOAD	-	
2nd EXIT RAMP	169 sq. ft.	NOT USED FOR OCCUPANCY LOAD	-	
TOTAL SQ. FT.	2200 sq. ft.			

Occupancy of Space (Brewery Area)

Room Names:	Area:	Occupancy Factor	No. of Occupants	Total Occupants
BREWMASTER OFFICE	245 sq. ft.	100 sq. ft. PER OCCUPANT	3 OCCUPANTS	= 7 OCCUPANTS
BREWING AREA	638 sq. ft.	200 sq. ft. PER OCCUPANT	4 OCCUPANT	
TOTAL SQ. FT.	943 sq. ft.			

TOTAL BUILDING AREA: 2200 + 943 + 219 sq. ft. OF EXTERIOR + INTERIOR WALL FRAMING = 3,362 sq. ft. WALL

Plumbing Fixture Required

Table 403.1
 Group "A-2" Occupancy - BASED ON 89 OCCUPANTS (50 MEN + 40 WOMEN)
 (INCLUDING FUTURE EXPANSION AND INCREASED OCCUPANT LOAD)

Water Closets	Lavatories	Drinking Fountain	Other
1 PER 40 OCCUPANTS FOR BOTH MEN & WOMEN	1 PER 15 OCCUPANTS FOR BOTH MEN & WOMEN	1 PER 500 OCCUPANTS	1 SERVICE SINK
REQUIRED MENS: 2	REQUIRED MENS: 2	1 REQUIRED	1 REQUIRED
REQUIRED WOMENS: 2	REQUIRED WOMENS: 2		

Table 403.1
 Group "F-2" Occupancy - BASED ON 6 OCCUPANTS (3 MEN + 3 WOMEN)

Water Closets	Lavatories	Drinking Fountain	Other
1 PER 100 OCCUPANTS FOR BOTH MEN & WOMEN	1 PER 100 OCCUPANTS FOR BOTH MEN & WOMEN	1 PER 400 OCCUPANTS	1 SERVICE SINK
REQUIRED MENS: 1	REQUIRED MENS: 1	1 REQUIRED	1 REQUIRED
REQUIRED WOMENS: 1	REQUIRED WOMENS: 1		

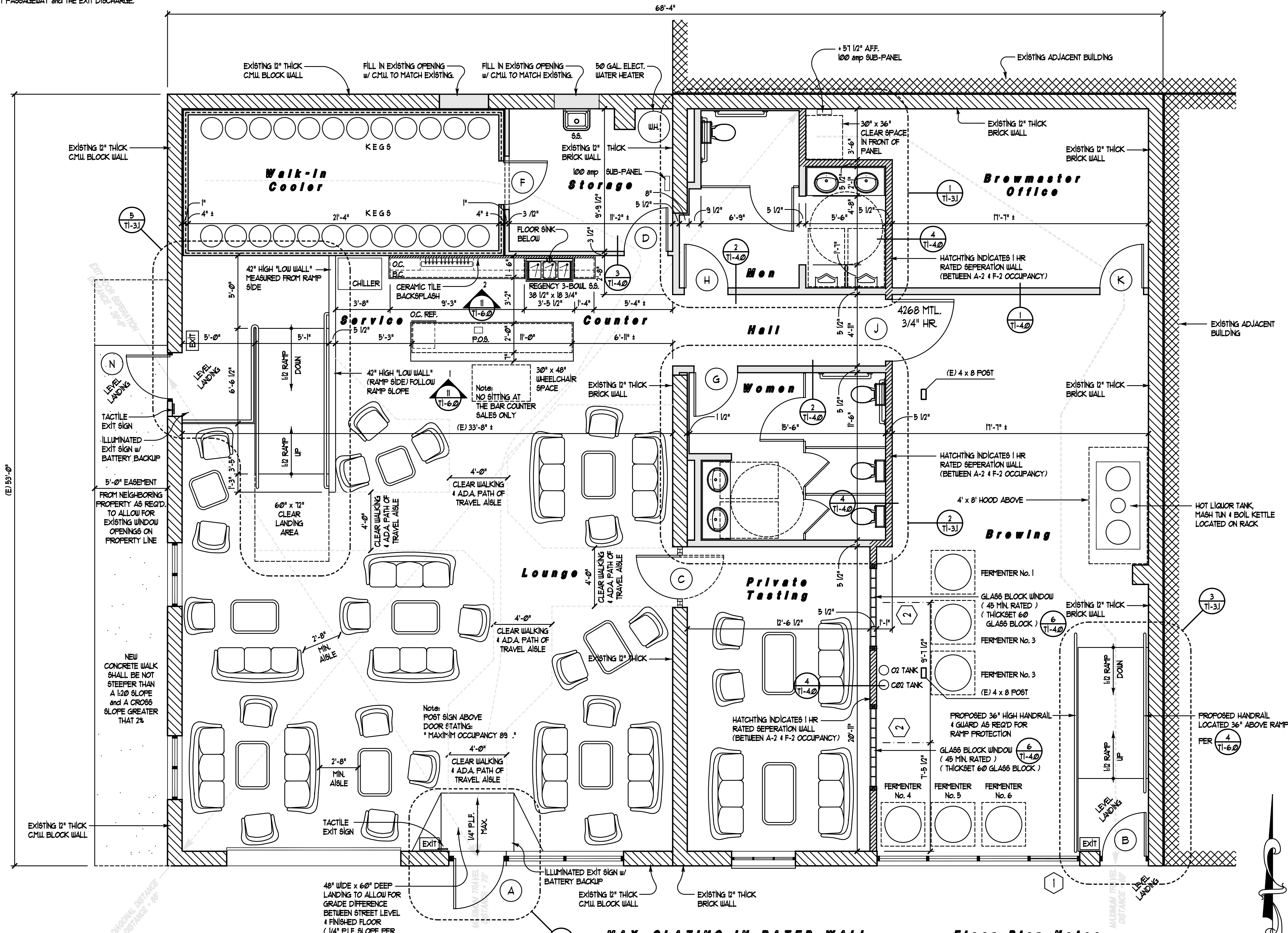

MAX. GLAZING IN RATED WALL

1. FOR 1-HOUR FIRE PARTITIONS, SMOKE BARRIERS, INCIDENTAL USE AREAS AND MIXED OCCUPANCY SEPARATIONS, 45-MINUTE FIRE PROTECTION WINDOWS ARE ALLOWED AS LONG AS THEY ARE LIMITED TO 25% OF THE COMMON WALL PER SECTION 716.6.12 N.C.B.C.

WALL AREA = 22' x 11' = 242 sq. ft. MAX. WINDOW AREA: 220 sq. ft. x 0.25 = 60 sq. ft.
 PROPOSED GLASS BLOCK WINDOW = 5'-4" x 5'-4" + 285 sq. ft. x 2 = 57 sq. ft. < 60 sq. ft. = OK

Floor Plan Notes:

1. REFER TO A.D.A. GENERAL NOTE SHEETS FOR SPECIFIC A.D.A. REQUIREMENTS FOR ACCESS FROM PUBLIC WAY, DOOR THRESHOLDS, DOOR WIDTHS, TOILET ROOMS, DRINKING FOUNTAINS, ETC.
2. THE PROPOSED TENANT IMPROVEMENT SHALL BE IN FULL COMPLIANCE WITH THE CITY OF LILLINGTON COMMUNITY DEVELOPMENT DEPARTMENT.
3. OPTIONAL: 2 x 4 STUDS MAY BE USED IN LIEU OF 2 x 6 STUDS AS DIMENSIONED ON THE PLAN.

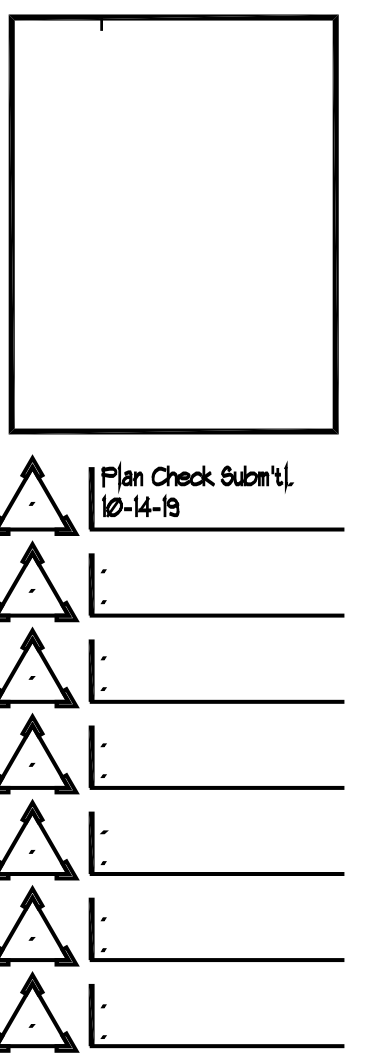

Plan Check Submittal 10-14-19

Abacus design group
 Building Design
 Architecture/Interiors
 Trade Improvements
 Building Permits
 Building Walls
 AN ASSOCIATE MEMBER TO THE
 AMERICAN INSTITUTE OF ARCHITECTS
 (867) 702-0214

3818 E. Foxman Hill Road
 Concord, NC 28024

TENANT IMPROVEMENT FOR:
Belleau Wood Brewery Company
 6 West Fox Street
 Lillington, NC 28666

DATE: 10-14-19
 DESIGNER:
 DRAWN/CHECKED:
 J.P.
 JOB NUMBER: 19005

Permit No.
BLD19-00374

10/09/2019 14:02 190050001.dwg
FLOOR PLAN
 TENANT SPACE sq. ft. 3,622 sq. ft.

TI-3.0