



Standard Document

Quote: PR71633

Date Issued: 01/08/2024

Regional Foundations Solutions

721 E. Gannon Ave

Zebulon, NC 27597

F (919) 269-6788

Prepared for:

Kristie McLean

hairmonkey255@gmail.com

M (919) 669-8495

L (919) 390-9431

Job Location:

255 Old Mill Road

Fuquay Varina, NC 27526

Prepared by:

Traver Jackson

Design Specialist

W (919) 437-9613

M (919) 437-9613

Project Overview

Proposal Summary

Total Investment	\$21,088.49
Same Day Savings	(\$2,108.85)
Total Contract Price	\$18,979.64
Deposit Required	\$5,693.89
Deposit Paid	\$5,700.00
Amount Due Upon Installation	\$13,279.64

Customer Consent

Any alteration from the above specifications and corresponding price adjustment (if necessary) will be made only at the Customer's request or approval. Completing the work in this Proposal at the time scheduled is contingent upon accidents or delays beyond our control. This Proposal is based primarily on the Customer's description of the problem. Engineering services are used as required by companies such as SFA Engineering and StoneWall Engineering. This Proposal may be withdrawn if not accepted by the Customer within 20 days.



1/8/2024

Company Signature

Date

Acceptance of Contract— I am/we are aware of and agree to the contents of this Proposal, the attached Job Detail sheet(s), and the attached Limited Warranty, (together, the "Contract"). I am/ we are aware of and agree to the 60 day window that Regional has to remedy any service issues that are covered under the attached Limited Warranty. I will have bio-hazards cleaned and remediated that Regional may discover in the affected work area. This includes plumbing/sewage leaks, and any other hazards at my cost. I will provide documentation from a restoration company. You are authorized to do the work as specified in the Contract. However, field adjustments may be made if deemed vital by project Foreman or Production Manager. I/we will make the payment to crew the day project is completed.



1/8/2024

Customer Signature

Date

My Project

Qty Product Name

Basement: Keep Whole Basement Dry

1 Permit Fee,
Obtain proper building permit.

1 Fuel Surcharge, Surcharge

147 CleanSpace Wall System
Install CleanSpace Wall System on walls as shown on drawing. Wall System is mechanically fastened to the walls.

165 SafeDrain, Basement Waterproofing
Install multi flow drain below the slab of concrete and backfilled with stone. Water diffuser on top of stone and re-cement floor

1 Pump: Triple Safe ,
Install a triple safe pump system, which includes 1/3 hp pump, 1/2 hp pump, ultra sump battery back up, twin canister, waterwatch alarm, clean stand and two 15' discharge lines.

1 Electrical Circuit 20amp circuit, Electric
Install 1 electric circuit and 2 outlets with GFI protection.

65 Exterior Discharge Line ,
Extend exterior discharge line as indicated on proposal.

6 Interior PVC Discharge Extension ,
Install 1.5 inch pvc plumbing from sump pump to location of the discharge line.

Total Investment	\$21,088.49
Same Day Savings	(\$2,108.85)
Total Contract Price	\$18,979.64

Product Specifications

Permit Fee,

Obtain proper building permit.

CleanSpace Wall System

Install CleanSpace Wall System on walls as shown on drawing. Wall System is mechanically fastened to the walls.

SafeDrain, Basement Waterproofing

Install multi flow drain below the slab of concrete and backfilled with stone. Water diffuser on top of stone and re-cement floor

Pump: Triple Safe ,

Install a triple safe pump system, which includes 1/3 hp pump, 1/2 hp pump, ultra sump battery back up, twin canister, waterwatch alarm, clean stand and two 15' discharge lines.

Electrical Circuit 20amp circuit, Electric

Install 1 electric circuit and 2 outlets with GFI protection.

Exterior Discharge Line ,

Extend exterior discharge line as indicated on proposal.

Interior PVC Discharge Extension ,

Install 1.5 inch pvc plumbing from sump pump to location of the discharge line.

Drawing

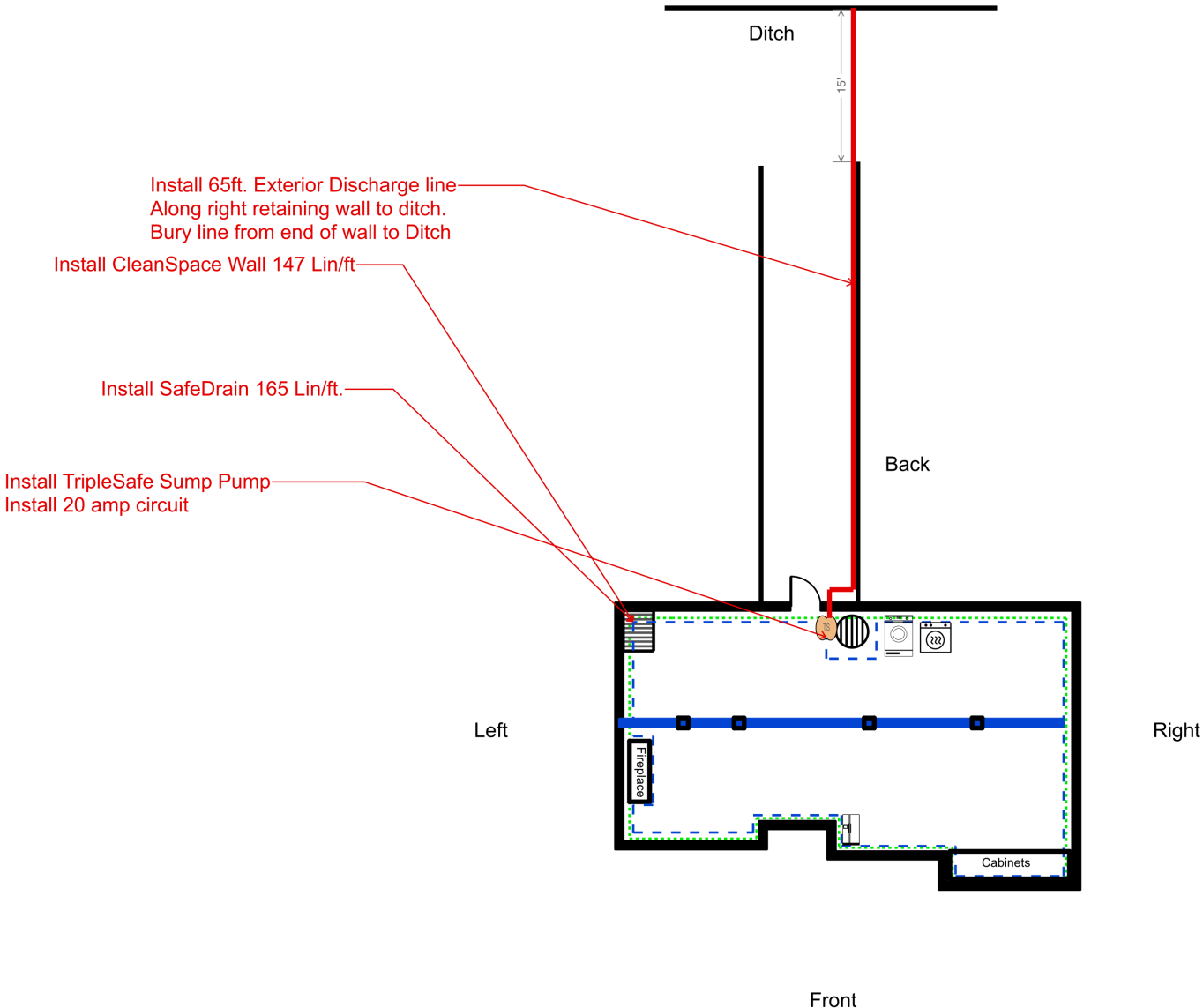

Job Details

Contractor Will

1. Permit Project.
2. Remove and replace excavated soils. Customer is responsible for final landscaping (pavers, plants, re-seeding, mulch, retaining walls, etc)
3. Remove and replace concrete as necessary in the workplace.
4. Contact utility locator service

Customer Will

1. Move items at least 10 feet away from the work area.
2. Remove finished walls, cabinets/shelving, and or flooring.
3. Make Regional aware of any open permits on the property work is being performed.
4. Mark any private lines that may be hidden underground, and assumes all liability if damage should occur to such lines.
5. Make payment of remaining balance to foreman of crew the same day installation is complete.