



Town of Erwin

Zoning Application & Permit

Planning & Inspections Department

Permit #
24-0101

Rev Jan2013

Each application should be submitted with an attached plot/site plan with the proposed use/structure showing lot shape, existing and proposed buildings, parking and loading areas, access drives and front, rear, and side yard dimensions.

Name of Applicant	BRS Field Ops, LLC	Property Owner	Antonio Johnny
Home Address	1403 N Research Way	Home Address	67 James Allen Ln
City, State, Zip	Orem, UT 84097	City, State, Zip	Dunn, North Carolina, 28334
Telephone	385-482-0045	Telephone	415-941-9964
Email	permitting.department@blueravensolar.com	Email	Antoniojjohnny@gmail.com

Address of Proposed Property	67 James Allen Ln, Dunn, North Carolina, 28334		
Parcel Identification Number(s) (PIN)	0596-94-5908.000	Estimated Project Cost	4,547.09
What is the applicant requesting to build / what is the proposed use of the subject property? Be specific.	5.04	kW PV Solar Panel Installation on Roof Single Family Residential	
Description of any proposed improvements to the building or property	INSTALLATION OF UTILITY INTERACTIVE PHOTOVOLTAIC SOLAR SYSTEM AND ANY NECESSARY ADDITIONAL WORK NEEDED FOR INSTALLATION.		
What was the Previous Use of the subject property?	Single Family Residential		
Does the Property Access DOT road?			
Number of dwelling / structures on the property already			
Property / Parcel Size			
MUST circle one that applies to property	Existing/Proposed Septic System		Or
	Existing/Proposed County/City Sewer		<input checked="" type="checkbox"/>

Owner/Applicant Must Read and Sign

The undersigned property owner, or duly authorized agent/representative thereof certifies that this application and the forgoing answers, statements, and other information herewith submitted are in all respects true and correct to the best of their knowledge and belief. The undersigning party understands that any incorrect information submitted may result in the revocation of this application. Upon issuance of this permit, the undersigning party agrees to conform to all applicable town ordinances, zoning regulations, and the laws of the State of North Carolina regulating such work and to the specifications of plans herein submitted. The undersigning party authorizes the Town of Erwin to review this request and conduct a site inspection to ensure compliance to this application as approved.

Bryson Taylor	<i>Bryson Taylor</i>	Permitting Coordinator	01 / 19 / 2024
Print Name	Signature of Owner or Representative		Date

For Office Use

Zoning District	MD	Existing Nonconforming Uses or Features	NA
Front Yard Setback	NA	Other Permits Required	<input type="checkbox"/> Conditional Use <input type="checkbox"/> Building <input type="checkbox"/> Fire Marshal <input checked="" type="checkbox"/> Other
Side Yard Setback	NA	Zoning Permit Status	<input checked="" type="checkbox"/> Approved <input type="checkbox"/> Denied
Rear Yard Setback	NA	Fee Paid: 20.00	Date Paid: Staff Initials:

Comments	Electrical permit is required from Harnett County
----------	---

Signature of Town Representative: <i>[Signature]</i>	Date Approved/Denied: 1/19/24
--	-------------------------------

• roof solar panels being installed

RESIDENTIAL ROOFTOP SOLAR PERMIT PACKAGE



Enphase
Platinum
Installer



SUNPOWER*
Authorized Installer

Antonio Johnny

67 James Allen Ln
Dunn, North Carolina 28334
415-941-9964



NABCEP
CERTIFIED
PV Installation
Professional
Scott Gurney
#PV-011719-015866

SCOPE OF WORK

INSTALLATION OF ROOFTOP MOUNTED
PHOTOVOLTAIC SOLAR SYSTEM

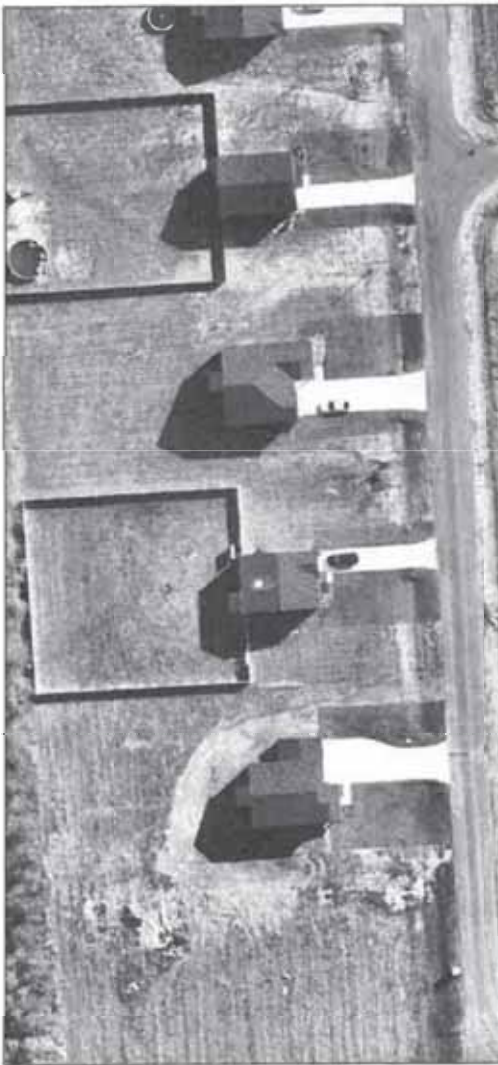

SHEET INDEX

- PV1 COVER SHEET
- PV2 SITE PLAN
- PV3 ROOF PLAN
- PV4 STRUCTURAL
- PV5 ELECTRICAL 3-LINE
- PV6 ELECTRICAL CALCULATIONS
- PV7 LABELS
- PV8 PLACARD
- SS SPEC SHEETS

TYPICAL STRUCTURAL INFORMATION

ROOF MATERIAL: Comp Shingle
SHEATHING TYPE: OSB
FRAMING TYPE: Manufactured Truss
RACKING TYPE: UNIRAC SFM INFINITY
ATTACHMENT TYPE: UNIRAC SFM INFINITY FLASHKIT
TOTAL ATTACHMENTS: 21

INFORMATION FOR INSTALLER

ECOBEES QTY: 0
LED LIGHTBULB QTY: 0

GENERAL NOTES

NEW PV SYSTEM INFORMATION

AC SYSTEM SIZE: 3.78 kW AC
DC SYSTEM SIZE: 5.04 kW DC
MODULE TYPE: (12) REC Solar REC420AA Pure-R
INVERTER TYPE: Enphase IQ7X-96-2-US

Sealed For
Existing Roof &
Attachment Only

ISSUED
FORM NO. 0408



AHJ
Harnett County
Digitally signed
by John A.
Calvert

UTILITY COMPANY
Duke Energy NC
Date: 2023.12.11
12:28:18 -07'00'

TOTAL DC SYSTEM SIZE

5.04 kW DC

TOTAL AC SYSTEM SIZE

3.78 kW AC

DESIGN CRITERIA

WIND SPEED: 119
WIND EXPOSURE FACTOR: C
RISK CATEGORY: II
GROUND SNOW LOAD: 10
ROOF SNOW LOAD: 7
SEISMIC DESIGN CATEGORY: B

WEATHER STATION DATA

WEATHER STATION: SEYMOUR-JOHNSON AFB
HIGH TEMP 2% AVG: 35°C
EXTREME MINIMUM TEMP: -10°C

APPLICABLE CODES

*2017 NATIONAL ELECTRIC CODE (NEC)
**2018 NORTH CAROLINA BUILDING CODE (NCBC)
**2018 NORTH CAROLINA RESIDENTIAL CODE (NCRC), PLUMBING CODE
(NCPCL), AND ALL STATE AND LOCAL BUILDING, ELECTRICAL AND PLUMBING
CODES

BLUE RAVEN
SOLAR

1403 N 630 E
Orem, Utah 84097
(800) 377-4480
BlueRavenSolar.com

Antonio Johnny
67 James Allen Ln
Dunn, North Carolina 28334

Harnett County
Duke Energy NC

CUSTOMER NAME:
PROJECT ID:
898102

DC SYSTEM SIZE:
5.04 kW DC

AC SYSTEM SIZE:
3.78 kW AC

REVISIONS:

DATE: / /
BY: / /
CHECKED BY: / /
APPROVED BY: / /

DESIGNED BY:
Brendan Filmore
PROJECT DATE:
December 9, 2023
DRAWING TITLE:
Cover Sheet

DRAWING NUMBER:
PV1



BLUE RAVEN
SOLAR

1403 N 630 E
Orem, Utah 84097
(800) 377-4480
BlueRavenSolar.com

CUSTOMER NAME: Antonio Johnny

PROJECT ID: 898102

DC SYSTEM SIZE: 5.04 kW DC

AC SYSTEM SIZE: 3.78 kW AC

REVISIONS:

DATE: December 9, 2023

DRAWING TITLE: Site Plan

DRAWING NUMBER: PV2

PROPERTY COMPANY: Duke Energy NC

CITY: Hamett County

ADDRESS: 67 James Allen Ln
Dunn, North Carolina 28334

DATE: December 9, 2023

DRAWING TITLE: Site Plan

DRAWING NUMBER: PV2

PROPERTY COMPANY: Duke Energy NC

CITY: Hamett County

ADDRESS: 67 James Allen Ln
Dunn, North Carolina 28334

DATE: December 9, 2023

DRAWING TITLE: Site Plan

DRAWING NUMBER: PV2

PROPERTY COMPANY: Duke Energy NC

CITY: Hamett County

ADDRESS: 67 James Allen Ln
Dunn, North Carolina 28334

DATE: December 9, 2023

DRAWING TITLE: Site Plan

DRAWING NUMBER: PV2

PROPERTY COMPANY: Duke Energy NC

CITY: Hamett County

ADDRESS: 67 James Allen Ln
Dunn, North Carolina 28334

DATE: December 9, 2023

DRAWING TITLE: Site Plan

DRAWING NUMBER: PV2

PROPERTY COMPANY: Duke Energy NC

CITY: Hamett County

ADDRESS: 67 James Allen Ln
Dunn, North Carolina 28334

DATE: December 9, 2023

DRAWING TITLE: Site Plan

DRAWING NUMBER: PV2

PROPERTY COMPANY: Duke Energy NC

CITY: Hamett County

ADDRESS: 67 James Allen Ln
Dunn, North Carolina 28334

DATE: December 9, 2023

DRAWING TITLE: Site Plan

DRAWING NUMBER: PV2

PROPERTY COMPANY: Duke Energy NC

CITY: Hamett County

ADDRESS: 67 James Allen Ln
Dunn, North Carolina 28334

DATE: December 9, 2023

DRAWING TITLE: Site Plan

DRAWING NUMBER: PV2

PROPERTY COMPANY: Duke Energy NC

CITY: Hamett County

ADDRESS: 67 James Allen Ln
Dunn, North Carolina 28334

DATE: December 9, 2023

DRAWING TITLE: Site Plan

DRAWING NUMBER: PV2

PROPERTY COMPANY: Duke Energy NC

CITY: Hamett County

ADDRESS: 67 James Allen Ln
Dunn, North Carolina 28334

DATE: December 9, 2023

DRAWING TITLE: Site Plan

DRAWING NUMBER: PV2

PROPERTY COMPANY: Duke Energy NC

CITY: Hamett County

ADDRESS: 67 James Allen Ln
Dunn, North Carolina 28334

DATE: December 9, 2023

DRAWING TITLE: Site Plan

DRAWING NUMBER: PV2

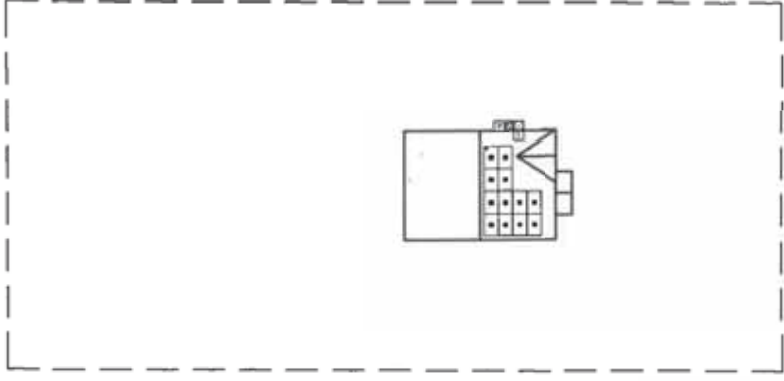

FRONT OF HOME
67 James Allen Ln

Sealed For
Existing Roof &
Attachment Only



REVISED:
DATE: 12/09/23

SITE PLAN
SCALE: 1/32" = 1'-0"

LEGEND

- ROOF TOP JUNCTION BOX
- UTILITY METER
- MAIN SERVICE PANEL
- SUB SUBPANEL
- BREAKER ENCLOSURE
- AC DISCONNECT
- PV PRODUCTION METER
- COMBINER BOX
- GENERATOR ATS PANEL
- UTILITY METER CT CABINET
- SUNPOWER HUB+
- SUNVAULT ESS
- REMOTE POWER OFF SWITCH
- FIRE SETBACK HATCH
- TRENCH OR OVERHEAD
- PROPERTY LINE
- NEW PV SYSTEM

PV SYSTEM SPECIFICATIONS

NEW PV SYSTEM INFORMATION
PV MODULE: (12) REC Solar REC-420AA Pure-R, POWER RATING: 420 W
MICROINVERTER: Enphase IQ7X-96-2-US, POWER RATING: 315 W

COMPASS





BLUE RAVEN
SOLAR

1403 N 430 E
Orem, Utah 84097
(800) 377-4480
BlueRavenSolar.com

Antonio Johnny
67 James Allen Ln
Dunn, North Carolina 28334
Harnett County
Duke Energy NC

PROJECT ID: **898102**
DC SYSTEM SIZE: 5.04 kW DC
AC SYSTEM SIZE: 3.78 kW AC

DRAWN BY: Brandon Filmore
PLOT DATE: December 9, 2023
DRAWING TITLE: Roof Plan
DRAWING NUMBER: **PV3**

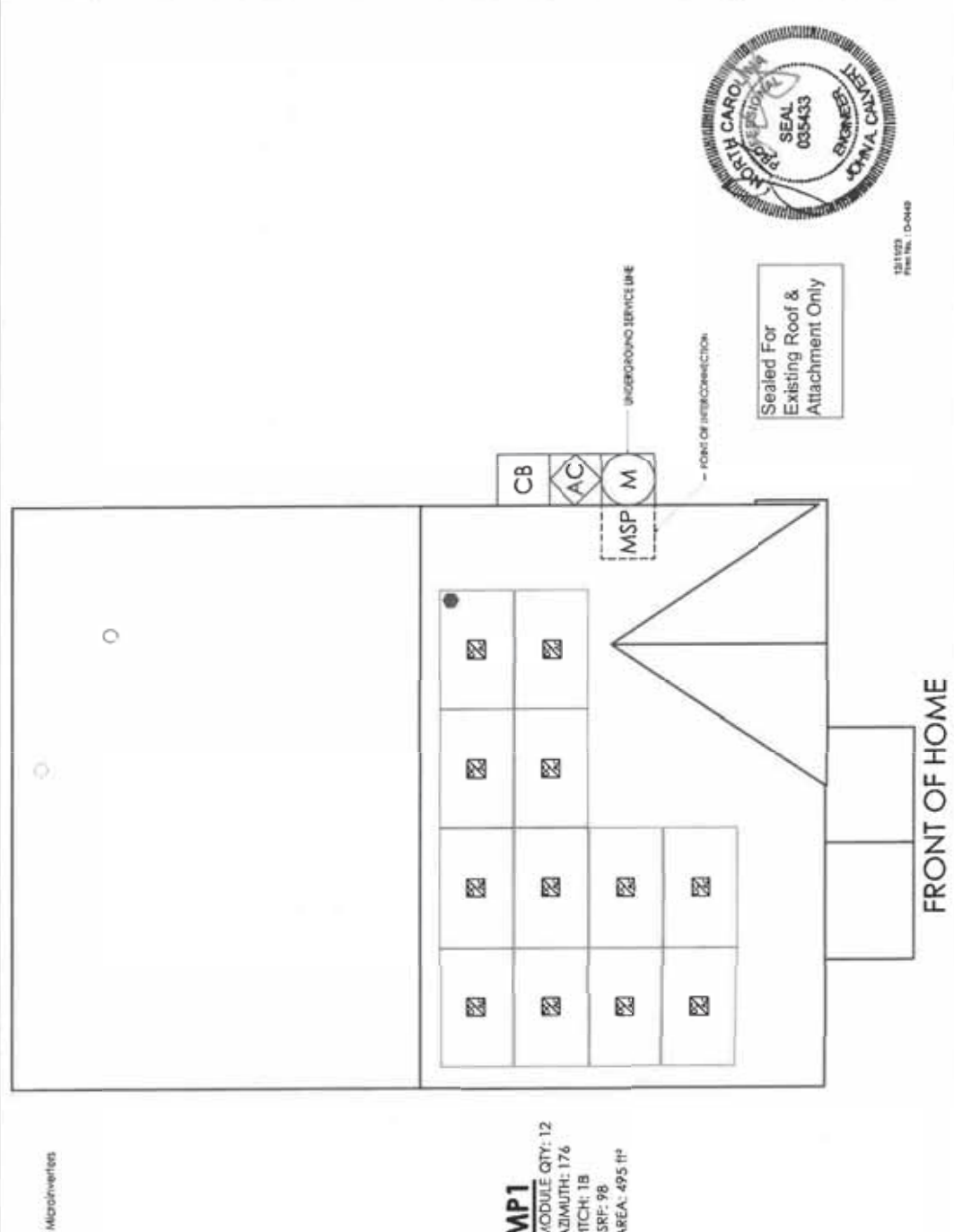

PV SYSTEM SPECIFICATIONS
NEW PV SYSTEM INFORMATION
PV MODULE: (12) REC Solar REC-420AA Pure-R, POWER RATING: 420 W
MICROINVERTER: Enphase IQ7X-96-2-US, POWER RATING: 31.5 W



MP1
MODULE QTY: 12
AZIMUTH: 176
PITCH: 18
TSRF: 98
AREA: 495 ft²

DC SYSTEM SITE: 5.04 kW DC, MODULE: REC 420 INVERTER(S): Enphase IQ7X Microinverters

Sealed For Existing Roof & Attachment Only

POINT OF INTERSECTION

UNDERGROUND SERVICE LINE

121123
Rev. No. 1.0-049

ROOF PLAN
SCALE: 3/16" = 1'-0"

LEGEND	
	ROOF TOP JUNCTION BOX
	UTILITY METER
	MAIN SERVICE PANEL
	SUB SUBPANEL
	BREAKER ENCLOSURE
	AC DISCONNECT
	PV PRODUCTION METER
	COMBINER BOX
	GENERATOR ATS PANEL
	UTILITY METER CT CABINET
	HUB
	SUNPOWER HUB+
	ESS
	REMOTE POWER OFF SWITCH
	FIRE SETBACK HATCH
	TRENCH OR OVERHEAD
	PROPERTY LINE
	NEW PV SYSTEM

FAMIL COUNT	ADJUTH (PRG)	PRCH (PRG)	DEAT (N)	ATA (PP)	ROOF MATERIAL	SHADING TYPE	FRAMING TYPE	FRAMING SIZE AND SPACING	CEILING JOIST/ AND SPACING	BACKING TYPE	ATTACHMENT TYPE	MAXIMUM ATTACHMENT SPACING (D)	MAXIMUM CABLE/CLIP SPACING (C)	TOTAL PV AREA (SQ FT)	TOTAL ROOF AREA (SQ FT)	TOTAL PV WEIGHT (LBS)	TOTAL ROOF WEIGHT (LBS)	POINT LOAD (LBS/FT ²)	
AMP1	178	18	18	495	Comp Shingle	018	Manufactured	2x6 @ 24" O.C	2x6 @ 24" O.C	UNIRAC 2x4x8x16	UNIRAC SFM INFINITY FLASHTIGHT	24" / 48"	24" / 18"	3637	1145	203	203	1.17	
AMP2	0	0	0	0	0	0	0	0	0	0	0	0	0	0	0	0	0	0	0
AMP3	0	0	0	0	0	0	0	0	0	0	0	0	0	0	0	0	0	0	0
AMP4	0	0	0	0	0	0	0	0	0	0	0	0	0	0	0	0	0	0	0
AMP5	0	0	0	0	0	0	0	0	0	0	0	0	0	0	0	0	0	0	0
AMP6	0	0	0	0	0	0	0	0	0	0	0	0	0	0	0	0	0	0	0
AMP7	0	0	0	0	0	0	0	0	0	0	0	0	0	0	0	0	0	0	0
AMP8	0	0	0	0	0	0	0	0	0	0	0	0	0	0	0	0	0	0	0
AMP9	0	0	0	0	0	0	0	0	0	0	0	0	0	0	0	0	0	0	0
AMP10	0	0	0	0	0	0	0	0	0	0	0	0	0	0	0	0	0	0	0

BLUE RAVEN
SOLAR

1403 N 630 E
Orem, Utah 84097
(800) 377-4480
blue Ravensolar.com

Antonio Johnny
67 James Allen Ln
Dunn, North Carolina 28334
Harnett County
Duke Energy NC

PROJECT ID: **898102**
DC SYSTEM SIZE: 5.04 kW DC
AC SYSTEM SIZE: 3.78 kW AC
REVISIONS:
DRAWN BY: Brendon Filmore
PLOT DATE: December 9, 2023
DRAWING TITLE: Structural
DRAWING NUMBER: **PV4**

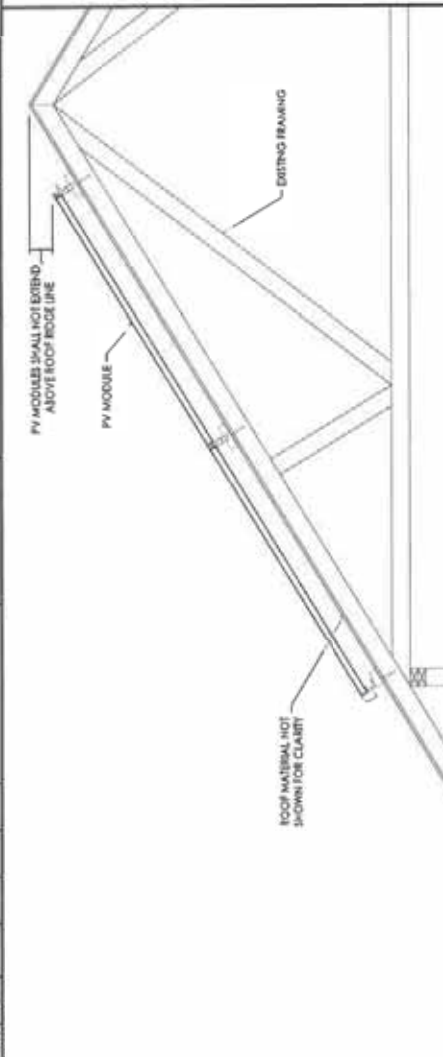
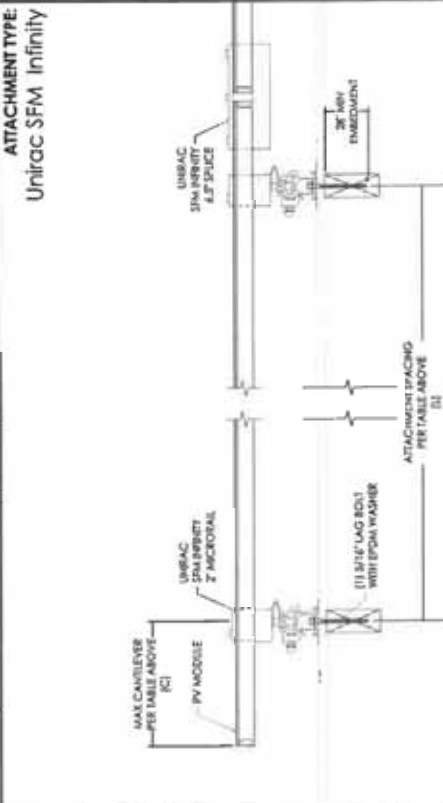

ATTACHMENT TYPE:
Unirac SFM Infinity

ATTACHMENT DETAIL
SCALE: 1-1/2" = 1'-0"

NOTES

Sealed For Existing Roof & Attachment Only

PRINTED PERM. 0-0448

1 FRAMING DETAIL
SCALE: 1/2" = 1'-0"

*THIS DETAIL IS NOT MEANT TO BE AN EXACT REPRESENTATION OF FRAMING OR PV MODULE LAYOUT

2 ATTACHMENT DETAIL
SCALE: 1-1/2" = 1'-0"

3 ATTACHMENT PATTERN
SCALE: 1/4" = 1'-0"

FOLLOW ATTACHMENT SPACING IN TABLE ABOVE

*ATTACHMENT PATTERN SHOULD BE STAGGERED UNLESS OTHERWISE NOTED IN ENGINEERING LETTER



BLUE RAVEN
SOLAR

1403 N 630 E
Orem, Utah 84097
(800) 377-4480
BlueRavenSolar.com

PROJECT ID: **898102**

DC SYSTEM SIZE: 5.04 kW DC

AC SYSTEM SIZE: 3.78 kW AC

REVISIONS:

DATE: December 9, 2023

DRAWING TITLE: Electrical Calculations

STANDARD NUMBER: PV6

CUSTOMER NAME: **Antonio Johnny**

ADDRESS: 67 James Allen Ln
Dunn, North Carolina 28334

COUNTY: Harnett County

UTILITY COMPANY: Duke Energy NC

WIRE SIZE SPECIFICATIONS

	①	②	③	④	⑤	⑥	⑦	⑧	⑨	⑩
MINIMUM CONDUCTOR AMPACITY	19.5A AC	19.5A AC	19.5A AC	19.5A AC	19.5A AC	19.5A AC	19.5A AC	19.5A AC	19.5A AC	19.5A AC
CONDUCTOR MATERIAL	CU	CU	CU	CU	CU	CU	CU	CU	CU	CU
CONDUCTOR TYPE	THHN/THWN-2	THHN/THWN-2	THHN/THWN-2	THHN/THWN-2	THHN/THWN-2	THHN/THWN-2	THHN/THWN-2	THHN/THWN-2	THHN/THWN-2	THHN/THWN-2
CONDUCTOR SIZE	12 AWG	10 AWG	10 AWG	10 AWG	10 AWG	10 AWG	10 AWG	10 AWG	10 AWG	10 AWG
CONDUCTOR AMPACITY	30A	30A	30A	30A	30A	30A	30A	30A	30A	30A
AMBIENT TEMPERATURE ADJUSTMENT FACTOR	0.96	0.96	0.96	0.96	0.96	0.96	0.96	0.96	0.96	0.96
CONDENSED RUL ADJUSTMENT FACTOR	1	1	1	1	1	1	1	1	1	1
ADJUSTED CONDUCTOR AMPACITY	28.8A	28.8A	28.8A	28.8A	28.8A	28.8A	28.8A	28.8A	28.8A	28.8A
WIRE RUN DISTANCE (FT)	79	30	20	3	0.33%	0.33%	0.33%	0.33%	0.33%	0.33%
CALCULATED VOLTAGE DROP	2.28%	0.5%	0.33%	0.08%	0.08%	0.08%	0.08%	0.08%	0.08%	0.08%

PV CIRCUIT SPECIFICATIONS

	PRIMARY STRUCTURE			DETACHED STRUCTURE						
	CIRCUIT 1	CIRCUIT 2	CIRCUIT 3	CIRCUIT 4	CIRCUIT 5	CIRCUIT 6	CIRCUIT 7	CIRCUIT 8	CIRCUIT 9	CIRCUIT 10
NUMBER OF MODULES PER CIRCUIT	12	0	0	0	0	0	0	0	0	0
RATED AC OUTPUT CURRENT (I _{sc})	13.7A	0.0A	0.0A	0.0A	0.0A	0.0A	0.0A	0.0A	0.0A	0.0A
MINIMUM AMPACITY (I _{sc} x 125%)	17.1A	0.0A	0.0A	0.0A	0.0A	0.0A	0.0A	0.0A	0.0A	0.0A
OVERCURRENT PROTECTION RATING	20A	20A	20A	20A	20A	20A	20A	20A	20A	20A
COMBINED AC OUTPUT CURRENT (I _{sc})	13.7A	0.0A	0.0A	0.0A	0.0A	0.0A	0.0A	0.0A	0.0A	0.0A
MINIMUM AMPACITY (I _{sc} x 125%)	17.1A	0.0A	0.0A	0.0A	0.0A	0.0A	0.0A	0.0A	0.0A	0.0A
COMBINED PV BREAKER RATING	20A	20A	20A	20A	20A	20A	20A	20A	20A	20A

TOTAL VOLTAGE DROP

WIRE TAG #1	2.00%
WIRE TAG #2	0.5%
WIRE TAG #3	0.33%
WIRE TAG #4	0.08%
WIRE TAG #5	0%
WIRE TAG #6	0%
TOTAL	2.910000%

ELECTRICAL INFORMATION

UTILITY ELECTRICAL SYSTEM

1-Phase, 240V, 60Hz, 120/240V

NEW PV SYSTEM

1-Phase, 240V, 60Hz, 120/240V

AC SYSTEM SIZE | 3.78kW AC

DC SYSTEM SIZE | 5.04kW DC

QUANTITY | 13

PV MODULES

TYPE | REC-500R REC-600A PV-6-B

WARRANTY | 25YR DC

INVERTERS

TYPE | REC-500R-600A PV-6-B

OUTPUT CURRENT | 31.1A AC

NOMINAL VOLTAGE | 240V AC

OUTPUT POWER | 3134W AC

DESIGN LOCATION AND TEMPERATURES

DATA SOURCE | AHJ/RAE Weather Station Data

CITY | Dunn

STATE | North Carolina

WEATHER STATION | SETACOL-3/JOHNSON AFB

HIGH TEMP 2% AVG | 35°C

EXTREME MINIMUM TEMP | -10°C

PV BREAKER BACKFEED CALCULATIONS

(UL984 RATING • 120V • OCCFD RATING • AVAILABLE BACKFEED)

MAIN SERVICE PANEL	SUBPANEL 1
BUSBAR RATING	200A
PANEL OCCFD RATING	200A
AVAILABLE BACKFEED (100% BUS)	70A
PV BREAKER RATING	20A
AVAILABLE BACKFEED (100% BUS)	20A

THESE CALCULATIONS ARE ONLY APPLICABLE IF PV INTERCONNECTION IS A LOAD SIDE BREAKER

**PV BREAKER MUST BE RATED LESS THAN OR EQUAL TO AVAILABLE BACKFEED FOR CODE COMPLIANCE*

WARNING LABELS FOR PHOTOVOLTAIC SYSTEM

UTILITY METER

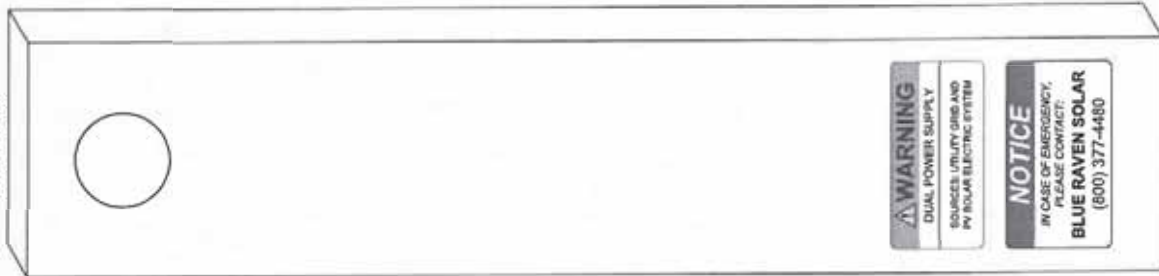

MAIN SERVICE PANEL



AC DISCONNECT



PV COMBINER BOX

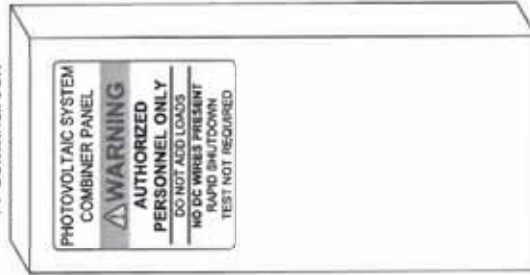

<p>BLUE RAVEN SOLAR</p> <p>1403 N 630 E Orem, Utah 84097 (800) 377-4480 BlueRavenSolar.com</p>	<p>Antonio Johnny 67 James Allen Ln Dunn, North Carolina 28334</p>	<p>DUKE COMPANY: Harnett County Duke Energy NC</p>
	<p>PROJECT ID: 898102</p>	<p>DC SYSTEM SIZE: 5.04 kW DC</p> <p>AC SYSTEM SIZE: 3.78 kW AC</p>

REVISIONS:

1			
2			
3			
4			

DESIGN BY: Brendan Filmore
 DATE: December 9, 2023
 DRAWING TITLE: Warning Labels
 DRAWING NUMBER: PV7



SOLAR'S MOST TRUSTED

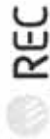

REC ALPHA PURE-R SERIES PRODUCT SPECIFICATIONS



COMPACT PANEL - SIZE

9 A MODULE CURRENT
COMPATIBLE WITH MPPE

430 WP
20.7 W/FT²
22.3% EFFICIENCY



LEAD-FREE
ROHS COMPLIANT

EXPERIENCE
PERFORMANCE



REC ALPHA PURE-R SERIES PRODUCT SPECIFICATIONS

GENERAL DATA

Cell type: 60 cell cut REC Crystal hetero-junction cells with back-surface field (BSF) technology

Glass: 0.33" (8.4mm) clear glass with anti-reflection low iron tempered glass on both sides (3.2mm)

Backsheet: High performance polymer (PET) with UV stabilizer and fire retardant

Frame: Anodized aluminum (black)

Junction box: 6 port, 400Vdc, 3000mA, 3000Vdc

Junction box IP: IP67 (not for use in rain) (NEMA 4X)

Connectivity: 20mm MC4 PV-ED1451410 (AWG)

Cable: 12 AWG (4-wire) PV wire, 6.52" (17.17cm) length

Dimensions: 68.1 x 44.8 x 3.2 (inches) / 1728 x 1138 x 80.9 (mm)

Weight: 47.4 lbs (21.5 kg)

Origin: Made in Singapore

ELECTRICAL DATA

Parameter	Value	Product Code	REC Alpha PURE-R
Power Output - P_{max} (W)	430	432	
V _{OC} (V)	41.0	01-10	
V _{MPPT} (V)	48.8	48.4	
V _{MPPT} (V) @ 1000W (V)	48.2	8.30	
V _{MPPT} (V) @ 1000W (V) @ 25°C	59.9	59.2	
V _{MPPT} (V) @ 1000W (V) @ 45°C	8.80	8.84	
V _{MPPT} (V) @ 1000W (V) @ 65°C	19.28	19.24	
V _{MPPT} (V) @ 1000W (V) @ 85°C	20.7	21.2	
V _{MPPT} (V) @ 1000W (V) @ 105°C	30.5	31.2	
V _{MPPT} (V) @ 1000W (V) @ 125°C	46.0	47.1	
V _{MPPT} (V) @ 1000W (V) @ 145°C	6.64	6.70	
V _{MPPT} (V) @ 1000W (V) @ 165°C	55.5	55.8	
V _{MPPT} (V) @ 1000W (V) @ 185°C	7.11	7.18	
V _{MPPT} (V) @ 1000W (V) @ 205°C			
V _{MPPT} (V) @ 1000W (V) @ 225°C			
V _{MPPT} (V) @ 1000W (V) @ 245°C			
V _{MPPT} (V) @ 1000W (V) @ 265°C			
V _{MPPT} (V) @ 1000W (V) @ 285°C			
V _{MPPT} (V) @ 1000W (V) @ 305°C			
V _{MPPT} (V) @ 1000W (V) @ 325°C			
V _{MPPT} (V) @ 1000W (V) @ 345°C			
V _{MPPT} (V) @ 1000W (V) @ 365°C			
V _{MPPT} (V) @ 1000W (V) @ 385°C			
V _{MPPT} (V) @ 1000W (V) @ 405°C			
V _{MPPT} (V) @ 1000W (V) @ 425°C			
V _{MPPT} (V) @ 1000W (V) @ 445°C			
V _{MPPT} (V) @ 1000W (V) @ 465°C			
V _{MPPT} (V) @ 1000W (V) @ 485°C			
V _{MPPT} (V) @ 1000W (V) @ 505°C			
V _{MPPT} (V) @ 1000W (V) @ 525°C			
V _{MPPT} (V) @ 1000W (V) @ 545°C			
V _{MPPT} (V) @ 1000W (V) @ 565°C			
V _{MPPT} (V) @ 1000W (V) @ 585°C			
V _{MPPT} (V) @ 1000W (V) @ 605°C			
V _{MPPT} (V) @ 1000W (V) @ 625°C			
V _{MPPT} (V) @ 1000W (V) @ 645°C			
V _{MPPT} (V) @ 1000W (V) @ 665°C			
V _{MPPT} (V) @ 1000W (V) @ 685°C			
V _{MPPT} (V) @ 1000W (V) @ 705°C			
V _{MPPT} (V) @ 1000W (V) @ 725°C			
V _{MPPT} (V) @ 1000W (V) @ 745°C			
V _{MPPT} (V) @ 1000W (V) @ 765°C			
V _{MPPT} (V) @ 1000W (V) @ 785°C			
V _{MPPT} (V) @ 1000W (V) @ 805°C			
V _{MPPT} (V) @ 1000W (V) @ 825°C			
V _{MPPT} (V) @ 1000W (V) @ 845°C			
V _{MPPT} (V) @ 1000W (V) @ 865°C			
V _{MPPT} (V) @ 1000W (V) @ 885°C			
V _{MPPT} (V) @ 1000W (V) @ 905°C			
V _{MPPT} (V) @ 1000W (V) @ 925°C			
V _{MPPT} (V) @ 1000W (V) @ 945°C			
V _{MPPT} (V) @ 1000W (V) @ 965°C			
V _{MPPT} (V) @ 1000W (V) @ 985°C			
V _{MPPT} (V) @ 1000W (V) @ 1005°C			

MAXIMUM RATINGS

Parameter	Value	Standard	REC Product
Operational temperature	-40 ~ +85°C	IEC 61215	Yes
System voltage	1000V	IEC 61215	Yes
Test load (bars)	+2000hPa (14.7psi) / -1000hPa (-7.35psi)	IEC 61215	Yes
Test load (bars)	+0.057Pa (0.833mmHg) / -0.057Pa (-0.833mmHg)	IEC 61215	Yes
Series Resistor	25A	IEC 61215	Yes
Reverse current	25A	IEC 61215	Yes

HUMIDITY

Parameter	Value	Standard	REC Product
Insulation resistance	>1000MΩ (1000VDC)	IEC 61215	Yes
System Size	432 W 25-100 MM	IEC 61215	Yes
Power Warranty (yr)	25	IEC 61215	Yes
Labor Warranty (yr)	5	IEC 61215	Yes
Power at Year 1	88%	IEC 61215	Yes
Annual Degradation	0.25%	IEC 61215	Yes
Power at Year 25	82%	IEC 61215	Yes

Available from:

Founded in 1996, REC Group is an international power solar energy company dedicated to engineering customers with clean, affordable solar power. As Solar's Most Trusted, REC is committed to high quality, innovation, and a low carbon footprint in the solar materials and solar panels manufacturers. Headquarters in Nanjing with regional headquarters in Singapore, REC has two regional distribution centers in Australia, Europe, and Asia Pacific.



1453 N. Ruskess Ave
Orem, UT 84057
801.227.4480
WWW.BLUERAVENPV.COM

CONFIDENTIAL - THE INFORMATION HEREIN CONTAINED SHALL NOT BE USED FOR THE BENEFIT OF ANYONE EXCEPT BLUE RAVEN SOLAR NOR SHALL IT BE DISCLOSED IN WHOLE OR IN PART TO ANY OTHER PARTY WITHOUT THE WRITTEN PERMISSION OF BLUE RAVEN SOLAR LLC.

NABCEP
CERTIFIED
PV INSTALLATION
PROFESSIONAL
Scott County
RPV-011718-016MAN

CONTRACTOR:
BRS FIELD OPS
385-488-6700

DRAWING BY:
PLOT DATE:
PROJECT NUMBER:
SHEET NAME:
SPEC SHEET
PAGE NUMBER:
SS

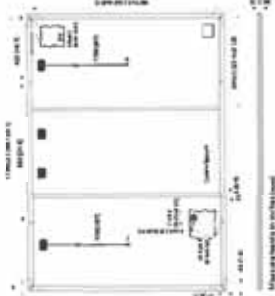

CERTIFICATIONS

Standard	Value
IEC 61215-2016	IEC 61730-2016, UL 61730
IEC 61853	IP67
IEC 61730	Salt Mist
IEC 61736	Aerosol Resistance
UL 61730	Fire Type 2
IEC 62782	Dynamic Mechanical Load
IEC 61732-2016	Hailstone (DIN)
IEC 62782	Leakdown w/UVS (DIN EN 60605)
ISO 9001:2015	ISO 14001:2015

TEMPERATURE RATINGS

Parameter	Value
Normal Module Operating Temperature	4°C (39°F)
Temperature coefficient of P_{max}	-0.24%/°C
Temperature coefficient of V_{oc}	-0.24%/°C
Temperature coefficient of I_{sc}	0.04%/°C

DELIVERY INFORMATION

Parameter	Value
Panels per pallet	33
Pallet size (L x W x H) (inches)	68.1 x 44.8 x 3.2
Panels per 53h truck	658 (26 pallets)

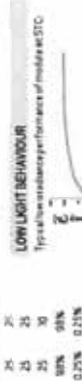

REC Solar PTE LTD.
20 East South Ave 14
Singapore 637332
www.recgroup.com

IQ7X Microinverter

The high-powered, smart grid-ready IQ7X Microinverter dramatically simplifies the installation process while achieving the highest system efficiency for systems with 96-cell modules. Part of the Enphase Energy System, the IQ7X Microinverter integrates with the IQ Gateway, IQ Battery, and the Enphase Installer App monitoring and analysis software.

The IQ Series Microinverters extend the reliability standards set forth by previous generations and undergo over a million hours of power-on testing, enabling Enphase to provide an industry-leading warranty of up to 25-years.

Easy to Install

- Lightweight and simple
- Factor installation with improved lighter two-wire cabling
- Built-in rapid shutdown compliant (NEC 2014, 2017 A, 2020)

Efficient and Reliable

- Optimized for high-powered 96-cell modules
- Highest CEC efficiency of 97.5%
- More than a million repairs at no charge
- Class II double-insulated enclosure
- UL listed

Smart Grid-Ready

- Complies with advanced grid support, voltage and frequency ride-through requirements
- Remotely updates to respond to changing grid requirements
- Configurable for varying grid profiles
- Meets CA Rule 21 (UL 1741-SA) and IEEE 1547-2018 (UL 1741-3B, 3rd Ed)

* The IQ7X is required to support 96-cell modules



To learn more about Enphase offerings, visit enphase.com
IQ7X-05-0099-EN-US-12-27-2022

IQ7X Microinverter

INPUT DATA (DC)	
Commonly used module pairings ¹	IQ7X-96-2-US 320W - 4850W
Module compatibility	96-cell PV modules
Maximum input DC voltage	79.5V
Peak power tracking voltage	53V - 64V
Operating range	25V - 79.5V
Min/Max start voltage	33V/79.5V
Max DC short circuit current (module fact)	10A
Over-voltage class DC port	II
DC port backfeed current	0A
PV array configuration	1 x 1 ungrounded array. No additional DC side protection required. AC side protection requires max. 20A per branch circuit @ 240VAC
OUTPUT DATA (AC)	
Peak output power	320VA
Maximum continuous output power	315VA
Nominal (L-L) voltage/range*	240V/211-254V
Maximum continuous output current	1.31A (240VAC)
Nominal frequency	60Hz
Extended frequency range	49 - 68 Hz
AC short circuit fault current over 3 cycles	5.8 Arms
Maximum units per 20A (L-L) branch circuit ²	12 (240VAC)
Over-voltage class AC port	III
AC port backfeed current	18 mA
Power factor setting	1.0
Power factor (adjustable)	0.95 leading - 0.85 lagging
CEC weighted efficiency	@ 240VAC 97.5%
MECHANICAL DATA	
Ambient temperature range	-40°C to +107°C
Relative humidity range	4% to 100% (condensing)
Connector type (IQ7X 96-2 US)	MCA (or Amphenol H4 UTX with optional Q-DCC-S adapter)
Dimensions (WxHxD)	212 mm x 176 mm x 30.2 mm (without bracket)
Weight	1.58 kg (2.98 lbs)
Cooling	Natural convection. No fans
Approved for wet locations	Yes
Pollution degree	FD3
Enclosure ³	Class II double-insulated. Corrosion resistant polymers, enclosure
Environmental category/UV exposure rating	NEMA Type 3R outdoor
FEATURES	
Communication	Power Line Communications (PLC)
Monitoring	Enphase Installer App and monitoring option
Disconnecting means	Compatible with IQ Gateway
Compliance	The AC and DC connectors have been evaluated and approved by UL for use as the load-break disconnect required by NEC 690
	CA Rule 21 (UL 1741-SA), IEEE 1547-2018 (UL 1741-3B, 3rd Ed)
	IEEE 1547-2018 (UL 1741-3B, 3rd Ed)
	CA Rule 21 (UL 1741-SA), IEEE 1547-2018 (UL 1741-3B, 3rd Ed)
	CA Rule 21 (UL 1741-SA), IEEE 1547-2018 (UL 1741-3B, 3rd Ed)
	This product is UL Listed as PV Rapid Shutdown Equipment and conforms with NEC 2014, NEC 2017, and NEC 2020, section 690.12 and C22.1-2015 Rule 64-218 Rapid Shutdown of PV Systems, for AC and DC conductors, when installed according to manufacturer's instructions.

1. Pairing PV modules with wattage above the limit may result in additional clipping losses. See the compatibility calculator at bit.ly/ulacclass-compatibility.
2. Maximum number of units per branch circuit is limited by the utility.
3. Units may only refer to load requirements to derive the number of microinverters per branch in your array.

To learn more about Enphase offerings, visit enphase.com

© 2022 Enphase Energy. All rights reserved. Enphase, the Enphase logo, IQ, IQ+, IQ Battery, Enphase Installer App, IQ gateway and other trademarks are or were owned by Enphase Energy, Inc.
IQ7X-05-0099-EN-US-12-27-2022



The IQ7X is required to support 96-cell modules

To learn more about Enphase offerings, visit enphase.com
IQ7X-05-0099-EN-US-12-27-2022



1403 N. Research Way
Orem, UT 84057
800.377.4480
WWW.BLUERAVEN-SOLAR.COM

CONFIDENTIAL: THE INFORMATION HEREIN CONTAINED SHALL NOT BE DISCLOSED OR REPRODUCED IN ANY MANNER WITHOUT THE WRITTEN PERMISSION OF BLUE RAVEN SOLAR LLC.



PV INSTALLATION
PROFESSIONAL
Scott Gurney
#PV-011718101808

CONTRACTOR:
BRS FIELD OPS
395-498-6700

DRAWING BY:	
PLOT DATE:	
PROJECT NUMBER:	
SHEET NAME:	SS
REVISION:	---
PAGE NUMBER:	SS



IQ Combiner 4/4C

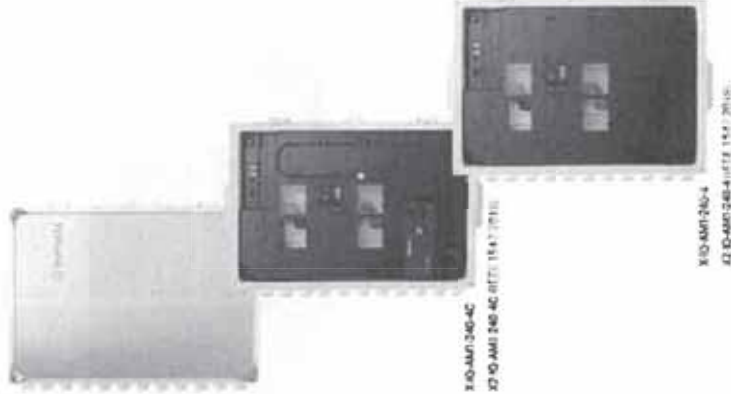

IQ-AMI-240-4C

IQ-AMI-240-4C (RTT)

IQ-AMI-240-4

IQ-AMI-240-4 (RTT)

The IQ Combiner 4/4C, Anti-IG Gateway and integrated 110V AC meter (included only with IQ Combiner 4C) consolidates interconnection equipment into a single enclosure. It streamlines IQ Micro-inverters and storage installations by providing a consistent, one-wire solution for residential applications. It offers up to four 2-pole output circuits and Enphase BR series breaker assembly.

Smart

- Includes IQ Gateway for monitoring, status and control
- Includes Mobile Command cellular modem
- CELL MODEM M1, M2, M3, M4, M5, M6, M7, M8, M9, M10, M11, M12, M13, M14, M15, M16, M17, M18, M19, M20, M21, M22, M23, M24, M25, M26, M27, M28, M29, M30, M31, M32, M33, M34, M35, M36, M37, M38, M39, M40, M41, M42, M43, M44, M45, M46, M47, M48, M49, M50, M51, M52, M53, M54, M55, M56, M57, M58, M59, M60, M61, M62, M63, M64, M65, M66, M67, M68, M69, M70, M71, M72, M73, M74, M75, M76, M77, M78, M79, M80, M81, M82, M83, M84, M85, M86, M87, M88, M89, M90, M91, M92, M93, M94, M95, M96, M97, M98, M99, M100, M101, M102, M103, M104, M105, M106, M107, M108, M109, M110, M111, M112, M113, M114, M115, M116, M117, M118, M119, M120, M121, M122, M123, M124, M125, M126, M127, M128, M129, M130, M131, M132, M133, M134, M135, M136, M137, M138, M139, M140, M141, M142, M143, M144, M145, M146, M147, M148, M149, M150, M151, M152, M153, M154, M155, M156, M157, M158, M159, M160, M161, M162, M163, M164, M165, M166, M167, M168, M169, M170, M171, M172, M173, M174, M175, M176, M177, M178, M179, M180, M181, M182, M183, M184, M185, M186, M187, M188, M189, M190, M191, M192, M193, M194, M195, M196, M197, M198, M199, M200, M201, M202, M203, M204, M205, M206, M207, M208, M209, M210, M211, M212, M213, M214, M215, M216, M217, M218, M219, M220, M221, M222, M223, M224, M225, M226, M227, M228, M229, M230, M231, M232, M233, M234, M235, M236, M237, M238, M239, M240, M241, M242, M243, M244, M245, M246, M247, M248, M249, M250, M251, M252, M253, M254, M255, M256, M257, M258, M259, M260, M261, M262, M263, M264, M265, M266, M267, M268, M269, M270, M271, M272, M273, M274, M275, M276, M277, M278, M279, M280, M281, M282, M283, M284, M285, M286, M287, M288, M289, M290, M291, M292, M293, M294, M295, M296, M297, M298, M299, M300, M301, M302, M303, M304, M305, M306, M307, M308, M309, M310, M311, M312, M313, M314, M315, M316, M317, M318, M319, M320, M321, M322, M323, M324, M325, M326, M327, M328, M329, M330, M331, M332, M333, M334, M335, M336, M337, M338, M339, M340, M341, M342, M343, M344, M345, M346, M347, M348, M349, M350, M351, M352, M353, M354, M355, M356, M357, M358, M359, M360, M361, M362, M363, M364, M365, M366, M367, M368, M369, M370, M371, M372, M373, M374, M375, M376, M377, M378, M379, M380, M381, M382, M383, M384, M385, M386, M387, M388, M389, M390, M391, M392, M393, M394, M395, M396, M397, M398, M399, M400, M401, M402, M403, M404, M405, M406, M407, M408, M409, M410, M411, M412, M413, M414, M415, M416, M417, M418, M419, M420, M421, M422, M423, M424, M425, M426, M427, M428, M429, M430, M431, M432, M433, M434, M435, M436, M437, M438, M439, M440, M441, M442, M443, M444, M445, M446, M447, M448, M449, M450, M451, M452, M453, M454, M455, M456, M457, M458, M459, M460, M461, M462, M463, M464, M465, M466, M467, M468, M469, M470, M471, M472, M473, M474, M475, M476, M477, M478, M479, M480, M481, M482, M483, M484, M485, M486, M487, M488, M489, M490, M491, M492, M493, M494, M495, M496, M497, M498, M499, M500, M501, M502, M503, M504, M505, M506, M507, M508, M509, M510, M511, M512, M513, M514, M515, M516, M517, M518, M519, M520, M521, M522, M523, M524, M525, M526, M527, M528, M529, M530, M531, M532, M533, M534, M535, M536, M537, M538, M539, M540, M541, M542, M543, M544, M545, M546, M547, M548, M549, M550, M551, M552, M553, M554, M555, M556, M557, M558, M559, M560, M561, M562, M563, M564, M565, M566, M567, M568, M569, M570, M571, M572, M573, M574, M575, M576, M577, M578, M579, M580, M581, M582, M583, M584, M585, M586, M587, M588, M589, M590, M591, M592, M593, M594, M595, M596, M597, M598, M599, M600, M601, M602, M603, M604, M605, M606, M607, M608, M609, M610, M611, M612, M613, M614, M615, M616, M617, M618, M619, M620, M621, M622, M623, M624, M625, M626, M627, M628, M629, M630, M631, M632, M633, M634, M635, M636, M637, M638, M639, M640, M641, M642, M643, M644, M645, M646, M647, M648, M649, M650, M651, M652, M653, M654, M655, M656, M657, M658, M659, M660, M661, M662, M663, M664, M665, M666, M667, M668, M669, M670, M671, M672, M673, M674, M675, M676, M677, M678, M679, M680, M681, M682, M683, M684, M685, M686, M687, M688, M689, M690, M691, M692, M693, M694, M695, M696, M697, M698, M699, M700, M701, M702, M703, M704, M705, M706, M707, M708, M709, M710, M711, M712, M713, M714, M715, M716, M717, M718, M719, M720, M721, M722, M723, M724, M725, M726, M727, M728, M729, M730, M731, M732, M733, M734, M735, M736, M737, M738, M739, M740, M741, M742, M743, M744, M745, M746, M747, M748, M749, M750, M751, M752, M753, M754, M755, M756, M757, M758, M759, M760, M761, M762, M763, M764, M765, M766, M767, M768, M769, M770, M771, M772, M773, M774, M775, M776, M777, M778, M779, M780, M781, M782, M783, M784, M785, M786, M787, M788, M789, M790, M791, M792, M793, M794, M795, M796, M797, M798, M799, M800, M801, M802, M803, M804, M805, M806, M807, M808, M809, M810, M811, M812, M813, M814, M815, M816, M817, M818, M819, M820, M821, M822, M823, M824, M825, M826, M827, M828, M829, M830, M831, M832, M833, M834, M835, M836, M837, M838, M839, M840, M841, M842, M843, M844, M845, M846, M847, M848, M849, M850, M851, M852, M853, M854, M855, M856, M857, M858, M859, M860, M861, M862, M863, M864, M865, M866, M867, M868, M869, M870, M871, M872, M873, M874, M875, M876, M877, M878, M879, M880, M881, M882, M883, M884, M885, M886, M887, M888, M889, M890, M891, M892, M893, M894, M895, M896, M897, M898, M899, M900, M901, M902, M903, M904, M905, M906, M907, M908, M909, M910, M911, M912, M913, M914, M915, M916, M917, M918, M919, M920, M921, M922, M923, M924, M925, M926, M927, M928, M929, M930, M931, M932, M933, M934, M935, M936, M937, M938, M939, M940, M941, M942, M943, M944, M945, M946, M947, M948, M949, M950, M951, M952, M953, M954, M955, M956, M957, M958, M959, M960, M961, M962, M963, M964, M965, M966, M967, M968, M969, M970, M971, M972, M973, M974, M975, M976, M977, M978, M979, M980, M981, M982, M983, M984, M985, M986, M987, M988, M989, M990, M991, M992, M993, M994, M995, M996, M997, M998, M999, M1000, M1001, M1002, M1003, M1004, M1005, M1006, M1007, M1008, M1009, M1010, M1011, M1012, M1013, M1014, M1015, M1016, M1017, M1018, M1019, M1020, M1021, M1022, M1023, M1024, M1025, M1026, M1027, M1028, M1029, M1030, M1031, M1032, M1033, M1034, M1035, M1036, M1037, M1038, M1039, M1040, M1041, M1042, M1043, M1044, M1045, M1046, M1047, M1048, M1049, M1050, M1051, M1052, M1053, M1054, M1055, M1056, M1057, M1058, M1059, M1060, M1061, M1062, M1063, M1064, M1065, M1066, M1067, M1068, M1069, M1070, M1071, M1072, M1073, M1074, M1075, M1076, M1077, M1078, M1079, M1080, M1081, M1082, M1083, M1084, M1085, M1086, M1087, M1088, M1089, M1090, M1091, M1092, M1093, M1094, M1095, M1096, M1097, M1098, M1099, M1100, M1101, M1102, M1103, M1104, M1105, M1106, M1107, M1108, M1109, M1110, M1111, M1112, M1113, M1114, M1115, M1116, M1117, M1118, M1119, M1120, M1121, M1122, M1123, M1124, M1125, M1126, M1127, M1128, M1129, M1130, M1131, M1132, M1133, M1134, M1135, M1136, M1137, M1138, M1139, M1140, M1141, M1142, M1143, M1144, M1145, M1146, M1147, M1148, M1149, M1150, M1151, M1152, M1153, M1154, M1155, M1156, M1157, M1158, M1159, M1160, M1161, M1162, M1163, M1164, M1165, M1166, M1167, M1168, M1169, M1170, M1171, M1172, M1173, M1174, M1175, M1176, M1177, M1178, M1179, M1180, M1181, M1182, M1183, M1184, M1185, M1186, M1187, M1188, M1189, M1190, M1191, M1192, M1193, M1194, M1195, M1196, M1197, M1198, M1199, M1200, M1201, M1202, M1203, M1204, M1205, M1206, M1207, M1208, M1209, M1210, M1211, M1212, M1213, M1214, M1215, M1216, M1217, M1218, M1219, M1220, M1221, M1222, M1223, M1224, M1225, M1226, M1227, M1228, M1229, M1230, M1231, M1232, M1233, M1234, M1235, M1236, M1237, M1238, M1239, M1240, M1241, M1242, M1243, M1244, M1245, M1246, M1247, M1248, M1249, M1250, M1251, M1252, M1253, M1254, M1255, M1256, M1257, M1258, M1259, M1260, M1261, M1262, M1263, M1264, M1265, M1266, M1267, M1268, M1269, M1270, M1271, M1272, M1273, M1274, M1275, M1276, M1277, M1278, M1279, M1280, M1281, M1282, M1283, M1284, M1285, M1286, M1287, M1288, M1289, M1290, M1291, M1292, M1293, M1294, M1295, M1296, M1297, M1298, M1299, M1300, M1301, M1302, M1303, M1304, M1305, M1306, M1307, M1308, M1309, M1310, M1311, M1312, M1313, M1314, M1315, M1316, M1317, M1318, M1319, M1320, M1321, M1322, M1323, M1324, M1325, M1326, M1327, M1328, M1329, M1330, M1331, M1332, M1333, M1334, M1335, M1336, M1337, M1338, M1339, M1340, M1341, M1342, M1343, M1344, M1345, M1346, M1347, M1348, M1349, M1350, M1351, M1352, M1353, M1354, M1355, M1356, M1357, M1358, M1359, M1360, M1361, M1362, M1363, M1364, M1365, M1366, M1367, M1368, M1369, M1370, M1371, M1372, M1373, M1374, M1375, M1376, M1377, M1378, M1379, M1380, M1381, M1382, M1383, M1384, M1385, M1386, M1387, M1388, M1389, M1390, M1391, M1392, M1393, M1394, M1395, M1396, M1397, M1398, M1399, M1400, M1401, M1402, M1403, M1404, M1405, M1406, M1407, M1408, M1409, M1410, M1411, M1412, M1413, M1414, M1415, M1416, M1417, M1418, M1419, M1420, M1421, M1422, M1423, M1424, M1425, M1426, M1427, M1428, M1429, M1430, M1431, M1432, M1433, M1434, M1435, M1436, M1437, M1438, M1439, M1440, M1441, M1442, M1443, M1444, M1445, M1446, M1447, M1448, M1449, M1450, M1451, M1452, M1453, M1454, M1455, M1456, M1457, M1458, M1459, M1460, M1461, M1462, M1463, M1464, M1465, M1466, M1467, M1468, M1469, M1470, M1471, M1472, M1473, M1474, M1475, M1476, M1477, M1478, M1479, M1480, M1481, M1482, M1483, M1484, M1485, M1486, M1487, M1488, M1489, M1490, M1491, M1492, M1493, M1494, M1495, M1496, M1497, M1498, M1499, M1500, M1501, M1502, M1503, M1504, M1505, M1506, M1507, M1508, M1509, M1510, M1511, M1512, M1513, M1514, M1515, M1516, M1517, M1518, M1519, M1520, M1521, M1522, M1523, M1524, M1525, M1526, M1527, M1528, M1529, M1530, M1531, M1532, M1533, M1534, M1535, M1536, M1537, M1538, M1539, M1540, M1541, M1542, M1543, M1544, M1545, M1546, M1547, M1548, M1549, M1550, M1551, M1552, M1553, M1554, M1555, M1556, M1557, M1558, M1559, M1560, M1561, M1562, M1563, M1564, M1565, M1566, M1567, M1568, M1569, M1570, M1571, M1572, M1573, M1574, M1575, M1576, M1577, M1578, M1579, M1580, M1581, M1582, M1583, M1584, M1585, M1586, M1587, M1588, M1589, M1590, M1591, M1592, M1593, M1594, M1595, M1596, M1597, M1598, M1599, M1600, M1601, M1602, M1603, M1604, M1605, M1606, M1607, M1608, M1609, M1610, M1611, M1612, M1613, M1614, M1615, M1616, M1617, M1618, M1619, M1620, M1621, M1622, M1623, M1624, M1625, M1626, M1627, M1628, M1629, M1630, M1631, M1632, M1633, M1634, M1635, M1636, M1637, M1638, M1639, M1640, M1641, M1642, M1643, M1644, M1645, M1646, M1647, M1648, M1649, M1650, M1651, M1652, M1653, M1654, M1655, M1656, M1657, M1658, M1659, M1660, M1661, M1662, M1663, M1664, M1665, M1666, M1667, M1668, M1669, M1670, M1671, M1672, M1673, M1674, M1675, M1676, M1677, M1678, M1679, M1680, M1681, M1682, M1683, M1684, M1685, M1686, M1687, M1688, M1689, M1690, M1691, M1692, M1693, M1694, M1695, M1696, M1697, M1698, M1699, M1700, M1701, M1702, M1703, M1704, M1705, M1706, M1707, M1708, M1709, M1710, M1711, M1712, M1713, M1714, M1715, M1716, M1717, M1718, M1719, M1720, M1721, M1722, M1723, M1724, M1725, M1726, M1727, M1728, M1729, M1730, M1731, M1732, M1733, M1734, M1735, M1736, M1737, M1738, M1739, M1740, M1741, M1742, M1743, M1744, M1745, M1746, M1747, M1748, M1749, M1750, M1751, M1752, M1753, M1754, M1755, M1756, M1757, M1758, M1759, M1760, M1761, M1762, M1763, M1764, M1765, M1766, M1767, M1768, M1769, M1770, M1771, M1772, M1773, M1774, M1775, M1776, M1777, M1778, M1779, M1780, M1781, M1782, M1783, M1784, M1785, M1786, M1787, M1788, M1789, M1790, M1791, M1792, M1793, M1794, M1795, M1796, M1797, M1798, M1799, M1800, M1801, M1802, M1803, M1804, M1805, M1806, M1807, M1808, M1809, M1810, M1811, M1812, M1813, M1814, M1815, M1816, M1817, M1818, M1819, M1820, M1821, M1822, M1823, M1824, M1825, M1826, M1827, M1828, M1829, M1830, M1831, M1832, M1833, M1834, M1835, M1836, M1837, M1838, M1839, M1840, M1841, M1842, M1843, M1844, M1845, M1846, M1847, M1848, M1849, M1850, M1851, M1852, M1853, M1854, M1855, M1856, M1857, M1858, M1859, M1860, M1861, M1862, M1863, M1864, M1865, M1866, M1867, M1868, M1869, M1870, M1871, M1872, M1873, M1874, M1875, M1876, M1877, M1878, M1879, M1880, M1881, M1882, M1883, M1884, M1885, M1886, M1887, M1888, M1889, M1890, M1891, M1892, M1893, M1894, M1895, M1896, M1897, M1898, M1899, M1900, M1901, M1902, M1903, M1904, M1905, M1906, M1907, M1908, M1909, M1910, M1911, M1912, M1913, M1914, M1915, M1916, M1917, M1918, M1919, M1920, M1921, M1922, M1923, M1924, M1925, M1926, M1927, M1928, M1929, M1930, M1931, M1932, M1933, M1934, M1935, M1936, M1937, M1938, M1939, M1940, M1941, M1942, M1943, M1944, M1945, M1946, M1947, M1948, M1949, M1950, M1951, M1952, M1953, M1954, M1955, M1956, M1957, M1958, M1959, M1960, M1961, M1962, M1963, M1964, M1965, M1966, M1967, M1968, M1969, M1970, M1971, M1972, M1973, M1974, M1975, M1976, M1977, M1978, M1979, M1980, M1981, M1982, M1983, M1984, M1985, M1986, M1987, M1988, M1989, M1990, M1991, M1992, M1993, M1994, M1995, M1996, M1997, M1998, M1999, M2000, M2001, M2002, M2003, M2004, M2005, M2006, M2007, M2008, M2009, M2010, M2011, M2012, M2013, M2014, M2015, M2016, M2017, M2018, M2019, M2020, M2021, M2022, M2023, M2024, M2025, M2026, M2027, M2028, M2029, M2030, M2031, M2032, M2033, M2034, M2035, M2036, M2037, M2038, M2039, M2040, M2041, M2042, M2043, M2044, M2045, M2046, M2047, M2048, M2049, M2050, M2051, M2052, M2053, M2054, M2055, M2056, M2057, M2058, M2059, M2060, M2061, M2062, M2063, M2064, M2065, M2066, M2067, M2068, M2069, M2070, M2071, M2072, M2073, M2074, M2075, M2076, M2077, M2078, M2079, M2080, M2081, M2082, M2083, M2084, M2085, M2086, M2087, M2088, M2089, M2090, M2091, M2092, M2093, M2094, M2095, M2096, M2097, M2098, M2099, M2100, M2101, M2102, M2103, M2104, M2105, M2106, M2107, M2108, M2109, M2110, M2111, M2112, M2113, M2114, M2115, M2116, M2117, M2118, M2119, M2120, M2121, M2122, M2123, M2124, M2125, M2126, M2127, M2128, M2129, M2130, M2131, M2132, M2133, M2134, M2135, M2136, M2137, M2138, M2139, M2140, M2141, M2142, M2143, M2144, M2145, M2146, M

Enphase IQ Envoy

The Enphase IQ Envoy™ communications gateway delivers solar production and energy consumption data to Enphase Enlighten™ monitoring and analysis software for comprehensive, remote maintenance and management of the Enphase IQ System.

With integrated revenue grade production metering and optional consumption monitoring, Envoy IQ is the platform for total energy management and integrals with the Enphase Ensemble™ and the Enphase IQ Battery™.

Smart

- Enables web-based monitoring and control
- Bidirectional communications for remote upgrades
- Supports power export limiting and zeroexport applications

Simple

- Easy system configuration using Enphase Installer Toolkit™ mobile app
- Flexible networking with Wi-Fi, Ethernet, or cellular

Reliable

- Designed for installation indoors or outdoors
- Five-year warranty



To learn more about Enphase offerings, visit enphase.com

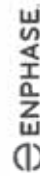

To learn more about Enphase offerings, visit enphase.com

©2017 Enphase, Inc. All rights reserved. Enphase, the Enphase logo, IQ Envoy, and Solar Production and Energy Management are trademarks of Enphase, Inc. Data subject to change. 06-16-2017

Enphase IQ Envoy

MODEL NUMBERS Enphase IQ Envoy™ ENV-IQ-AMI-240	Enphase IQ Envoy communications gateway with integrated revenue grade PV production metering and optional consumption monitoring (v1 - 2.5N) including (AMS) CT1-20 v1 - 0.5N) and optional consumption monitoring (v1 - 2.5N) and one 200A continuous rated production CT (transit transformer).
ACCESSORIES (Order Separately) Enphase Mobile Connect™ CELLMOD-M1-M1 (4G based LTE-M/5-year data plan) CELLMOD-M1-B (4G based LTE-M/5-year data plan) Consumption Monitoring CT CT-200-SPLT	Plug and play industrial grade cellular modem with data plan for systems up to 60 microconverters. (Available in the US, Canada, Mexico, Puerto Rico, and the US Virgin Islands, where there is adequate cellular service in the installation area.) Split-core consumption CTs enable whole home metering.
Enphase Communications Kit COMPS-KIT-01	Installed at the IQ Envoy. For communications with Enphase Enlighten™, Enphase and Enphase Engage™ smart switches. Includes USB cable for connection to PC and Enphase IQ Controller™ and allows wireless communication with Enlighten and Engage.
POWER REQUIREMENTS Power requirement Typical Power Consumption	100-240 VAC split phase Max 20 A overcurrent protection required. 5W
CAPACITY Number of microconverters joined	Up to 600
MECHANICAL DATA Dimensions (WxHxD) Weight Ambient temperature range Environmental rating Altitude Production CT	213 x 123 x 45 mm (8.4" x 5" x 1.8") 17.6 oz (498 g) -40° to 65° C (-40° to 149° F) -40° to 48° C (-40° to 115° F) if installed in an enclosure IP30. For installation indoors or in an NEMA-certified, NEMA type 3R enclosure. To 2000 meters (6,560 feet) - Limited to 200A of continuous current / 250A OCPD - 72NVA AC - Internal aperture measures 18.34mm to support 250MCM T11NVA conductors (max) - UL2888 certified for revenue grade metering - For electrical services to 250A with parallel runs up to 500A. - Internal aperture measures 0.84" x 0.56" (21.3mm x 14.18mm) to support 3/0 THWN conductor - UL2808 certified, for use at service entrance for services up to 250Wac
INTERNET CONNECTION OPTIONS Integrated Wi-Fi Ethernet Mobile	802.11b/g/n 802.3 Cat5E (for Cat 4) UTP Ethernet cable (not included) CELLMOD-M1 (4G) or CELLMOD-M1-B (4G). Not included. Note that an Enphase Mobile Connect cellular modem is required for all 5-assembly installations.
COMPLIANCE Compliance	UL 61010-1 CAN/CSA C22.2 No. 61010-1 4E CPE Part 1.5 Class B ICES 001 FCC Part 15 Class B ICES 002 ICES 003 ICES 004 ICES 005 ICES 006 ICES 007 ICES 008 ICES 009 ICES 010 ICES 011 ICES 012 ICES 013 ICES 014 ICES 015 ICES 016 ICES 017 ICES 018 ICES 019 ICES 020 ICES 021 ICES 022 ICES 023 ICES 024 ICES 025 ICES 026 ICES 027 ICES 028 ICES 029 ICES 030 ICES 031 ICES 032 ICES 033 ICES 034 ICES 035 ICES 036 ICES 037 ICES 038 ICES 039 ICES 040 ICES 041 ICES 042 ICES 043 ICES 044 ICES 045 ICES 046 ICES 047 ICES 048 ICES 049 ICES 050 ICES 051 ICES 052 ICES 053 ICES 054 ICES 055 ICES 056 ICES 057 ICES 058 ICES 059 ICES 060 ICES 061 ICES 062 ICES 063 ICES 064 ICES 065 ICES 066 ICES 067 ICES 068 ICES 069 ICES 070 ICES 071 ICES 072 ICES 073 ICES 074 ICES 075 ICES 076 ICES 077 ICES 078 ICES 079 ICES 080 ICES 081 ICES 082 ICES 083 ICES 084 ICES 085 ICES 086 ICES 087 ICES 088 ICES 089 ICES 090 ICES 091 ICES 092 ICES 093 ICES 094 ICES 095 ICES 096 ICES 097 ICES 098 ICES 099 ICES 100 ICES 101 ICES 102 ICES 103 ICES 104 ICES 105 ICES 106 ICES 107 ICES 108 ICES 109 ICES 110 ICES 111 ICES 112 ICES 113 ICES 114 ICES 115 ICES 116 ICES 117 ICES 118 ICES 119 ICES 120 ICES 121 ICES 122 ICES 123 ICES 124 ICES 125 ICES 126 ICES 127 ICES 128 ICES 129 ICES 130 ICES 131 ICES 132 ICES 133 ICES 134 ICES 135 ICES 136 ICES 137 ICES 138 ICES 139 ICES 140 ICES 141 ICES 142 ICES 143 ICES 144 ICES 145 ICES 146 ICES 147 ICES 148 ICES 149 ICES 150 ICES 151 ICES 152 ICES 153 ICES 154 ICES 155 ICES 156 ICES 157 ICES 158 ICES 159 ICES 160 ICES 161 ICES 162 ICES 163 ICES 164 ICES 165 ICES 166 ICES 167 ICES 168 ICES 169 ICES 170 ICES 171 ICES 172 ICES 173 ICES 174 ICES 175 ICES 176 ICES 177 ICES 178 ICES 179 ICES 180 ICES 181 ICES 182 ICES 183 ICES 184 ICES 185 ICES 186 ICES 187 ICES 188 ICES 189 ICES 190 ICES 191 ICES 192 ICES 193 ICES 194 ICES 195 ICES 196 ICES 197 ICES 198 ICES 199 ICES 200 ICES 201 ICES 202 ICES 203 ICES 204 ICES 205 ICES 206 ICES 207 ICES 208 ICES 209 ICES 210 ICES 211 ICES 212 ICES 213 ICES 214 ICES 215 ICES 216 ICES 217 ICES 218 ICES 219 ICES 220 ICES 221 ICES 222 ICES 223 ICES 224 ICES 225 ICES 226 ICES 227 ICES 228 ICES 229 ICES 230 ICES 231 ICES 232 ICES 233 ICES 234 ICES 235 ICES 236 ICES 237 ICES 238 ICES 239 ICES 240 ICES 241 ICES 242 ICES 243 ICES 244 ICES 245 ICES 246 ICES 247 ICES 248 ICES 249 ICES 250 ICES 251 ICES 252 ICES 253 ICES 254 ICES 255 ICES 256 ICES 257 ICES 258 ICES 259 ICES 260 ICES 261 ICES 262 ICES 263 ICES 264 ICES 265 ICES 266 ICES 267 ICES 268 ICES 269 ICES 270 ICES 271 ICES 272 ICES 273 ICES 274 ICES 275 ICES 276 ICES 277 ICES 278 ICES 279 ICES 280 ICES 281 ICES 282 ICES 283 ICES 284 ICES 285 ICES 286 ICES 287 ICES 288 ICES 289 ICES 290 ICES 291 ICES 292 ICES 293 ICES 294 ICES 295 ICES 296 ICES 297 ICES 298 ICES 299 ICES 300 ICES 301 ICES 302 ICES 303 ICES 304 ICES 305 ICES 306 ICES 307 ICES 308 ICES 309 ICES 310 ICES 311 ICES 312 ICES 313 ICES 314 ICES 315 ICES 316 ICES 317 ICES 318 ICES 319 ICES 320 ICES 321 ICES 322 ICES 323 ICES 324 ICES 325 ICES 326 ICES 327 ICES 328 ICES 329 ICES 330 ICES 331 ICES 332 ICES 333 ICES 334 ICES 335 ICES 336 ICES 337 ICES 338 ICES 339 ICES 340 ICES 341 ICES 342 ICES 343 ICES 344 ICES 345 ICES 346 ICES 347 ICES 348 ICES 349 ICES 350 ICES 351 ICES 352 ICES 353 ICES 354 ICES 355 ICES 356 ICES 357 ICES 358 ICES 359 ICES 360 ICES 361 ICES 362 ICES 363 ICES 364 ICES 365 ICES 366 ICES 367 ICES 368 ICES 369 ICES 370 ICES 371 ICES 372 ICES 373 ICES 374 ICES 375 ICES 376 ICES 377 ICES 378 ICES 379 ICES 380 ICES 381 ICES 382 ICES 383 ICES 384 ICES 385 ICES 386 ICES 387 ICES 388 ICES 389 ICES 390 ICES 391 ICES 392 ICES 393 ICES 394 ICES 395 ICES 396 ICES 397 ICES 398 ICES 399 ICES 400 ICES 401 ICES 402 ICES 403 ICES 404 ICES 405 ICES 406 ICES 407 ICES 408 ICES 409 ICES 410 ICES 411 ICES 412 ICES 413 ICES 414 ICES 415 ICES 416 ICES 417 ICES 418 ICES 419 ICES 420 ICES 421 ICES 422 ICES 423 ICES 424 ICES 425 ICES 426 ICES 427 ICES 428 ICES 429 ICES 430 ICES 431 ICES 432 ICES 433 ICES 434 ICES 435 ICES 436 ICES 437 ICES 438 ICES 439 ICES 440 ICES 441 ICES 442 ICES 443 ICES 444 ICES 445 ICES 446 ICES 447 ICES 448 ICES 449 ICES 450 ICES 451 ICES 452 ICES 453 ICES 454 ICES 455 ICES 456 ICES 457 ICES 458 ICES 459 ICES 460 ICES 461 ICES 462 ICES 463 ICES 464 ICES 465 ICES 466 ICES 467 ICES 468 ICES 469 ICES 470 ICES 471 ICES 472 ICES 473 ICES 474 ICES 475 ICES 476 ICES 477 ICES 478 ICES 479 ICES 480 ICES 481 ICES 482 ICES 483 ICES 484 ICES 485 ICES 486 ICES 487 ICES 488 ICES 489 ICES 490 ICES 491 ICES 492 ICES 493 ICES 494 ICES 495 ICES 496 ICES 497 ICES 498 ICES 499 ICES 500 ICES 501 ICES 502 ICES 503 ICES 504 ICES 505 ICES 506 ICES 507 ICES 508 ICES 509 ICES 510 ICES 511 ICES 512 ICES 513 ICES 514 ICES 515 ICES 516 ICES 517 ICES 518 ICES 519 ICES 520 ICES 521 ICES 522 ICES 523 ICES 524 ICES 525 ICES 526 ICES 527 ICES 528 ICES 529 ICES 530 ICES 531 ICES 532 ICES 533 ICES 534 ICES 535 ICES 536 ICES 537 ICES 538 ICES 539 ICES 540 ICES 541 ICES 542 ICES 543 ICES 544 ICES 545 ICES 546 ICES 547 ICES 548 ICES 549 ICES 550 ICES 551 ICES 552 ICES 553 ICES 554 ICES 555 ICES 556 ICES 557 ICES 558 ICES 559 ICES 560 ICES 561 ICES 562 ICES 563 ICES 564 ICES 565 ICES 566 ICES 567 ICES 568 ICES 569 ICES 570 ICES 571 ICES 572 ICES 573 ICES 574 ICES 575 ICES 576 ICES 577 ICES 578 ICES 579 ICES 580 ICES 581 ICES 582 ICES 583 ICES 584 ICES 585 ICES 586 ICES 587 ICES 588 ICES 589 ICES 590 ICES 591 ICES 592 ICES 593 ICES 594 ICES 595 ICES 596 ICES 597 ICES 598 ICES 599 ICES 600 ICES 601 ICES 602 ICES 603 ICES 604 ICES 605 ICES 606 ICES 607 ICES 608 ICES 609 ICES 610 ICES 611 ICES 612 ICES 613 ICES 614 ICES 615 ICES 616 ICES 617 ICES 618 ICES 619 ICES 620 ICES 621 ICES 622 ICES 623 ICES 624 ICES 625 ICES 626 ICES 627 ICES 628 ICES 629 ICES 630 ICES 631 ICES 632 ICES 633 ICES 634 ICES 635 ICES 636 ICES 637 ICES 638 ICES 639 ICES 640 ICES 641 ICES 642 ICES 643 ICES 644 ICES 645 ICES 646 ICES 647 ICES 648 ICES 649 ICES 650 ICES 651 ICES 652 ICES 653 ICES 654 ICES 655 ICES 656 ICES 657 ICES 658 ICES 659 ICES 660 ICES 661 ICES 662 ICES 663 ICES 664 ICES 665 ICES 666 ICES 667 ICES 668 ICES 669 ICES 670 ICES 671 ICES 672 ICES 673 ICES 674 ICES 675 ICES 676 ICES 677 ICES 678 ICES 679 ICES 680 ICES 681 ICES 682 ICES 683 ICES 684 ICES 685 ICES 686 ICES 687 ICES 688 ICES 689 ICES 690 ICES 691 ICES 692 ICES 693 ICES 694 ICES 695 ICES 696 ICES 697 ICES 698 ICES 699 ICES 700 ICES 701 ICES 702 ICES 703 ICES 704 ICES 705 ICES 706 ICES 707 ICES 708 ICES 709 ICES 710 ICES 711 ICES 712 ICES 713 ICES 714 ICES 715 ICES 716 ICES 717 ICES 718 ICES 719 ICES 720 ICES 721 ICES 722 ICES 723 ICES 724 ICES 725 ICES 726 ICES 727 ICES 728 ICES 729 ICES 730 ICES 731 ICES 732 ICES 733 ICES 734 ICES 735 ICES 736 ICES 737 ICES 738 ICES 739 ICES 740 ICES 741 ICES 742 ICES 743 ICES 744 ICES 745 ICES 746 ICES 747 ICES 748 ICES 749 ICES 750 ICES 751 ICES 752 ICES 753 ICES 754 ICES 755 ICES 756 ICES 757 ICES 758 ICES 759 ICES 760 ICES 761 ICES 762 ICES 763 ICES 764 ICES 765 ICES 766 ICES 767 ICES 768 ICES 769 ICES 770 ICES 771 ICES 772 ICES 773 ICES 774 ICES 775 ICES 776 ICES 777 ICES 778 ICES 779 ICES 780 ICES 781 ICES 782 ICES 783 ICES 784 ICES 785 ICES 786 ICES 787 ICES 788 ICES 789 ICES 790 ICES 791 ICES 792 ICES 793 ICES 794 ICES 795 ICES 796 ICES 797 ICES 798 ICES 799 ICES 800 ICES 801 ICES 802 ICES 803 ICES 804 ICES 805 ICES 806 ICES 807 ICES 808 ICES 809 ICES 810 ICES 811 ICES 812 ICES 813 ICES 814 ICES 815 ICES 816 ICES 817 ICES 818 ICES 819 ICES 820 ICES 821 ICES 822 ICES 823 ICES 824 ICES 825 ICES 826 ICES 827 ICES 828 ICES 829 ICES 830 ICES 831 ICES 832 ICES 833 ICES 834 ICES 835 ICES 836 ICES 837 ICES 838 ICES 839 ICES 840 ICES 841 ICES 842 ICES 843 ICES 844 ICES 845 ICES 846 ICES 847 ICES 848 ICES 849 ICES 850 ICES 851 ICES 852 ICES 853 ICES 854 ICES 855 ICES 856 ICES 857 ICES 858 ICES 859 ICES 860 ICES 861 ICES 862 ICES 863 ICES 864 ICES 865 ICES 866 ICES 867 ICES 868 ICES 869 ICES 870 ICES 871 ICES 872 ICES 873 ICES 874 ICES 875 ICES 876 ICES 877 ICES 878 ICES 879 ICES 880 ICES 881 ICES 882 ICES 883 ICES 884 ICES 885 ICES 886 ICES 887 ICES 888 ICES 889 ICES 890 ICES 891 ICES 892 ICES 893 ICES 894 ICES 895 ICES 896 ICES 897 ICES 898 ICES 899 ICES 900 ICES 901 ICES 902 ICES 903 ICES 904 ICES 905 ICES 906 ICES 907 ICES 908 ICES 909 ICES 910 ICES 911 ICES 912 ICES 913 ICES 914 ICES 915 ICES 916 ICES 917 ICES 918 ICES 919 ICES 920 ICES 921 ICES 922 ICES 923 ICES 924 ICES 925 ICES 926 ICES 927 ICES 928 ICES 929 ICES 930 ICES 931 ICES 932 ICES 933 ICES 934 ICES 935 ICES 936 ICES 937 ICES 938 ICES 939 ICES 940 ICES 941 ICES 942 ICES 943 ICES 944 ICES 945 ICES 946 ICES 947 ICES 948 ICES 949 ICES 950 ICES 951 ICES 952 ICES 953 ICES 954 ICES 955 ICES 956 ICES 957 ICES 958 ICES 959 ICES 960 ICES 961 ICES 962 ICES 963 ICES 964 ICES 965 ICES 966 ICES 967 ICES 968 ICES 969 ICES 970 ICES 971 ICES 972 ICES 973 ICES 974 ICES 975 ICES 976 ICES 977 ICES 978 ICES 979 ICES 980 ICES 981 ICES 982 ICES 983 ICES 984 ICES 985 ICES 986 ICES 987 ICES 988 ICES 989 ICES 990 ICES 991 ICES 992 ICES 993 ICES 994 ICES 995 ICES 996 ICES 997 ICES 998 ICES 999 ICES 1000



1423 N. Research Way
Orem, UT 84057

801.377.4480
WWW.BLUERAVEN.SOLAR.COM

COMPENSATION: THE INFORMATION
HEREIN CONTAINED SHALL NOT BE
USED FOR THE BENEFIT OF ANYONE
EXCEPT BLUE RAVEN SOLAR NOR
SHALL IT BE DISCLOSED IN WHOLE OR
IN PART TO ANY OTHER PERSON OR
ORGANIZATION WITHOUT THE WRITTEN
CONSENT OF BLUE RAVEN SOLAR, LLC.

IN CONNECTION WITH THE SALE AND
USE OF THE RESPECTIVE EQUIPMENT,
WITHOUT THE WRITTEN PERMISSION
OF BLUE RAVEN SOLAR, LLC.

NABCEP
CERTIFIED

PV INSTALLATION
PROFESSIONAL

Scott Querry
#PV-01111-015588

CONTRACTOR:
BRS FIELD OPS
385-498-8700

DRAWING BY:

PLANT DATE:

PROJECT NUMBER:

SHEET NAME:
SPEC SHEET

REVISION:
PAGE NUMBER:
SS



BLUE RAVEN

1423 N. Research Way
Orem, UT 84057
800.377.6480
WWW.BLUERAVEN-SOLAR.COM

CONFIDENTIAL - THE INFORMATION HEREIN CONTAINED SHALL NOT BE DISCLOSED TO ANY OTHER PARTY EXCEPT BLUE RAVEN SOLAR NOR SHALL IT BE DISCLOSED IN WHOLE OR IN PART TO OTHERS OUTSIDE THE COMPANY OR TO ANY OTHER REPUTABLE ORGANIZATION, EXCEPT FOR THE LIMITED USE AND REUSE OF THE RESPECTIVE EQUIPMENT WITHOUT THE WRITTEN PERMISSION OF BLUE RAVEN SOLAR LLC.



CONTRACTOR:
BRS FIELD OPS
385-498-6700

DRAWING BY:

PLOT DATE:

PROJECT NUMBER:

SHEET NAME:

SPEC SHEET

REVISION: PAGE NUMBER:

SS

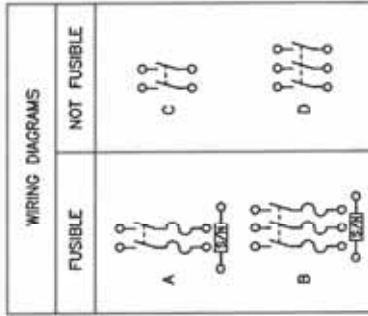

TERMINAL LUGS #	AMPERS	MAX. WIRE #	MIN. WIRE	TYPE
30	# 6 AWG	# 12 AWG	AL	
	# 5 AWG	# 14 AWG	CU	

SYMBOL	KNOCKOUTS			
	A	B	C	D
CONDUIT SIZE	.50	.75	1	1.25

DUAL DIMENSIONS: INCHES MILLIMETERS

CATALOG NUMBER	VOLTAGE RATINGS	WIRING DIAG.	HORSEPOWER RATINGS			
			120VAC STD.	120VAC MAX.	240VAC STD.	240VAC MAX.
0211NRB**	240VAC	A	1/2	2	1 1/2	3
0221NRB	240VAC	A	-	-	1 1/2	3*
0321NRB	240VAC	B	-	-	1 1/2	3
04221RB	240VAC	C	-	-	-	3
03221RB	240VAC	D	-	-	-	3

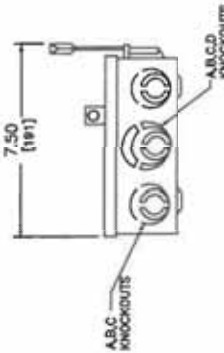
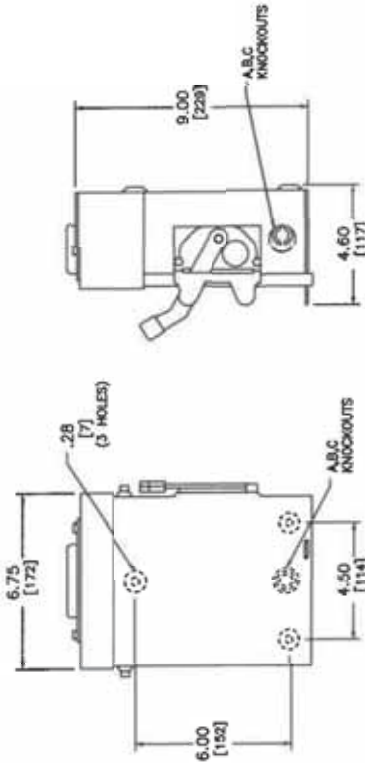

NEMA TYPE 3R ILLUSTRATED

- NOTES: - GRAY BAKED ENAMEL ELECTRODEPOSITED OVER CLEANED PHOSPHATIZED STEEL.
 UL LISTED AS FILE E-2075
 FINISH IS UNPAINTED, GROUNDABLE
 SUITABLE FOR USE AS SERVICE EQUIPMENT
 TOP OF NEMA TYPE 3R SWITCHES HAVE PROVISIONS FOR MAXIMUM 2 1/2" BOLT-ON HUB.
 SHORT CIRCUIT CURRENT RATINGS:
 * 10,000 AMPERES.
 * 100,000 AMPERES WHEN USED WITH OR PROTECTED BY CLASS H OR K FUSES.
 * FOR CORNER GROUNDING WITH CLASS R FUSES.
 * FOR CORNER GROUNDING DELTA SYSTEMS.
 # LUGS SUITABLE FOR 60°C OR 75° CONDUCTORS.

GENERAL DUTY SAFETY SWITCHES
VISIBLE BLADE TYPE
30 AMPERE
ENCLOSURE - NEMA TYPE 3R RAINPROOF

SQUARE D
by Schneider Electric

REF 1852

REF DWG #1852

FEBRUARY 2014



1423 N. Research Way
Orem, UT 84057
WWW.EZSOLARPRODUCTS.COM
800.377.4433
CONFIDENTIAL: THE INFORMATION
HEREIN CONTAINED SHALL NOT BE
USED FOR THE BENEFIT OF ANYONE
EXCEPT BLUE RAVEN SOLAR NOR
SHALL IT BE DISCLOSED IN WHOLE OR
IN PART TO ANY OTHER PERSON
WITHOUT THE WRITTEN PERMISSION
OF BLUE RAVEN SOLAR, LLC.

NABCEP
CERTIFIED
PV INSTALLATION
PROFESSIONAL
Scott Gumbert
RPV-2017-9-215688

CONTRACTOR:
BRS FIELD OPS
385-498-6700

DRAWING BY:
PROJECT NUMBER:
SHEET NAME:
REVISION:

FIGURE NO.:
FIGURE DATE:
PROJECT NUMBER:
SHEET NAME:
REVISION:
SPEC SHEET
PAGE NUMBER:
SS

A. System Specifications and Ratings

- Maximum Voltage: 1,000 Volts
- Maximum Current: 80 Amps
- Allowable Wire: 14 AWG – 6 AWG
- Spacing: Please maintain a spacing of at least 1/2" between un-insulated live parts and fittings for conduit, armored cable, and un-insulated live parts of opposite polarity.
- Enclosure Rating: Type 3R
- Roof Slope Range: 2.5 – 12:12
- Max Side Wall Fitting Size: 1"
- Max Floor Pass-Through Fitting Size: 1"
- Ambient Operating Conditions: (-35°C) - (+75°C)
- Compliance:
 - JB-1.2; UL1741
 - Approved wire connectors: must conform to UL1741
- System Marking: Interek Symbol and File #5019942
- Periodic Re-inspections: If re-inspections yield loose components, loose fasteners, or any corrosion between components, components that are found to be affected are to be replaced immediately.

ITEM NO.	PART NUMBER	DESCRIPTION	QTY
1	JB-1.2 BODY	POLYCARBONATE WITH UV INHIBITORS	1
2	JB-1.2 LID	POLYCARBONATE WITH UV INHIBITORS	1
3	#10 X 1 1/4" PHILLIPS PAN-HEAD SCREW		6
4	#8 X 3/4" PHILLIPS PAN-HEAD SCREW		6

SIZE	QTY	REV
B	JB-1.2	
SCALE: 1:2	WEIGHT LABELS	SHEET 1 OF 3
TABLE SPECIFICATION:	15-20 LBS	
CERTIFICATION:	UL STANDARD 1741, NEMA 3R	
WEIGHT:	1.46 LBS	

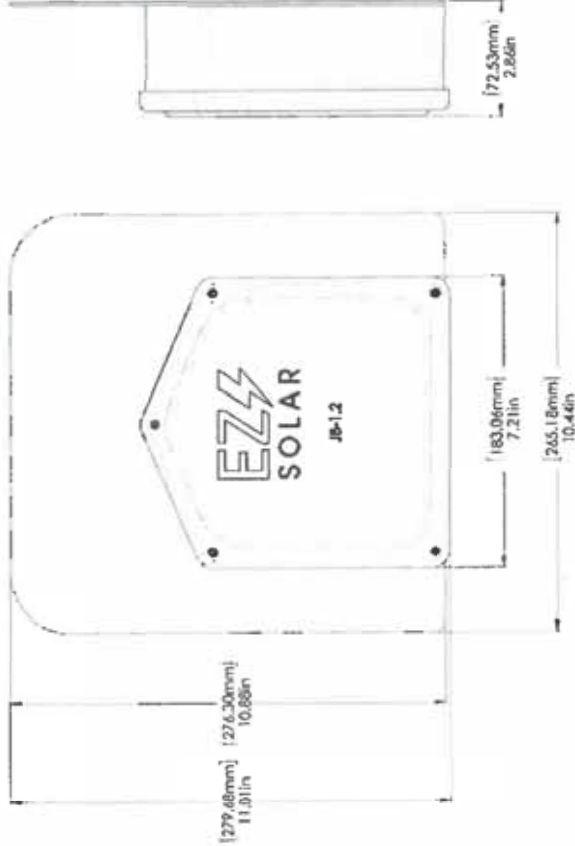

Table 1: Typical Wire Size, Torque Loads and Ratings

	1 Conductor		2 Conductor		Torque		Voltage	Current
	mm	Type	mm	Type	Inch-Lbs	Inch-Lbs		
ABB 250 terminal block	10-24 AWG	10-24 AWG	10-24 AWG	10-24 AWG	6.3 @ 95%	6.00V	600V	10 AMP
ABB 250 terminal block	6-24 AWG	10-24 AWG	10-24 AWG	10-24 AWG	8.85-14.16	600V	600V	10 AMP
ABB 250 terminal block	4-24 AWG	10-24 AWG	10-24 AWG	10-24 AWG	14.6-21.24	600V	600V	10 AMP
ABB MK60 terminal block	8-22 AWG	10-24 AWG	10-24 AWG	10-24 AWG	8.85	600V	600V	10 AMP
ABB 45.2 Red Wire, RJ-45 Connector	8-18 AWG	10-24 AWG	10-24 AWG	10-24 AWG	Self Torque	600V	600V	10 AMP
ABB 45.1 Yellow Wire, RJ-45 Connector	10-18 AWG	10-24 AWG	10-24 AWG	10-24 AWG	Self Torque	600V	600V	10 AMP
ABB In-Sure Push-in Connector Part 039	10-14 AWG	10-24 AWG	10-24 AWG	10-24 AWG	Self Torque	600V	600V	10 AMP
ABB 2204-1-201	10-20 AWG	10-24 AWG	10-24 AWG	10-24 AWG	Self Torque	600V	600V	10 AMP
ABB 221-6117	10-20 AWG	10-24 AWG	10-24 AWG	10-24 AWG	Self Torque	600V	600V	10 AMP
ABB 221-6117	6-12 AWG	10-24 AWG	10-24 AWG	10-24 AWG	Self Torque	600V	600V	10 AMP
ABB 10-5-1	4-6 AWG	10-24 AWG	10-24 AWG	10-24 AWG	Self Torque	45	2000V	
ABB 10-5-1	4-6 AWG	10-24 AWG	10-24 AWG	10-24 AWG	Self Torque	45	2000V	
ABB 10-5-1	4-6 AWG	10-24 AWG	10-24 AWG	10-24 AWG	Self Torque	45	2000V	
ABB 6-5-3	10-14 AWG	10-24 AWG	10-24 AWG	10-24 AWG	Self Torque	45	2000V	

Table 2: Minimum wire-bending space for conductors through a wall opposite terminals in mm (inches)

Wire size, AWG or kcmil	Wires per terminal (inches)			
	1	2	3	4 or More
14-20 (0.1-0.31)	mm	mm	mm	mm
8 (0.4)	mm	mm	mm	mm
6 (0.33)	mm	mm	mm	mm

"Stay Connected" with **HEYCO** Solar Power Components

© Heyco Engineering Company

Heyco®-Tite Liquid Tight Cordgrips for Enphase Q Cables

Straight-Thru, NPT Hubs with Integral Sealing Ring

The Ultimate in Liquid Tight Strain Relief Protection

ALL NEW PRODUCT!

- Two new cordgrips now accommodate the Enphase Q Cables - M3231GCZ (1/2" NPT) and M3234GDN-SM (3/4" NPT).
- The 1/2" version provides liquid tight entry for one Enphase Q Cable - .24 x .38" (6.1 x 9.7 mm).
- The 3/4" version provides liquid tight entry for up to two Enphase Q Cables - .24 x .38" (6.1 x 9.7 mm) and an additional .730" (3.3 mm) dia. hole for a #8 solid grounding cable.
- The 3/4" version utilizes our skinned-over technology so any unused holes will retain a liquid tight seal.
- Rated for use with UG Cable.

BLANK Cordgrip Configuration	PART NO.	DESCRIPTION	PART DIMENSIONS				D	E			
			A	B	C	F					
Type	Size	NPT	Max Dia.	Length	Thread	Thickness	Flat Dia.	Working Dia.			
Overall Gland	M3231GCZ	1/2" (12.7)	1.10	1.70	0.2	0.1	1.5	0.1	0.3	0.8	24.8
Break-Thru Skinned Over Gland	M3234GDN-SM	3/4" (19.0)	1.4	1.6	1.6	0.4	1.5	0.1	0.5	0.4	30.0

Metal Locknuts INCLUDED.



Material: Nylon 6/6 with TFE Sealing Blend
 Certifications: UL Listed under Underwriters Laboratories File E504900
 CSA Certified by the Canadian Standards Association file 50276
 Flammability Rating: 94V-2
 Temperature Range: Static -40°F (-40°C) to 230°F (115°C)
 Dynamic -4°F (-20°C) to 212°F (100°C)
 IP Rating: IP 68

Heyco® Helios® UVX Clip - Blind Mount

ALL NEW PRODUCT!

- The Jersey pine tree mounting style installs easily with superior holding power.
- UVX nylon protects from corrosion due to outdoor exposure.
- Installs into .260" (6.6 mm) mounting hole.
- Holds up to 2 cables between .230 - .315 (5.8 - 8.0 mm) each.
- Cables install with fingertip pressure.
- Molded from our robust UVX nylon 6/6 with extended UV capabilities for our Solar 20 Year Warranty.

PANEL THICKNESS RANGE	MINIMUM	MAXIMUM	WIRE DIAMETER RANGE	PART NO.	DESCRIPTION	MOUNTING HOLE DIA. (MINOR)				
						A	B	C		
In.	In.	In.	In.			In.	In.	In.		
.238	0.7	.250	0.4	23	(2.9 mm) - .27 (6.9 mm) each cable	M3235	Helios UVX Clip 100 Pack	.260	0.8	.264
				M3236	Helios UVX Clip Bulk					

Material: Nylon 6/6 with extended UV Capabilities
 Flammability Rating: 94V-2
 Temperature Range: Dynamic -4°F (-20°C) to 185°F (85°C)

1-800-328-4182 • 732-286-1890 (NJ) • FAX: 732-244-9843 • www.heyco.com

SFM INFINITY

UNIRAC
BETTER SOLAR STARTS HERE

BLUE RAVEN
SOLAR



UL1703



2 INSTALLS PER DAY

Make two installs per day your new standard. SFM INFINITY has fewer roof attachments, one foot installation, and pre-assembled components to get you off the roof 40% faster.

87% OF HOMEOWNERS PREFER

BETTER AESTHETICS

Install the system with the aesthetics preferred by homeowners, with integrated rams, trim, trim and caps, dark components, and recessed hardware.

MAXIMUM POWER DENSITY

Easily mix module orientations to achieve optimal power density without incurring the increased bill of materials, labor, and attachments required by rail.

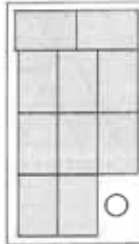

SYSTEM OVERVIEW

PART NAME	DESCRIPTION
TRIMRAIL	Structural host to all panels, brackets and other modules.
TRIMRAIL SPICE	Connects and electrically bonds sections of TRIMRAIL.
TRIMRAIL FLASHKIT	Attaches TRIMRAIL to roof. Available for composite or tile.
MODULE CLIPS	Secure modules to TRIMRAIL.
MICRORAIL	Connects modules to SUBRACK. Provides post-install array leveling.
SPICE	Connects and supports modules. Provides east-west bonding. Attachment direction also available.
SEIDER FLASHKIT	Roof attachment and flashing. Available for composite and tile.

BONDING AND ACCESSORIES

PART NAME	DESCRIPTION
TRIMRAIL ENDCAPS	Seals ends of TRIMRAIL for reduced aesthetics.
TRIMRAIL BONDING CLAMP	Electrically bonds TRIMRAIL and modules.
M/S BONDING CLAMP	Electrically bonds rows of modules.

20% FEWER ATTACHMENTS

Save time and money on every project. SFM INFINITY requires fewer attachments than rail systems.



SFM INFINITY IS Attachments



RAIL 20 Attachments

30% LOGISTICS SAVINGS

With fewer SKUs and compact components, SFM INFINITY is easier to stock, easier to transport, and easier to fit in the roof. Plus, make more efficient use of your vehicle fleet.



SFM INFINITY REVOLUTIONIZES ROOFTOP SOLAR WITH BENEFITS ACROSS YOUR BUSINESS, FROM DESIGN AND LOGISTICS, THROUGH ARRAY INSTALLATION AND SERVICE.

DRAWING NUMBER

SS

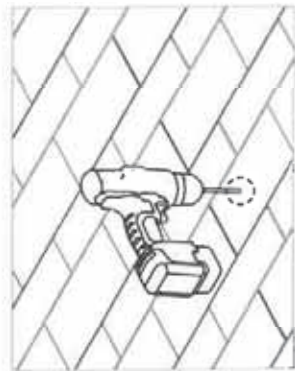

PILOT HOLES:
 Drill pilot holes for lag screws or structural screws (as necessary) at marked attachment points

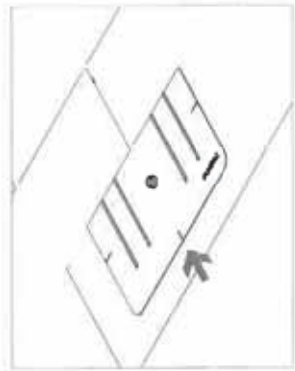

FLASHINGS:
 Place flashings

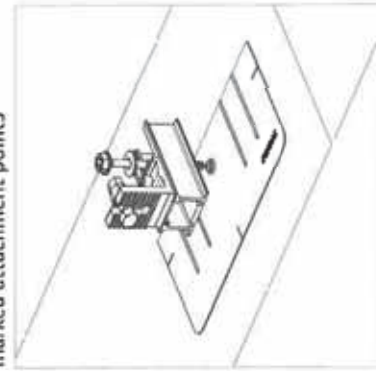

INSTALL SLIDERS AND TRIMRAIL ROOF ATTACHMENTS:

- Insert flashings per manufacturer instructions
- NOTE: Use Lag screw or structural fastener with a maximum diameter of 5/16"
- Attach sliders to rafters
- Verify proper row to row spacing for module size (Mod NS + 1')
- Ensure that Trimrail™ roof attachments in each row have sufficient engagement with slider dovetails for proper attachment.

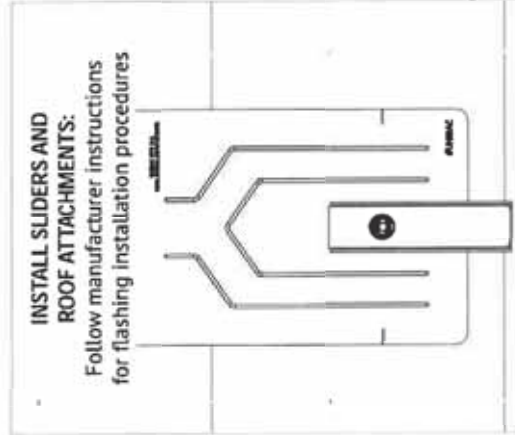
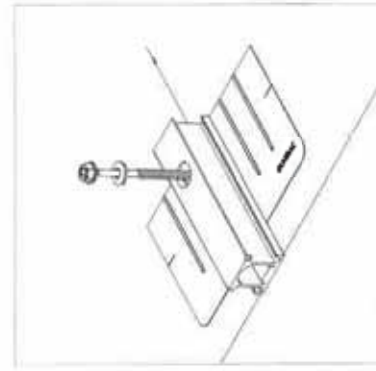

INSTALL SLIDERS AND ROOF ATTACHMENTS:
 Follow manufacturer instructions for flashing installation procedures

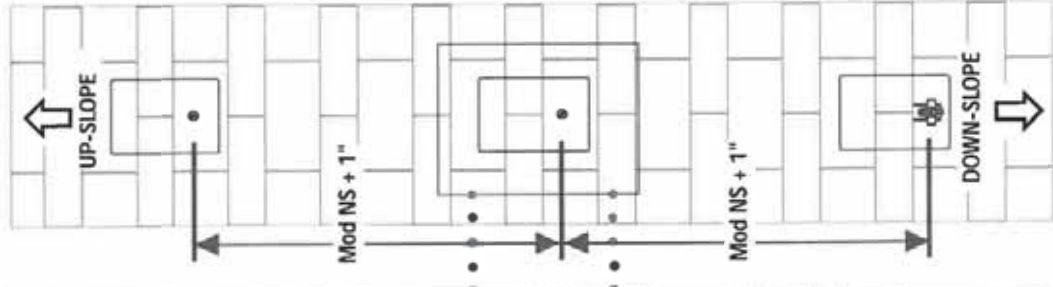
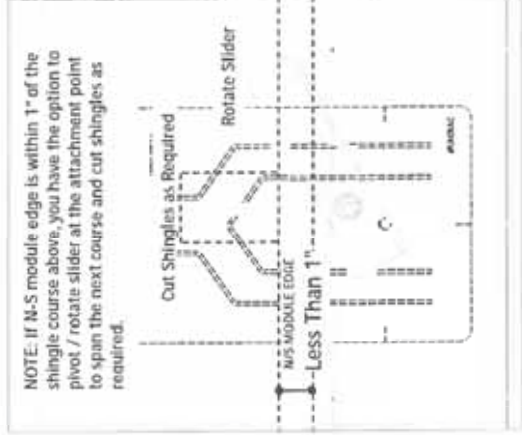

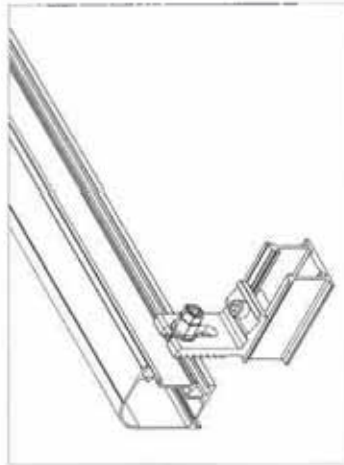

ATTACH TRIMRAIL TO ROOF ATTACHMENT:
Attach rail using 3/8" hex bolt & Tri-drive or serrated flange nuts. Make sure Trimrail™ is level across all Trimrail™ roof attachments. After rail is level, tighten channel clamp bolts to secure Trimrail™ roof attachments to channels.



INSTALL MODULE CLIPS ON TRIMRAIL:
Attach module clips to Trimrail using 3/8" T-bolts and Tri-drive or serrated flange nuts. A minimum of two clips are required per module. Refer to SFM D&E guide and U-builder for required position and quantity of module clips.

NOTE: module clips may be pre-installed on trimrail prior to attaching trimrail to roof attachments

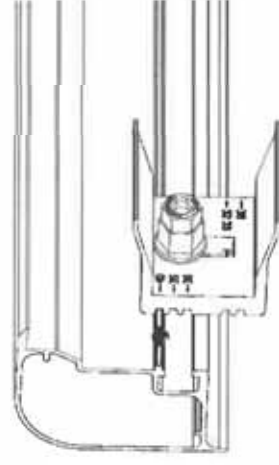

POSITION MODULE CLIPS ACCORDING TO MODULE THICKNESS:
Align notch in module clip with trimrail rib according to module thickness (identified in mm on faces of module clips). Rotate clip to position at required location.

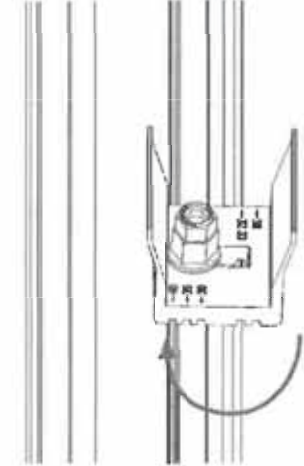

NOTE: Bonding pin on Microrails should be positioned downslope.
INSTALL MICRORAILS:
Install Microrail™ at marked attachment points. Click Microrail™ into sliders and push Microrail™ to top of slider. Ensure that cap remains in upper most (40mm) position.

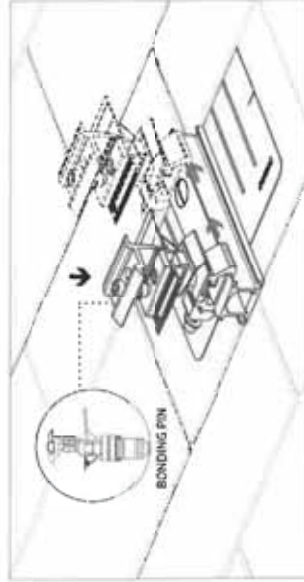

SYSTEM BONDING & GROUNDING

19

INSTALLATION GUIDE PAGE

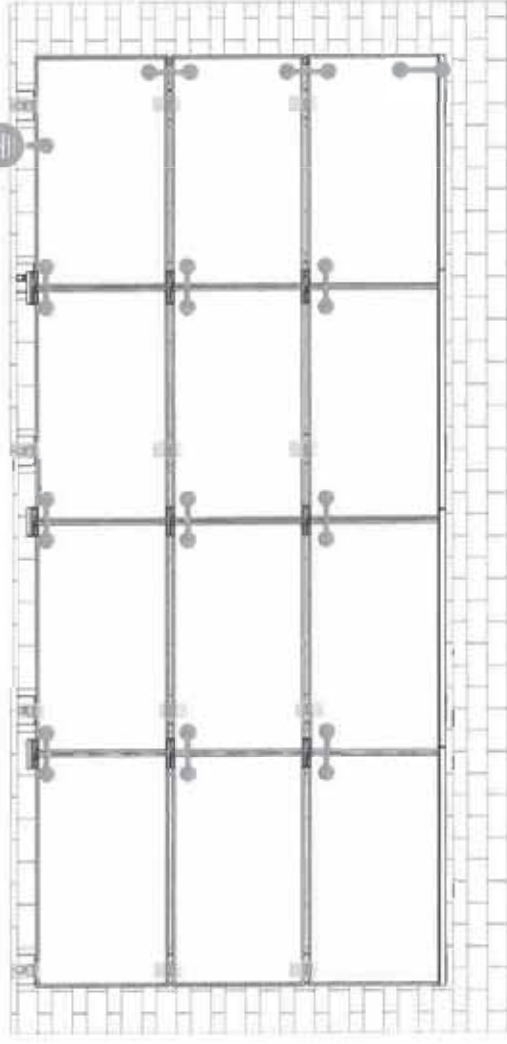

Star Washer
Single Use Only

TERMINAL TORQUE.
Install Conductor and torque to the following:
4-6 AWG: 35in-lbs
8 AWG: 25 in-lbs
10-14 AWG: 20 in-lbs



LUG DETAIL & TORQUE INFO
Ilisco Lay-In Lug (GBL-4DBT)

- 10-32 mounting hardware
- Torque = 5 ft-lb
- AWG 4-14- Solid or Stranded



TERMINAL TORQUE.
Install Conductor and torque to the following:
4-14 AWG: 35in-lbs

LUG DETAIL & TORQUE INFO
Ilisco Flange Lug (SGB-4)

- 1/4" mounting hardware
- Torque = 75 in-lb
- AWG 4-14- Solid or Stranded

WEEBLUG
Single Use Only



TERMINAL TORQUE.
Install Conductor and torque to the following:
6-14 AWG: 7ft-lbs

LUG DETAIL & TORQUE INFO
Wiley WEEBLUG (6.7)

- 1/4" mounting hardware
- Torque = 10 ft-lb
- AWG 6-14- Solid or Stranded

NOTE: ISOLATE COPPER FROM ALUMINUM CONTACT TO PREVENT CORROSION

System bonding is accomplished through modules. System grounding accomplished by attaching a ground lug to any module at a location on the module specified by the module manufacturer.



E-W BONDING PATH:
E-W module to module bonding is accomplished with 2 pre-installed bonding pins which engage on the secure side of the Microrail™ and splice.

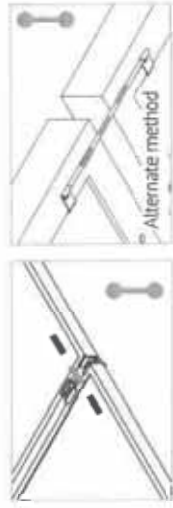

N-S BONDING PATH:
N-S module to module bonding is accomplished with bonding clamp with 2 integral bonding pins. (refer also to alternate method)



TRIMRAIL BONDING PATH:
Trimrail to module bonding is accomplished with bonding clamp with integral bonding pin and bonding T-bolt. (refer also to alternate method)

SYSTEM LEVEL FIRE CLASSIFICATION

The system fire class rating requires installation in the manner specified in the SUNFRAME MICRORAIL (SFM) Installation Guide. SFM has been classified to the system level fire portion of UL 1703. This UL 1703 classification has been incorporated into the UL 2703 product certification. SFM has achieved Class A, B & C system level performance for low slope & steep sloped roofs when used in conjunction with type 1 and type 2 modules. Class A, B & C system level fire

performance is inherent in the SFM design, and no additional mitigation measures are required. The fire classification rating is valid for any roof pitch. There is no required minimum or maximum height limitation above the roof deck to maintain the Class A, B & C fire rating for SFM. SUNFRAME MICRORAIL™ components shall be mounted over a fire resistant roof covering rated for the application.

Module Type	Roof Slope	System Level Fire Rating	Microrail Direction	Module Orientation	Mitigation Required
Type 1 and Type 2	Steep Slope & Low Slope	Class A, B & C	East-West	Landscape OR Portrait	None Required

UL2703 TEST MODULES

See pages 22 and 23 for a list of modules that were electrically and mechanically tested or qualified with the SUNFRAME MICRORAIL (SFM) components outlined within this Installation Guide.

- Maximum Area of Module = 27.76 sqft
- UL2703 Design Load Ratings:
 - a) Downward Pressure – 113 PSF / 5400 Pa
 - b) Upward Pressure – 50 PSF / 2400 Pa
 - c) Down-Slope Load – 21.6 PSF / 1034 Pa
- Tested Loads:
 - a) Downward Pressure – 170 PSF / 8000 Pa
 - b) Upward Pressure – 75 PSF / 3500 Pa
 - c) Down-Slope Load – 32.4 PSF / 1550 Pa
- Maximum Span = 6ft
- Use with a maximum over current protection device OCPD of 30A
- System conforms to UL Std 2703, certified to LTR AE-001-2012
- Rated for a design load of 2400 Pa / 5400 Pa with 24 inch span
- PV modules may have a reduced load rating, independent of the SFM load rating. Please consult the PV module manufacturer's installation guide for more information
- Down-Slope design load rating of 30 PSF/ 1400 Pa for module areas of 22.3 sq ft or less

SFM SUN
FRAME
MICRORAIL™

UL CODE COMPLIANCE NOTES 21
INSTALLATION GUIDE PAGE

LABEL MARKINGS

- System fire class rating: See installation instructions for installation requirements to achieve a specified system fire class rating with Unirac.
- Unirac SUNFRAME MICRORAIL™ is listed to UL 2703.
- All splices within a system are shipped with marking indicating date and location of manufacture.

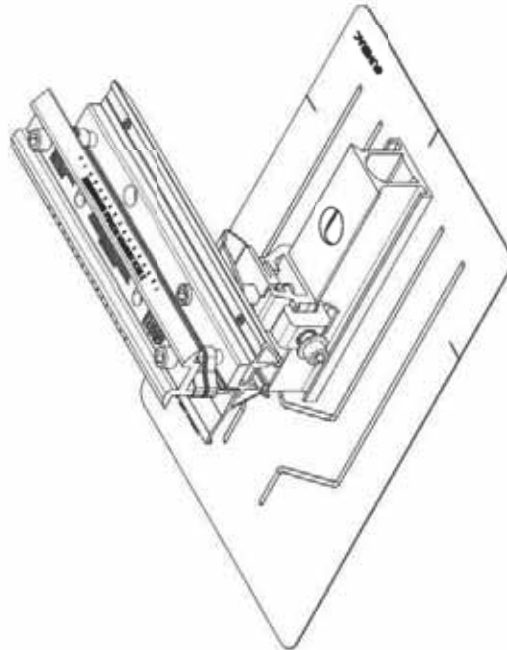

Manufacture	Module Model / Series	Manufacture	Module Model / Series	Manufacture	Module Model / Series
Panasonic	EVPxxxx (HX/PK), VBHxxxxSA15 & SA16, VBHxxxxSA17 & SA18, VBHxxxxSA17(E/G) & SA18E, VBHxxxxKA01 & KA05 & KA0A, VBHxxxxZA01, VBHxxxxZA02, VBHxxxxZA03, VBHxxxxZA04	REC Solar (cont.)	TwinPeak Series TwinPeak 2 Series TwinPeak 2 BLK2 Series TwinPeak 25P(172)XX TwinPeak 3 Series (58mm) TP4 (Black)	Suniva	MV Series & Optimus Series A-Series A400-BLK, SPR-MAX3-XXX-R, X-Series, E-Series & P-Series
	Peimar	Renesola	Vitus2 Series & 156 Series	SunPower	STP, STPXXX - B60/Whhb TP572, TP596, TP654, TP660, TP672, Hipar M, Smart
	Phono Solar	Risen	R3172-6 (MDG) (M), R3M60-6	Talesun	TP672, Hipar M, Smart SC, SC B, SC B1, SC B2 Txxxx, Txxxx
	Ptism Solar	SEG Solar	SEG-xxxx-BMD-HV SEG-xxx-BMD-TB	Tesla	PA05, PD05, DD05, DE06, DD06, PE06, PD14, PE14, DD14, DE09.05, DE14, DE15, PE15H
	Q.Cells	S-Energy	SN72 & SN60 Series (40mm)	Trina	UP-MxxxxP(B), UP-MxxxxM(B)
REC Solar	PS-60, PS-72	Scraper	SEG-6 & SRP-6 Series	Upolar	07M-xxxx-7A, D7(M/K)xxxxH8A FAKxxxx(CB/G/E8/G), FAKxxxxE7G-BB FAKxxxxEBG(-BB) FBHxxxxMG-BB
	PT2 Series	Sharp	NU-SA & NU-SC Series	United Renewable Energy (URE)	Eldora, Solivo, Somera
	Plus, Pro, Peak, G3, G4, G5, G6(+), G7, G8(+) Pro, Peak L-G2, L-G4, L-G5, L-G6, L-G7	Silfab	SLA, SLG, BC Series & SLxxx(BL/NL/NT/HL/ML/BK/XX/NU/HQ)	Vikram	AC & Adlyr Series WST & WSP Series YGE & YLM Series
	Q.PEAK DUO BLK-G6+	Solarer USA	SE-166'83-xxxxM-120N	Winneco	ZXH6-72, ZXM6-NH144-166_2094
	Q.PEAK DUO BLK-G6+7S	Solaria	PowerXT-xxxx(-JAC/PD/BD)	Yingli	
	Q.PEAK DUO (BLK)-G8(+)	SolarWorld	PowerXT-xxxxC-PD PowerXT-xxxxR-PM (AC)	ZN Shine	
	Q.PEAK DUO L-G8.3(BFF)		Summodule Protect, Summodule Plus		
	Q.PEAK DUO (BLK) ML-G9(+)		SS-M-360 to 390 Series, SS-M-390 to 400 Series, SS-M-440 to 460 Series, SS-M-430 to 460 Bifacial Series, SS-230 - 265		
	Q.PEAK DUO XL-G(10/10.2/10.3/10.4/10.d)		F-Series, R-Series & FLEX FXS Series		
	Q.PEAK DUO BLK ML-G10+ /1				

- Unless otherwise noted, all modules listed above include all wattages and specific models within that series. Variable wattages are represented as 'xxx'
- Items in parenthesis are those that may or may not be present in a compatible module's model ID
- Slashes '/' between one or more items indicates that either of those items may be the one that is present in a module's model ID
- Please see the SFM UL2703 Construction Data Report at Unirac.com to ensure the exact solar module selected is approved for use with SFM
- SFM Infinity is not compatible with module frame height of less than 30mm and more than 40mm. See Module Mounting section, page 12 for further information



AUTHORIZATION TO MARK

This authorizes the application of the Certification Mark(s) shown below to the models described in the Product(s) Covered section when made in accordance with the conditions set forth in the Certification Agreement and Listing Report. This authorization also applies to multiple listed model(s) identified on the correlation page of the Listing Report.

This document is the property of Intertek Testing Services and is not transferable. The certification mark(s) may be applied only at the location of the Party Authorized To Apply Mark.

Applicant: Unirac, Inc. **Manufacturer:**
Address: 1411 Broadway Blvd NE
Albuquerque, NM 87102
Country: USA
Party Authorized To Apply Mark: Same as Manufacturer
Report Issuing Office: Intertek Testing Services NA, Inc., Lake Forest, CA
Control Number: 5003705 **Authorized by:** *Kimberly L. Lundy*
for L. Matthew Snyder, Certification Manager



This document supersedes all previous Authorizations to Mark for the noted Report Number.

This authorization is made in full compliance with the requirements of the Certification Agreement between Intertek and the Client. Intertek's responsibility and liability are limited to the terms and conditions of the agreement. Intertek assumes no liability for any party other than the Client who certifies with the agreement. Use of Intertek's Certification mark is restricted to the conditions set forth in the Agreement and in the Authorization to Mark. Any further use of the Intertek mark for the sale or advertisement of the listed product or service that has not been approved in writing by Intertek, Intertek Testing Services and/or Intertek USA Inc. is prohibited. Intertek Testing Services and/or Intertek USA Inc. are not responsible for any consequences that may result from the use of the Intertek mark for the sale or advertisement of the listed product or service that has not been approved in writing by Intertek, Intertek Testing Services and/or Intertek USA Inc. Intertek Testing Services and/or Intertek USA Inc. are not responsible for any consequences that may result from the use of the Intertek mark for the sale or advertisement of the listed product or service that has not been approved in writing by Intertek, Intertek Testing Services and/or Intertek USA Inc.

Intertek Testing Services NA Inc.
545 East Algonquin Road, Arlington Heights, IL 60005
Telephone 800-345-3851 or 847-439-5667 Fax 312-263-1672

Standard(s):	Mounting Systems, Mounting Devices, Clamping/Retention Devices, and Ground Lugs for Use with Flat-Plate Photovoltaic Modules and Panels [UL 2703:2015 Ed.1+R:24Mar2021] PV Module and Panel Racking Mounting System and Accessories [CSA TIL No. A-40:2020]
Product:	Photovoltaic Mounting System, Sun Frame Microcell Installation Guide, PUB2023MAY10
Brand Name:	Unirac
Model:	Unirac SFM



AUTHORIZATION TO MARK

This authorizes the application of the Certification Mark(s) shown below to the models described in the Product(s) Covered section when made in accordance with the conditions set forth in the Certification Agreement and Listing Report. This authorization also applies to multiple listed model(s) identified on the correlation page of the Listing Report.

This document is the property of Intertek Testing Services and is not transferable. The certification mark(s) may be applied only at the location of the Party Authorized To Apply Mark.

Applicant: Unirac, Inc. **Manufacturer:**
Address: 1411 Broadway Blvd NE
Albuquerque, NM 87102
Country: USA
Party Authorized To Apply Mark: Same as Manufacturer
Report Issuing Office: Intertek Testing Services NA, Inc., Lake Forest, CA
Control Number: 5014989 **Authorized by:** *Kimberly L. Lundy*
for L. Matthew Snyder, Certification Manager



This document supersedes all previous Authorizations to Mark for the noted Report Number.

This authorization is made in full compliance with the requirements of the Certification Agreement between Intertek and the Client. Intertek's responsibility and liability are limited to the terms and conditions of the agreement. Intertek assumes no liability for any party other than the Client who certifies with the agreement. Use of Intertek's Certification mark is restricted to the conditions set forth in the Agreement and in the Authorization to Mark. Any further use of the Intertek mark for the sale or advertisement of the listed product or service that has not been approved in writing by Intertek, Intertek Testing Services and/or Intertek USA Inc. is prohibited. Intertek Testing Services and/or Intertek USA Inc. are not responsible for any consequences that may result from the use of the Intertek mark for the sale or advertisement of the listed product or service that has not been approved in writing by Intertek, Intertek Testing Services and/or Intertek USA Inc.

Intertek Testing Services NA Inc.
545 East Algonquin Road, Arlington Heights, IL 60005
Telephone 800-345-3851 or 847-439-5667 Fax 312-263-1672

Standard(s):	Mounting Systems, Mounting Devices, Clamping/Retention Devices, and Ground Lugs for Use with Flat-Plate Photovoltaic Modules and Panels [UL 2703:2015 Ed.1+R:24Mar2021] PV Module and Panel Racking Mounting System and Accessories [CSA TIL No. A-40:2020]
Product:	Photovoltaic Mounting System, Sun Frame Microcell Installation Guide, PUB2023MAY10
Brand Name:	Unirac
Model:	Unirac SFM

Listing Constructional Data Report (CDR)

Listing Constructional Data Report (CDR)

1.0 Reference and Address	
Report Number	1023292LAX-002
Original	11-Apr-2016
Revised	5-Oct-2022
Standard(s)	Mounting Systems, Mounting Devices, Clamping/Retention Devices, and Ground Lugs for Use with Flat-Plate Photovoltaic Modules and Panels [UL 2703.2015 Ed.1+R:24Mar2021] PV Module and Panel Racking Mounting System and Accessories [CSA TIL No. A-40:2020]

1.0 Reference and Address	
Report Number	1023292LAX-002
Original	11-Apr-2015
Revised	5-Oct-2022
Email	

Applicant	Manufacturer 2
Address	Address
Country	Country
Contact	Contact
Phone	Phone
FAX	FAX
Email	Email

Manufacturer 3	Manufacturer 4
Address	Address
Country	Country
Contact	Contact
Phone	Phone
FAX	FAX
Email	Email

Manufacturer 5
Address
Country
Contact
Phone
FAX

This report is for the exclusive use of Intertek's Client and is provided pursuant to the agreement between Intertek and its Client. Intertek's responsibility and liability are limited to the terms and conditions of the agreement. Intertek assumes no liability to any party other than the Client in accordance with the agreement for any loss, expense or damage occasioned by the use of this report. Only the Client is authorized to permit copying or distribution of this report and any information contained herein. The observations and test results in this report are relevant only to the sample tested. This report by itself does not imply that the material, product, or service is or has ever been under an Intertek certification program.

This report is for the exclusive use of Intertek's Client and is provided pursuant to the agreement between Intertek and its Client. Intertek's responsibility and liability are limited to the terms and conditions of the agreement. Intertek assumes no liability to any party other than the Client in accordance with the agreement for any loss, expense or damage occasioned by the use of this report. Only the Client is authorized to permit copying or distribution of this report and any information contained herein. The observations and test results in this report are relevant only to the sample tested. This report by itself does not imply that the material, product, or service is or has ever been under an Intertek certification program.



2.0 Product Description	
Product Brand name	Unirac
Description	<p>The product covered by this report is the Sun Frame Micro Rail roof mounted Photovoltaic Rack Mounting System. This system is designed to provide bonding and grounding to photovoltaic modules. The mounting system employs anodized or mill finish aluminum brackets that are roof mounted using the slider, outlined in section 4 of this report. There are no rails within this product, whereas the 3" Micro Rail, Floating Splice, and 9" Attached Splice electrically bond the modules together forming the path to ground.</p> <p>The Micro Rails are installed onto the module frame by using a stainless steel bolt anodized with black oxide with a stainless type 300 bonding pin, torqued to 20 ft-lbs, retaining the modules to the bracket. The bonding pin of the Micro Rail when bolted and torqued, penetrates the anodized coating of the photovoltaic module frame (at bottom flange) to contact the metal, creating a bonded connection from module to module.</p> <p>The grounding of the entire system is intended to be in accordance with the latest edition of the National Electrical Code, including NEC 250: Grounding and Bonding, and NEC 690: Solar Photovoltaic Systems or the Canadian Electrical Code, CSA C22.1 Part 1 in accordance to the revision in effect in the jurisdiction in which the project resides. Any local electrical codes must be adhered to in addition to the national electrical codes. The Grounding Lug is secured to the photovoltaic module, torqued in accordance with the installation manual provided in this document.</p> <p>Other optional grounding includes the use of the Emphase UL2703 certified grounding system, which requires a minimum of 2 micro-inverters mounted to the same rail, and using the same engage cable.</p>

2.0 Product Description	
Models	Unirac SFM
Model Similarity	NA
Fuse Rating: 30A	
Module Orientation: Portrait or Landscape	
Maximum Module Size: 17.98 ft	
UL2703 Design Load Rating: 33 PSF Downward, 33 PSF Upward, 10 PSF Down-Slope	
Tested Loads - 50 psf/2400Pa Downward, 50psf/2400Pa Uplift, 15psf/720Pa Down Slope	
Trina TSM-25SPD05-08 and Sunpower SPR-E20-327 used for Mechanical Loading	
Increased size ML test:	
Maximum Module Size: 22.3 ft	
UL2703 Design Load Rating: 113 PSF Downward, 50 PSF Upward, 30 PSF Down-Slope	
LG35S2W-A5	
used for Mechanical Loading test.	
Mounting configuration: Four mountings on each long side of panel with the longest span of 24"	
UL2703 Design Load Rating: 46.9 PSF Downward, 40 PSF Upward, 10 PSF Down-Slope	
LG395N2W-A5,	
LG360S2W-A5 and LG35S2W-A5 used for used for Mechanical Loading test.	
Mounting configuration: Six mountings for two modules used with the maximum span of 74.5"	
IEC 61646 Test Loads - 112.78 psf/5400Pa Downward, 50psf/2400Pa Uplift	
Ratings	<p>Mechanical Load test to add FishLoc Slider and Trim Assemblies to UL2703 and IEC 61646 Certifications, & Increase SFM System UL2703 Module Size.</p> <p>Maximum Module Size: 27.76 ft</p> <p>UL2703 Design Load Rating: 113 PSF Downward, 50 PSF Upward, 21.6 PSF Down-Slope</p> <p>Jirko Eagle 72HM G5 used for Mechanical Loading test.</p> <p>Mounting configuration: Four mountings on each long side of panel with the longest span of 24"</p> <p>Maximum module size: 21.86 ft</p> <p>IEC 61646 Test Loads - 112.78 psf/5400Pa Downward, 75psf/3600Pa Uplift</p> <p>SunPower model SPR-A430-COM-MLSD used for Mechanical Loading</p>
Other Ratings	<p>Fire Class Resistance Rating:</p> <ul style="list-style-type: none"> - Class A for Steep Slope Applications when using Type 1 Modules. Can be installed at any interstitial gap. Installations must include Trim Rail. - Class A for Steep Slope Applications when using Type 2 Modules. Can be installed at any interstitial gap. Installations must include Trim Rail. - Class A Fire Rated for Low Slope applications with Type 1 or 2 listed photovoltaic modules. This system was evaluated with a 5" gap between the bottom of the module and the roof's surface <p>See section 7.0 illustrations # 1, 1a and 1b for a complete list of PV modules evaluated with these racking systems</p>