

PROJECT DESCRIPTION:

18 X 380 SILFAB SOLAR SIL-380 HC MODULES
 ROOF MOUNTED SOLAR PHOTOVOLTAIC MODULES

SYSTEM SIZE: 6.84 kW DC STC
 ARRAY AREA: ROOF#1 - 39.32 SQ FT
 ARRAY AREA: ROOF#2 - 275.24 SQ FT
 ARRAY AREA: ROOF#3 - 39.32 SQ FT

EQUIPMENT SUMMARY

- 18 SILFAB SOLAR SIL-380 HC MODULES
- 04 GENERAC PV LINK S2502 POWER OPTIMIZERS
- 01 GENERAC PWRCELL XVT076A03 (7.6KW) INVERTER

APPLICABLE CODES & STANDARDS

NORTH CAROLINA RESIDENTIAL CODE 2018
 NEC 2017

AUTHORITIES HAVING JURISDICTION

- BUILDING : HARNETT COUNTY
- ZONING : HARNETT COUNTY
- UTILITY : CENTRAL ELECTRIC MEMBERSHIP CORP.

DESIGN SPECIFICATIONS

- OCCUPANCY : II
- CONSTRUCTION : SINGLE-FAMILY
- ZONING : RESIDENTIAL
- GROUND SNOW LOAD : SEE STRUCTURAL LETTER
- WIND EXPOSURE : SEE STRUCTURAL LETTER
- WIND SPEED : SEE STRUCTURAL LETTER



2 HOUSE PHOTO
 PV-1 | SCALE: NTS



3 VICINITY MAP
 PV-1 | SCALE: NTS

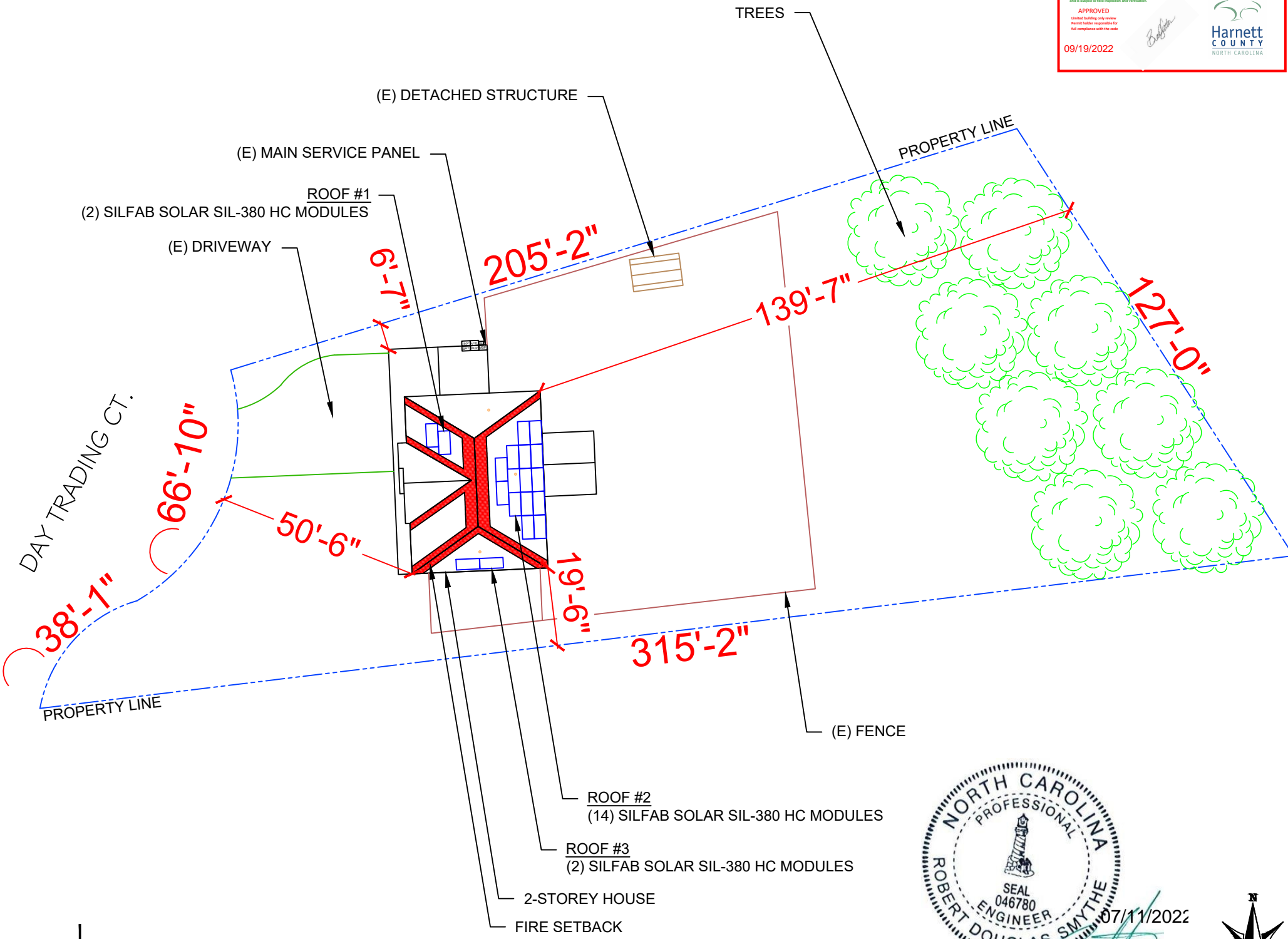

1 PLOT PLAN & VICINITY MAP
 PV-1 | SCALE: 1"=30'-0"

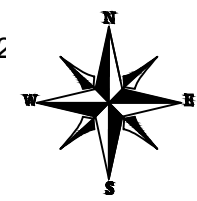
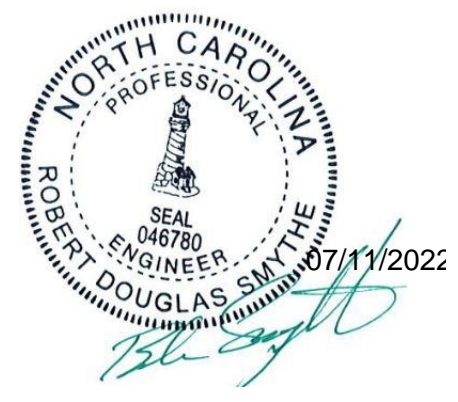

SHEET INDEX

PV-1	PLOT PLAN & VICINITY MAP
PV-2	ROOF PLAN & MODULES
PV-2A	STRING LAYOUT
PV-3	ATTACHMENT DETAIL
PV-4	ELECTRICAL LINE DIAGRAM
PV-5	WIRING CALCULATIONS
PV-6 to 12	EQUIPMENT SPECIFICATIONS
PV-13	AS BUILT SIGN OFF

pinkenergy
 Proud Sponsor of Planet Earth

PINK ENERGY
 PROUD SPONSOR OF PLANET EARTH
 919 N. MAIN ST.
 MOORESVILLE, NC 28115
 Web: www.gopink.com

REVISIONS

DESCRIPTION	DATE	REV

Signature with Seal

DATE: 7/8/2022

PROJECT NAME & ADDRESS

THOMAS K JOHNSON
 RESIDENCE
 48 DAY TRADING CT.,
 BROADWAY, NC 27505

SHEET NAME
PLOT PLAN & VICINITY MAP

SHEET SIZE
**ANSI B
 11" X 17"**

SHEET NUMBER
PV-1

MODULE TYPE, DIMENSIONS & WEIGHT

NUMBER OF MODULES = 18 MODULES
 MODULE TYPE = SILFAB SOLAR SIL-380 HC MODULES
 MODULE WEIGHT = 43.0 LBS / 19.5 KG.
 MODULE DIMENSIONS = 69.4"x 40.8" = 19.66 SF
 UNIT WEIGHT OF ARRAY = 2.18 PSF

ROOF DESCRIPTION				
ROOF TYPE			COMPOSITION SHINGLE	
ROOF	ROOF TILT	AZIMUTH	FRAMING SIZE	FRAMING SPACING
#1	30.26°	268°	SEE STRUCTURAL LETTER	
#2	30.26°	88°		
#3	39.81°	178°		

ARRAY AREA & ROOF AREA CALC'S				
ROOF	# OF MODULES	ARRAY AREA (Sq. Ft.)	ROOF AREA (Sq. Ft.)	ROOF AREA COVERED BY ARRAY (%)
#1	2	39.32	402.82	10
#2	14	275.24	561.72	49
#3	2	39.32	188.64	21

pinkenergy
 Proud Sponsor of Planet Earth

PINK ENERGY
 PROUD SPONSOR OF PLANET EARTH
 919 N. MAIN ST.
 MOORESVILLE, NC 28115
 Web: www.gopink.com

REVISIONS		
DESCRIPTION	DATE	REV

Signature with Seal

DATE: 7/8/2022

PROJECT NAME & ADDRESS

**THOMAS K JOHNSON
 RESIDENCE**
 48 DAY TRADING CT.,
 BROADWAY, NC 27505

SHEET NAME
ROOF PLAN & MODULES

SHEET SIZE
**ANSI B
 11" X 17"**

SHEET NUMBER
PV-2

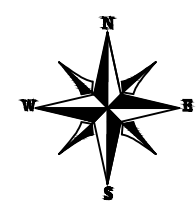

1 | **ROOF PLAN & MODULES**
 PV-2 | SCALE: 1/8" = 1'-0"

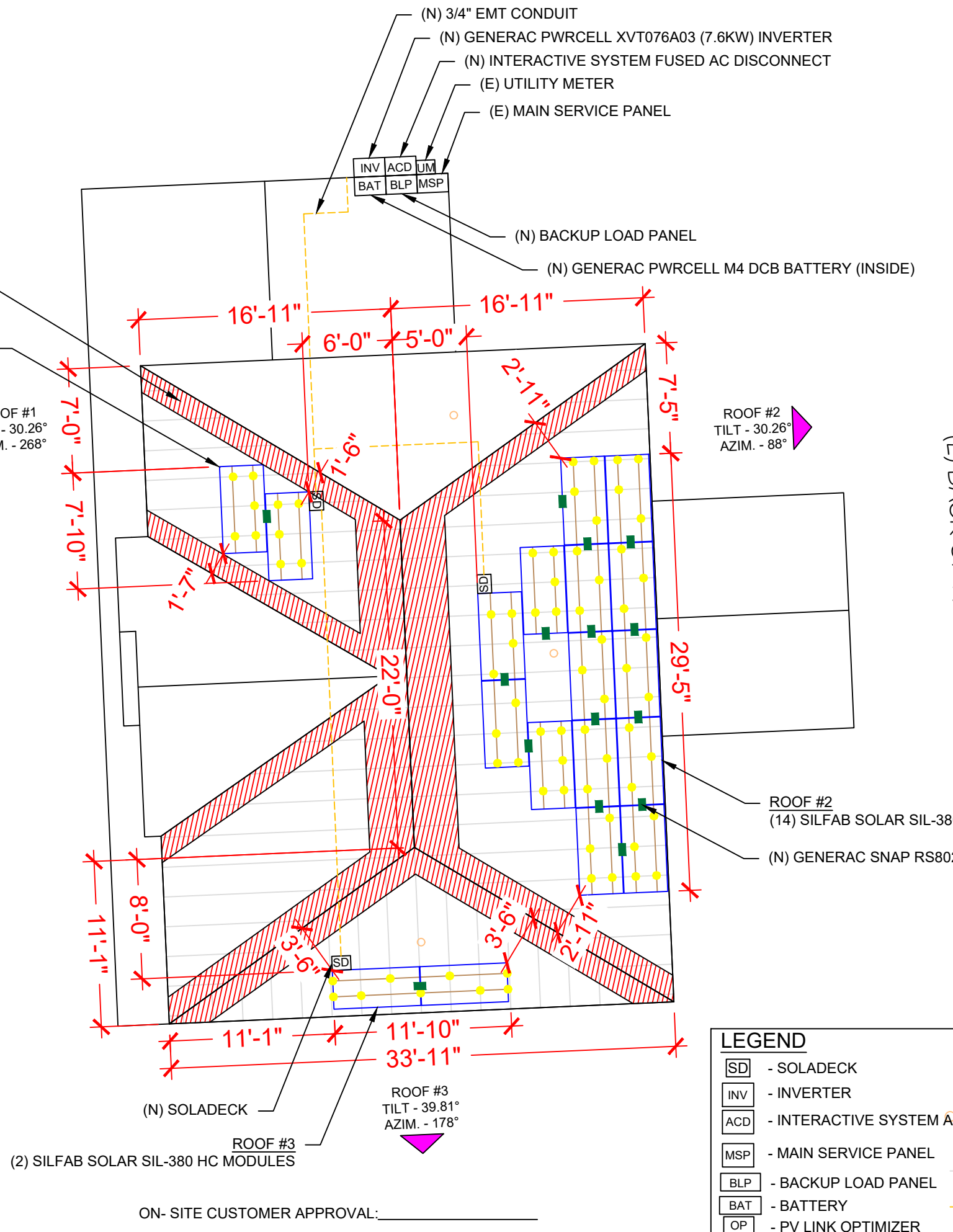

LEGEND

[SD] - SOLADECK	[] - VENT, ATTIC FAN (ROOF OBSTRUCTION)
[INV] - INVERTER	[] - RAFTERS
[ACD] - INTERACTIVE SYSTEM AC DISCONNECT	[] - CONDUIT
[MSP] - MAIN SERVICE PANEL	[] - RAPID SHUTDOWN
[BLP] - BACKUP LOAD PANEL	
[BAT] - BATTERY	
[OP] - PV LINK OPTIMIZER	

ON- SITE CUSTOMER APPROVAL: _____

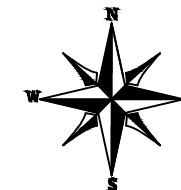

pinkenergy
Proud Sponsor of Planet Earth

PINK ENERGY
PROUD SPONSOR OF PLANET EARTH
919 N. MAIN ST.
MOORESVILLE, NC 28115
Web: www.gopink.com

REVISIONS

DESCRIPTION	DATE	REV

Signature with Seal

DATE: 7/8/2022

PROJECT NAME & ADDRESS

THOMAS K JOHNSON
RESIDENCE
48 DAY TRADING CT.,
BROADWAY, NC 27505

SHEET NAME

STRING
LAYOUT

SHEET SIZE

ANSI B
11" X 17"

SHEET NUMBER

PV-2A

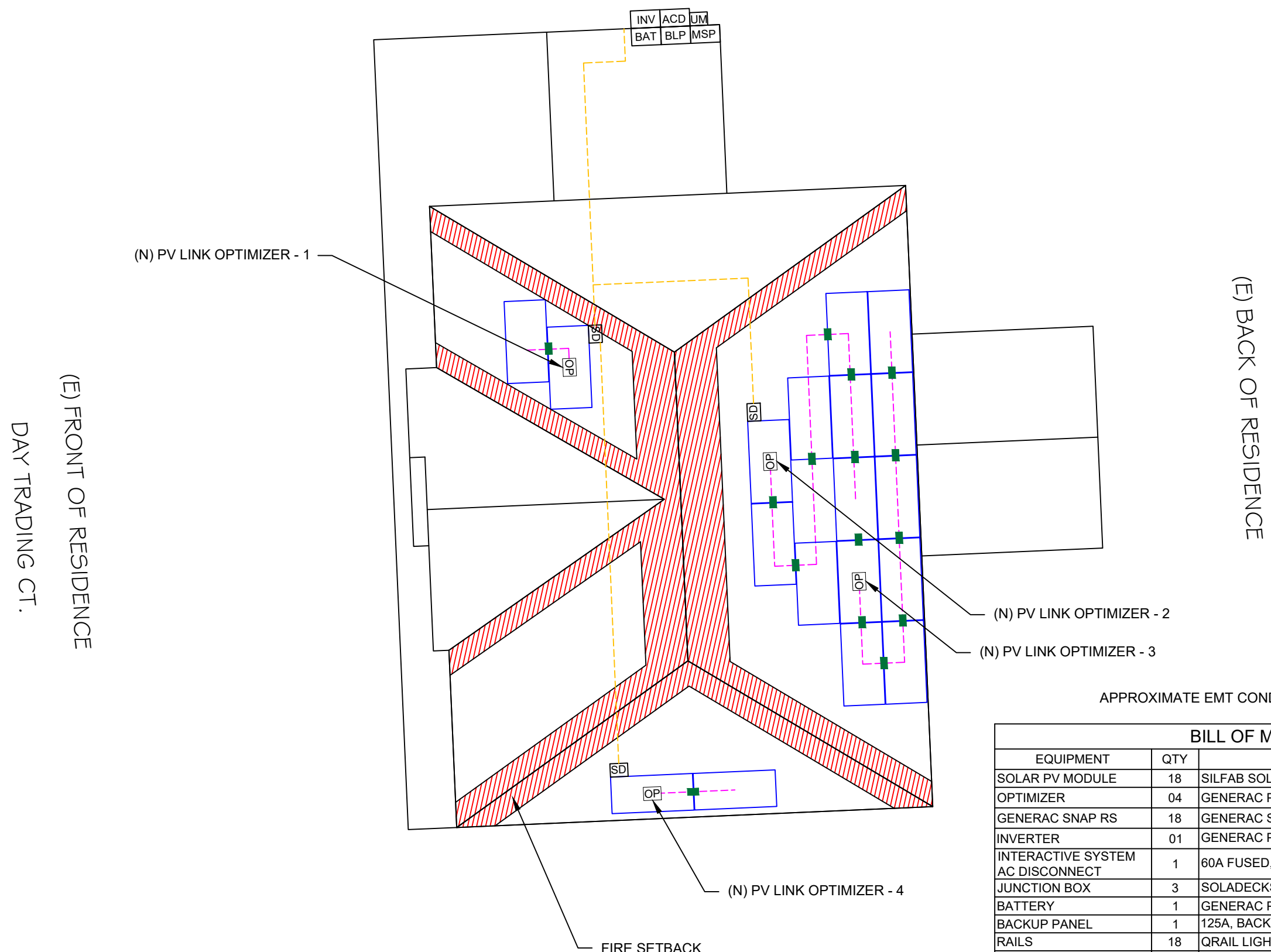

APPROXIMATE EMT CONDUIT LENGTH = 88'-0"

BILL OF MATERIALS

EQUIPMENT	QTY	DESCRIPTION
SOLAR PV MODULE	18	SILFAB SOLAR SIL-380 HC MODULES
OPTIMIZER	04	GENERAC PV LINK S2502 POWER OPTIMIZERS
GENERAC SNAP RS	18	GENERAC SNAPRS MODEL RS802
INVERTER	01	GENERAC PWRCELL XVT076A03 (7.6KW) INVERTER
INTERACTIVE SYSTEM AC DISCONNECT	1	60A FUSED, (2) 40A FUSES, 240V, NEMA 3R, UL LISTED
JUNCTION BOX	3	SOLADECKS 600 V, NEMA 3R, UL LISTED
BATTERY	1	GENERAC PWRCELL OR M4 DCB BATTERY
BACKUP PANEL	1	125A, BACKUP PANEL, 240V
RAILS	18	QRAIL LIGHT 14 FT. BLACK
SPLICE KIT	8	QSPLICE INTERNAL LIGHT
WEEB BMC	16	WEEB BMC MILL
MODULE CLAMPS	20	UNIVERSAL MID CLAMP
GROUNDING LUG	8	WEEB LUG W/ T-BOLT
END CLAMPS	32	UNIVERSAL END CLAMPS
ATTACHMENT	72	L-MOUNT ATTACHMENT (QUICKMOUNT)
T-BOLT	76	T-BOLT W/ NUT M8 X 20MM

1 ROOF PLAN WITH STRING LAYOUT

PV-2A

SCALE: 1/8" = 1'-0"

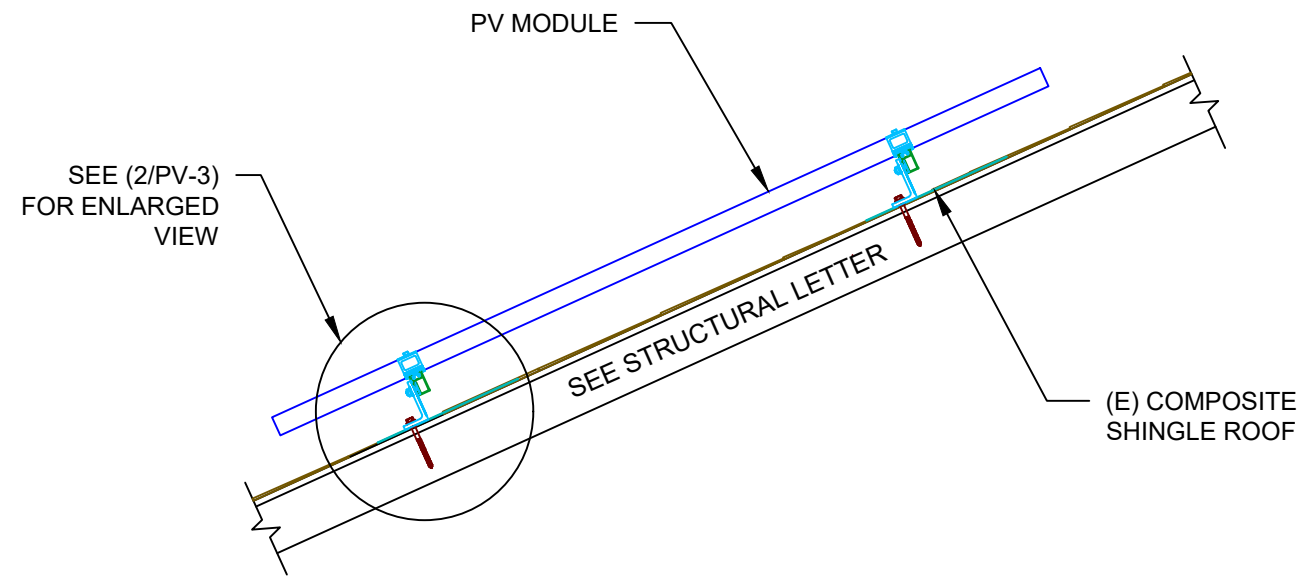

1 ATTACHMENT DETAIL
 PV-3 SCALE: 1" = 1'-0"

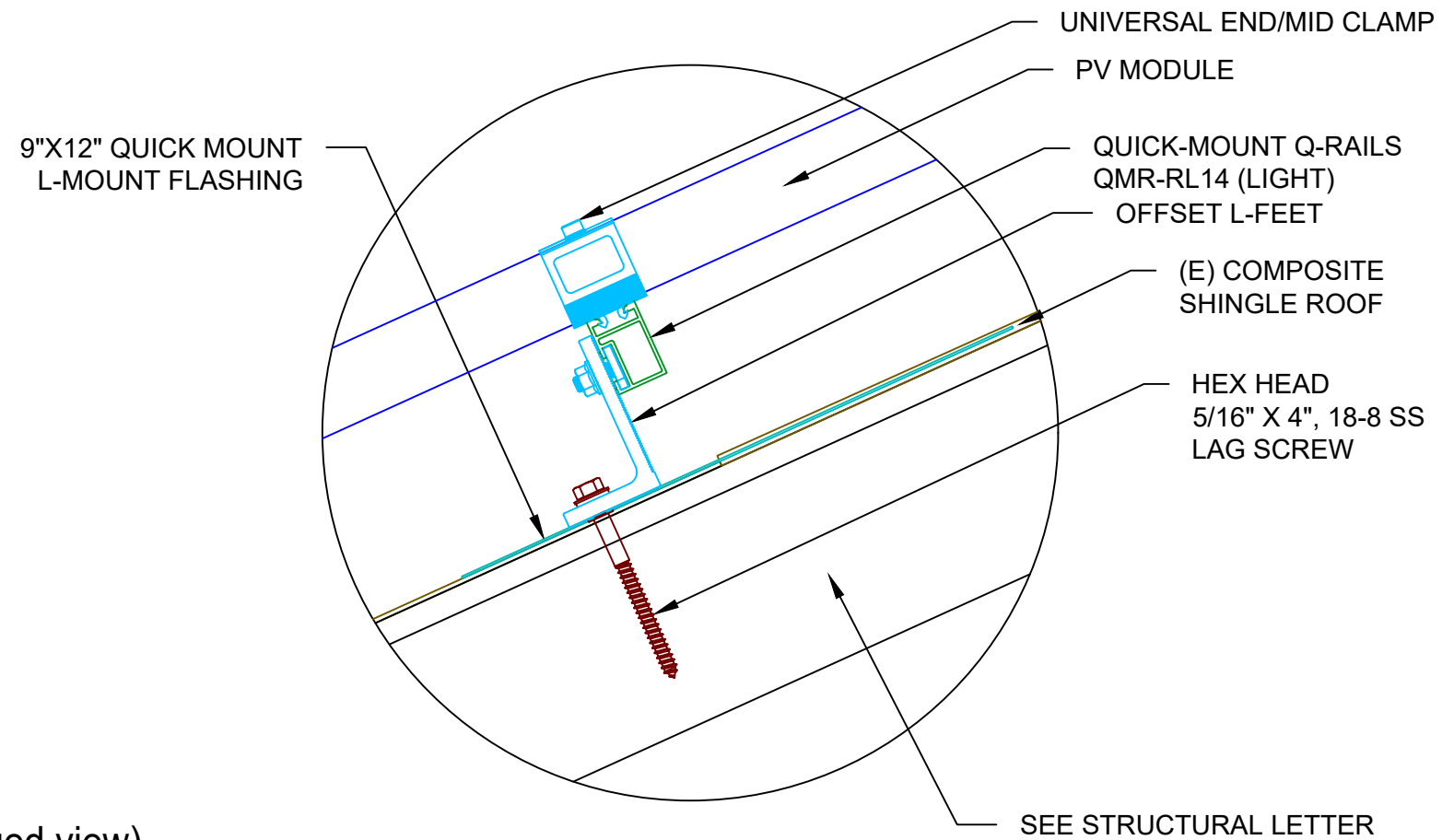

2 ATTACHMENT DETAIL (enlarged view)
 PV-3 SCALE: NTS

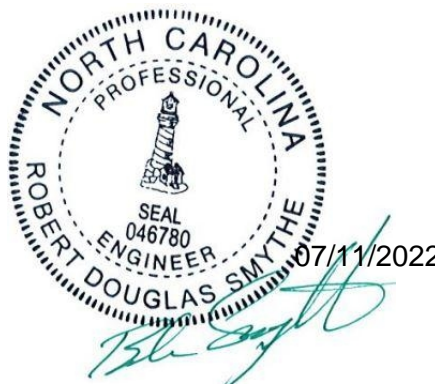

pinkenergy
 Proud Sponsor of Planet Earth

PINK ENERGY
 PROUD SPONSOR OF PLANET EARTH
 919 N. MAIN ST.
 MOORESVILLE, NC 28115
 Web: www.gopink.com

REVISIONS		
DESCRIPTION	DATE	REV

Signature with Seal

DATE: 7/8/2022

PROJECT NAME & ADDRESS

**THOMAS K JOHNSON
 RESIDENCE**
 48 DAY TRADING CT.,
 BROADWAY, NC 27505

SHEET NAME
**ATTACHMENT
 DETAIL**

SHEET SIZE
**ANSI B
 11" X 17"**

SHEET NUMBER
PV-3

(18) SILFAB SOLAR SIL-380 HC MODULES
 (2) PV LINKS OF 2 MODULES &
 (2) PV LINKS OF 7 MODULES CONNECTED IN SERIES
 TOTAL AC SYSTEM SIZE: 7.60kW
 TOTAL DC SYSTEM SIZE: 6.84kW

SERVICE INFO

UTILITY PROVIDER: CENTRAL ELECTRIC MEMBERSHIP CORP.
 MAIN SERVICE VOLTAGE: 240V
 MAIN PANEL BRAND: SQUARE D
 MAIN SERVICE PANEL: 200A
 MAIN CIRCUIT BREAKER RATING: 200A
 MAIN SERVICE LOCATION: NORTH-WEST
 SERVICE FEED SOURCE: UNDERGROUND

WIRE LEGEND

- PV ARRAY +VE CONDUCTOR AND L1
- PV ARRAY -VE CONDUCTOR AND L2
- NEUTRAL CONDUCTOR
- - - EGC AND GEC
- SINGLE TWISTED PAIR, CAT 5 WIRE

SILFAB SOLAR SIL-380 HC MODULES

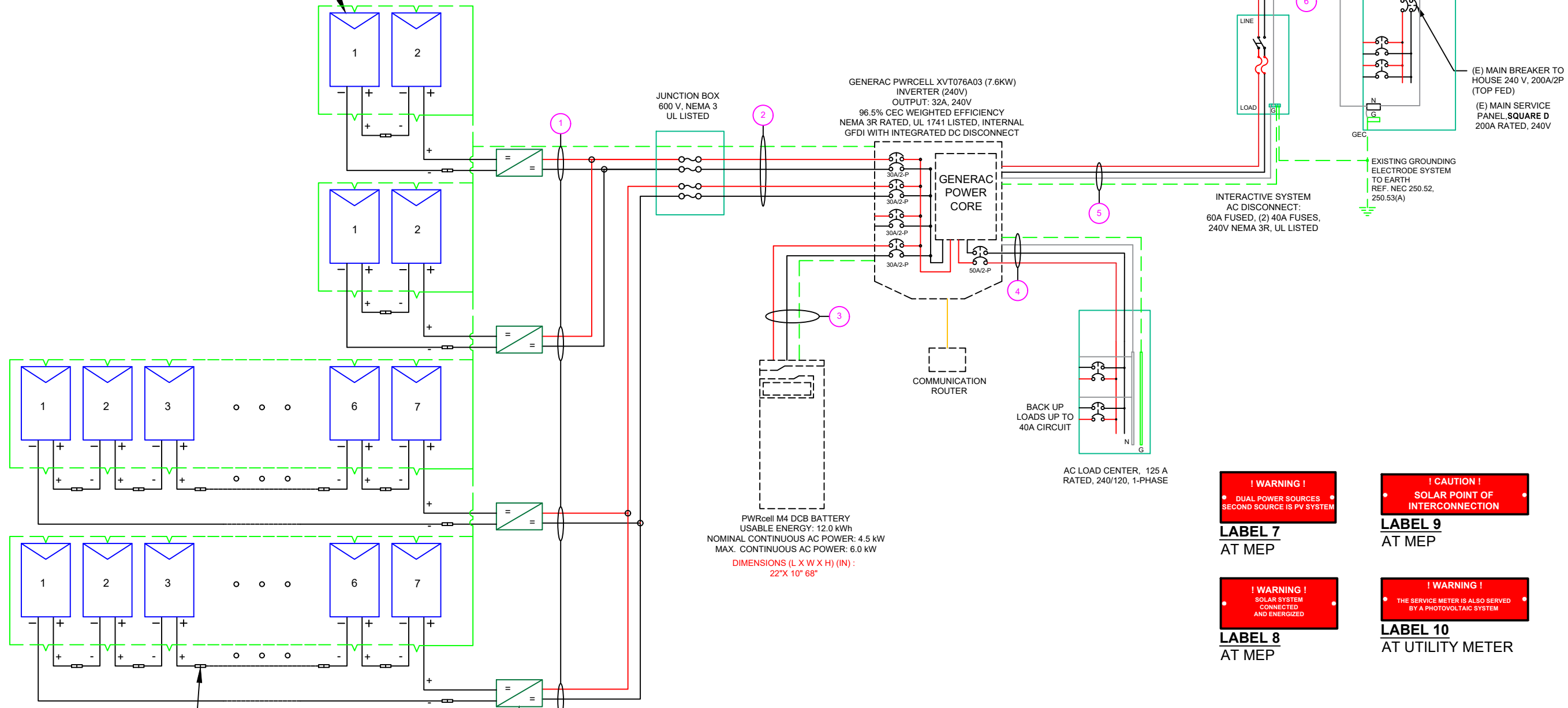

SNAP RS (RS802)
 MAX INPUT CURRENT - 15 A
 UL 1741 LISTED
 MODULE LEVEL RAPID
 SHUTDOWN (PVRSS)
 COMPLIANT
 NEMA 6P RATED

PVLINK SUBSTRING OPTIMIZER (S2502)
 RATED POWER : 2500W
 MPPT VOLTAGE RANGE: 60 TO 360 V
 MAX OUTPUT VOLTAGE: 420V
 MAX OUTPUT CURRENT: 8A
 RAPID SHUTDOWN COMPLIANT
 GROUND-FAULT PROTECTION COMPLIANT

PWRcell M4 DCB BATTERY
 USABLE ENERGY: 12.0 kWh
 NOMINAL CONTINUOUS AC POWER: 4.5 kW
 MAX. CONTINUOUS AC POWER: 6.0 kW
 DIMENSIONS (L X W X H) (IN) :
 22"X 10" 68"

! WARNING !
 PHOTOVOLTAIC
 POWER SOURCE
LABEL 1
 ON ALL PV CONDUITS
 SPACED AT MAX 10FT

! CAUTION !
 SOLAR ELECTRIC
 SYSTEM CONNECTED
 AND ENERGIZED
LABEL 3
 AT INVERTER

! WARNING !
 ELECTRIC SHOCK HAZARD
 DO NOT TOUCH TERMINALS.
 TERMINALS ON BOTH LINE AND LOAD SIDES
 MAY BE ENERGIZED IN THE OPEN POSITION.
LABEL 5
 AT EACH AC
 DISCONNECT

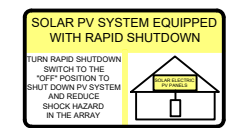

LABEL 2
 AT INVERTER

**PHOTOVOLTAIC
 DC DISCONNECT**
LABEL 4
 AT EACH DC
 DISCONNECT

**PHOTOVOLTAIC
 AC DISCONNECT**
LABEL 6
 AT EACH AC
 DISCONNECT

! WARNING !
 DUAL POWER SOURCES
 SECOND SOURCE IS PV SYSTEM
LABEL 7
 AT MEP

! CAUTION !
 SOLAR POINT OF
 INTERCONNECTION
LABEL 9
 AT MEP

! WARNING !
 SOLAR SYSTEM
 CONNECTED
 AND ENERGIZED
LABEL 8
 AT MEP

! WARNING !
 THE SERVICE METER IS ALSO SERVED
 BY A PHOTOVOLTAIC SYSTEM
LABEL 10
 AT UTILITY METER

QTY	CONDUCTOR INFORMATION	CONDUIT TYPE	CONDUIT SIZE
(8)	#10AWG - PV WIRE/USE-2		
(1)	#6AWG - BARE COPPER IN FREE AIR	N/A	N/A
(4)	#10AWG - THWN-2	EMT OR FLEX IN ATTIC	3/4"
(1)	#6AWG - THWN-2 GND		
(2)	#6AWG - THWN-2	EMT OR FLEX	3/4"
(1)	#6AWG - THWN-2 GND		
(3)	#6AWG - THWN-2	EMT OR FLEX	3/4"
(1)	#6AWG - THWN-2 GND		
(3)	#6AWG - THWN-2	EMT OR FLEX	3/4"
(1)	#6AWG - THWN-2 GND		
(3)	#6AWG - THWN-2	EMT OR FLEX	3/4"

pinkenergy
 Proud Sponsor of Planet Earth
 PINK ENERGY
 PROUD SPONSOR OF PLANET EARTH
 919 N. MAIN ST.
 MOORESVILLE, NC 28115
 Web: www.gopink.com

REVISIONS

DESCRIPTION	DATE	REV
(E) MAIN BREAKER TO HOUSE 240 V, 200A/2P (TOP FED)		
(E) MAIN SERVICE PANEL, SQUARE D 200A RATED, 240V		

Signature with Seal
 DATE: 7/8/2022

PROJECT NAME & ADDRESS
**THOMAS K JOHNSON
 RESIDENCE**
 48 DAY TRADING CT.,
 BROADWAY, NC 27505

SHEET NAME
**ELECTRICAL LINE
 DIAGRAM**
 SHEET SIZE
**ANSI B
 11" X 17"**
 SHEET NUMBER
PV-4

SOLAR MODULE SPECIFICATIONS	
MANUFACTURER / MODEL #	SILFAB SOLAR SIL-380 HC
VMP	35.32V
IMP	10.77A
VOC	42.17V
ISC	11.36A
TEMP. COEFF. VOC	-0.28%/°C
PTC RATING	351.71W
MODULE DIMENSION	69.4"L x 40.8"W x 1.37"D (In Inch)

INVERTER SPECIFICATIONS	
MANUFACTURER / MODEL #	GENERAC PWRCELL XVT076A03 (7.6KW)
AC POWER OUTPUT (LOADS/GRID)	7600VA
AC POWER OUTPUT (BACKUP)	8000VA
NOMINAL OUTPUT VOLTAGE	240 VAC
MAX OUTPUT CURRENT @240V (LOADS/GRID)	32A
MAX OUTPUT CURRENT @240V (BACKUP)	50A
NOMINAL DC INPUT VOLTAGE	380Vdc
MAX DC INPUT VOLTAGE	420Vdc
CEC WEIGHTED EFFICIENCY	96.5%
MAX DC POWER (PV)	10000W
MAX INPUT CURRENT (PV)	20Adc
CONT. PEAK POWER (BATTERY)	8000W

SERIES SUB STRING OPTIMIZER SPECIFICATIONS	
MANUFACTURER / MODEL #	PV LINK S2502
RATED POWER	2500W
MPPT VOLTAGE RANGE	60-360 Vmp
MAXIMUM INPUT VOLTAGE	420Voc
MAXIMUM OUTPUT	420 Adc
NOMINAL OUTPUT	380 Vdc
MAXIMUM OUTPUT CURRENT	8 A
MAXIMUM SHORT CIRCUIT CURRENT	18 A

BATTERY SPECIFICATIONS	
MANUFACTURER / MODEL #	GENERAC PWRCELL M4 DCB BATTERY
USABLE ENERGY	12.0kWH
NOMINAL CONTINUOUS AC POWER	4.5kW
MAX. CONTINUOUS AC POWER	6.0kW
PEAK MOTOR STARTING CURRENT (2 SEC)	33A
REBUS VOLTAGE: INPUT/ OUTPUT	360-420Vdc
MODULE VOLTAGE	46.8Vdc
ROUND-TRIP EFFICIENCY	96.5%

ELECTRICAL NOTES

- 1.) ALL EQUIPMENT TO BE LISTED BY UL OR OTHER NRTL, AND LABELED FOR ITS APPLICATION.
- 2.) ALL CONDUCTORS SHALL BE COPPER, RATED FOR 600 V AND 90 DEGREE C WET ENVIRONMENT.
- 3.) WIRING, CONDUIT, AND RACEWAYS MOUNTED ON ROOFTOPS SHALL BE ROUTED DIRECTLY TO, AND LOCATED AS CLOSE AS POSSIBLE TO THE NEAREST RIDGE, HIP, OR VALLEY.
- 4.) WORKING CLEARANCES AROUND ALL NEW AND EXISTING ELECTRICAL EQUIPMENT SHALL COMPLY WITH NEC 110.26.
- 5.) DRAWINGS INDICATE THE GENERAL ARRANGEMENT OF SYSTEMS. CONTRACTOR SHALL FURNISH ALL NECESSARY OUTLETS, SUPPORTS, FITTINGS AND ACCESSORIES TO FULFILL APPLICABLE CODES AND STANDARDS.
- 6.) WHERE SIZES OF JUNCTION BOXES, RACEWAYS, AND CONDUITS ARE NOT SPECIFIED, THE CONTRACTOR SHALL SIZE THEM ACCORDINGLY.
- 7.) ALL WIRE TERMINATIONS SHALL BE APPROPRIATELY LABELED AND READILY VISIBLE.
- 8.) MODULE GROUNDING CLIPS TO BE INSTALLED BETWEEN MODULE FRAME AND MODULE SUPPORT RAIL, PER THE GROUNDING CLIP MANUFACTURER'S INSTRUCTION.
- 9.) MODULE SUPPORT RAIL TO BE BONDED TO CONTINUOUS COPPER G.E.C. VIA WEEB LUG OR ILSCO GBL-4DBT LAY-IN LUG.
- 10.) THE POLARITY OF THE GROUNDED CONDUCTORS IS NEGATIVE

AMBIENT TEMPERATURE SPECS	
RECORD LOW TEMP	-19°
AMBIENT TEMP (HIGH TEMP 2%)	34°
CONDUIT HEIGHT	0.5"
ROOF TOP TEMP	56°

**DC CONDUCTOR AMPACITY CALCULATIONS:
PV LINK OPTIMIZER TO JUNCTION BOX:**

EXPECTED WIRE TEMP (In Celsius)	56°
TEMP. CORRECTION PER NEC TABLE 310.15 (B)(2)(a)	0.71
NO. OF CURRENT CARRYING CONDUCTORS	8
CONDUIT FILL CORRECTION PER NEC TABLE 310.15(B)(3)(a)	0.7
CIRCUIT CONDUCTOR SIZE	10 AWG
CIRCUIT CONDUCTOR AMPACITY PER NEC TABLE 310.15(B)(16)	40A

REQUIRED CIRCUIT CONDUCTOR AMPACITY PER NEC 690.8(A&B)	10A
1.25 X I _{max}	
DERATED AMPACITY OF CIRCUIT CONDUCTOR	19.88A
TEMP. CORRECTION PER TABLE 310.15 (B)(2)(a) X CONDUIT FILL CORRECTION PER NEC 310.15(B)(3)(a) X CIRCUIT CONDUCTOR AMPACITY 310.15 (B)(16)	
Result should be greater than (10A) otherwise less the entry for circuit conductor size and ampacity	

FROM JUNCTION BOX TO INVERTER:

EXPECTED WIRE TEMP (In Celsius)	56°
TEMP. CORRECTION PER NEC TABLE 310.15 (B)(2)(a)	0.71
NO. OF CURRENT CARRYING CONDUCTORS	4
CONDUIT FILL CORRECTION PER NEC TABLE 310.15(B)(3)(a)	0.8
CIRCUIT CONDUCTOR SIZE	10 AWG
CIRCUIT CONDUCTOR AMPACITY PER NEC TABLE 310.15(B)(16)	40A

REQUIRED CIRCUIT CONDUCTOR AMPACITY PER NEC 690.8(A&B)	20A
1.25 X I _{max} X # of PV LINKS	
DERATED AMPACITY OF CIRCUIT CONDUCTOR	22.72A
TEMP. CORRECTION PER TABLE 310.15 (B)(2)(a) X CONDUIT FILL CORRECTION PER NEC 310.15(B)(3)(a) X CIRCUIT CONDUCTOR AMPACITY 310.15 (B)(16)	
Result should be greater than (20A) otherwise less the entry for circuit conductor size and ampacity	

FROM BATTERY TO INVERTER:

EXPECTED WIRE TEMP (In Celsius)	34°
TEMP. CORRECTION PER NEC TABLE 310.15 (B)(2)(a)	0.96
NO. OF CURRENT CARRYING CONDUCTORS	2
CONDUIT FILL CORRECTION PER NEC TABLE 310.15(B)(3)(a)	1
CIRCUIT CONDUCTOR SIZE	6 AWG
CIRCUIT CONDUCTOR AMPACITY PER NEC TABLE 310.15(B)(16)	75A

REQUIRED CIRCUIT CONDUCTOR AMPACITY PER NEC 690.8(A&B)	41.25A
1.25 X I _{max} (= 33A)	
DERATED AMPACITY OF CIRCUIT CONDUCTOR	72.0A
TEMP. CORRECTION PER TABLE 310.15 (B)(2)(a) X CONDUIT FILL CORRECTION PER NEC 310.15(B)(3)(a) X CIRCUIT CONDUCTOR AMPACITY 310.15 (B)(16)	
Result should be greater than (41.25A) otherwise less the entry for circuit conductor size and ampacity	

**AC CONDUCTOR AMPACITY CALCULATIONS:
FROM INVERTER TO BACK-UP PANEL:**

No. OF INVERTER	1
EXPECTED WIRE TEMP (In Celsius)	34°
TEMP. CORRECTION PER NEC TABLE 310.15(B)(2)(a)	0.96
NO. OF CURRENT CARRYING CONDUCTORS	3
CONDUIT FILL CORRECTION PER NEC TABLE 310.15(B)(3)(a)	1
CIRCUIT CONDUCTOR SIZE	6 AWG
CIRCUIT CONDUCTOR AMPACITY PER NEC TABLE 310.15(B)(16)	75A

REQUIRED CIRCUIT CONDUCTOR AMPACITY PER NEC 690.8(A&B)	42.5A
1.25 X INVERTER OUTPUT CURRENT (BACKUP POWER)	
DERATED AMPACITY OF CIRCUIT CONDUCTOR	72A
TEMP. CORRECTION PER TABLE 310.15 (B)(2)(a) X CONDUIT FILL CORRECTION PER NEC 310.15(B)(3)(a) X CIRCUIT CONDUCTOR AMPACITY 310.15 (B)(16)	
Result should be greater than (42.5A) otherwise less the entry for circuit conductor size and ampacity	

**AC CONDUCTOR AMPACITY CALCULATIONS:
FROM INVERTER TO MEP:**

No. OF INVERTER	1
EXPECTED WIRE TEMP (In Celsius)	34°
TEMP. CORRECTION PER NEC TABLE 310.15(B)(2)(a)	0.96
NO. OF CURRENT CARRYING CONDUCTORS	3
CONDUIT FILL CORRECTION PER NEC TABLE 310.15(B)(3)(a)	1
CIRCUIT CONDUCTOR SIZE	6 AWG
CIRCUIT CONDUCTOR AMPACITY PER NEC TABLE 310.15(B)(16)	75A

REQUIRED CIRCUIT CONDUCTOR AMPACITY PER NEC 690.8(A&B)	40A
1.25 X MAX INVERTER OUTPUT CURRENT (LOADS/GRID)	
DERATED AMPACITY OF CIRCUIT CONDUCTOR	72A
TEMP. CORRECTION PER TABLE 310.15 (B)(2)(a) X CONDUIT FILL CORRECTION PER NEC 310.15(B)(3)(a) X CIRCUIT CONDUCTOR AMPACITY 310.15 (B)(16)	
Result should be greater than (40A) otherwise less the entry for circuit conductor size and ampacity	

pinkenergy
Proud Sponsor of Planet Earth

PINK ENERGY
PROUD SPONSOR OF PLANET EARTH
919 N. MAIN ST.
MOORESVILLE, NC 28115
Web: www.gopink.com

REVISIONS		
DESCRIPTION	DATE	REV

Signature with Seal

DATE: 7/8/2022

PROJECT NAME & ADDRESS

**THOMAS K JOHNSON
RESIDENCE
48 DAY TRADING CT.,
BROADWAY, NC 27505**

SHEET NAME
**WIRING
CALCULATIONS**

SHEET SIZE
**ANSI B
11" X 17"**

SHEET NUMBER
PV-5

SILFAB PRIME

SIL-380 HC

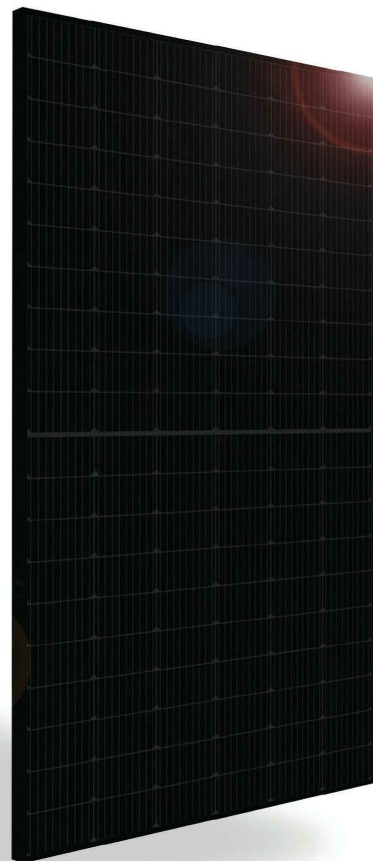

RELIABLE ENERGY.
DIRECT FROM THE SOURCE.

Introducing Silfab Prime.

Designed to outperform.

Dependable, durable, high-performance solar panels
engineered for North American homeowners.

SILFABSOLAR.COM



CHUBB
* Chubb provides error and omission insurance to Silfab Solar Inc.



ELECTRICAL SPECIFICATIONS		380	
Test Conditions		STC	NOCT
Module Power (Pmax)	Wp	380	284
Maximum power voltage (Vpmax)	V	35.32	32.83
Maximum power current (Ipmax)	A	10.77	8.64
Open circuit voltage (Voc)	V	42.17	39.55
Short circuit current (Isc)	A	11.36	9.16
Module efficiency	%	20.8%	19.4%
Maximum system voltage (VDC)	V		1000
Series fuse rating	A		20
Power Tolerance	Wp		±3%

Measurement conditions: STC 1000 W/m² • AM 1.5 • Temperature 25 °C • NOCT 800 W/m² • AM 1.5 • Measurement uncertainty ≤ 3%
Sun simulator calibration reference modules from Fraunhofer Institute. Electrical characteristics may vary by ±5% and power by ±3%.

MECHANICAL PROPERTIES / COMPONENTS	METRIC	IMPERIAL
Module weight	19.5kg ±0.2kg	43lbs ±0.4lbs
Dimensions (H x L x D)	1762 mm x 1037 mm x 35 mm	69.4 in x 40.8 in x 1.37 in
Maximum surface load (wind/snow)*	5400 Pa rear load / 5400 Pa front load	112.8 lb/ft ² rear load / 112.8 lb/ft ² front load
Hail impact resistance	ø 25 mm at 83 km/h	ø 1 in at 51.6 mph
Cells	120 Half cells - Si mono PERC 9 busbar - 83 x 166 mm	120 Half cells - Si mono PERC 9 busbar - 3.26 x 6.53 in
Glass	3.2 mm high transmittance, tempered, DSM antireflective coating	0.126 in high transmittance, tempered, DSM antireflective coating
Cables and connectors (refer to installation manual)	1350 mm, ø 5.7 mm, MC4 from Staubli	53.15 in, ø 0.22 in (12AWG), MC4 from Staubli
Backsheet	High durability, superior hydrolysis and UV resistance, multi-layer dielectric film, fluorine-free PV backsheet	
Frame	Anodized Aluminum (Black)	
Bypass diodes	3 diodes-30SQ045T (45V max DC blocking voltage, 30A max forward rectified current)	
Junction Box	UL 3730 Certified, IEC 62790 Certified, IP68 rated	

TEMPERATURE RATINGS		WARRANTIES	
Temperature Coefficient Isc	+0.064 %/°C	Module product workmanship warranty	25 years**
Temperature Coefficient Voc	-0.28 %/°C	Linear power performance guarantee	30 years
Temperature Coefficient Pmax	-0.36 %/°C		≥ 97.1% end 1st yr ≥ 91.6% end 12th yr ≥ 85.1% end 25th yr ≥ 82.6% end 30th yr
NOCT (± 2°C)	45 °C		
Operating temperature	-40/+85 °C		

CERTIFICATIONS		SHIPPING SPECS	
Product	ULC ORD C1703, UL1703, CEC listed, UL 61215-1/-1-1/-2, UL 61730-1/-2, IEC 61215-1/-1-1/-2***, IEC 61730-1/-2***, CSA C22.2#61730-1/-2, IEC 62716 Ammonia Corrosion; IEC61701:2011 Salt Mist Corrosion Certified, UL Fire Rating: Type 2	Modules Per Pallet:	26 or 26 (California)
Factory	ISO9001:2015	Pallets Per Truck	34 or 32 (California)
		Modules Per Truck	884 or 832 (California)

* ⚠ Warning: Read the Safety and Installation Manual for mounting specifications and before handling, installing and operating modules.
** 12 year extendable to 25 years subject to registration and conditions outlined under "Warranty" at silfabsolar.com
*** Certification in progress.
PAN files generated from 3rd party performance data are available for download at: silfabsolar.com/downloads

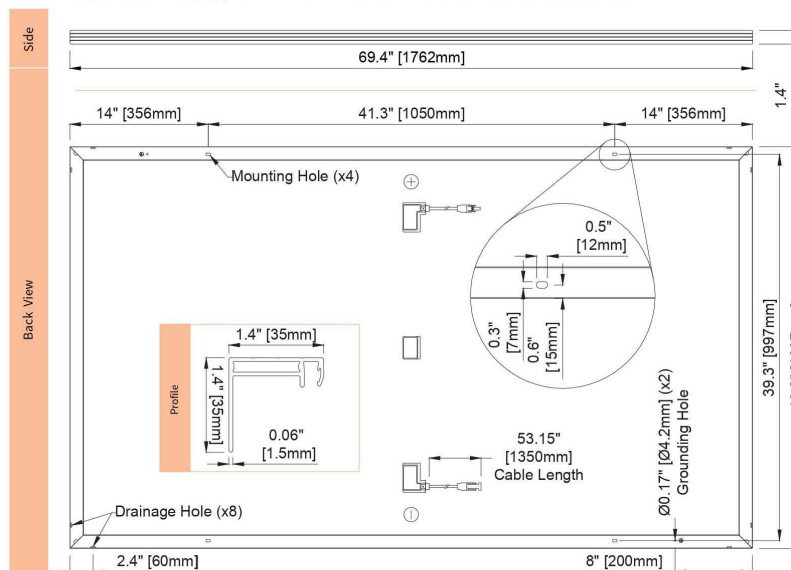

SILFAB SOLAR INC.

800 Cornwall Ave
Bellingham WA 98225 USA
T +1 360.569.4733
info@silfabsolar.com
SILFABSOLAR.COM
1770 Port Drive
Burlington WA 98233 USA
T +1 360.569.4733
240 Courtneypark Drive East
Mississauga ON L5T 2Y3 Canada
T +1 905.255.2501
F +1 905.696.0267

Silfab - SIL-380-HC-20211029
No reproduction of any kind is allowed without
permission. Data and information is subject to
modifications without notice. © Silfab Solar Inc.,
2021. Silfab Solar™ is a trademark of Silfab Solar Inc.



PINK ENERGY
PROUD SPONSOR OF PLANET EARTH
919 N. MAIN ST.
MOORESVILLE, NC 28115
Web: www.gopink.com

REVISIONS

DESCRIPTION	DATE	REV

Signature with Seal

DATE: 7/8/2022

PROJECT NAME & ADDRESS

THOMAS K JOHNSON
RESIDENCE
48 DAY TRADING CT.,
BROADWAY, NC 27505

SHEET NAME
EQUIPMENT
SPECIFICATION

SHEET SIZE

ANSI B
11" X 17"

SHEET NUMBER

PV-6

GENERAC

PWRCELL

7.6kW 1Ø PWRcell Inverter with CTs
Model #: XVT076A03

11.4 kW 3Ø PWRcell Inverter with CTs
Model #: X11402 (Ordering SKU: APKE00013)



Solar + storage is simple with the Generac PWRcell™ Inverter. This bi-directional, REbus™-powered inverter offers a simple, efficient design for integrating smart batteries with solar. Ideal for self-supply, backup power, zero-export and energy cost management, the PWRcell Inverter is the industry's most feature-rich line of inverters, available in single-phase and three-phase models.

FEATURES & BENEFITS

- Single inverter for grid-tied solar with smart battery integration
- Simplified system design: No autotransformer or battery inverter needed
- User-selectable modes for backup power, self-supply, time-of-use, zero-import and export limiting
- Free system monitoring included via PWRview™ Web Portal and Mobile App

AC OUTPUT/GRID-TIE	MODEL XVT076A03	MODEL X11402
CONT. GRID-TIED AC POWER @ 50°C (122°F):	7600 W	11400 W
AC OUTPUT VOLTAGE:	120/240, 1Ø VAC	120/208, 3Ø VAC
AC FREQUENCY:	60 Hz	
MAXIMUM CONTINUOUS OUTPUT CURRENT:	32 A, RMS	
GROUND-FAULT ISOLATION DETECTION:	Included	
CHARGE BATTERY FROM AC:	Yes	
THD (CURRENT):	< 2%	
TYPICAL NIGHTTIME POWER CONSUMPTION ¹ :	< 7 W	

AC OUTPUT/ISLAND MODE	MODEL XVT076A03	MODEL X11402
MAX. CONT. AC POWER WHILE IN ISLAND MODE WITHOUT AN EXTERNAL TRANSFER SWITCH ² :	7600 W	
MAX. CONT. AC POWER WHILE IN ISLAND MODE W/ EXTERNAL TRANSFER SWITCH AND SINGLE 6 MODULE BATTERY CABINET ³ :	9000 W	
MAX. CONT. AC POWER WHILE IN ISLAND MODE W/ EXTERNAL TRANSFER SWITCH AND 2 BATTERY CABINETS (8 MODULES MINIMUM) ³ :	11000 W	9600 W-11000 W*
PEAK MOTOR STARTING CURRENT (2 SEC):	50 A, RMS	
AC BACKUP OUTPUT VOLTAGE:	120/240, 1Ø VAC	120/208, 1Ø VAC
AC FREQUENCY:	60 Hz	
THD (VOLTAGE):	< 2%	
ALLOWABLE SPLIT PHASE IMBALANCE:	Up to 30%	

DC INPUT	MODEL XVT076A03	MODEL X11402
DC INPUT VOLTAGE RANGE:	360-420 VDC	
NOMINAL DC BUS VOLTAGE:	380 VDC	
DC DISTRIBUTION INPUT BREAKERS:	4 x 2P30 A	
MAX INPUT CURRENT PER DC INPUT:	30 A	
REVERSE-POLARITY PROTECTION:	Yes	
TRANSFORMERLESS, UNGROUNDED:	Yes	
DC BUS EXPORT FUSES (+/-):	40 A	
2-POLE DISCONNECTION:	Yes	

EFFICIENCY	MODEL XVT076A03	MODEL X11402
PEAK EFFICIENCY:	97.3%	97.7%
CEC WEIGHTED EFFICIENCY:	96.5%	97.5%

¹Nighttime power consumption depends on the system mode
²In Island Mode, continuous power output is restricted to 7.6kW unless backup power is routed through an external transfer switch in a whole home backup application.
³Peak performance, values provided for 40°C (104°F).
 *In Island mode X11402 protected loads only supply 2 phases 120 VAC L-N, 208 L-L which results in lower power than in a grid tied 3 phase state. The low value of the range is for full L-L loading while high value of the range is full L-N loading

Specifications

FEATURES AND MODES

ISLAND MODE ¹ :	Yes
GRID SELL:	Yes
SELF CONSUMPTION:	Yes
PRIORITIZED CHARGING FROM RENEWABLES:	Yes
GRID SUPPORT - ZERO EXPORT:	Yes
ESS PCS OPERATION MODES (IMPORT ONLY, EXPORT ONLY):	Yes

ADDITIONAL FEATURES

SUPPORTED COMMUNICATION INTERFACES:	REbus™, CANbus, Ethernet
SYSTEM MONITORING:	PWRview™ Web Portal and Mobile App
BACKUP LOADS DISCONNECT ² :	Yes, 50 A Circuit Breaker
INVERTER BYPASS SWITCH:	Automatic
WARRANTY:	10 Years

STANDARDS COMPLIANCE

SAFETY:	UL 1741 SA, CSA 22.2 #107.1, UL 1998
GRID CONNECTION STANDARDS:	IEEE 1547, Rule 21, Rule 14H (HECO V1.1), CSIP, UL 1741 PCS CRD (Import Only, Export Only)
EMISSIONS:	FCC Part 15 Class B

DIMENSIONS AND INSTALLATION SPECIFICATIONS

ENCLOSURE KNOCKOUTS - QTY, SIZE - IN (MM):	6 x Combo 3/4" x 1" (19 x 25.4) 7 x Combo 1/2" x 3/4" (12.7 x 19)	1 x 0.575" exclusively for optional LTE antenna mounting
DIMENSIONS L x W x H - IN (MM):	24.5" x 19.25" x 8" (622.3 x 488.9 x 203.2)	
WEIGHT - LB (KG):	62.7 (28.4)	
COOLING:	Forced convection	
AUDIBLE NOISE:	< 40 dBA	
OPERATING TEMPERATURE:	-4 to 122 °F (-20 to 50 °C) ⁵	
ENCLOSURE TYPE:	Type 3R	

INSTALLATION GUIDELINES

BATTERY TYPES SUPPORTED:	PWRcell™ Battery
MODULE SUBSTRING SIZE PER PV LINK OPTIMIZER:	Varies, refer to PV Link Installation Manual
MAXIMUM RECOMMENDED DC POWER FROM PV ⁶ :	10 kW (1Ø), 15 kW (3Ø)

⁴3Ø inverters offer backup for [single phase] 208 V loads.
⁵Includes ambient temperature rising from inverter operation. Reduced power at extreme temperatures.
⁶Values provided for PV-only or small storage systems. Additional PV power is permissible if sufficient battery storage capacity is installed.

Generac Power Systems, Inc.
 S45 W29290 Hwy. 59, Waukesha, WI 53189
www.Generac.com | 888-GENERAC (436-3722)
 A0000909057 REV D

©2021 Generac Power Systems. All rights reserved.
 Specifications are subject to change without notice.



pinkenergy
 Proud Sponsor of Planet Earth

PINK ENERGY
 PROUD SPONSOR OF PLANET EARTH
 919 N. MAIN ST.
 MOORESVILLE, NC 28115
 Web: www.gopink.com

REVISIONS

DESCRIPTION	DATE	REV

Signature with Seal

DATE: 7/8/2022

PROJECT NAME & ADDRESS

THOMAS K JOHNSON
 RESIDENCE
 48 DAY TRADING CT.,
 BROADWAY, NC 27505

SHEET NAME
**EQUIPMENT
 SPECIFICATION**

SHEET SIZE

**ANSI B
 11" X 17"**

SHEET NUMBER

PV-7

GENERAC

SnapRS™

Inline Disconnect Switch
Model #: RS802



Generac SnapRS are a simple way to satisfy rapid shutdown compliance for solar + storage systems. Generac SnapRS are 2017/2020 NEC 690.12 compliant, don't require any extra hardware to mount, and need no pairing or fussy digital communications.

FEATURES & BENEFITS

- Fast, easy, and simple to install
- One SnapRS device per PV module
- Achieves PVRSS Compliance
- Low cost, high efficiency solution

SYSTEM DESIGN

Snap a Generac SnapRS disconnect device (RS) to the negative lead (-) of each module in the solar array for simple module-level rapid shutdown compliance. SnapRS devices isolate array voltage when a rapid shutdown is initiated at a PWRcell™ Inverter. When rapid shutdown is initiated, SnapRS units isolate each PV module in the array, reducing array voltage to <80V in seconds.

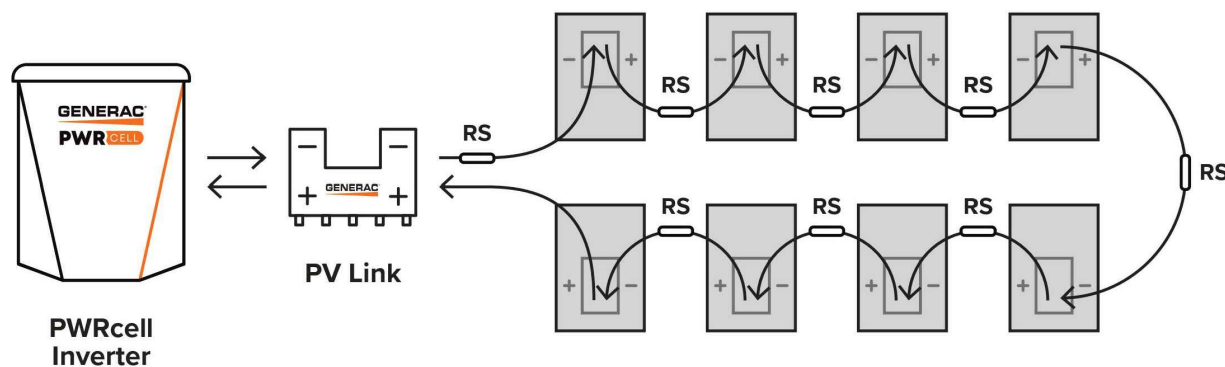

Diagram is applicable for most 60 cell PV modules. Modules with higher cell count may require a different arrangement. Contact Generac for more details.

Specifications

SnapRS™ (RS802)	
PV MODULE MAX VOC:	75 V
EFFICIENCY:	99.8%*
MAX INPUT CURRENT:	15 A
MAX TOTAL QTY IN SUBSTRING:	10
SHUTDOWN TIME:	< 10 Seconds
ENCLOSURE RATING:	NEMA 6P
OPERATING TEMPERATURE - FAHRENHEIT (CELSIUS):	-40 to 158 °F (-40 to 70 °C)
CERTIFICATIONS:	UL1741
PROTECTIONS:	PVRSE
WEIGHT - LB (KG):	0.17 (0.08)
DIMENSIONS, L x W x H - IN (MM):	7" x 1" x 1" (177.8 x 25.4 x 25.4)
WARRANTY:	25 Years

*When used with a 50V panel

Connect one SnapRS device to the negative lead of each PV module in the PV Link controlled array for complete PV Rapid shutdown performance



Generac Power Systems, Inc.
S45 W29290 Hwy. 59, Waukesha, WI 53189
www.Generac.com | 888-GENERAC (436-3722)
A0001520570 REV A

©2021 Generac Power Systems. All rights reserved.
Specifications are subject to change without notice.

GENERAC

pinkenergy
Proud Sponsor of Planet Earth

PINK ENERGY
PROUD SPONSOR OF PLANET EARTH
919 N. MAIN ST.
MOORESVILLE, NC 28115
Web: www.gopink.com

REVISIONS

DESCRIPTION	DATE	REV

Signature with Seal

DATE: 7/8/2022

PROJECT NAME & ADDRESS

THOMAS K JOHNSON
RESIDENCE
48 DAY TRADING CT.,
BROADWAY, NC 27505

SHEET NAME
EQUIPMENT
SPECIFICATION

SHEET SIZE

ANSI B
11" X 17"

SHEET NUMBER

PV-8

GENERAC

PWRCELL

3.0kWh DCB BATTERY MODULE

3.0kWh PWRcell DCB Battery Module
Model #: BJ-DCB05ZKBG (Ordering SKU: G0080040)



Build a better backup system with the Generac DCB Battery Module for PWRcell™. Add capacity and backup power with as few as three or as many as six modules. Upgrade a PWRcell Battery post-installation with the addition of more DCB modules for more power and capacity.

FEATURES & BENEFITS

- Suitable for indoor and outdoor cabinets
- Modular: Stack the right number of battery modules for the application
- Upgradeable: Add more modules later when consumer needs change
- Easy to install: At just 55lbs, installers won't need special equipment to move and install these batteries

SPECIFICATIONS

NOMINAL VOLTAGE:	46.8 VDC
USABLE CAPACITY @ TYPICAL VOLTAGE:	3.00 kWh
MAXIMUM AMBIENT OPERATING TEMPERATURE:	14 to 122 °F (-10 to 50 °C)
OPTIMAL AMBIENT OPERATING TEMPERATURE:	41 to 104 °F (5 to 40 °C)
STORAGE TEMPERATURE RANGE:	-4 to 68 °F (-20 to 20 °C)
SCALABILITY:	3-6 pcs in series
DIMENSIONS, L x W x H - IN (MM):	17.3" x 17.7" x 3.3" (440 x 450 x 84)
WEIGHT - LB (KG):	55 (25)
BATTERY CHEMISTRY:	Lithium Nickel Manganese Cobalt (NMC)
WARRANTY:	10 years or 7.56MWh Throughput (per module)
COMPLIANCE:	UL 1973

Note: Charge/discharge rate may be reduced at temperature extremes

Generac Power Systems, Inc.
S45 W29290 Hwy. 59, Waukesha, WI 53189
www.Generac.com | 888-GENERAC (436-3722)
A0000953959 REV E

©2021 Generac Power Systems. All rights reserved.
Specifications are subject to change without notice.



Overview of technical specifications

PWRcell™ BATTERY CONFIGURATIONS

BATTERY MODULE SERIES:	3.0 kWh DCB / 3.0 kWh EX			
BATTERY MODULES:	3	4	5	6
USABLE ENERGY:	9 kWh	12 kWh	15 kWh	18 kWh
NOMINAL CONT. AC POWER ¹ :	3.4 kW	4.5 kW	5.6 kW	6.7 kW
MAX. CONT. AC POWER ² :	4.5 kW	6 kW	7.5 kW	9 kW
MAX. CONT. DC CURRENT (CHARGE/DISCHARGE) - A:	13.8	18.4	23.0	27.5
PEAK MOTOR STARTING CURRENT (2 SEC) - A, RMS:	25	33	42	50
REbus™ VOLTAGE - INPUT/OUTPUT:	360-420 VDC			
NOMINAL VOLTAGE:	380 VDC			
DC-DC ROUND-TRIP EFFICIENCY:	96.5%			
MAXIMUM AMBIENT OPERATING TEMPERATURE:	14 to 122 °F (-10 to 50 °C)			
RECOMMENDED AMBIENT OPERATING TEMPERATURE:	41 to 104 °F (5 to 40 °C)			
MAXIMUM INSTALLATION ALTITUDE - FT (M):	9834 (3000)			
DIMENSIONS, L x W x H - IN (MM):	22" X 10" X 68" (559 X 254 X 1727)			
WEIGHT, ENCLOSURE - LB (KG):	111 (50)			
WEIGHT, INSTALLED W/ DCB MODULES- LB (KG):	276 (125)	331 (150)	386 (175)	441 (200)
WEIGHT, INSTALLED W/ EX MODULES - LB (KG):	282 (128)	340 (154)	397 (180)	454 (206)
ENCLOSURE TYPE:	Type 1			
WARRANTY - LI-ION MODULES:	10 Years, (7.56MWh)			
WARRANTY - ELECTRONICS AND ENCLOSURE:	10 Years			
COMMUNICATION PROTOCOL:	REbus™ DC Nanogrid™			
SEISMIC RATING:	IEEE 693-2018 (HIGH)			
COMPLIANCE:	UL 9540, UL 1973, UL 1642, CSA 22.2 #107.1			

pinkenergy
Proud Sponsor of Planet Earth

PINK ENERGY
PROUD SPONSOR OF PLANET EARTH
919 N. MAIN ST.
MOORESVILLE, NC 28115
Web: www.gopink.com

REVISIONS

DESCRIPTION	DATE	REV

Signature with Seal

DATE: 7/8/2022

PROJECT NAME & ADDRESS

THOMAS K JOHNSON
RESIDENCE
48 DAY TRADING CT.,
BROADWAY, NC 27505

SHEET NAME
EQUIPMENT
SPECIFICATION

SHEET SIZE

ANSI B
11" X 17"

SHEET NUMBER

PV-9

GENERAC[®]

PWRCELL

OUTDOOR RATED BATTERY

PWRcell Outdoor Rated Battery Cabinet (Ordering SKU: APKE00028)
 3.0kWh PWRcell DCB Battery Module
 Model #: BJ-DCB05ZKBG (Ordering SKU: G0080040)
 3.0kWh PWRcell EX Battery Module
 Model #: G0080001

The PWRcell™ Outdoor Rated (OR) Battery Cabinet is a Type 3R smart battery enclosure that allows for a range of configurations to suit any need, small or large, indoor or outdoor. No other smart battery offers the power and flexibility of PWRcell.

PWRcell BATTERY CABINET DESIGN

The PWRcell Battery Cabinet allows system owners the flexibility to scale from an economical 9kWh to a massive 18kWh by installing additional battery modules to the PWRcell Battery Cabinet. An existing PWRcell Battery Cabinet can be upgraded with additional modules. Use the graphic below and the chart on the back of this sheet to understand what components you need for your chosen PWRcell configuration.

BATTERY CONFIGURATION GUIDE

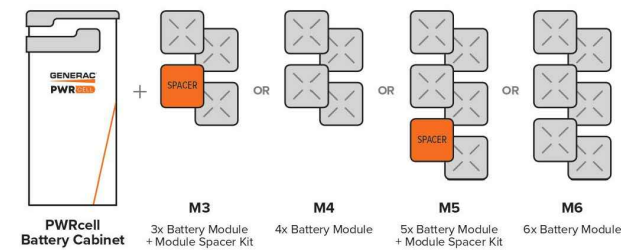

FEATURES & BENEFITS

- Connect 2 PWRcell Battery Cabinets to a single PWRcell Inverter for up to 36kWh of storage
- Best-in-class battery backup power
- Plug-and-play with PWRcell Inverter and PV Link™
- Time-of-use (TOU) and zero-export ready
- Residential and commercial application ready.
- 3R-rated cabinet allows for outdoor or indoor installation
- Additional mounting hardware for outdoor installations comes standard to provide additional ground clearance and support

BATTERY CABINET ASSEMBLY

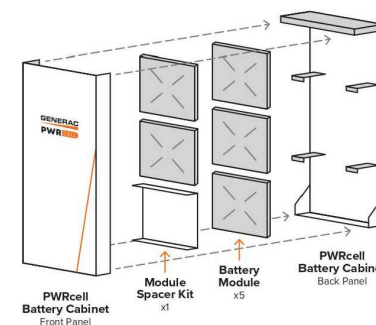

pinkenergy
 Proud Sponsor of Planet Earth

PINK ENERGY
 PROUD SPONSOR OF PLANET EARTH
 919 N. MAIN ST.
 MOORESVILLE, NC 28115
 Web: www.gopink.com

REVISIONS

DESCRIPTION	DATE	REV

Signature with Seal

DATE: 7/8/2022

PROJECT NAME & ADDRESS

THOMAS K JOHNSON
 RESIDENCE
 48 DAY TRADING CT.,
 BROADWAY, NC 27505

SHEET NAME

EQUIPMENT
 SPECIFICATION

SHEET SIZE

ANSI B
 11" X 17"

SHEET NUMBER

PV-9A

GENERAC

PV Link™

2500W MPPT Substring Optimizer
Model #: S2502 (Ordering SKU: APKE00010)

PV Link is the simple solar optimizer for quick installation and long-lasting performance. Connect PV modules to each PV Link to overcome shading and challenging roof lines.

FEATURES & BENEFITS

- Fast, simple installation
- Lower failure risk than module-level optimizers
- 2017/2020 NEC rapid shutdown compliant with SnapRS™
- Quick connections with MC4 connectors
- Exports up to 2500W
- Compatible with PWRcell™ Inverters
- Cost-effective solution for high-performance PV
- Ground-fault protection

SINGLE-STRING PV ARRAY WITH SnapRS DEVICES

Where PV module-level rapid shutdown is required (NEC 690.12), a SnapRS device (RS) is installed to negative (-) lead of each PV module.

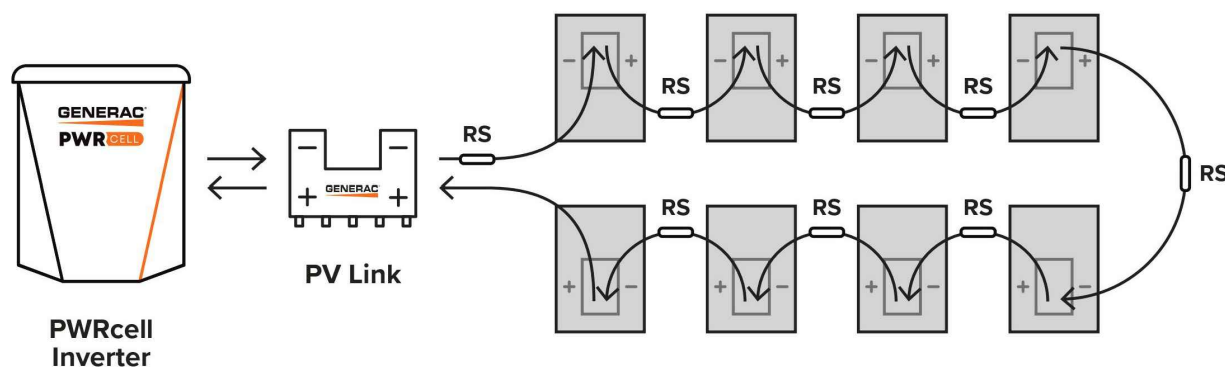

Diagram is applicable for most 60 cell PV modules. Modules with higher cell count may require a different arrangement. Contact Generac for more details.



Specifications

PV Link™ (APKE00010)	
RATED POWER*:	2500W
PEAK EFFICIENCY:	99%
MPPT VOLTAGE RANGE:	60-360 VMP
MAX INPUT VOLTAGE:	420 VOC; max when cold
MAX OUTPUT:	420 VOC
NOMINAL OUTPUT (REbus™):	380 VDC
MAX OUTPUT CURRENT (CONTINUOUS):	8 A
MAX OUTPUT CURRENT (FAULT):	10 A
MAX INPUT CURRENT (CONTINUOUS):	13 A @ 50°C, 10 A @ 70°C
MAX INPUT SHORT CIRCUIT CURRENT (ISC):	18 A
STANDBY POWER:	< 1 W
PROTECTIONS:	Ground-fault, Arc-fault (Arc-fault Type 1 AFCI, Integrated), PVRSE
MAX OPERATING TEMP: FAHRENHEIT (CELSIUS):	158 °F (70 °C)
SYSTEM MONITORING:	PWRview™ Web Portal and Mobile App
ENCLOSURE:	Type 4X
WEIGHT - LB (KG):	7.3 lb (3.3 kg)
DIMENSIONS, L x W x H - IN (MM):	15.4" x 2" x 9.6" (391.2 x 50.8 x 243.8)
COMPLIANCE:	UL 1741, CSA 22.2
WARRANTY:	25 Years

*PV Link can tolerate higher than rated power at its input if Max Input Voltage and Short Circuit Current specifications are not exceeded



Generac Power Systems, Inc.
S45 W29290 Hwy. 59, Waukesha, WI 53189
www.Generac.com | 888-GENERAC (436-3722)
A0000528162 REV D

©2020 Generac Power Systems. All rights reserved.
Specifications are subject to change without notice.

GENERAC

pinkenergy
Proud Sponsor of Planet Earth

PINK ENERGY
PROUD SPONSOR OF PLANET EARTH
919 N. MAIN ST.
MOORESVILLE, NC 28115
Web: www.gopink.com

REVISIONS

DESCRIPTION	DATE	REV

Signature with Seal

DATE: 7/8/2022

PROJECT NAME & ADDRESS

THOMAS K JOHNSON
RESIDENCE
48 DAY TRADING CT.,
BROADWAY, NC 27505

SHEET NAME
EQUIPMENT
SPECIFICATION

SHEET SIZE

ANSI B
11" X 17"

SHEET NUMBER

PV-10



QRail™ — Fully Integrated Mounting and Racking System

The QRail Series is a strong and versatile solar array mounting system that provides unrivaled benefits to solar designers and installers. Combined with Quick Mount PV's industry-leading waterproof mounts, QRail offers a complete racking solution for mounting solar modules on any roof.



Easily design array configurations with the QDesign software application. Generate complete engineering reports and calculate a precise bill of materials for all the mounting, racking and accessories needed for a complete solar array.

Comprehensive, One-Source Solution

QRail, together with Quick Mount PV's waterproof mounting products, provides the benefit of a single-sourced, seamlessly integrated rooftop installation that works with all roof types — composition/asphalt shingles, flat or curved tile, metal shingle, shake, slate and low slope roofs. The QRail system also works with any roof attachment system for maximum flexibility.

Superior Strength and Versatility

QRail is engineered for optimal structural performance. The system is certified to UL 2703, fully code compliant and backed by a 25-year warranty. QRail is available in Light, Standard and Heavy versions to match all geographic locations. QRail is compatible with virtually all modules and works on a wide range of pitched roof surfaces. Modules can be mounted in portrait or landscape orientation in standard or shared-rail configurations.



QRails come in two lengths — 168 inches (14 ft) and 208 inches (17.3 ft) Mill and Black Finish

Fast, Simple Installation: It Just Clicks

QClick Technology™

The universal mid and end clamps use QClick technology to simply "click" into the rail channel and remain upright, ready to accept the module. The pre-assembled clamps fit virtually all module frames and require no extra hardware, eliminating pre-loading and reducing installation time.

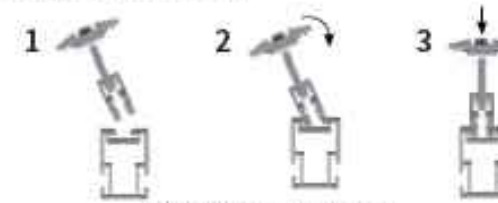

Installing is as easy as 1-2-3



UNIVERSAL END CLAMP
2 clamps for modules from 30-45mm or 38-50mm thick

UNIVERSAL BONDED MID CLAMP
2 clamps for modules from 30-45mm or 38-50mm thick

QSplice™ Technology

QRail's innovative internal QSplice installs in seconds, requiring no tools or screws. Simply insert QSplice into the rail and slide the other rail on to create a fully structural, bonded splice. An external splice is also available.



Installs in seconds — no tools or hardware required

Fully Integrated Electrical Bonding

The QRail system provides an integrated electrical bonding path, ensuring that all exposed metal parts and the solar module frames are electrically connected. All electrical bonds are created when the components are installed and tightened down.

pinkenergy
Proud Sponsor of Planet Earth

PINK ENERGY
PROUD SPONSOR OF PLANET EARTH
919 N. MAIN ST.
MOORESVILLE, NC 28115
Web: www.gopink.com

REVISIONS

DESCRIPTION	DATE	REV

Signature with Seal

DATE: 7/8/2022

PROJECT NAME & ADDRESS

THOMAS K JOHNSON
RESIDENCE
48 DAY TRADING CT.,
BROADWAY, NC 27505

SHEET NAME

EQUIPMENT
SPECIFICATION

SHEET SIZE

ANSI B
11" X 17"

SHEET NUMBER

PV-11

QRail™ Configurations



Item Code	Part Number	Description	Finish
QMR-RL14 A 60	800	QRail Light, 14 ft., 60 Pack	Mill
QMR-RL17.3 A 60	801	QRail Light, 17.3 ft., 60 Pack	Mill
QMR-RL14 B 60	805	QRail Light, 14 ft., 60 Pack	Black
QMR-RL17.3 B 60	806	QRail Light, 17.3 ft., 60 Pack	Black
QMR-RS14 A 60	810	QRail Standard, 14 ft., 60 Pack	Mill
QMR-RS17.3 A 60	811	QRail Standard, 17.3 ft., 60 Pack	Mill
QMR-RS14 B 60	815	QRail Standard, 14 ft., 60 Pack	Black
QMR-RS17.3 B 60	816	QRail Standard, 17.3 ft., 60 Pack	Black
QMR-RH14 A 60	820	QRail Heavy, 14 ft., 60 Pack	Mill
QMR-RH17.3 A 60	821	QRail Heavy, 17.3 ft., 60 Pack	Mill
QMR-RH14 B 60	825	QRail Heavy, 14 ft., 60 Pack	Black
QMR-RH17.3 B 60	826	QRail Heavy, 17.3 ft., 60 Pack	Black

QSplice™ Internal Structural Splice



Item Code	Part Number	Description	Finish
QMR-ISL A 15	830	QSplice Internal, Light, 15 Pack	Mill
QMR-ISS A 15	831	QSplice Internal, Standard, 15 Pack	Mill
QMR-ISH A 15	832	QSplice Internal, Heavy, 15 Pack	Mill

QSplice™ External Structural Splice



Item Code	Part Number	Description	Finish
QMR-ESS A 15	834	QSplice External, Standard, 15 Pack	Mill
QMR-ESH A 15	835	QSplice External, Heavy, 15 Pack	Mill

pinkenergy
Proud Sponsor of Planet Earth

PINK ENERGY
PROUD SPONSOR OF PLANET EARTH
919 N. MAIN ST.
MOORESVILLE, NC 28115
Web: www.gopink.com

REVISIONS		
DESCRIPTION	DATE	REV

Signature with Seal

DATE: 7/8/2022

PROJECT NAME & ADDRESS

THOMAS K JOHNSON
RESIDENCE
48 DAY TRADING CT.,
BROADWAY, NC 27505

SHEET NAME
EQUIPMENT
SPECIFICATION

SHEET SIZE
ANSI B
11" X 17"

SHEET NUMBER
PV-11A

Universal End Clamp with QClick™ Technology



Black

Mill

Item Code	Part Number	Description	Finish
QMR-UEC3045 A 20	860	Universal End Clamp, 30-45mm, 20 Pack	Mill
QMR-UEC3850 A 20	861	Universal End Clamp, 38-50mm, 20 Pack	Mill
QMR-UEC3045 B 20	865	Universal End Clamp, 30-45mm, 20 Pack	Black
QMR-UEC3850 B 20	866	Universal End Clamp, 38-50mm, 20 Pack	Black
QMR-UEC3045BP A 20	862	Universal End Clamp, 30-45mm, w/ Bonding, 20 Pack	Mill
QMR-UEC3850BP A 20	863	Universal End Clamp, 38-50mm, w/ Bonding, 20 Pack	Mill
QMR-UEC3045BP B 20	867	Universal End Clamp, 30-45mm, w/ Bonding, 20 Pack	Black
QMR-UEC3850BP B 20	868	Universal End Clamp, 38-50mm, w/ Bonding, 20 Pack	Black

Mid Clamp with QClick™ Technology



Black

Mill

Item Code	Part Number	Description	Finish
QMR-UMC3045BP 1.2 A 20	872	Universal Mid Clamp, 30-45mm, w/ Bonding, 20 Pack	Mill
QMR-UMC3850BP 1.2 A 20	873	Universal Mid Clamp, 38-50mm, w/ Bonding, 20 Pack	Mill
QMR-UMC3045BP 1.2 B 20	877	Universal Mid Clamp, 30-45mm, w/ Bonding, 20 Pack	Black
QMR-UMC3850BP 1.2 B 20	878	Universal Mid Clamp, 38-50mm, w/ Bonding, 20 Pack	Black

Single-Slot L-Foot



Item Code	Part Number	Description	Finish
QMC-LF A 12	692	Single-slot L-foot, 12 Pack	Mill
QMC-LF B 12	693	Single-slot L-foot, 12 Pack	Black

End Caps



Heavy

Standard

Light

Item Code	Part Number	Description	Finish
QMR-CPL B 50	885	End Cap Light, 50 Pack	Black
QMR-CPS B 50	886	End Cap Standard, 50 Pack	Black
QMR-CPH B 50	887	End Cap Heavy, 50 Pack	Black

pinkenergy
Proud Sponsor of Planet Earth

PINK ENERGY
PROUD SPONSOR OF PLANET EARTH
919 N. MAIN ST.
MOORESVILLE, NC 28115
Web: www.gopink.com

REVISIONS

DESCRIPTION	DATE	REV

Signature with Seal

DATE: 7/8/2022

PROJECT NAME & ADDRESS

THOMAS K JOHNSON
RESIDENCE
48 DAY TRADING CT.,
BROADWAY, NC 27505

SHEET NAME

EQUIPMENT
SPECIFICATION

SHEET SIZE

ANSI B
11" X 17"

SHEET NUMBER

PV-11B

T-Bolt



Item Code	Part Number	Description	Finish
QMR-TB A 300	880	T-Bolt w/ Nut, 300 Pack	stainless steel

Grounding Lug



Item Code	Part Number	Description	Finish
QMR-GL A 50	890	WEEB Lug w/ T-Bolt, 50 Pack	n/a

Wire Clip



Works with both PV and Trunk Cabling

Item Code	Part Number	Description	Finish
QMR-WCA 300	892	Trunk/PV Cable, 300 Pack	stainless steel

WEEB BMC



Item Code	Part Number	Description	Finish
QMR-ECWA 50	891	WEEB BMC, 50 Pack	stainless steel

REVISIONS

DESCRIPTION	DATE	REV

Signature with Seal

DATE: 7/8/2022

PROJECT NAME & ADDRESS

THOMAS K JOHNSON
RESIDENCE
48 DAY TRADING CT.,
BROADWAY, NC 27505

SHEET NAME
EQUIPMENT
SPECIFICATION

SHEET SIZE

ANSI B
11" X 17"

SHEET NUMBER

PV-11C

L-Mount | QMLM / QMLM-ST

Elevated Water Seal Technology®

ITEM NO.	DESCRIPTION	QTY.
1	FLASHING, ROUNDED CORNERS, 9" X 12" X .040", .438" HOLE, 5052, MILL	1
2	L-FOOT, 2" X 3.30" FOR .438" O.D. FASTENER, 2-1/16" SLOT, 6061-T6/6005A-T61, MILL	1
3	WASHER, SEALING, 5/16" ID X 3/4" OD, EPDM BONDED SS	1
4	LAG SCREW, HEX HEAD, 5/16" x 4", 18-8 SS	1
*5	STRUCTURAL SCREW, QMPV, T-30 HEX WASHER HEAD, 5/16" X 4-1/2", 18-8SS	1

Quick Mount PV®
 TITLE: QMLM & QMLM-ST: L-MOUNT, 2-1/16" SLOT
 UNLESS OTHERWISE SPECIFIED: DIMENSIONS ARE IN INCHES
 TOLERANCES: FRACTIONAL ± 1/32
 TWO PLACE DECIMAL ± .015
 THREE PLACE DECIMAL ± .004
 SIZE: A DRAWN BY: AAP REV: 11
 DATE: 4/4/2019
 SCALE: 1:4 WEIGHT: 0.7566 SHEET 1 OF 1

L-Mount Installation Instructions

Installation Tools Required: tape measure, roofing bar, chalk line, stud finder, caulking gun, sealant compatible with roofing materials, drill with 7/32" or 1/8" bit, drill or impact gun with 1/2" socket.

WARNING: Quick Mount PV products are NOT designed for and should NOT be used to anchor fall protection equipment.

1 Locate, choose, and mark centers of rafters to be mounted. Select the courses of shingles where mounts will be placed.

2 Carefully lift composition roof shingle with roofing bar, just above placement of mount. Remove nails as required and backfill holes with approved sealant. See "Proper Flashing Placement" on next page.

3 Insert flashing between 1st and 2nd course. Slide up so top edge of flashing is at least 3/4" higher than the butt-edge of the 3rd course and lower flashing edge is above the butt-edge of 1st course. Mark center for drilling.

4 If attaching with lag bolt use a 7/32" bit (Lag). Use a 1/8" bit (ST) for attaching with the structural screw. Drill pilot hole into roof and rafter, taking care to drill square to the roof. Do not use mount as a drill guide. Drill a 2" deep hole into rafter.

5 Clean off any sawdust, and fill hole with sealant compatible with roofing materials.

6 Place L-foot onto elevated flange and rotate L-foot to desired orientation.

7 Prepare lag bolt or structural screw with sealing washer. Using a 1/2-inch socket on an impact gun, drive prepared lag bolt through L-foot until L-foot can no longer easily rotate. **DO NOT over-torque.** NOTE: Structural screw can be driven with T-30 hex head bit.

8 You are now ready for the rack of your choice. Follow all the directions of the rack manufacturer as well as the module manufacturer. NOTE: Make sure top of L-Foot makes solid contact with racking.

All roofing manufacturers' written instructions must also be followed by anyone modifying a roof system. Consult the roof manufacturer's specs and instructions prior to working on the roof.

BI 7.2.3-44

Apr-2019 Rev 6

Quick Mount PV®
RESPECT THE ROOF

pinkenergy
Proud Sponsor of Planet Earth

PINK ENERGY
PROUD SPONSOR OF PLANET EARTH
919 N. MAIN ST.
MOORESVILLE, NC 28115
Web: www.gopink.com

REVISIONS

DESCRIPTION	DATE	REV

Signature with Seal

DATE: 7/8/2022

PROJECT NAME & ADDRESS

THOMAS K JOHNSON
RESIDENCE
48 DAY TRADING CT.,
BROADWAY, NC 27505

SHEET NAME
EQUIPMENT
SPECIFICATION

SHEET SIZE
ANSI B
11" X 17"

SHEET NUMBER
PV-12

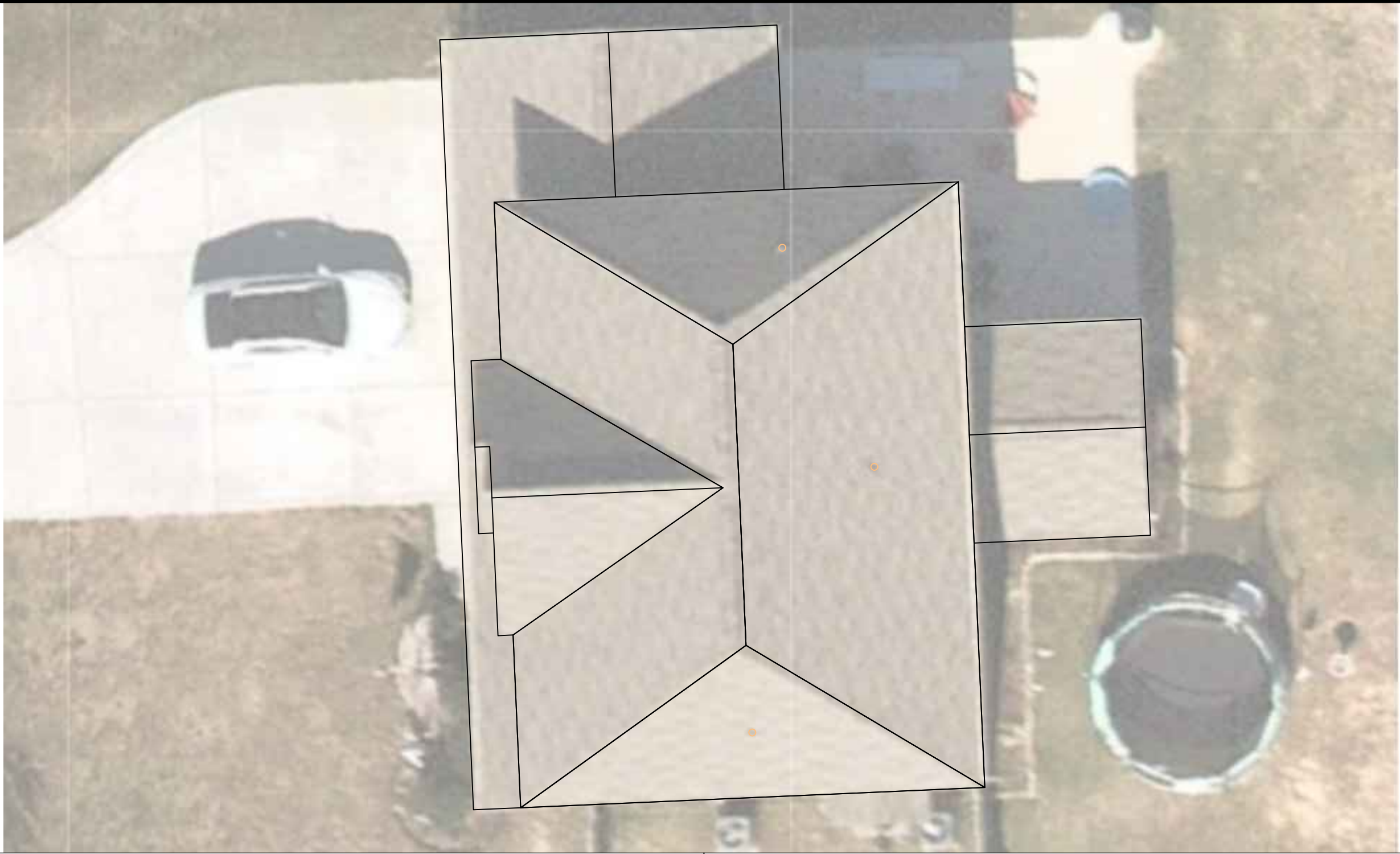

pinkenergy
Proud Sponsor of Planet Earth

PINK ENERGY
PROUD SPONSOR OF PLANET EARTH
919 N. MAIN ST.
MOORESVILLE, NC 28115
Web: www.gopink.com

REVISIONS

DESCRIPTION	DATE	REV

Signature with Seal

DATE: 7/8/2022

PROJECT NAME & ADDRESS

THOMAS K JOHNSON
RESIDENCE
48 DAY TRADING CT.,
BROADWAY, NC 27505

SHEET NAME

AS BUILT
SIGN OFF

SHEET SIZE

ANSI B
11" X 17"

SHEET NUMBER

PV-13

HOME OWNER SIGNATURE & DATE

PHS EMPLOYEE WITNESS SIGNATURE & DATE

DESIGN CHANGES:
PANEL LAYOUT CHANGE:
EQUIPMENT LOCATION :
BATTERY LOCATION:
POINT OF INTERCONNECTION:

ADDITIONAL NOTES: