

PROJECT DESCRIPTION:

14 X 400 HANWHA QCELL Q.PEAK DUO BLK ML-G10+ 400 MODULES
 ROOF MOUNTED SOLAR PHOTOVOLTAIC MODULES

EQUIPMENT SUMMARY

- 14 HANWHA QCELL Q.PEAK DUO BLK ML-G10+ 400 MODULES
- 04 GENERAC PV LINK S2502 POWER OPTIMIZERS
- 01 GENERAC PWRCELL XVT076A03 (7.6KW) INVERTER

SYSTEM SIZE: 5.60 kW DC STC
 ARRAY AREA: ROOF#1 - 84.48 SQ FT
 ARRAY AREA: ROOF#2 - 84.48 SQ FT
 ARRAY AREA: ROOF#3 - 84.48 SQ FT
 ARRAY AREA: ROOF#4 - 42.24 SQ FT

APPLICABLE CODES & STANDARDS
 NORTH CAROLINA RESIDENTIAL CODE 2018
 NEC 2017

AUTHORITIES HAVING JURISDICTION
 BUILDING : HARNETT COUNTY
 ZONING : HARNETT COUNTY
 UTILITY : SOUTH RIVER EMC

DESIGN SPECIFICATIONS

OCCUPANCY : II
 CONSTRUCTION : SINGLE-FAMILY
 ZONING : RESIDENTIAL
 GROUND SNOW LOAD : SEE STRUCTURAL LETTER
 WIND EXPOSURE : SEE STRUCTURAL LETTER
 WIND SPEED : SEE STRUCTURAL LETTER



2 HOUSE PHOTO

PV-1 | SCALE: NTS

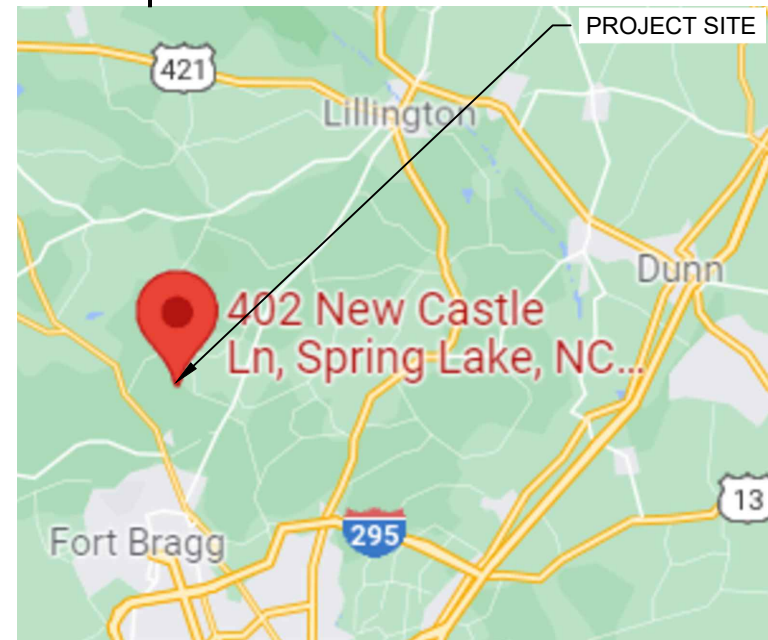

3 VICINITY MAP

PV-1 | SCALE: NTS

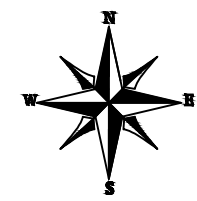
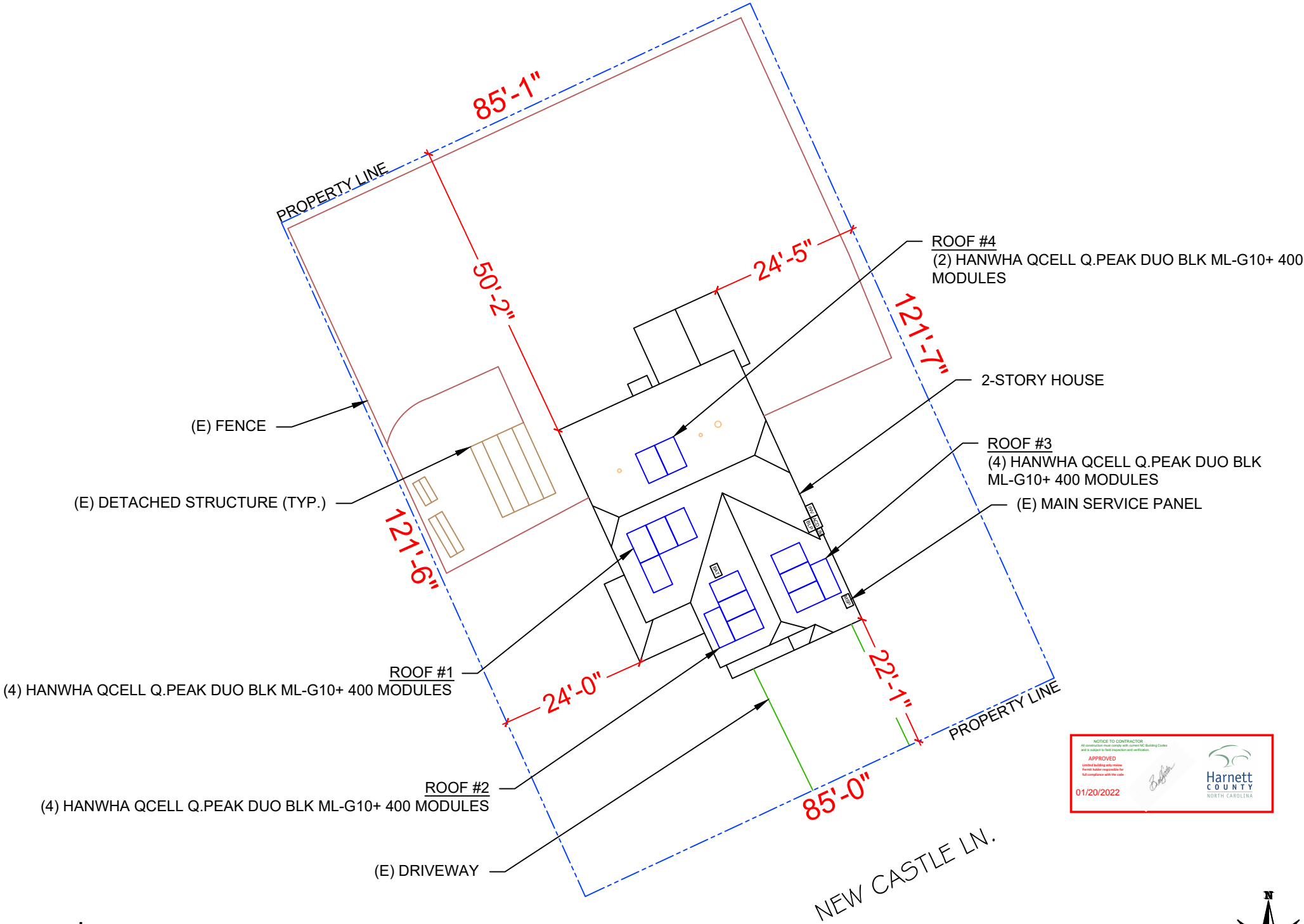

1 PLOT PLAN & VICINITY MAP

PV-1 | SCALE: 1"=20'-0"

POWERHOME
 POWER HOME SOLAR, LLC
 "POWER YOUR FUTURE"
 919 N. MAIN ST.
 MOORESVILLE, NC 28115
 Phone: 704-800-6591 (OFFICE)
 Email: info@powerhome.com
 Web: www.powerhome.com

| REVISIONS | | |
|-------------|------|-----|
| DESCRIPTION | DATE | REV |
| | | |
| | | |
| | | |
| | | |

Signature with Seal
 DATE: 1/13/2022

PROJECT NAME & ADDRESS
**RONIEL SWABY
 RESIDENCE**
 402 NEW CASTLE LN.,
 SPRING LAKE, NC 28390

SHEET NAME
**PLOT PLAN &
 VICINITY MAP**

SHEET SIZE
**ANSI B
 11" X 17"**

SHEET NUMBER
PV-1

SHEET INDEX

| | |
|------------|--------------------------|
| PV-1 | PLOT PLAN & VICINITY MAP |
| PV-2 | ROOF PLAN & MODULES |
| PV-2A | STRING LAYOUT |
| PV-3 | ATTACHMENT DETAIL |
| PV-4 | ELECTRICAL LINE DIAGRAM |
| PV-5 | WIRING CALCULATIONS |
| PV-6 to 12 | EQUIPMENT SPECIFICATIONS |

MODULE TYPE, DIMENSIONS & WEIGHT

NUMBER OF MODULES = 14 MODULES
 MODULE TYPE = HANWHA QCELL Q.PEAK DUO BLK ML-G10+ 400 MODULES
 MODULE WEIGHT = 48.5 LBS / 22.0 KG.
 MODULE DIMENSIONS = 74.00"x 41.1" = 21.12 SF
 UNIT WEIGHT OF ARRAY = 2.30 PSF

ARRAY AREA & ROOF AREA CALC'S

| ROOF | # OF MODULES | ARRAY AREA (Sq. Ft.) | ROOF AREA (Sq. Ft.) | ROOF AREA COVERED BY ARRAY (%) |
|------|--------------|----------------------|---------------------|--------------------------------|
| #1 | 4 | 84.48 | 371.55 | 23 |
| #2 | 4 | 84.48 | 226.90 | 37 |
| #3 | 4 | 84.48 | 240.77 | 35 |
| #4 | 2 | 42.24 | 529.58 | 8 |

ROOF DESCRIPTION

| ROOF TYPE | | | COMPOSITION SHINGLE | |
|-----------|-----------|---------|-----------------------|-----------------|
| ROOF | ROOF TILT | AZIMUTH | FRAMING SIZE | FRAMING SPACING |
| #1 | 30.26° | 155° | SEE STRUCTURAL LETTER | |
| #2 | 33.69° | 245° | | |
| #3 | 33.69° | 65° | | |
| #4 | 30.26° | 335° | | |

POWERHOME
 POWER HOME SOLAR, LLC
 "POWER YOUR FUTURE"
 919 N. MAIN ST.
 MOORESVILLE, NC 28115
 Phone: 704-800-6591 (OFFICE)
 Email: info@powerhome.com
 Web: www.powerhome.com

REVISIONS

| DESCRIPTION | DATE | REV |
|-------------|------|-----|
| | | |
| | | |
| | | |
| | | |

Signature with Seal
 DATE: 1/13/2022

PROJECT NAME & ADDRESS
RONIEL SWABY RESIDENCE
 402 NEW CASTLE LN.,
 SPRING LAKE, NC 28390

SHEET NAME
ROOF PLAN & MODULES
 SHEET SIZE
ANSI B 11" X 17"
 SHEET NUMBER
PV-2

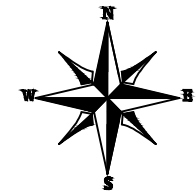

1 ROOF PLAN & MODULES
 SCALE: 1/8" = 1'-0"

ON- SITE CUSTOMER APPROVAL: _____

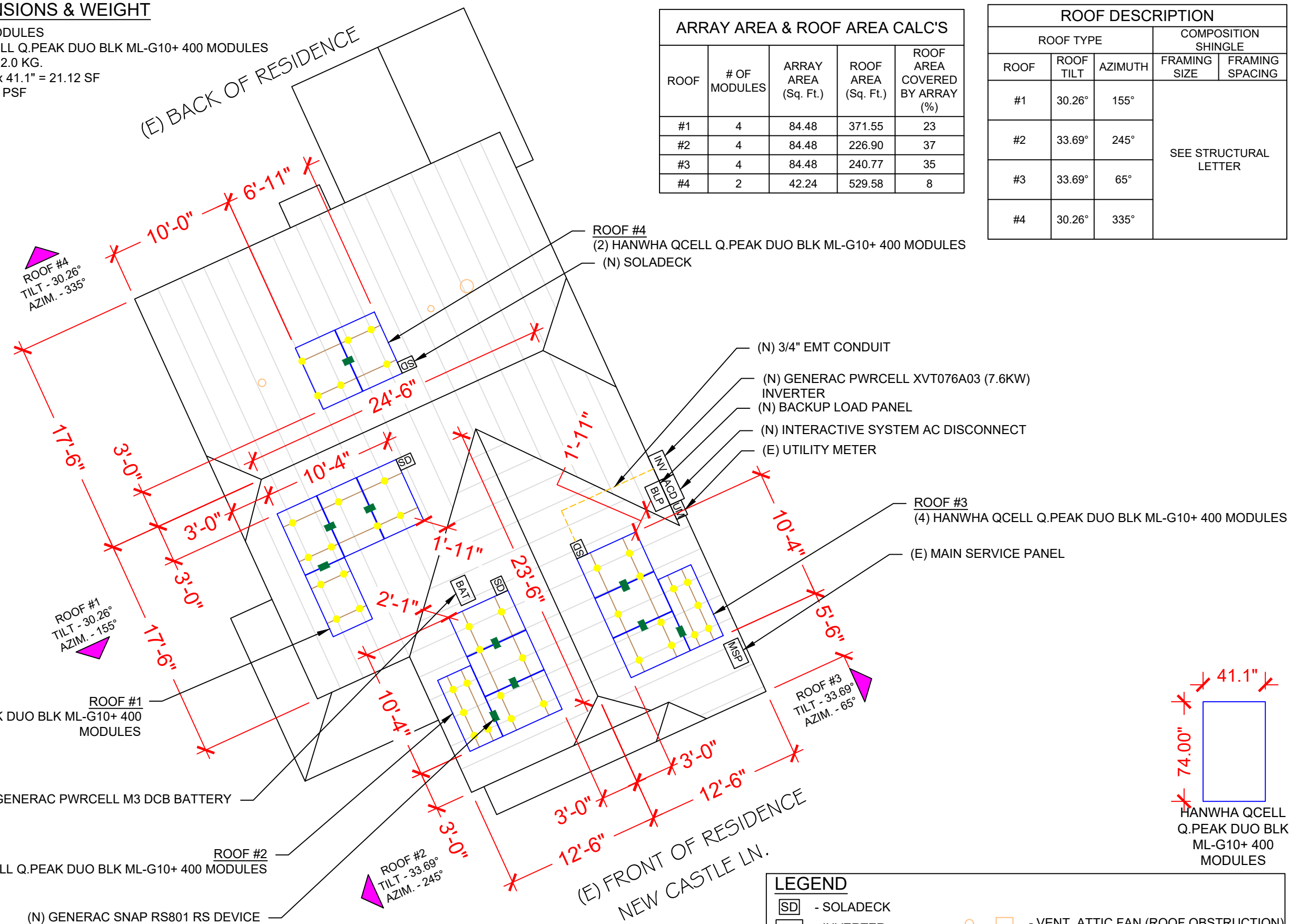

LEGEND

| | | | |
|-------|------------------------------------|-----|--------------------------------------|
| [SD] | - SOLADECK | ○ □ | - VENT, ATTIC FAN (ROOF OBSTRUCTION) |
| [INV] | - INVERTER | ● | - ROOF ATTACHMENT |
| [ACD] | - INTERACTIVE SYSTEM AC DISCONNECT | --- | - RAFTERS |
| [MSP] | - MAIN SERVICE PANEL | --- | - CONDUIT |
| [BLP] | - BACKUP LOAD PANEL | ■ | - RAPID SHUTDOWN |
| [BAT] | - BATTERY | | |
| [OP] | - PV LINK OPTIMIZER | | |



POWERHOME
 POWER HOME SOLAR, LLC
 "POWER YOUR FUTURE"
 919 N. MAIN ST.
 MOORESVILLE, NC 28115
 Phone: 704-800-6591 (OFFICE)
 Email: info@powerhome.com
 Web: www.powerhome.com

| REVISIONS | | |
|-------------|------|-----|
| DESCRIPTION | DATE | REV |
| | | |
| | | |
| | | |
| | | |
| | | |

Signature with Seal

 DATE: 1/13/2022

PROJECT NAME & ADDRESS

**RONEIL SWABY
 RESIDENCE**
 402 NEW CASTLE LN.,
 SPRING LAKE, NC 28390

SHEET NAME
**STRING
 LAYOUT**

SHEET SIZE
**ANSI B
 11" X 17"**

SHEET NUMBER
PV-2A

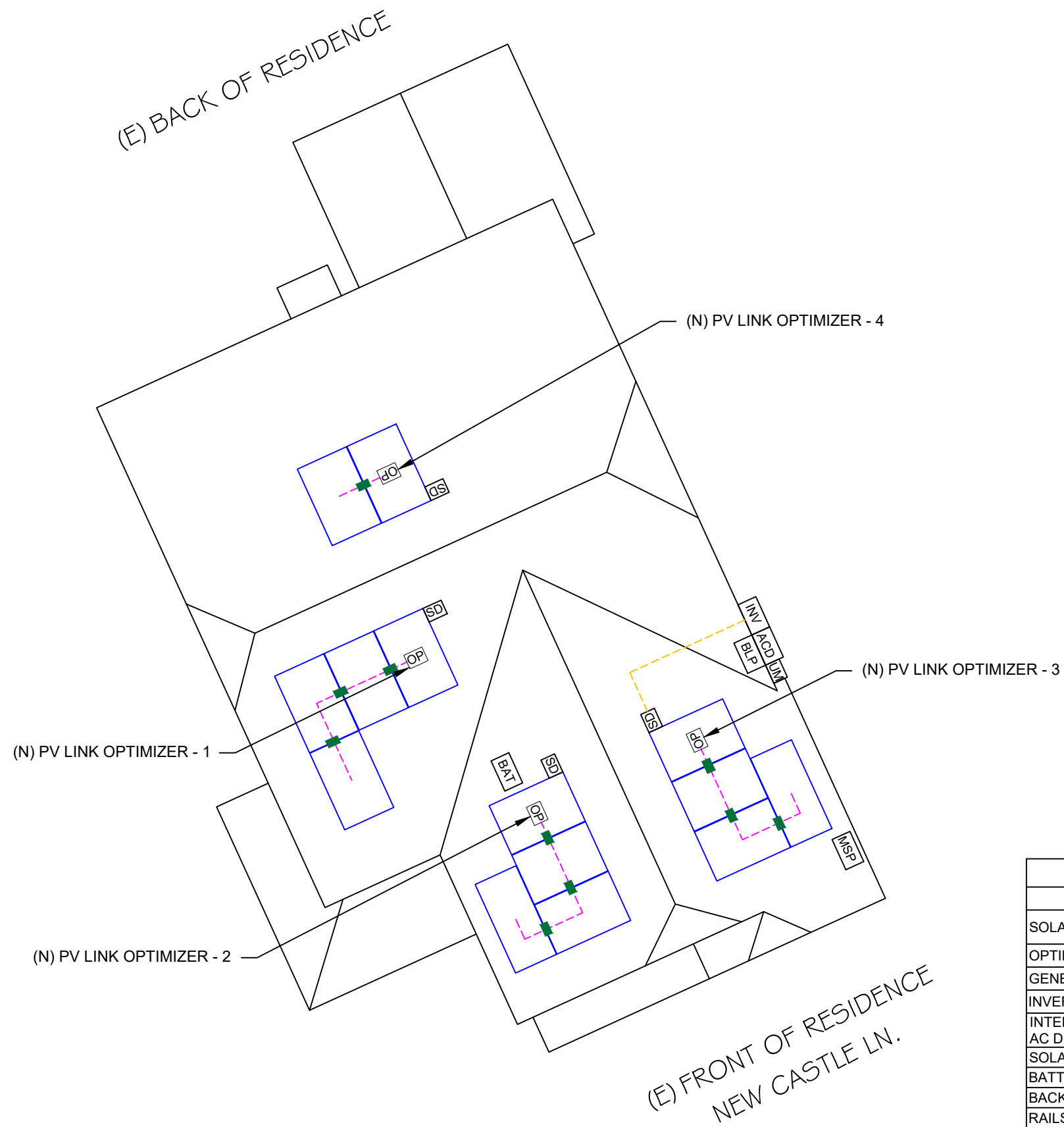

| BILL OF MATERIALS | | |
|----------------------------------|-----|--|
| EQUIPMENT | QTY | DESCRIPTION |
| SOLAR PV MODULE | 14 | HANWHA QCELL Q.PEAK DUO BLK ML-G10+ 400 MODULES |
| OPTIMIZER | 04 | GENERAC PV LINK S2502 POWER OPTIMIZERS |
| GENERAC SNAP RS | 14 | GENERAC SNAPRS MODEL RS801 |
| INVERTER | 01 | GENERAC PWRCELL XVT076A03 (7.6KW) INVERTER |
| INTERACTIVE SYSTEM AC DISCONNECT | 1 | 60A FUSED, (2) 40A FUSES, 240V, NEMA 3R, UL LISTED |
| SOLADECK | 4 | SOLADECKS 600 V, NEMA 3R, UL LISTED |
| BATTERY | 1 | GENERAC PWRCELL IR M3 DCB BATTERY |
| BACKUP PANEL | 1 | 125A, BACKUP PANEL, 240V |
| RAILS | 11 | QRAIL LIGHT 14 FT. BLACK |
| SPLICE KIT | 0 | QSPLICE INTERNAL LIGHT |
| WEEB BMC | 12 | WEEB BMC MILL |
| MODULE CLAMPS | 14 | UNIVERSAL MID CLAMP |
| GROUNDING LUG | 7 | WEEB LUG W/ T-BOLT |
| END CLAMPS | 28 | UNIVERSAL END CLAMPS |
| ATTACHMENT | 41 | L-MOUNT ATTACHMENT (QUICKMOUNT) |
| T-BOLT | 45 | T-BOLT W/ NUT M8 X 20MM |

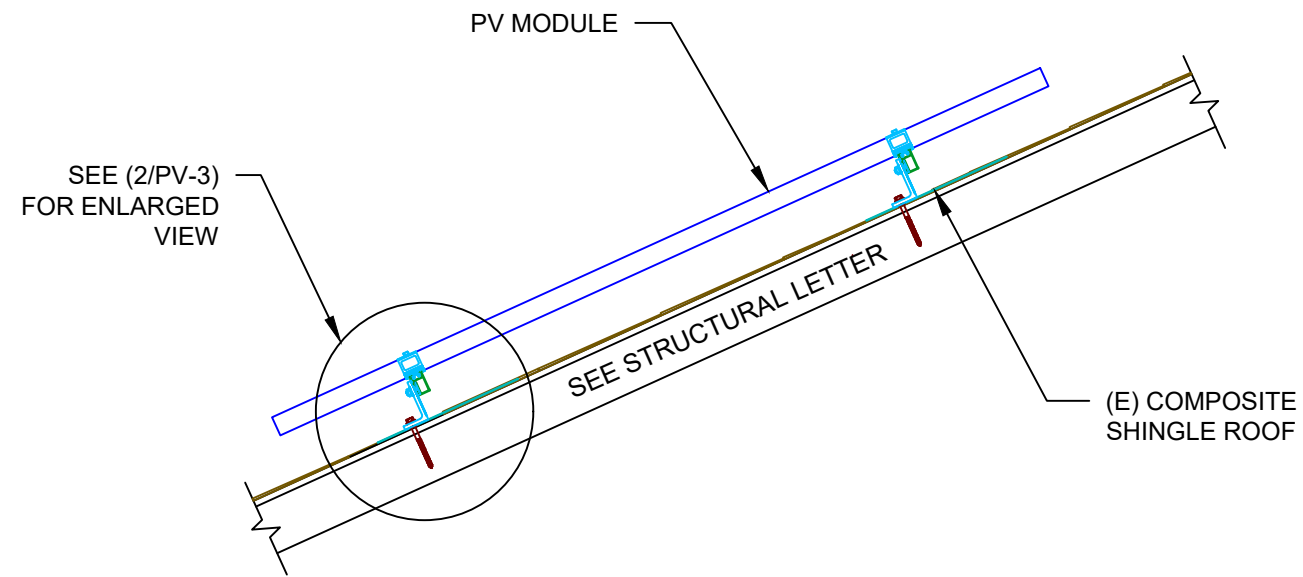

1 | ATTACHMENT DETAIL
 PV-3 | SCALE: 1" = 1'-0"

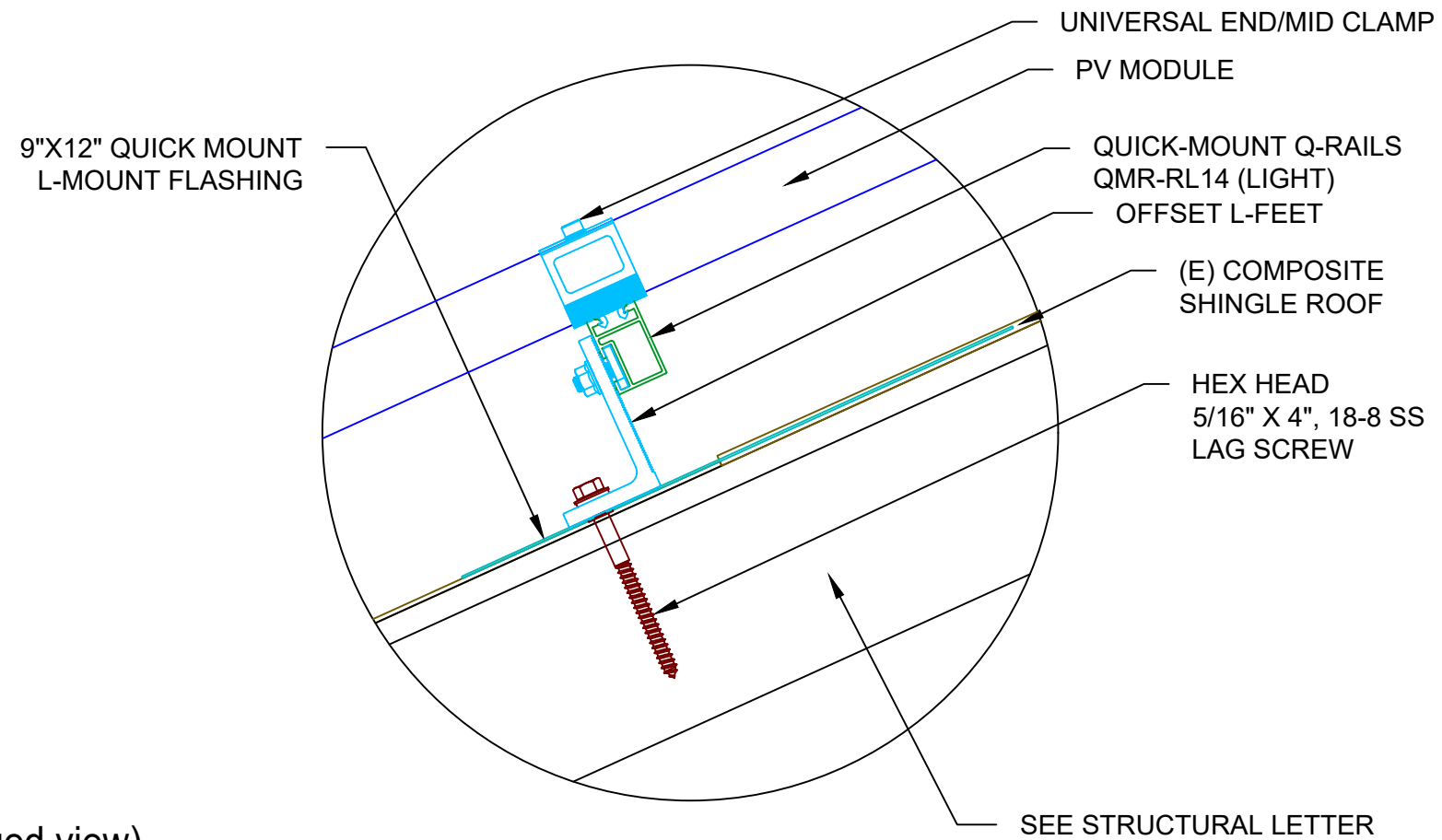

2 | ATTACHMENT DETAIL (enlarged view)
 PV-3 | SCALE: NTS

POWERHOME
 POWER HOME SOLAR, LLC
 "POWER YOUR FUTURE"
 919 N. MAIN ST.
 MOORESVILLE, NC 28115
 Phone: 704-800-6591 (OFFICE)
 Email: info@powerhome.com
 Web: www.powerhome.com

| REVISIONS | | |
|-------------|------|-----|
| DESCRIPTION | DATE | REV |
| | | |
| | | |
| | | |
| | | |
| | | |

Signature with Seal
 DATE: 1/13/2022

PROJECT NAME & ADDRESS
**RONEIL SWABY
 RESIDENCE**
 402 NEW CASTLE LN.,
 SPRING LAKE, NC 28390

SHEET NAME
**ATTACHMENT
 DETAIL**

SHEET SIZE
**ANSI B
 11" X 17"**

SHEET NUMBER
PV-3

- (14) HANWHA QCELL Q.PEAK DUO BLK ML-G10+ 400 MODULES
- (1) PV LINK OF 2 MODULES &
- (3) PV LINKS OF 4 MODULES CONNECTED IN SERIES

SERVICE INFO

UTILITY PROVIDER: SOUTH RIVER EMC
 MAIN SERVICE VOLTAGE: 240V
 MAIN PANEL BRAND: N/A
 MAIN SERVICE PANEL: 200A
 MAIN CIRCUIT BREAKER RATING: 200A
 MAIN SERVICE LOCATION: NORTH-EAST
 SERVICE FEED SOURCE: UNDERGROUND

WIRE LEGEND

- PV ARRAY +VE CONDUCTOR AND L1
- PV ARRAY -VE CONDUCTOR AND L2
- NEUTRAL CONDUCTOR
- EGC AND GEC
- SINGLE TWISTED PAIR, CAT 5 WIRE

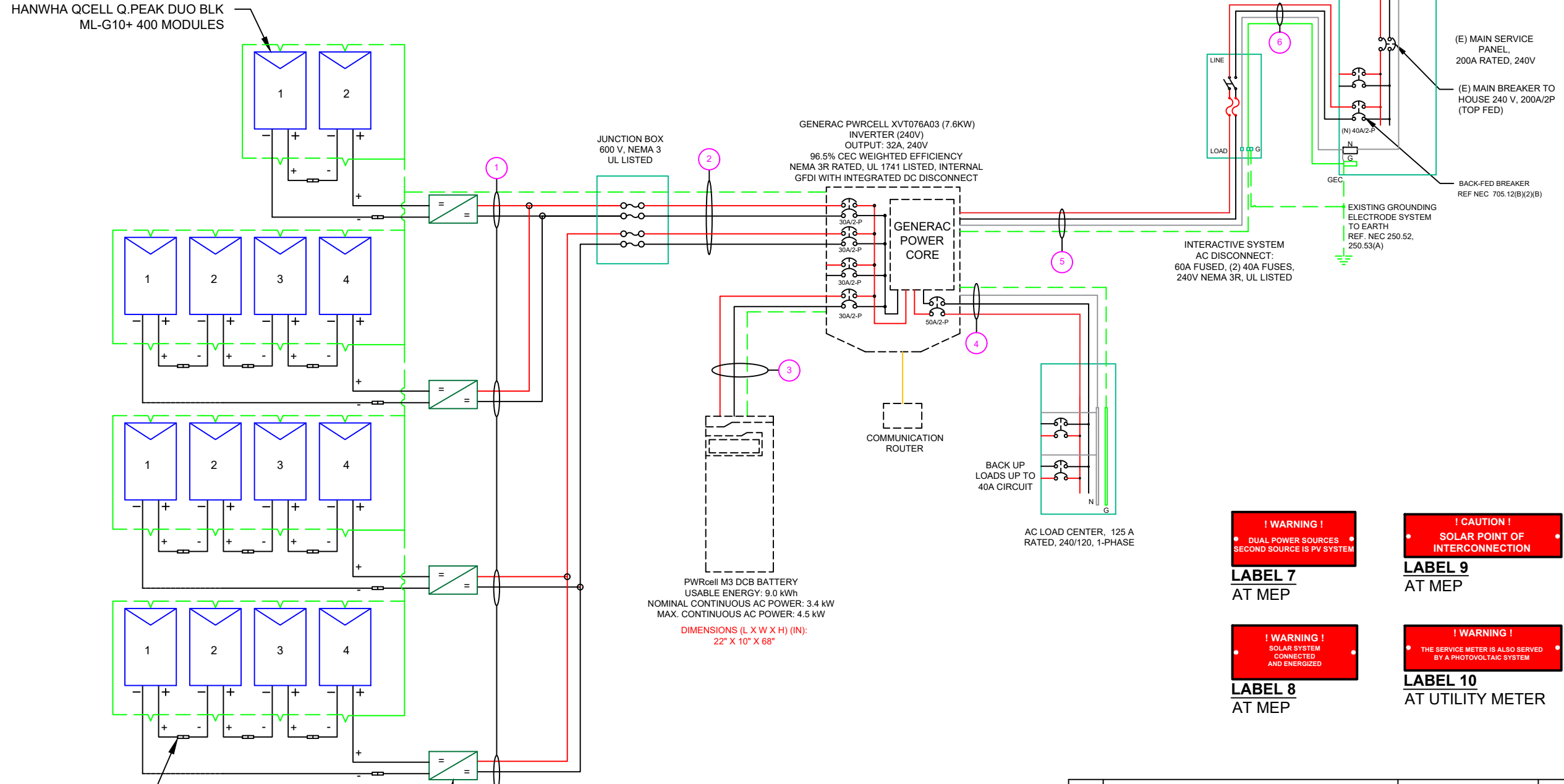

SNAP RS (RS801)
 MAX INPUT CURRENT - 13 A
 UL 1741 LISTED
 MODULE LEVEL RAPID
 SHUTDOWN (PVRSS)
 COMPLIANT
 NEMA 6P RATED

PVLINK SUBSTRING OPTIMIZER (S2502)
 RATED POWER : 2500W
 MPPT VOLTAGE RANGE: 60 TO 360 V
 MAX OUTPUT VOLTAGE: 420V
 MAX OUTPUT CURRENT: 8A
 RAPID SHUTDOWN COMPLIANT
 GROUND-FAULT PROTECTION COMPLIANT

! WARNING !
 PHOTOVOLTAIC
 POWER SOURCE

LABEL 1
 ON ALL PV CONDUITS
 SPACED AT MAX 10FT

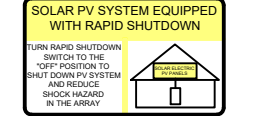

LABEL 2
 AT INVERTER

! CAUTION !
 SOLAR ELECTRIC
 SYSTEM CONNECTED
 AND ENERGIZED

LABEL 3
 AT INVERTER

**! PHOTOVOLTAIC
 DC DISCONNECT !**

LABEL 4
 AT EACH DC
 DISCONNECT

! WARNING !
 ELECTRIC SHOCK HAZARD
 DO NOT TOUCH TERMINALS.
 TERMINALS ON BOTH LINE AND LOAD SIDES
 MAY BE ENERGIZED IN THE OPEN POSITION

LABEL 5
 AT EACH AC
 DISCONNECT

**! PHOTOVOLTAIC
 AC DISCONNECT !**

LABEL 6
 AT EACH AC
 DISCONNECT

! WARNING !
 DUAL POWER SOURCES
 SECOND SOURCE IS PV SYSTEM

LABEL 7
 AT MEP

! CAUTION !
 SOLAR POINT OF
 INTERCONNECTION

LABEL 9
 AT MEP

! WARNING !
 SOLAR SYSTEM
 CONNECTED
 AND ENERGIZED

LABEL 8
 AT MEP

! WARNING !
 THE SERVICE METER IS ALSO SERVED
 BY A PHOTOVOLTAIC SYSTEM

LABEL 10
 AT UTILITY METER

| QTY | CONDUCTOR INFORMATION | CONDUIT TYPE | CONDUIT SIZE |
|-----|---------------------------------|----------------------|--------------|
| (8) | #10AWG - PV WIRE/USE-2 | N/A | N/A |
| (1) | #6AWG - BARE COPPER IN FREE AIR | N/A | N/A |
| (4) | #10AWG - THWN-2 | EMT OR FLEX IN ATTIC | 3/4" |
| (1) | #6AWG - THWN-2 GND | EMT OR FLEX | 3/4" |
| (2) | #10AWG - THWN-2 | EMT OR FLEX | 3/4" |
| (1) | #10AWG - THWN-2 GND | EMT OR FLEX | 3/4" |
| (3) | #6AWG - THWN-2 | EMT OR FLEX | 3/4" |
| (1) | #6AWG - THWN-2 GND | EMT OR FLEX | 3/4" |
| (3) | #6AWG - THWN-2 | EMT OR FLEX | 3/4" |
| (1) | #6AWG - THWN-2 GND | EMT OR FLEX | 3/4" |
| (3) | #6AWG - THWN-2 | EMT OR FLEX | 3/4" |
| (1) | #6AWG - THWN-2 GND | EMT OR FLEX | 3/4" |

POWERHOME
 POWER HOME SOLAR, LLC
 "POWER YOUR FUTURE"
 919 N. MAIN ST.
 MOORESVILLE, NC 28115
 Phone: 704-800-6591 (OFFICE)
 Email: info@powerhome.com
 Web: www.powerhome.com

REVISIONS

| DESCRIPTION | DATE | REV |
|-------------|------|-----|
| | | |
| | | |
| | | |
| | | |

Signature with Seal
 DATE: 1/13/2022

PROJECT NAME & ADDRESS
**RONIEL SWABY
 RESIDENCE**
 402 NEW CASTLE LN.,
 SPRING LAKE, NC 28390

SHEET NAME
**ELECTRICAL LINE
 DIAGRAM**

SHEET SIZE
**ANSI B
 11" X 17"**

SHEET NUMBER
PV-4

| SOLAR MODULE SPECIFICATIONS | |
|-----------------------------|--|
| MANUFACTURER / MODEL # | HANWHA QCELL Q.PEAK DUO BLK ML-G10+400 |
| VMP | 37.13V |
| IMP | 10.77A |
| VOC | 45.30V |
| ISC | 11.14A |
| TEMP. COEFF. VOC | -0.27%/°C |
| PTC RATING | 376.56W |
| MODULE DIMENSION | 74.00"L x 41.1"W x 1.26"D (In Inch) |

| INVERTER SPECIFICATIONS | |
|---------------------------------------|-----------------------------------|
| MANUFACTURER / MODEL # | GENERAC PWRCELL XVT076A03 (7.6KW) |
| AC POWER OUTPUT (LOADS/GRID) | 7600VA |
| AC POWER OUTPUT (BACKUP) | 8000VA |
| NOMINAL OUTPUT VOLTAGE | 240 VAC |
| MAX OUTPUT CURRENT @240V (LOADS/GRID) | 32A |
| MAX OUTPUT CURRENT @240V (BACKUP) | 50A |
| NOMINAL DC INPUT VOLTAGE | 380Vdc |
| MAX DC INPUT VOLTAGE | 420Vdc |
| CEC WEIGHTED EFFICIENCY | 96.5% |
| MAX DC POWER (PV) | 10000W |
| MAX INPUT CURRENT (PV) | 20Adc |
| CONT. PEAK POWER (BATTERY) | 8000W |

| SERIES SUB STRING OPTIMIZER SPECIFICATIONS | |
|--|---------------|
| MANUFACTURER / MODEL # | PV LINK S2502 |
| RATED POWER | 2500W |
| MPPT VOLTAGE RANGE | 60-360 Vmp |
| MAXIMUM INPUT VOLTAGE | 420Voc |
| MAXIMUM OUTPUT | 420 Adc |
| NOMINAL OUTPUT | 380 Vdc |
| MAXIMUM OUTPUT CURRENT | 8 A |
| MAXIMUM SHORT CIRCUIT CURRENT | 18 A |

| BATTERY SPECIFICATIONS | |
|-------------------------------------|--------------------------------|
| MANUFACTURER / MODEL # | GENERAC PWRCELL M3 DCB BATTERY |
| USABLE ENERGY | 9.0kWH |
| NOMINAL CONTINUOUS AC POWER | 3.4kW |
| MAX. CONTINUOUS AC POWER | 4.5kW |
| PEAK MOTOR STARTING CURRENT (2 SEC) | 25A |
| REBUS VOLTAGE: INPUT/ OUTPUT | 360-420Vdc |
| MODULE VOLTAGE | 46.8Vdc |
| ROUND-TRIP EFFICIENCY | 96.5% |

ELECTRICAL NOTES

- 1.) ALL EQUIPMENT TO BE LISTED BY UL OR OTHER NRTL, AND LABELED FOR ITS APPLICATION.
- 2.) ALL CONDUCTORS SHALL BE COPPER, RATED FOR 600 V AND 90 DEGREE C WET ENVIRONMENT.
- 3.) WIRING, CONDUIT, AND RACEWAYS MOUNTED ON ROOFTOPS SHALL BE ROUTED DIRECTLY TO, AND LOCATED AS CLOSE AS POSSIBLE TO THE NEAREST RIDGE, HIP, OR VALLEY.
- 4.) WORKING CLEARANCES AROUND ALL NEW AND EXISTING ELECTRICAL EQUIPMENT SHALL COMPLY WITH NEC 110.26.
- 5.) DRAWINGS INDICATE THE GENERAL ARRANGEMENT OF SYSTEMS. CONTRACTOR SHALL FURNISH ALL NECESSARY OUTLETS, SUPPORTS, FITTINGS AND ACCESSORIES TO FULFILL APPLICABLE CODES AND STANDARDS.
- 6.) WHERE SIZES OF JUNCTION BOXES, RACEWAYS, AND CONDUITS ARE NOT SPECIFIED, THE CONTRACTOR SHALL SIZE THEM ACCORDINGLY.
- 7.) ALL WIRE TERMINATIONS SHALL BE APPROPRIATELY LABELED AND READILY VISIBLE.
- 8.) MODULE GROUNDING CLIPS TO BE INSTALLED BETWEEN MODULE FRAME AND MODULE SUPPORT RAIL, PER THE GROUNDING CLIP MANUFACTURER'S INSTRUCTION.
- 9.) MODULE SUPPORT RAIL TO BE BONDED TO CONTINUOUS COPPER G.E.C. VIA WEEB LUG OR ILSCO GBL-4DBT LAY-IN LUG.
- 10.) THE POLARITY OF THE GROUNDED CONDUCTORS IS NEGATIVE

| AMBIENT TEMPERATURE SPECS | |
|-----------------------------|------|
| RECORD LOW TEMP | -19° |
| AMBIENT TEMP (HIGH TEMP 2%) | 34° |
| CONDUIT HEIGHT | 0.5" |
| ROOF TOP TEMP | 56° |

**DC CONDUCTOR AMPACITY CALCULATIONS:
PV LINK OPTIMIZER TO JUNCTION BOX:**

| | |
|--|--------|
| EXPECTED WIRE TEMP (In Celsius) | 56° |
| TEMP. CORRECTION PER NEC TABLE 310.15 (B)(2)(a) | 0.71 |
| NO. OF CURRENT CARRYING CONDUCTORS | 8 |
| CONDUIT FILL CORRECTION PER NEC TABLE 310.15(B)(3)(a) | 0.7 |
| CIRCUIT CONDUCTOR SIZE | 10 AWG |
| CIRCUIT CONDUCTOR AMPACITY PER NEC TABLE 310.15(B)(16) | 40A |

| | |
|---|--------|
| REQUIRED CIRCUIT CONDUCTOR AMPACITY PER NEC 690.8(A&B) | 10A |
| 1.25 X I _{max} | |
| DERATED AMPACITY OF CIRCUIT CONDUCTOR | 19.88A |
| TEMP. CORRECTION PER TABLE 310.15 (B)(2)(a) X CONDUIT FILL CORRECTION PER NEC 310.15(B)(3)(a) X CIRCUIT CONDUCTOR AMPACITY 310.15 (B)(16) | |
| Result should be greater than (10A) otherwise less the entry for circuit conductor size and ampacity | |

FROM JUNCTION BOX TO INVERTER:

| | |
|--|--------|
| EXPECTED WIRE TEMP (In Celsius) | 56° |
| TEMP. CORRECTION PER NEC TABLE 310.15 (B)(2)(a) | 0.71 |
| NO. OF CURRENT CARRYING CONDUCTORS | 4 |
| CONDUIT FILL CORRECTION PER NEC TABLE 310.15(B)(3)(a) | 0.8 |
| CIRCUIT CONDUCTOR SIZE | 10 AWG |
| CIRCUIT CONDUCTOR AMPACITY PER NEC TABLE 310.15(B)(16) | 40A |

| | |
|---|--------|
| REQUIRED CIRCUIT CONDUCTOR AMPACITY PER NEC 690.8(A&B) | 20A |
| 1.25 X I _{max} X # of PV LINKS | |
| DERATED AMPACITY OF CIRCUIT CONDUCTOR | 22.72A |
| TEMP. CORRECTION PER TABLE 310.15 (B)(2)(a) X CONDUIT FILL CORRECTION PER NEC 310.15(B)(3)(a) X CIRCUIT CONDUCTOR AMPACITY 310.15 (B)(16) | |
| Result should be greater than (20A) otherwise less the entry for circuit conductor size and ampacity | |

FROM BATTERY TO INVERTER:

| | |
|--|--------|
| EXPECTED WIRE TEMP (In Celsius) | 34° |
| TEMP. CORRECTION PER NEC TABLE 310.15 (B)(2)(a) | 0.96 |
| NO. OF CURRENT CARRYING CONDUCTORS | 2 |
| CONDUIT FILL CORRECTION PER NEC TABLE 310.15(B)(3)(a) | 1 |
| CIRCUIT CONDUCTOR SIZE | 10 AWG |
| CIRCUIT CONDUCTOR AMPACITY PER NEC TABLE 310.15(B)(16) | 40A |

| | |
|---|--------|
| REQUIRED CIRCUIT CONDUCTOR AMPACITY PER NEC 690.8(A&B) | 31.25A |
| 1.25 X I _{max} (= 25A) | |
| DERATED AMPACITY OF CIRCUIT CONDUCTOR | 38.40A |
| TEMP. CORRECTION PER TABLE 310.15 (B)(2)(a) X CONDUIT FILL CORRECTION PER NEC 310.15(B)(3)(a) X CIRCUIT CONDUCTOR AMPACITY 310.15 (B)(16) | |
| Result should be greater than (31.25A) otherwise less the entry for circuit conductor size and ampacity | |

**AC CONDUCTOR AMPACITY CALCULATIONS:
FROM INVERTER TO BACK-UP PANEL:**

| | |
|--|-------|
| No. OF INVERTER | 1 |
| EXPECTED WIRE TEMP (In Celsius) | 34° |
| TEMP. CORRECTION PER NEC TABLE 310.15(B)(2)(a) | 0.96 |
| NO. OF CURRENT CARRYING CONDUCTORS | 3 |
| CONDUIT FILL CORRECTION PER NEC TABLE 310.15(B)(3)(a) | 1 |
| CIRCUIT CONDUCTOR SIZE | 6 AWG |
| CIRCUIT CONDUCTOR AMPACITY PER NEC TABLE 310.15(B)(16) | 75A |

| | |
|---|-------|
| REQUIRED CIRCUIT CONDUCTOR AMPACITY PER NEC 690.8(A&B) | 42.5A |
| 1.25 X INVERTER OUTPUT CURRENT (BACKUP POWER) | |
| DERATED AMPACITY OF CIRCUIT CONDUCTOR | 72A |
| TEMP. CORRECTION PER TABLE 310.15 (B)(2)(a) X CONDUIT FILL CORRECTION PER NEC 310.15(B)(3)(a) X CIRCUIT CONDUCTOR AMPACITY 310.15 (B)(16) | |
| Result should be greater than (42.5A) otherwise less the entry for circuit conductor size and ampacity | |

**AC CONDUCTOR AMPACITY CALCULATIONS:
FROM INVERTER TO MEP:**

| | |
|--|-------|
| No. OF INVERTER | 1 |
| EXPECTED WIRE TEMP (In Celsius) | 34° |
| TEMP. CORRECTION PER NEC TABLE 310.15(B)(2)(a) | 0.96 |
| NO. OF CURRENT CARRYING CONDUCTORS | 3 |
| CONDUIT FILL CORRECTION PER NEC TABLE 310.15(B)(3)(a) | 1 |
| CIRCUIT CONDUCTOR SIZE | 6 AWG |
| CIRCUIT CONDUCTOR AMPACITY PER NEC TABLE 310.15(B)(16) | 75A |

| | |
|---|-----|
| REQUIRED CIRCUIT CONDUCTOR AMPACITY PER NEC 690.8(A&B) | 40A |
| 1.25 X MAX INVERTER OUTPUT CURRENT (LOADS/GRID) | |
| DERATED AMPACITY OF CIRCUIT CONDUCTOR | 72A |
| TEMP. CORRECTION PER TABLE 310.15 (B)(2)(a) X CONDUIT FILL CORRECTION PER NEC 310.15(B)(3)(a) X CIRCUIT CONDUCTOR AMPACITY 310.15 (B)(16) | |
| Result should be greater than (40A) otherwise less the entry for circuit conductor size and ampacity | |



| REVISIONS | | |
|-------------|------|-----|
| DESCRIPTION | DATE | REV |
| | | |
| | | |
| | | |
| | | |
| | | |

Signature with Seal

DATE: 1/13/2022

PROJECT NAME & ADDRESS

**RONIEL SWABY
RESIDENCE
402 NEW CASTLE LN.,
SPRING LAKE, NC 28390**

SHEET NAME
**WIRING
CALCULATIONS**

SHEET SIZE
**ANSI B
11" X 17"**

SHEET NUMBER
PV-5

powered by
Q.ANTUM DUO Z

Q.PEAK DUO BLK ML-G10+

385-405

ENDURING HIGH PERFORMANCE



BREAKING THE 20% EFFICIENCY BARRIER

Q.ANTUM DUO Z Technology with zero gap cell layout boosts module efficiency up to 20.9%.



THE MOST THOROUGH TESTING PROGRAMME IN THE INDUSTRY

Q CELLS is the first solar module manufacturer to pass the most comprehensive quality programme in the industry. The new "Quality Controlled PV" of the independent certification institute TÜV Rheinland.



INNOVATIVE ALL-WEATHER TECHNOLOGY

Optimal yields, whatever the weather with excellent low-light and temperature behavior.



ENDURING HIGH PERFORMANCE

Long-term yield security with Anti LID Technology, Anti PID Technology¹, Hot-Spot Protect and Traceable Quality Tra.Q™.



EXTREME WEATHER RATING

High-tech aluminum alloy frame, certified for high snow (5400 Pa) and wind loads (4000 Pa).



A RELIABLE INVESTMENT

Inclusive 25-year product warranty and 25-year linear performance warranty².

¹ APT test conditions according to IEC / TS 62804-1:2015, method A (-1500V, 96h)
² See data sheet on rear for further information.

THE IDEAL SOLUTION FOR:



Engineered in Germany



MECHANICAL SPECIFICATION

| | |
|--------------|---|
| Format | 74.0 in × 41.1 in × 1.26 in (including frame) (1879 mm × 1045 mm × 32 mm) |
| Weight | 48.5 lbs (22.0 kg) |
| Front Cover | 0.13 in (3.2 mm) thermally pre-stressed glass with anti-reflection technology |
| Back Cover | Composite film |
| Frame | Black anodized aluminum |
| Cell | 6 × 22 monocrystalline Q.ANTUM solar half cells |
| Junction Box | 2.09-3.98 in × 1.26-2.36 in × 0.59-0.71 in (53-101 mm × 32-60 mm × 15-18 mm), IP67, with bypass diodes |
| Cable | 4 mm ² Solar cable; (+) ≥ 49.2 in (1250 mm), (-) ≥ 49.2 in (1250 mm) |
| Connector | Stäubli MC4; IP68 |

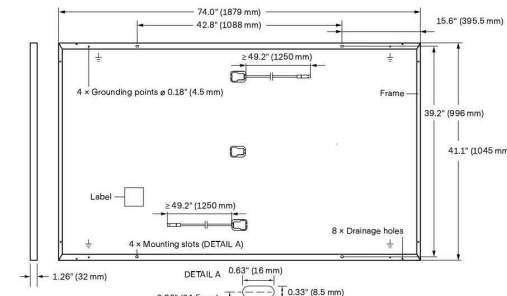

ELECTRICAL CHARACTERISTICS

| POWER CLASS | | 385 | 390 | 395 | 400 | 405 |
|---|----------------------|--------|--------|--------|--------|--------|
| MINIMUM PERFORMANCE AT STANDARD TEST CONDITIONS, STC ¹ (POWER TOLERANCE +5 W / -0 W) | | | | | | |
| Power at MPP ¹ | P _{MPP} [W] | 385 | 390 | 395 | 400 | 405 |
| Short Circuit Current ¹ | I _{SC} [A] | 11.04 | 11.07 | 11.10 | 11.14 | 11.17 |
| Open Circuit Voltage ¹ | V _{OC} [V] | 45.19 | 45.23 | 45.27 | 45.30 | 45.34 |
| Current at MPP | I _{MPP} [A] | 10.59 | 10.65 | 10.71 | 10.77 | 10.83 |
| Voltage at MPP | V _{MPP} [V] | 36.36 | 36.62 | 36.88 | 37.13 | 37.39 |
| Efficiency ¹ | η [%] | ≥ 19.6 | ≥ 19.9 | ≥ 20.1 | ≥ 20.4 | ≥ 20.6 |
| MINIMUM PERFORMANCE AT NORMAL OPERATING CONDITIONS, NMOT ² | | | | | | |
| Power at MPP | P _{MPP} [W] | 288.8 | 292.6 | 296.3 | 300.1 | 303.8 |
| Short Circuit Current | I _{SC} [A] | 8.90 | 8.92 | 8.95 | 8.97 | 9.00 |
| Open Circuit Voltage | V _{OC} [V] | 42.62 | 42.65 | 42.69 | 42.72 | 42.76 |
| Current at MPP | I _{MPP} [A] | 8.35 | 8.41 | 8.46 | 8.51 | 8.57 |
| Voltage at MPP | V _{MPP} [V] | 34.59 | 34.81 | 35.03 | 35.25 | 35.46 |

¹ Measurement tolerances P_{MPP} ± 3%; I_{SC}; V_{OC} ± 5% at STC: 1000 W/m², 25 ± 2°C, AM 1.5 according to IEC 60904-3 • 2800 W/m², NMOT, spectrum AM 1.5

Q CELLS PERFORMANCE WARRANTY

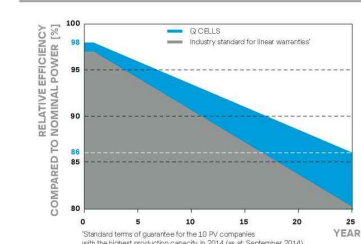

At least 98% of nominal power during first year. Thereafter max. 0.5% degradation per year. At least 93.5% of nominal power up to 10 years. At least 86% of nominal power up to 25 years.

All data within measurement tolerances. Full warranties in accordance with the warranty terms of the Q CELLS sales organisation of your respective country.

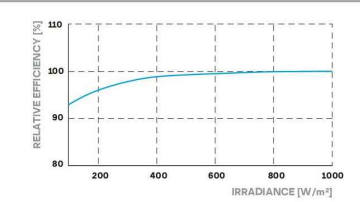

Typical module performance under low irradiance conditions in comparison to STC conditions (25°C, 1000 W/m²)

TEMPERATURE COEFFICIENTS

| | | | | | |
|---|---------|-------|--|-----------|-----------------------|
| Temperature Coefficient of I _{SC} | α [%/K] | +0.04 | Temperature Coefficient of V _{OC} | β [%/K] | -0.27 |
| Temperature Coefficient of P _{MPP} | γ [%/K] | -0.34 | Nominal Module Operating Temperature | NMOT [°F] | 109 ± 5.4 (43 ± 3 °C) |

PROPERTIES FOR SYSTEM DESIGN

| | | | | |
|--|------------------------|------------------------------|---|---|
| Maximum System Voltage V _{sys} | [V] | 1000 (IEC) / 1000 (UL) | PV module classification | Class II |
| Maximum Series Fuse Rating | [A DC] | 20 | Fire Rating based on ANSI / UL 61730 | TYPE 2 |
| Max. Design Load, Push / Pull ³ | [lbs/ft ²] | 75 (3600 Pa) / 55 (2660 Pa) | Permitted Module Temperature on Continuous Duty | -40 °F up to +185 °F (-40 °C up to +85 °C) |
| Max. Test Load, Push / Pull ³ | [lbs/ft ²] | 113 (5400 Pa) / 84 (4000 Pa) | | |

³ See Installation Manual

QUALIFICATIONS AND CERTIFICATES

UL 61730, CE-compliant, Quality Controlled PV - TÜV Rheinland, IEC 61215:2016, IEC 61730:2016, U.S. Patent No. 9,893,215 (solar cells), QCPV Certification ongoing.

PACKAGING INFORMATION

| | | | | | | | |
|----------------------|-------------------|-------------------|-------------------|-------------------|------------|------------|------------|
| Horizontal packaging | 76.4 in / 1940 mm | 43.3 in / 1100 mm | 48.0 in / 1220 mm | 1656 lbs / 751 kg | 24 pallets | 24 pallets | 32 modules |
|----------------------|-------------------|-------------------|-------------------|-------------------|------------|------------|------------|

Note: Installation instructions must be followed. See the installation and operating manual or contact our technical service department for further information on approved installation and use of this product.

Hanwha Q CELLS America Inc.
400 Spectrum Center Drive, Suite 1400, Irvine, CA 92618, USA | TEL +1 949 748 59 96 | EMAIL inquiry@us.q-cells.com | WEB www.q-cells.us

POWER HOME SOLAR, LLC
"POWER YOUR FUTURE"
919 N. MAIN ST.
MOORESVILLE, NC 28115
Phone: 704-800-6591 (OFFICE)
Email: info@powerhome.com
Web: www.powerhome.com

REVISIONS

| DESCRIPTION | DATE | REV |
|-------------|------|-----|
| | | |
| | | |
| | | |
| | | |

Signature with Seal

DATE: 1/13/2022

PROJECT NAME & ADDRESS

**RONIEL SWABY
RESIDENCE**
402 NEW CASTLE LN.,
SPRING LAKE, NC 28390

SHEET NAME
EQUIPMENT SPECIFICATION

SHEET SIZE
**ANSI B
11" X 17"**

SHEET NUMBER
PV-6

Specifications subject to technical changes © Q CELLS Q.PEAK DUO BLK ML-G10+ 385-405 2021-05 Rev01_NA

GENERAC

PWRCELL

7.6kW 1Ø PWRcell Inverter with CTs
Model #: XVT076A03

11.4 kW 3Ø PWRcell Inverter with CTs
Model #: X11402 (Ordering SKU: APKE00013)



Solar + storage is simple with the Generac PWRcell™ Inverter. This bi-directional, REbus™-powered inverter offers a simple, efficient design for integrating smart batteries with solar. Ideal for self-supply, backup power, zero-export and energy cost management, the PWRcell Inverter is the industry's most feature-rich line of inverters, available in single-phase and three-phase models.

FEATURES & BENEFITS

- Single inverter for grid-tied solar with smart battery integration
- Simplified system design: No autotransformer or battery inverter needed
- User-selectable modes for backup power, self-supply, time-of-use, zero-import and export limiting
- Free system monitoring included via PWRview™ Web Portal and Mobile App

| AC OUTPUT/GRID-TIE | MODEL XVT076A03 | MODEL X11402 |
|--|-----------------|-----------------|
| CONT. GRID-TIED AC POWER @ 50°C (122°F): | 7600 W | 11400 W |
| AC OUTPUT VOLTAGE: | 120/240, 1Ø VAC | 120/208, 3Ø VAC |
| AC FREQUENCY: | 60 Hz | |
| MAXIMUM CONTINUOUS OUTPUT CURRENT: | 32 A, RMS | |
| GROUND-FAULT ISOLATION DETECTION: | Included | |
| CHARGE BATTERY FROM AC: | Yes | |
| THD (CURRENT): | < 2% | |
| TYPICAL NIGHTTIME POWER CONSUMPTION ¹ : | < 7 W | |

| AC OUTPUT/ISLAND MODE | MODEL XVT076A03 | MODEL X11402 |
|--|-----------------|-----------------|
| MAX. CONT. AC POWER WHILE IN ISLAND MODE WITHOUT AN EXTERNAL TRANSFER SWITCH ² : | 7600 W | |
| MAX. CONT. AC POWER WHILE IN ISLAND MODE W/ EXTERNAL TRANSFER SWITCH AND SINGLE 6 MODULE BATTERY CABINET ³ : | 9000 W | |
| MAX. CONT. AC POWER WHILE IN ISLAND MODE W/ EXTERNAL TRANSFER SWITCH AND 2 BATTERY CABINETS (8 MODULES MINIMUM) ³ : | 11000 W | 9600 W-11000 W* |
| PEAK MOTOR STARTING CURRENT (2 SEC): | 50 A, RMS | |
| AC BACKUP OUTPUT VOLTAGE: | 120/240, 1Ø VAC | 120/208, 1Ø VAC |
| AC FREQUENCY: | 60 Hz | |
| THD (VOLTAGE): | < 2% | |
| ALLOWABLE SPLIT PHASE IMBALANCE: | Up to 30% | |

| DC INPUT | MODEL XVT076A03 | MODEL X11402 |
|---------------------------------|-----------------|--------------|
| DC INPUT VOLTAGE RANGE: | 360-420 VDC | |
| NOMINAL DC BUS VOLTAGE: | 380 VDC | |
| DC DISTRIBUTION INPUT BREAKERS: | 4 x 2P30 A | |
| MAX INPUT CURRENT PER DC INPUT: | 30 A | |
| REVERSE-POLARITY PROTECTION: | Yes | |
| TRANSFORMERLESS, UNGROUNDED: | Yes | |
| DC BUS EXPORT FUSES (+/-): | 40 A | |
| 2-POLE DISCONNECTION: | Yes | |

| EFFICIENCY | MODEL XVT076A03 | MODEL X11402 |
|--------------------------|-----------------|--------------|
| PEAK EFFICIENCY: | 97.3% | 97.7% |
| CEC WEIGHTED EFFICIENCY: | 96.5% | 97.5% |

¹Nighttime power consumption depends on the system mode
²In Island Mode, continuous power output is restricted to 7.6kW unless backup power is routed through an external transfer switch in a whole home backup application.
³Peak performance, values provided for 40°C (104°F).
 *In Island mode X11402 protected loads only supply 2 phases 120 VAC L-N, 208 L-L which results in lower power than in a grid tied 3 phase state. The low value of the range is for full L-L loading while high value of the range is full L-N loading

Specifications

FEATURES AND MODES

| | |
|---|-----|
| ISLAND MODE ¹ : | Yes |
| GRID SELL: | Yes |
| SELF CONSUMPTION: | Yes |
| PRIORITIZED CHARGING FROM RENEWABLES: | Yes |
| GRID SUPPORT - ZERO EXPORT: | Yes |
| ESS PCS OPERATION MODES (IMPORT ONLY, EXPORT ONLY): | Yes |

ADDITIONAL FEATURES

| | |
|--|------------------------------------|
| SUPPORTED COMMUNICATION INTERFACES: | REbus™, CANbus, Ethernet |
| SYSTEM MONITORING: | PWRview™ Web Portal and Mobile App |
| BACKUP LOADS DISCONNECT ² : | Yes, 50 A Circuit Breaker |
| INVERTER BYPASS SWITCH: | Automatic |
| WARRANTY: | 10 Years |

STANDARDS COMPLIANCE

| | |
|----------------------------|--|
| SAFETY: | UL 1741 SA, CSA 22.2 #107.1, UL 1998 |
| GRID CONNECTION STANDARDS: | IEEE 1547, Rule 21, Rule 14H (HECO V1.1), CSIP, UL 1741 PCS CRD (Import Only, Export Only) |
| EMISSIONS: | FCC Part 15 Class B |

DIMENSIONS AND INSTALLATION SPECIFICATIONS

| | | |
|--|--|--|
| ENCLOSURE KNOCKOUTS - QTY, SIZE - IN (MM): | 6 x Combo 3/4" x 1" (19 x 25.4) 7 x Combo 1/2" x 3/4" (12.7 x 19) | 1 x 0.575" exclusively for optional LTE antenna mounting |
| DIMENSIONS L x W x H - IN (MM): | 24.5" x 19.25" x 8" (622.3 x 488.9 x 203.2) | |
| WEIGHT - LB (KG): | 62.7 (28.4) | |
| COOLING: | Forced convection | |
| AUDIBLE NOISE: | < 40 dBA | |
| OPERATING TEMPERATURE: | -4 to 122 °F (-20 to 50 °C) ⁵ | |
| ENCLOSURE TYPE: | Type 3R | |

INSTALLATION GUIDELINES

| | |
|---|--|
| BATTERY TYPES SUPPORTED: | PWRcell™ Battery |
| MODULE SUBSTRING SIZE PER PV LINK OPTIMIZER: | Varies, refer to PV Link Installation Manual |
| MAXIMUM RECOMMENDED DC POWER FROM PV ⁶ : | 10 kW (1Ø), 15 kW (3Ø) |

⁴3Ø inverters offer backup for [single phase] 208 V loads.
⁵Includes ambient temperature rising from inverter operation. Reduced power at extreme temperatures.
⁶Values provided for PV-only or small storage systems. Additional PV power is permissible if sufficient battery storage capacity is installed.

Generac Power Systems, Inc.
 S45 W29290 Hwy. 59, Waukesha, WI 53189
www.Generac.com | 888-GENERAC (436-3722)
 A0000909057 REV D

©2021 Generac Power Systems. All rights reserved.
 Specifications are subject to change without notice.

GENERAC



POWER HOME SOLAR, LLC
 "POWER YOUR FUTURE"
 919 N. MAIN ST.
 MOORESVILLE, NC 28115
 Phone: 704-800-6591 (OFFICE)
 Email: info@powerhome.com
 Web: www.powerhome.com

REVISIONS

| DESCRIPTION | DATE | REV |
|-------------|------|-----|
| | | |
| | | |
| | | |
| | | |
| | | |

Signature with Seal

DATE: 1/13/2022

PROJECT NAME & ADDRESS

RONIEL SWABY
 RESIDENCE
 402 NEW CASTLE LN.,
 SPRING LAKE, NC 28390

SHEET NAME
**EQUIPMENT
 SPECIFICATION**

SHEET SIZE

**ANSI B
 11" X 17"**

SHEET NUMBER

PV-7

GENERAC

SnapRS™

Inline Disconnect Switch
Model #: RS801 (Ordering SKU: APKE00011)



Generac SnapRS are a simple way to satisfy rapid shutdown compliance for solar + storage systems. Generac SnapRS are 2017/2020 NEC 690.12 compliant, don't require any extra hardware to mount, and need no pairing or fussy digital communications.

FEATURES & BENEFITS

- Fast, easy, and simple to install
- One SnapRS device per PV module
- Achieves PVRSS Compliance
- Low cost, high efficiency solution

SYSTEM DESIGN

Snap a Generac SnapRS disconnect device (RS) to the negative lead (-) of each module in the solar array for simple module-level rapid shutdown compliance. SnapRS devices isolate array voltage when a rapid shutdown is initiated at a PWRcell™ Inverter. When rapid shutdown is initiated, SnapRS units isolate each PV module in the array, reducing array voltage to <80V in seconds.

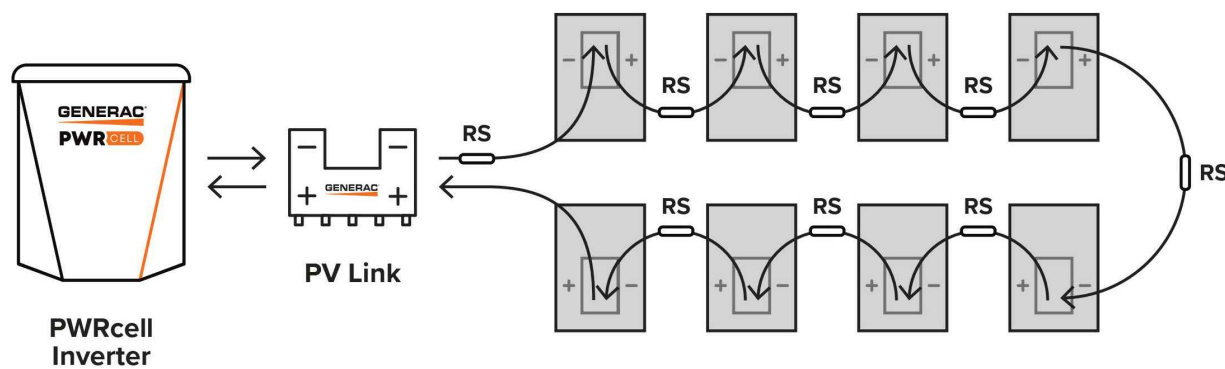

Diagram is applicable for most 60 cell PV modules. Modules with higher cell count may require a different arrangement. Contact Generac for more details.

Specifications

SnapRS™ (APKE00011)

| | |
|---|------------------------------------|
| PV MODULE MAX VOC: | 75 V |
| EFFICIENCY: | 99.8%* |
| MAX INPUT CURRENT: | 13 A |
| MAX TOTAL QTY IN SUBSTRING: | 10 |
| SHUTDOWN TIME: | <10 Seconds |
| ENCLOSURE RATING: | NEMA 6P |
| OPERATING TEMPERATURE - FAHRENHEIT (CELSIUS): | -40 to 158 °F (-40 to 70 °C) |
| CERTIFICATIONS: | UL1741 |
| PROTECTIONS: | PVRSE |
| WEIGHT - LB (KG): | 0.17 (0.08) |
| DIMENSIONS, L x W x H - IN (MM): | 7" x 1" x 1" (177.8 x 25.4 x 25.4) |
| WARRANTY: | 25 Years |

*When used with a 50V panel

Connect one SnapRS device to the negative lead of each PV module in the PV Link controlled array for complete PV Rapid shutdown performance



Generac Power Systems, Inc.
S45 W29290 Hwy. 59, Waukesha, WI 53189
www.Generac.com | 888-GENERAC (436-3722)
A0000528183 REV D

©2020 Generac Power Systems. All rights reserved.
Specifications are subject to change without notice.

GENERAC



POWER HOME SOLAR, LLC
"POWER YOUR FUTURE"
919 N. MAIN ST.
MOORESVILLE, NC 28115
Phone: 704-800-6591 (OFFICE)
Email: info@powerhome.com
Web: www.powerhome.com

REVISIONS

| DESCRIPTION | DATE | REV |
|-------------|------|-----|
| | | |
| | | |
| | | |
| | | |
| | | |
| | | |
| | | |

Signature with Seal

DATE: 1/13/2022

PROJECT NAME & ADDRESS

RONCIL SWABY
RESIDENCE
402 NEW CASTLE LN.,
SPRING LAKE, NC 28390

SHEET NAME
EQUIPMENT
SPECIFICATION

SHEET SIZE

ANSI B
11" X 17"

SHEET NUMBER

PV-8

GENERAC

PWRCELL

3.0kWh DCB BATTERY MODULE

3.0kWh PWRcell DCB Battery Module
Model #: BJ-DCB05ZKBG (Ordering SKU: G0080040)



Build a better backup system with the Generac DCB Battery Module for PWRcell™. Add capacity and backup power with as few as three or as many as six modules. Upgrade a PWRcell Battery post-installation with the addition of more DCB modules for more power and capacity.

FEATURES & BENEFITS

- Suitable for indoor and outdoor cabinets
- Modular: Stack the right number of battery modules for the application
- Upgradeable: Add more modules later when consumer needs change
- Easy to install: At just 55lbs, installers won't need special equipment to move and install these batteries

SPECIFICATIONS

| | |
|--|---|
| NOMINAL VOLTAGE: | 46.8 VDC |
| USABLE CAPACITY @ TYPICAL VOLTAGE: | 3.00 kWh |
| MAXIMUM AMBIENT OPERATING TEMPERATURE: | 14 to 122 °F (-10 to 50 °C) |
| OPTIMAL AMBIENT OPERATING TEMPERATURE: | 41 to 104 °F (5 to 40 °C) |
| STORAGE TEMPERATURE RANGE: | -4 to 68 °F (-20 to 20 °C) |
| SCALABILITY: | 3-6 pcs in series |
| DIMENSIONS, L x W x H - IN (MM): | 17.3" x 17.7" x 3.3" (440 x 450 x 84) |
| WEIGHT - LB (KG): | 55 (25) |
| BATTERY CHEMISTRY: | Lithium Nickel Manganese Cobalt (NMC) |
| WARRANTY: | 10 years or 7.56MWh Throughput (per module) |
| COMPLIANCE: | UL 1973 |

Note: Charge/discharge rate may be reduced at temperature extremes

Generac Power Systems, Inc.
S45 W29290 Hwy. 59, Waukesha, WI 53189

www.Generac.com | 888-GENERAC (436-3722)

A0000953959 REV E

©2021 Generac Power Systems. All rights reserved.
Specifications are subject to change without notice.

GENERAC

Overview of technical specifications

PWRcell™ BATTERY CONFIGURATIONS

| BATTERY MODULE SERIES: | 3.0 kWh DCB / 3.0 kWh EX | | | |
|---|--|-----------|-----------|-----------|
| BATTERY MODULES: | 3 | 4 | 5 | 6 |
| USABLE ENERGY: | 9 kWh | 12 kWh | 15 kWh | 18 kWh |
| NOMINAL CONT. AC POWER ¹ : | 3.4 kW | 4.5 kW | 5.6 kW | 6.7 kW |
| MAX. CONT. AC POWER ² : | 4.5 kW | 6 kW | 7.5 kW | 9 kW |
| MAX. CONT. DC CURRENT (CHARGE/DISCHARGE) - A: | 13.8 | 18.4 | 23.0 | 27.5 |
| PEAK MOTOR STARTING CURRENT (2 SEC) - A, RMS: | 25 | 33 | 42 | 50 |
| REbus™ VOLTAGE - INPUT/OUTPUT: | 360-420 VDC | | | |
| NOMINAL VOLTAGE: | 380 VDC | | | |
| DC-DC ROUND-TRIP EFFICIENCY: | 96.5% | | | |
| MAXIMUM AMBIENT OPERATING TEMPERATURE: | 14 to 122 °F (-10 to 50 °C) | | | |
| RECOMMENDED AMBIENT OPERATING TEMPERATURE: | 41 to 104 °F (5 to 40 °C) | | | |
| MAXIMUM INSTALLATION ALTITUDE - FT (M): | 9834 (3000) | | | |
| DIMENSIONS, L x W x H - IN (MM): | 22" X 10" X 68" (559 X 254 X 1727) | | | |
| WEIGHT, ENCLOSURE - LB (KG): | 111 (50) | | | |
| WEIGHT, INSTALLED W/ DCB MODULES- LB (KG): | 276 (125) | 331 (150) | 386 (175) | 441 (200) |
| WEIGHT, INSTALLED W/ EX MODULES - LB (KG): | 282 (128) | 340 (154) | 397 (180) | 454 (206) |
| ENCLOSURE TYPE: | Type 1 | | | |
| WARRANTY - LI-ION MODULES: | 10 Years, (7.56MWh) | | | |
| WARRANTY - ELECTRONICS AND ENCLOSURE: | 10 Years | | | |
| COMMUNICATION PROTOCOL: | REbus™ DC Nanogrid™ | | | |
| SEISMIC RATING: | IEEE 693-2018 (HIGH) | | | |
| COMPLIANCE: | UL 9540, UL 1973, UL 1642, CSA 22.2 #107.1 | | | |



POWER HOME SOLAR, LLC
"POWER YOUR FUTURE"
919 N. MAIN ST.
MOORESVILLE, NC 28115
Phone: 704-800-6591 (OFFICE)
Email: info@powerhome.com
Web: www.powerhome.com

REVISIONS

| DESCRIPTION | DATE | REV |
|-------------|------|-----|
| | | |
| | | |
| | | |
| | | |
| | | |
| | | |

Signature with Seal

DATE: 1/13/2022

PROJECT NAME & ADDRESS

**RONAIL SWABY
RESIDENCE**
402 NEW CASTLE LN.,
SPRING LAKE, NC 28390

SHEET NAME
**EQUIPMENT
SPECIFICATION**

SHEET SIZE

**ANSI B
11" X 17"**

SHEET NUMBER

PV-9

GENERAC[®]

PWRCELL

OUTDOOR RATED BATTERY

PWRcell Outdoor Rated Battery Cabinet (Ordering SKU: APKE00028)
 3.0kWh PWRcell DCB Battery Module
 Model #: BJ-DCB05ZKBG (Ordering SKU: G0080040)
 3.0kWh PWRcell EX Battery Module
 Model #: G0080001

The PWRcell™ Outdoor Rated (OR) Battery Cabinet is a Type 3R smart battery enclosure that allows for a range of configurations to suit any need, small or large, indoor or outdoor. No other smart battery offers the power and flexibility of PWRcell.

PWRcell BATTERY CABINET DESIGN

The PWRcell Battery Cabinet allows system owners the flexibility to scale from an economical 9kWh to a massive 18kWh by installing additional battery modules to the PWRcell Battery Cabinet. An existing PWRcell Battery Cabinet can be upgraded with additional modules. Use the graphic below and the chart on the back of this sheet to understand what components you need for your chosen PWRcell configuration.

BATTERY CONFIGURATION GUIDE

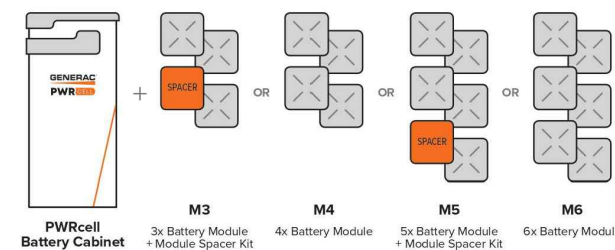

FEATURES & BENEFITS

- Connect 2 PWRcell Battery Cabinets to a single PWRcell Inverter for up to 36kWh of storage
- Best-in-class battery backup power
- Plug-and-play with PWRcell Inverter and PV Link™
- Time-of-use (TOU) and zero-export ready
- Residential and commercial application ready.
- 3R-rated cabinet allows for outdoor or indoor installation
- Additional mounting hardware for outdoor installations comes standard to provide additional ground clearance and support

BATTERY CABINET ASSEMBLY

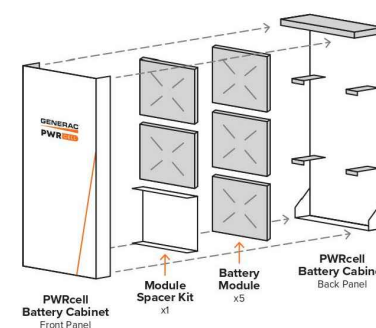

POWER HOME SOLAR, LLC
 "POWER YOUR FUTURE"
 919 N. MAIN ST.
 MOORESVILLE, NC 28115
 Phone: 704-800-6591 (OFFICE)
 Email: info@powerhome.com
 Web: www.powerhome.com

REVISIONS

| DESCRIPTION | DATE | REV |
|-------------|------|-----|
| | | |
| | | |
| | | |
| | | |
| | | |
| | | |

Signature with Seal

DATE: 1/13/2022

PROJECT NAME & ADDRESS

**RONAIL SWABY
 RESIDENCE**
 402 NEW CASTLE LN.,
 SPRING LAKE, NC 28390

SHEET NAME

**EQUIPMENT
 SPECIFICATION**

SHEET SIZE

**ANSI B
 11" X 17"**

SHEET NUMBER

PV-9A

GENERAC

PV Link™

2500W MPPT Substring Optimizer
Model #: S2502 (Ordering SKU: APKE00010)

PV Link is the simple solar optimizer for quick installation and long-lasting performance. Connect PV modules to each PV Link to overcome shading and challenging roof lines.

FEATURES & BENEFITS

- Fast, simple installation
- Lower failure risk than module-level optimizers
- 2017/2020 NEC rapid shutdown compliant with SnapRS™
- Quick connections with MC4 connectors
- Exports up to 2500W
- Compatible with PWRcell™ Inverters
- Cost-effective solution for high-performance PV
- Ground-fault protection

SINGLE-STRING PV ARRAY WITH SnapRS DEVICES

Where PV module-level rapid shutdown is required (NEC 690.12), a SnapRS device (RS) is installed to negative (-) lead of each PV module.

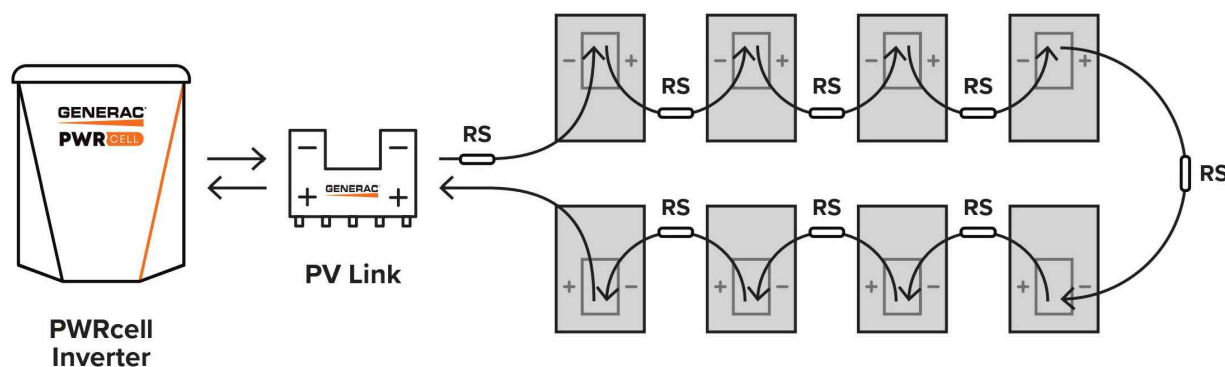

Diagram is applicable for most 60 cell PV modules. Modules with higher cell count may require a different arrangement. Contact Generac for more details.



Specifications

| PV Link™ (APKE00010) | |
|---|--|
| RATED POWER*: | 2500W |
| PEAK EFFICIENCY: | 99% |
| MPPT VOLTAGE RANGE: | 60-360 VMP |
| MAX INPUT VOLTAGE: | 420 VOC; max when cold |
| MAX OUTPUT: | 420 VOC |
| NOMINAL OUTPUT (REbus™): | 380 VDC |
| MAX OUTPUT CURRENT (CONTINUOUS): | 8 A |
| MAX OUTPUT CURRENT (FAULT): | 10 A |
| MAX INPUT CURRENT (CONTINUOUS): | 13 A @ 50°C, 10 A @ 70°C |
| MAX INPUT SHORT CIRCUIT CURRENT (ISC): | 18 A |
| STANDBY POWER: | < 1 W |
| PROTECTIONS: | Ground-fault, Arc-fault (Arc-fault Type 1 AFCI, Integrated), PVRSE |
| MAX OPERATING TEMP: FAHRENHEIT (CELSIUS): | 158 °F (70 °C) |
| SYSTEM MONITORING: | PWRview™ Web Portal and Mobile App |
| ENCLOSURE: | Type 4X |
| WEIGHT - LB (KG): | 7.3 lb (3.3 kg) |
| DIMENSIONS, L x W x H - IN (MM): | 15.4" x 2" x 9.6" (391.2 x 50.8 x 243.8) |
| COMPLIANCE: | UL 1741, CSA 22.2 |
| WARRANTY: | 25 Years |

*PV Link can tolerate higher than rated power at its input if Max Input Voltage and Short Circuit Current specifications are not exceeded



Generac Power Systems, Inc.
S45 W29290 Hwy. 59, Waukesha, WI 53189
www.Generac.com | 888-GENERAC (436-3722)
A0000528162 REV D

©2020 Generac Power Systems. All rights reserved.
Specifications are subject to change without notice.

GENERAC



POWER HOME SOLAR, LLC
"POWER YOUR FUTURE"
919 N. MAIN ST.
MOORESVILLE, NC 28115
Phone: 704-800-6591 (OFFICE)
Email: info@powerhome.com
Web: www.powerhome.com

REVISIONS

| DESCRIPTION | DATE | REV |
|-------------|------|-----|
| | | |
| | | |
| | | |
| | | |
| | | |
| | | |

Signature with Seal

DATE: 1/13/2022

PROJECT NAME & ADDRESS

RONIEL SWABY
RESIDENCE
402 NEW CASTLE LN.,
SPRING LAKE, NC 28390

SHEET NAME
EQUIPMENT
SPECIFICATION

SHEET SIZE

ANSI B
11" X 17"

SHEET NUMBER

PV-10



QRail™ — Fully Integrated Mounting and Racking System

The QRail Series is a strong and versatile solar array mounting system that provides unrivaled benefits to solar designers and installers. Combined with Quick Mount PV's industry-leading waterproof mounts, QRail offers a complete racking solution for mounting solar modules on any roof.



Easily design array configurations with the QDesign software application. Generate complete engineering reports and calculate a precise bill of materials for all the mounting, racking and accessories needed for a complete solar array.

Comprehensive, One-Source Solution

QRail, together with Quick Mount PV's waterproof mounting products, provides the benefit of a single-sourced, seamlessly integrated rooftop installation that works with all roof types — composition/asphalt shingles, flat or curved tile, metal shingle, shake, slate and low slope roofs. The QRail system also works with any roof attachment system for maximum flexibility.

Superior Strength and Versatility

QRail is engineered for optimal structural performance. The system is certified to UL 2703, fully code compliant and backed by a 25-year warranty. QRail is available in Light, Standard and Heavy versions to match all geographic locations. QRail is compatible with virtually all modules and works on a wide range of pitched roof surfaces. Modules can be mounted in portrait or landscape orientation in standard or shared-rail configurations.



Fast, Simple Installation: It Just Clicks

QClick Technology™

The universal mid and end clamps use QClick technology to simply "click" into the rail channel and remain upright, ready to accept the module. The pre-assembled clamps fit virtually all module frames and require no extra hardware, eliminating pre-loading and reducing installation time.

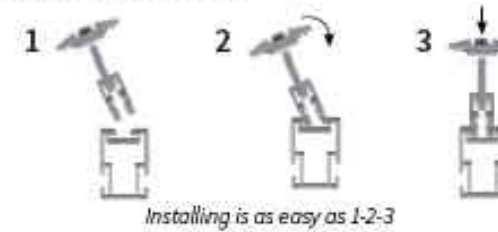

UNIVERSAL END CLAMP
2 clamps for modules from
30-45mm or 38-50mm thick



UNIVERSAL BONDED MID CLAMP
2 clamps for modules from
30-45mm or 38-50mm thick

QSplice™ Technology

QRail's innovative internal QSplice installs in seconds, requiring no tools or screws. Simply insert QSplice into the rail and slide the other rail on to create a fully structural, bonded splice. An external splice is also available.



Fully Integrated Electrical Bonding

The QRail system provides an integrated electrical bonding path, ensuring that all exposed metal parts and the solar module frames are electrically connected. All electrical bonds are created when the components are installed and tightened down.



POWER HOME SOLAR, LLC
"POWER YOUR FUTURE"
919 N. MAIN ST.
MOORESVILLE, NC 28115
Phone: 704-800-6591 (OFFICE)
Email: info@powerhome.com
Web: www.powerhome.com

REVISIONS

| DESCRIPTION | DATE | REV |
|-------------|------|-----|
| | | |
| | | |
| | | |
| | | |
| | | |

Signature with Seal

DATE: 1/13/2022

PROJECT NAME & ADDRESS

RONIEL SWABY
RESIDENCE
402 NEW CASTLE LN.,
SPRING LAKE, NC 28390

SHEET NAME

EQUIPMENT
SPECIFICATION

SHEET SIZE

ANSI B
11" X 17"

SHEET NUMBER

PV-11

QRail™ Configurations



| Item Code | Part Number | Description | Finish |
|-----------------|-------------|-----------------------------------|--------|
| QMR-RL14 A 60 | 800 | QRail Light, 14 ft., 60 Pack | Mill |
| QMR-RL17.3 A 60 | 801 | QRail Light, 17.3 ft., 60 Pack | Mill |
| QMR-RL14 B 60 | 805 | QRail Light, 14 ft., 60 Pack | Black |
| QMR-RL17.3 B 60 | 806 | QRail Light, 17.3 ft., 60 Pack | Black |
| QMR-RS14 A 60 | 810 | QRail Standard, 14 ft., 60 Pack | Mill |
| QMR-RS17.3 A 60 | 811 | QRail Standard, 17.3 ft., 60 Pack | Mill |
| QMR-RS14 B 60 | 815 | QRail Standard, 14 ft., 60 Pack | Black |
| QMR-RS17.3 B 60 | 816 | QRail Standard, 17.3 ft., 60 Pack | Black |
| QMR-RH14 A 60 | 820 | QRail Heavy, 14 ft., 60 Pack | Mill |
| QMR-RH17.3 A 60 | 821 | QRail Heavy, 17.3 ft., 60 Pack | Mill |
| QMR-RH14 B 60 | 825 | QRail Heavy, 14 ft., 60 Pack | Black |
| QMR-RH17.3 B 60 | 826 | QRail Heavy, 17.3 ft., 60 Pack | Black |

QSplice™ Internal Structural Splice



| Item Code | Part Number | Description | Finish |
|--------------|-------------|-------------------------------------|--------|
| QMR-ISL A 15 | 830 | QSplice Internal, Light, 15 Pack | Mill |
| QMR-ISS A 15 | 831 | QSplice Internal, Standard, 15 Pack | Mill |
| QMR-ISH A 15 | 832 | QSplice Internal, Heavy, 15 Pack | Mill |

QSplice™ External Structural Splice

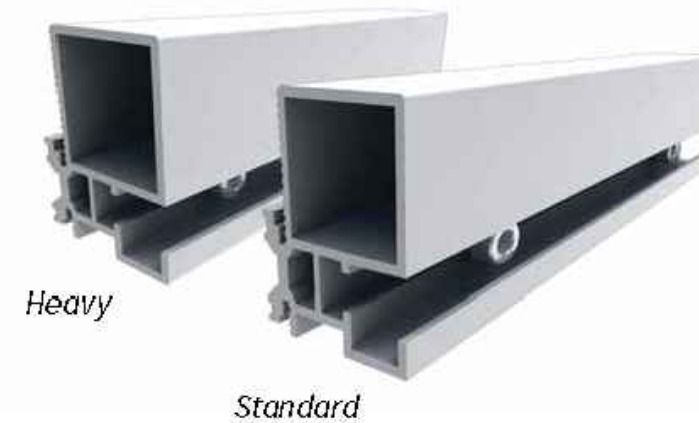

| Item Code | Part Number | Description | Finish |
|--------------|-------------|-------------------------------------|--------|
| QMR-ESS A 15 | 834 | QSplice External, Standard, 15 Pack | Mill |
| QMR-ESH A 15 | 835 | QSplice External, Heavy, 15 Pack | Mill |



| REVISIONS | | |
|-------------|------|-----|
| DESCRIPTION | DATE | REV |
| | | |
| | | |
| | | |
| | | |
| | | |

Signature with Seal

DATE: 1/13/2022

PROJECT NAME & ADDRESS

RONCIL SWABY
 RESIDENCE
 402 NEW CASTLE LN.,
 SPRING LAKE, NC 28390

SHEET NAME
 EQUIPMENT
 SPECIFICATION

SHEET SIZE
 ANSI B
 11" X 17"

SHEET NUMBER
 PV-11A

Universal End Clamp with QClick™ Technology



Black

Mill

| Item Code | Part Number | Description | Finish |
|--------------------|-------------|---|--------|
| QMR-UEC3045 A 20 | 860 | Universal End Clamp, 30-45mm, 20 Pack | Mill |
| QMR-UEC3850 A 20 | 861 | Universal End Clamp, 38-50mm, 20 Pack | Mill |
| QMR-UEC3045 B 20 | 865 | Universal End Clamp, 30-45mm, 20 Pack | Black |
| QMR-UEC3850 B 20 | 866 | Universal End Clamp, 38-50mm, 20 Pack | Black |
| QMR-UEC3045BP A 20 | 862 | Universal End Clamp, 30-45mm, w/ Bonding, 20 Pack | Mill |
| QMR-UEC3850BP A 20 | 863 | Universal End Clamp, 38-50mm, w/ Bonding, 20 Pack | Mill |
| QMR-UEC3045BP B 20 | 867 | Universal End Clamp, 30-45mm, w/ Bonding, 20 Pack | Black |
| QMR-UEC3850BP B 20 | 868 | Universal End Clamp, 38-50mm, w/ Bonding, 20 Pack | Black |

Mid Clamp with QClick™ Technology



Black

Mill

| Item Code | Part Number | Description | Finish |
|------------------------|-------------|---|--------|
| QMR-UMC3045BP 1.2 A 20 | 872 | Universal Mid Clamp, 30-45mm, w/ Bonding, 20 Pack | Mill |
| QMR-UMC3850BP 1.2 A 20 | 873 | Universal Mid Clamp, 38-50mm, w/ Bonding, 20 Pack | Mill |
| QMR-UMC3045BP 1.2 B 20 | 877 | Universal Mid Clamp, 30-45mm, w/ Bonding, 20 Pack | Black |
| QMR-UMC3850BP 1.2 B 20 | 878 | Universal Mid Clamp, 38-50mm, w/ Bonding, 20 Pack | Black |

Single-Slot L-Foot



| Item Code | Part Number | Description | Finish |
|-------------|-------------|-----------------------------|--------|
| QMC-LF A 12 | 692 | Single-slot L-foot, 12 Pack | Mill |
| QMC-LF B 12 | 693 | Single-slot L-foot, 12 Pack | Black |

End Caps



Heavy

Standard

Light

| Item Code | Part Number | Description | Finish |
|--------------|-------------|---------------------------|--------|
| QMR-CPL B 50 | 885 | End Cap Light, 50 Pack | Black |
| QMR-CPS B 50 | 886 | End Cap Standard, 50 Pack | Black |
| QMR-CPH B 50 | 887 | End Cap Heavy, 50 Pack | Black |



POWER HOME SOLAR, LLC
 "POWER YOUR FUTURE"
 919 N. MAIN ST.
 MOORESVILLE, NC 28115
 Phone: 704-800-6591 (OFFICE)
 Email: info@powerhome.com
 Web: www.powerhome.com

REVISIONS

| DESCRIPTION | DATE | REV |
|-------------|------|-----|
| | | |
| | | |
| | | |
| | | |
| | | |
| | | |

Signature with Seal

DATE: 1/13/2022

PROJECT NAME & ADDRESS

**RONIEL SWABY
 RESIDENCE**
 402 NEW CASTLE LN.,
 SPRING LAKE, NC 28390

SHEET NAME

**EQUIPMENT
 SPECIFICATION**

SHEET SIZE

**ANSI B
 11" X 17"**

SHEET NUMBER

PV-11B

T-Bolt



| Item Code | Part Number | Description | Finish |
|--------------|-------------|-------------------------|-----------------|
| QMR-TB A 300 | 880 | T-Bolt w/ Nut, 300 Pack | stainless steel |

Grounding Lug



| Item Code | Part Number | Description | Finish |
|-------------|-------------|-----------------------------|--------|
| QMR-GL A 50 | 890 | WEEB Lug w/ T-Bolt, 50 Pack | n/a |

Wire Clip



Works with both PV and Trunk Cabling

| Item Code | Part Number | Description | Finish |
|-------------|-------------|--------------------------|-----------------|
| QMR-WCA 300 | 892 | Trunk/PV Cable, 300 Pack | stainless steel |

WEEB BMC



| Item Code | Part Number | Description | Finish |
|-------------|-------------|-------------------|-----------------|
| QMR-ECWA 50 | 891 | WEEB BMC, 50 Pack | stainless steel |



POWER HOME SOLAR, LLC
 "POWER YOUR FUTURE"
 919 N. MAIN ST.
 MOORESVILLE, NC 28115
 Phone: 704-800-6591 (OFFICE)
 Email: info@powerhome.com
 Web: www.powerhome.com

REVISIONS

| DESCRIPTION | DATE | REV |
|-------------|------|-----|
| | | |
| | | |
| | | |
| | | |
| | | |
| | | |

Signature with Seal

DATE: 1/13/2022

PROJECT NAME & ADDRESS

**RONEIL SWABY
 RESIDENCE**
 402 NEW CASTLE LN.,
 SPRING LAKE, NC 28390

SHEET NAME

**EQUIPMENT
 SPECIFICATION**

SHEET SIZE

**ANSI B
 11" X 17"**

SHEET NUMBER

PV-11C

L-Mount | QMLM / QMLM-ST

Elevated Water Seal Technology®

| ITEM NO. | DESCRIPTION | QTY. |
|----------|---|------|
| 1 | FLASHING, ROUNDED CORNERS, 9" X 12" X .040", .438" HOLE, 5052, MILL | 1 |
| 2 | L-FOOT, 2" X 3.30" FOR .438" O.D. FASTENER, 2-1/16" SLOT, 6061-T6/6005A-T61, MILL | 1 |
| 3 | WASHER, SEALING, 5/16" ID X 3/4" OD, EPDM BONDED SS | 1 |
| 4 | LAG SCREW, HEX HEAD, 5/16" x 4", 18-8 SS | 1 |
| *5 | STRUCTURAL SCREW, QMPV, T-30 HEX WASHER HEAD, 5/16" X 4-1/2", 18-8SS | 1 |

Quick Mount PV®
QMLM & QMLM-ST: L-MOUNT, 2-1/16" SLOT

UNLESS OTHERWISE SPECIFIED:
 DIMENSIONS ARE IN INCHES
 TOLERANCES:
 FRACTIONAL ± 1/32
 TWO PLACE DECIMAL ± .015
 THREE PLACE DECIMAL ± .004

SCALE: 1:4 WEIGHT: 0.7566 SHEET 1 OF 1

DO NOT SCALE DRAWING

L-Mount Installation Instructions

Installation Tools Required: tape measure, roofing bar, chalk line, stud finder, caulking gun, sealant compatible with roofing materials, drill with 7/32" or 1/8" bit, drill or impact gun with 1/2" socket.

WARNING: Quick Mount PV products are NOT designed for and should NOT be used to anchor fall protection equipment.

- Locate, choose, and mark centers of rafters to be mounted. Select the courses of shingles where mounts will be placed.
- Carefully lift composition roof shingle with roofing bar, just above placement of mount. Remove nails as required and backfill holes with approved sealant. See "Proper Flashing Placement" on next page.
- Insert flashing between 1st and 2nd course. Slide up so top edge of flashing is at least 3/4" higher than the butt-edge of the 3rd course and lower flashing edge is above the butt-edge of 1st course. Mark center for drilling.
- If attaching with lag bolt use a 7/32" bit (Lag). Use a 1/8" bit (ST) for attaching with the structural screw. Drill pilot hole into roof and rafter, taking care to drill square to the roof. Do not use mount as a drill guide. Drill a 2" deep hole into rafter.
- Clean off any sawdust, and fill hole with sealant compatible with roofing materials.
- Place L-foot onto elevated flange and rotate L-foot to desired orientation.
- Prepare lag bolt or structural screw with sealing washer. Using a 1/2-inch socket on an impact gun, drive prepared lag bolt through L-foot until L-foot can no longer easily rotate. **DO NOT over-torque.** NOTE: Structural screw can be driven with T-30 hex head bit.
- You are now ready for the rack of your choice. Follow all the directions of the rack manufacturer as well as the module manufacturer. NOTE: Make sure top of L-Foot makes solid contact with racking.

Available in Mill and Black Finishes

Structural Screw Available on QMLM-ST Versions Only

All roofing manufacturers' written instructions must also be followed by anyone modifying a roof system. Consult the roof manufacturer's specs and instructions prior to working on the roof.

Prepare lag bolt or structural screw with sealing washer. Using a 1/2-inch socket on an impact gun, drive prepared lag bolt through L-foot until L-foot can no longer easily rotate. **DO NOT over-torque.** NOTE: Structural screw can be driven with T-30 hex head bit.

You are now ready for the rack of your choice. Follow all the directions of the rack manufacturer as well as the module manufacturer. NOTE: Make sure top of L-Foot makes solid contact with racking.

BI 7.2.3-44

Apr-2019 Rev 6

Quick Mount PV®
RESPECT THE ROOF

POWERHOME
 POWER HOME SOLAR, LLC
 "POWER YOUR FUTURE"
 919 N. MAIN ST.
 MOORESVILLE, NC 28115
 Phone: 704-800-6591 (OFFICE)
 Email: info@powerhome.com
 Web: www.powerhome.com

| REVISIONS | | |
|-------------|------|-----|
| DESCRIPTION | DATE | REV |
| | | |
| | | |
| | | |
| | | |
| | | |

Signature with Seal

DATE: 1/13/2022

PROJECT NAME & ADDRESS

**RONIEL SWABY
 RESIDENCE**
 402 NEW CASTLE LN.,
 SPRING LAKE, NC 28390

SHEET NAME
EQUIPMENT SPECIFICATION

SHEET SIZE
**ANSI B
11" X 17"**

SHEET NUMBER
PV-12