

Trench: 100ft. (approx.)

Utility Meter

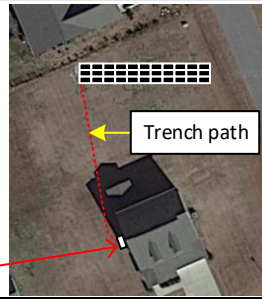

Module Dimension

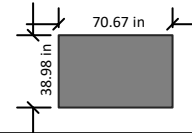

Arrays	Tilt	Azimuth
A	30°	180°

8MSOLAR
ADVANCING ENERGY INDEPENDENCE
1600 Heritage Commerce Ct Ste 104,
Wake Forest NC 27587
O: 919.948.6474
E: info@8msolar.com

Morgan M Ledford
22 Squire Street
Fuquay-Varina, NC 27526

SYSTEM DETAILS

NUMBER OF PANELS : 33
PANELS MODEL : SILFAB ELITE SIL-380 BK
DC SIZE : 12.54 kW
AC SIZE : 11.4 kVA

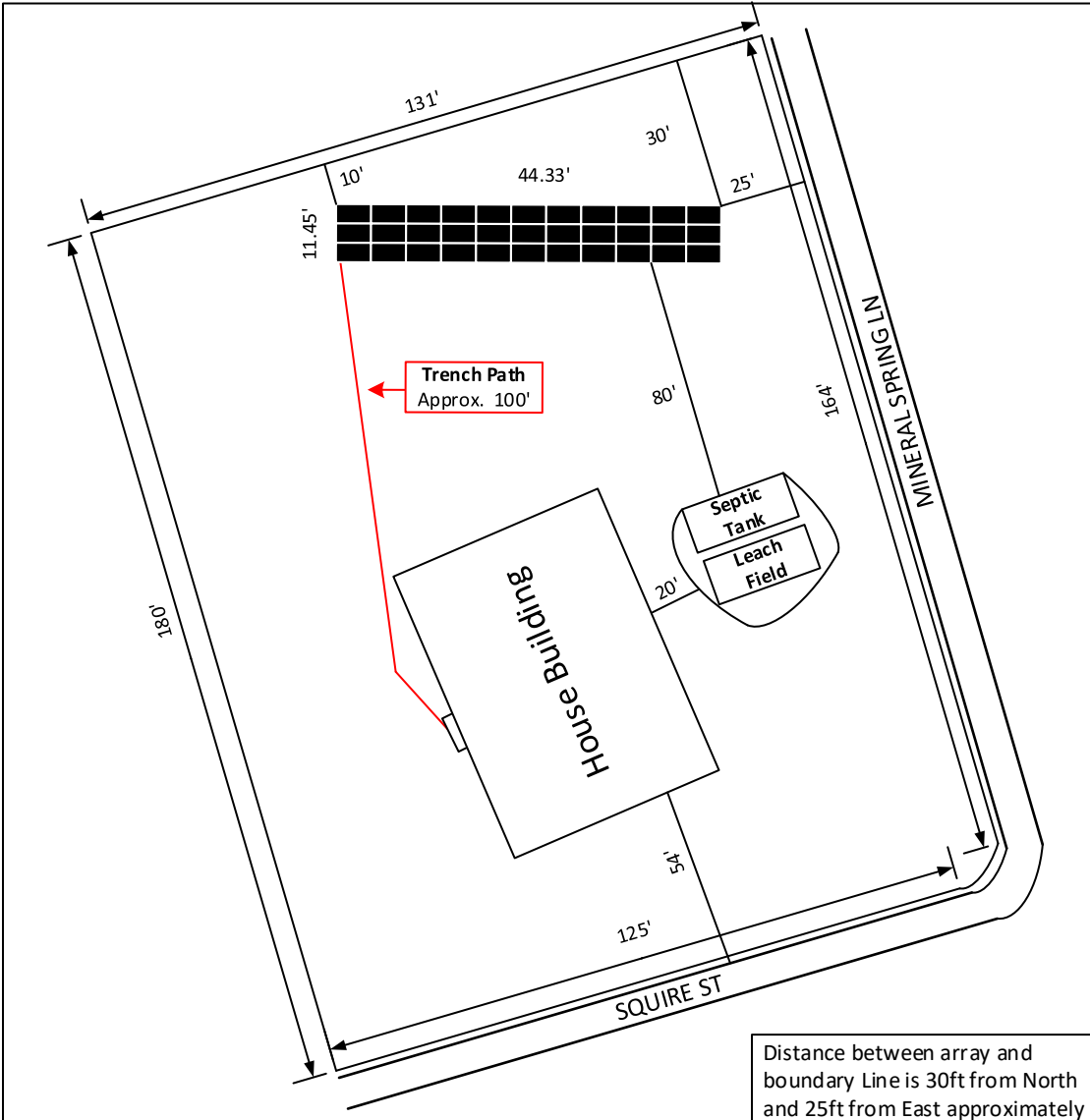

Distance between array and boundary Line is 30ft from North and 25ft from East approximately

PLOT PLAN
SCALE: 3/32" - 1' 0"



Ali Buttar
PVIP #031310-32

1	09/20/2021	A

JOB NUMBER: 21-235-ML00
DATE ISSUED: 09/20/2021
PROJECT STATUS: PERMITTING

SHEET
PLOT PLAN

ML
21235ML00-7