

PROJECT DESCRIPTION:

10 x MISSION SOLAR MSE305SQT MODULES
 ROOF MOUNTED SOLAR PHOTOVOLTAIC MODULES
 SYSTEM SIZE: 3.05 kW DC STC
 ARRAY AREA: ROOF #1- 178.90 SQ FT.

EQUIPMENT SUMMARY

10 MISSION SOLAR MSE305SQT MODULES
 10 SOLAREEDGE POWER OPTIMIZER P320
 01 SOLAREEDGE SE3800H-US INVERTER

AUTHORITIES HAVING JURISDICTION

BUILDING: HARNETT COUNTY
 ZONING: HARNETT COUNTY
 UTILITY: DUKE ENERGY

APPLICABLE CODES & STANDARDS

BUILDING: IBC 2012 IRC 2012
 ELECTRICAL: NEC 2017

DESIGN SPECIFICATION

OCCUPANCY: II
 CONSTRUCTION: SINGLE-FAMILY
 ZONING: RESIDENTIAL
 GROUND SNOW LOAD: 15 PSF
 WIND EXPOSURE: B
 WIND SPEED: 118 MPH

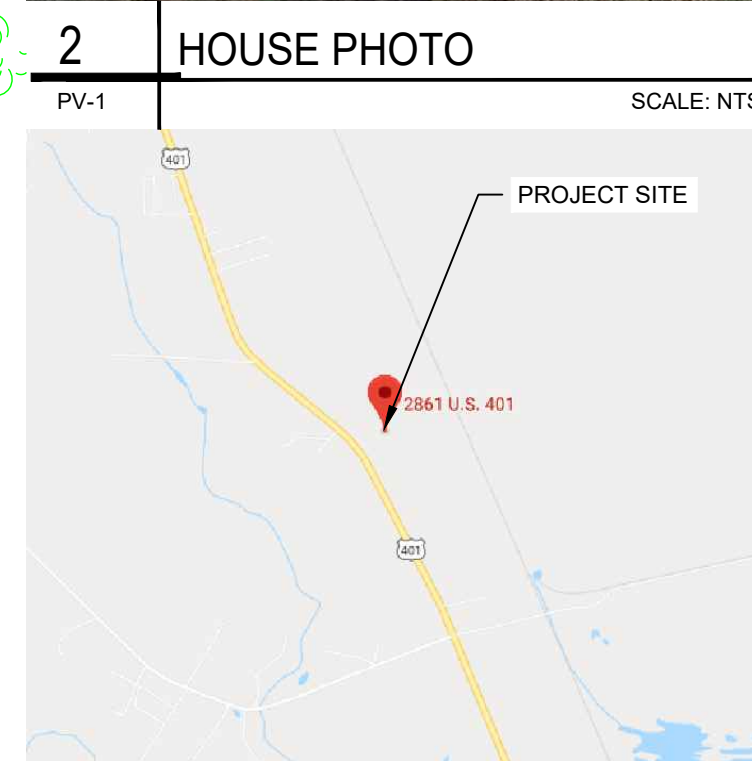
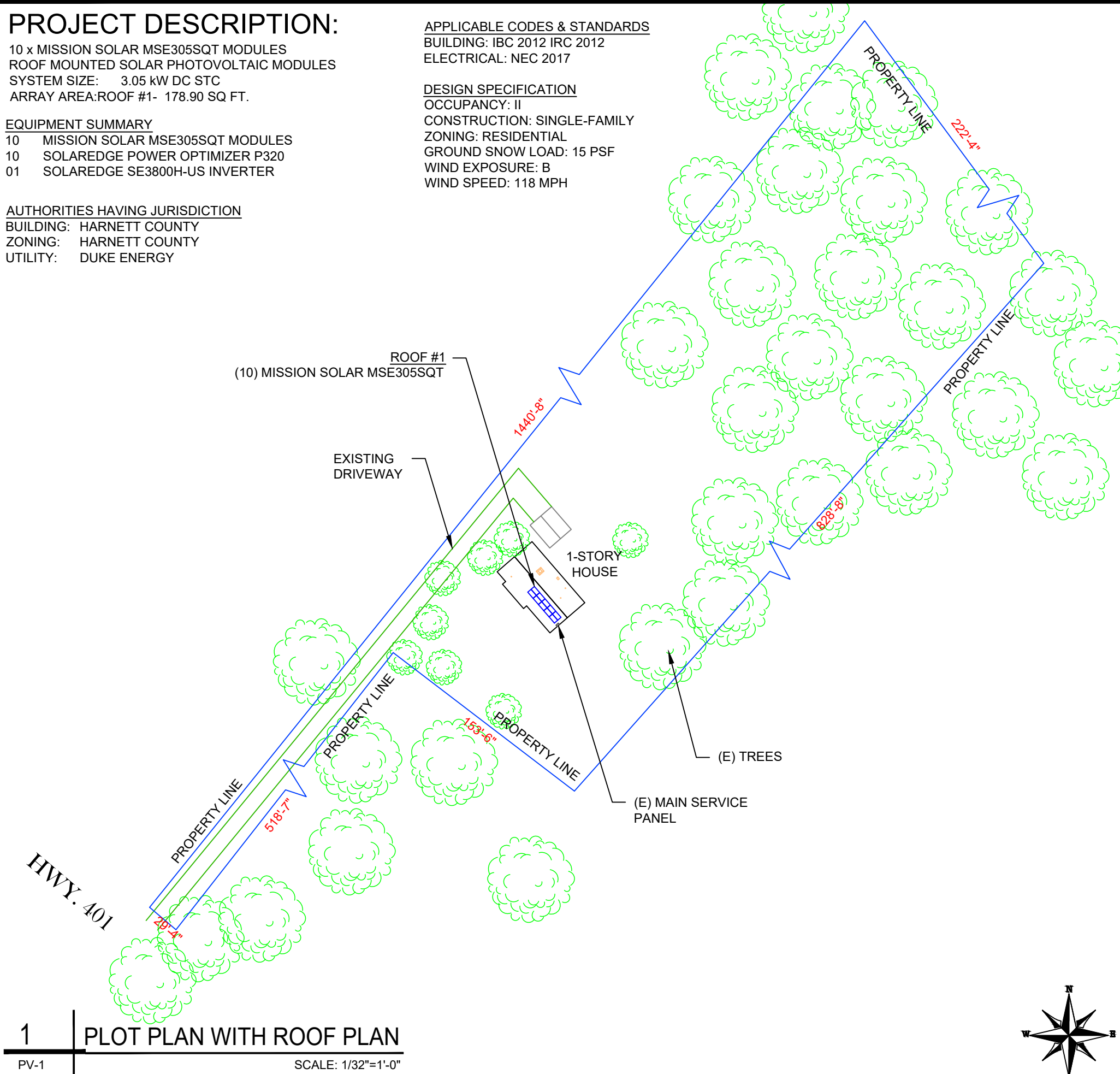

SHEET INDEX

PV-1	PLOT PLAN & VICINITY MAP
PV-2	ROOF PLAN & MODULES
PV-2A	STRING LAYOUT
PV-3	ATTACHMENT DETAIL
PV-4	ELECTRICAL LINE DIAGRAM
PV-5	WIRING CALCULATIONS
PV-6	SOLAREEDGE OPTIMIZER CHART
PV-7 to 11	EQUIPMENT SPECIFICATIONS

POWERHOME SOLAR & ROOFING
 POWER HOME SOLAR, LLC
 "POWER YOUR FUTURE"
 919 N. MAIN ST.
 MOORESVILLE, NC 28115
 Phone: 704-800-6591 (OFFICE)
 Email: info@powerhome.com
 Web: www.powerhome.com

REVISIONS

DESCRIPTION	DATE	REV
INITIAL	20181812	

Signature with Seal
 DATE: 12/18/2018

PROJECT NAME & ADDRESS
 JEFFREY SOWELL
 RESIDENCE
 2861 HWY 401 S.,
 LILLINGTON, NC 27546

DESIGNED BY
 PHS

SHEET NAME
 PLOT PLAN &
 VICINITY MAP

SHEET SIZE
 ANSI B
 11" X 17"

SHEET NUMBER
 PV-1

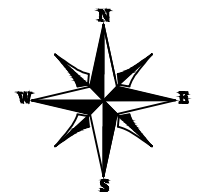

MODULE TYPE, DIMENSIONS & WEIGHT

NUMBER OF MODULES = 10 MODULES
 MODULE TYPE = MISSION SOLAR MSE305SQT MODULES
 MODULE WEIGHT = 40.1 LBS / 18.2 KG.
 MODULE DIMENSIONS = 65.51"x 39.33" = 17.89 SF

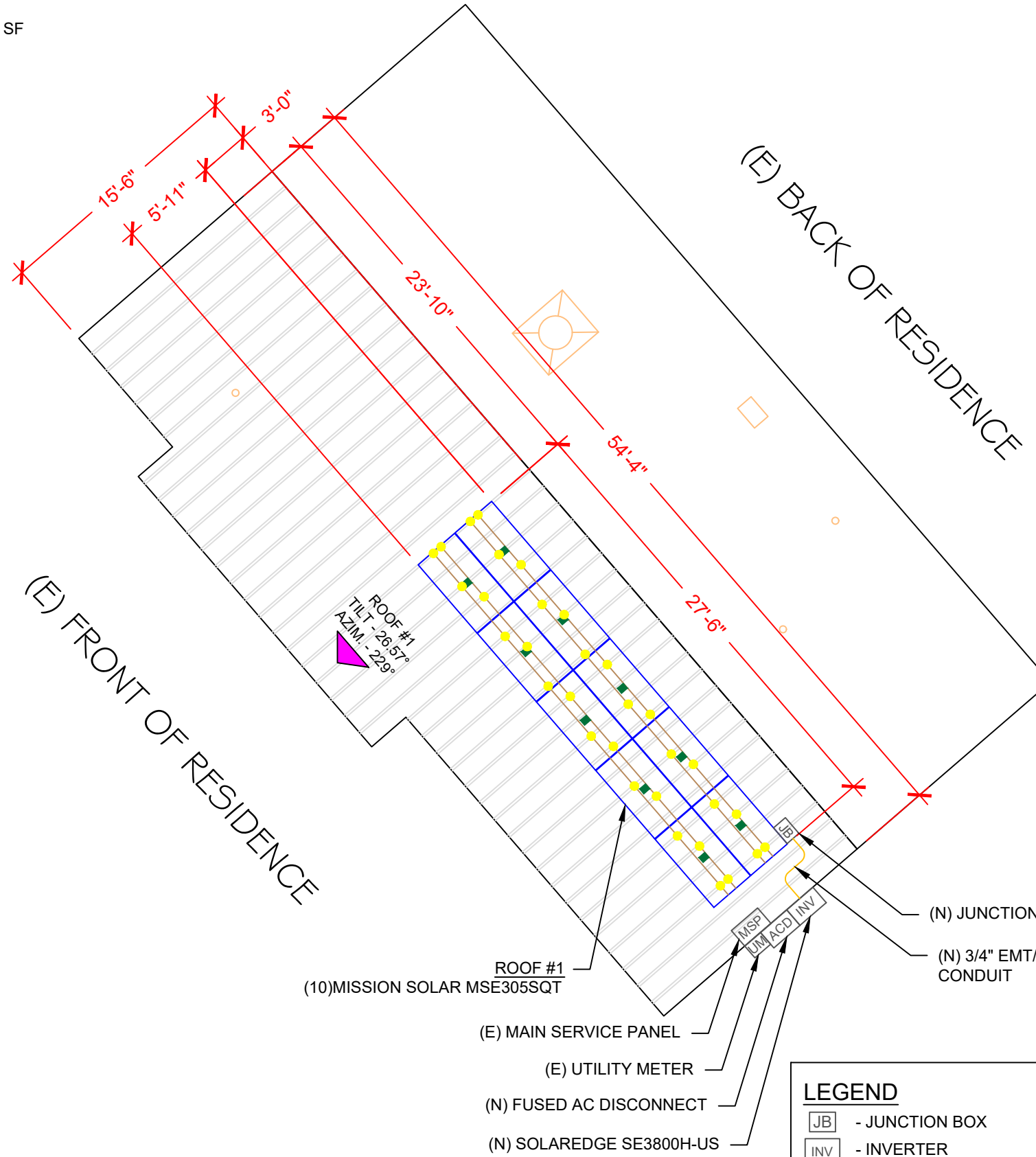

ROOF DESCRIPTION				
ROOF TYPE		COMPOSITE SHINGLE		
ROOF LAYER		1 LAYER		
ROOF	TILT	AZIMUTH	RAFTER SIZE	RAFTER SPACING
#1	26.57°	229°	2X6	16"

ARRAY AREA & ROOF AREA CALC'S				
ROOF	# OF MODULES	ARRAY AREA (Sq. Ft.)	ROOF AREA (Sq. Ft.)	ROOF AREA COVERED BY ARRAY (%)
#1	10	178.90	901.43	20

POWERHOME SOLAR & ROOFING
 POWERHOME SOLAR, LLC
 "POWER YOUR FUTURE"
 919 N. MAIN ST.
 MOORESVILLE, NC 28115
 Phone: 704-800-6591 (OFFICE)
 Email: info@powerhome.com
 Web: www.powerhome.com

REVISIONS		
DESCRIPTION	DATE	REV
INITIAL	20181812	

Signature with Seal
 DATE: 12/18/2018

PROJECT NAME & ADDRESS
JEFFREY SOWELL RESIDENCE
 2861 HWY 401 S.,
 LILLINGTON, NC 27546

DESIGNED BY
PHS

SHEET NAME
ROOF PLAN & MODULES

SHEET SIZE
**ANSI B
 11" X 17"**

SHEET NUMBER
PV-2

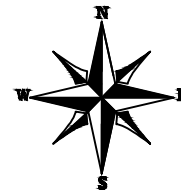

LEGEND

- [JB] - JUNCTION BOX
- [INV] - INVERTER
- [DC] - INTEGRATED DC DISCONNECT
- [SLD] - SOLAR LOAD CENTER
- [PM] - PRODUCTION METER
- [MSP] - MAIN SERVICE PANEL
- [] - VENT, ATTIC FAN (ROOF OBSTRUCTION)
- [] - ROOF ATTACHMENT
- - - - - RAFTERS
- - - - - CONDUIT
- [CB] - COMBINER BOX

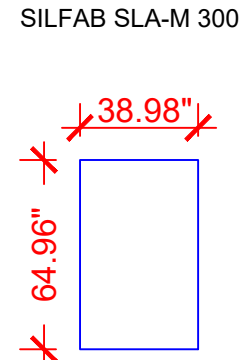

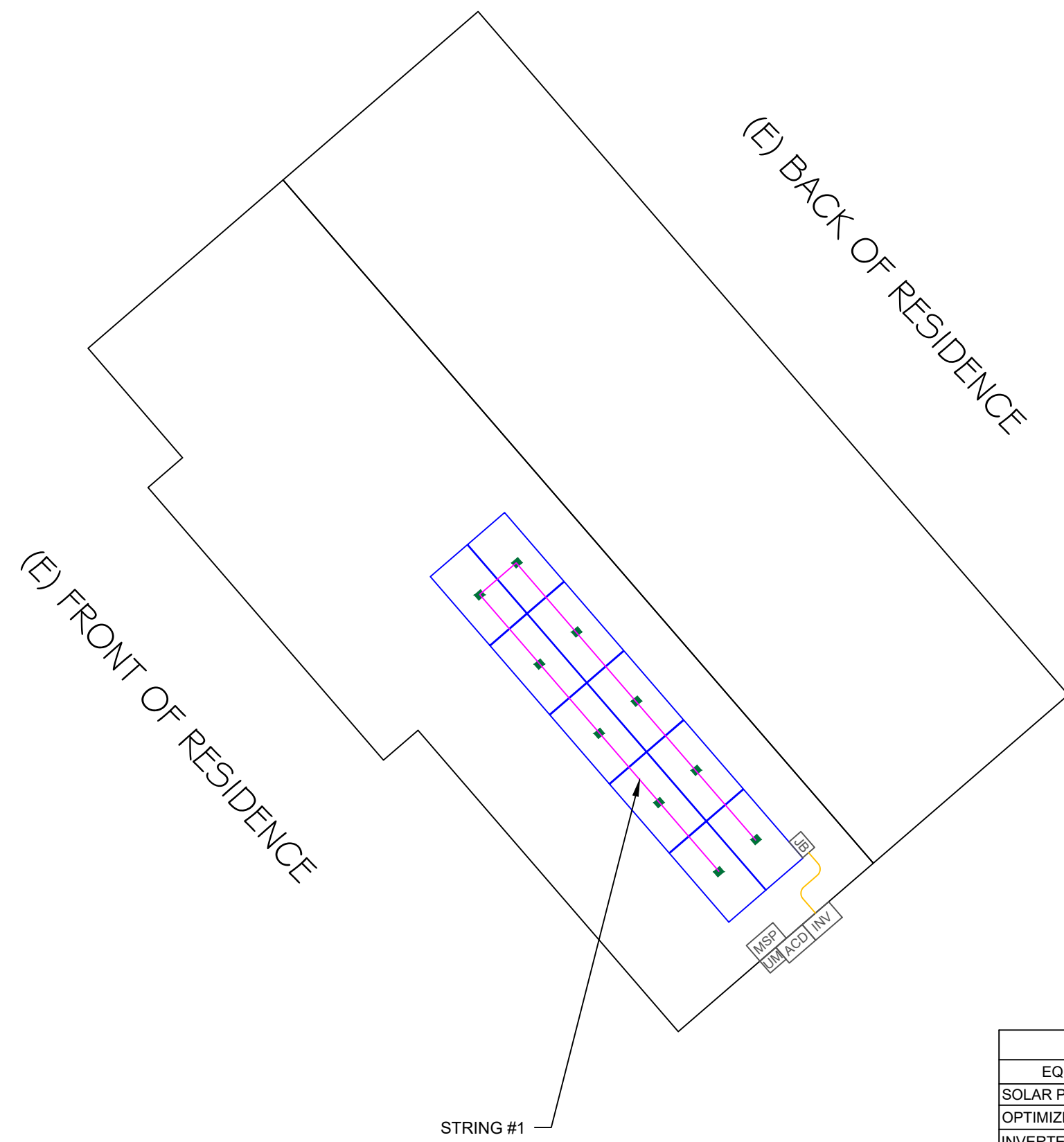
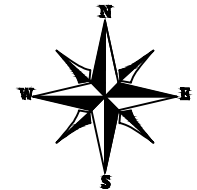

POWERHOME
SOLAR & ROOFING

POWER HOME SOLAR, LLC
"POWER YOUR FUTURE"
919 N. MAIN ST.
MOORESVILLE, NC 28115
Phone: 704-800-6591 (OFFICE)
Email: info@powerhome.com
Web: www.powerhome.com

REVISIONS		
DESCRIPTION	DATE	REV
INITIAL	20181812	

Signature with Seal

DATE: 12/18/2018

PROJECT NAME & ADDRESS

**JEFFREY SOWELL
RESIDENCE**
2861 HWY 401 S.,
LILLINGTON, NC 27546

DESIGNED BY
PHS

SHEET NAME
**STRING
LAYOUT**

SHEET SIZE
**ANSI B
11" X 17"**

SHEET NUMBER
PV-2A

BILL OF MATERIALS		
EQUIPMENT	QTY	DESCRIPTION
SOLAR PV MODULE	10	MISSION SOLAR MSE305SQT
OPTIMIZER	10	SOLAREGE POWER OPTIMIZER P320
INVERTER	1	SOLAREGE SE3800H-US INVERTER
AC DISCONNECT	1	30A FUSED, (2) 20A FUSES, 240V, NEMA 3R, UL LISTED
SOLAR DECK	1	SOLAR DECKS
RAILS	8	IRONRIDGE XR10 RAIL 168" (14 FEET) BLACK
BONDED SPLICE	4	SPLICE KIT
MODULE CLAMPS	24	UNIVERSAL MODULE CLAMPS
GROUNDING LUG	2	IRONRIDGE GROUNDING LUG
END CLAMPS	8	END CLAMPS / STOPPER SLEEVE
ATTACHMENT	28	SRH LOW PROFILE QUICKBOLT
SQUARE-BOLT	28	SQUARE-BOLT BONDING ATTACHMENT HARDWARE

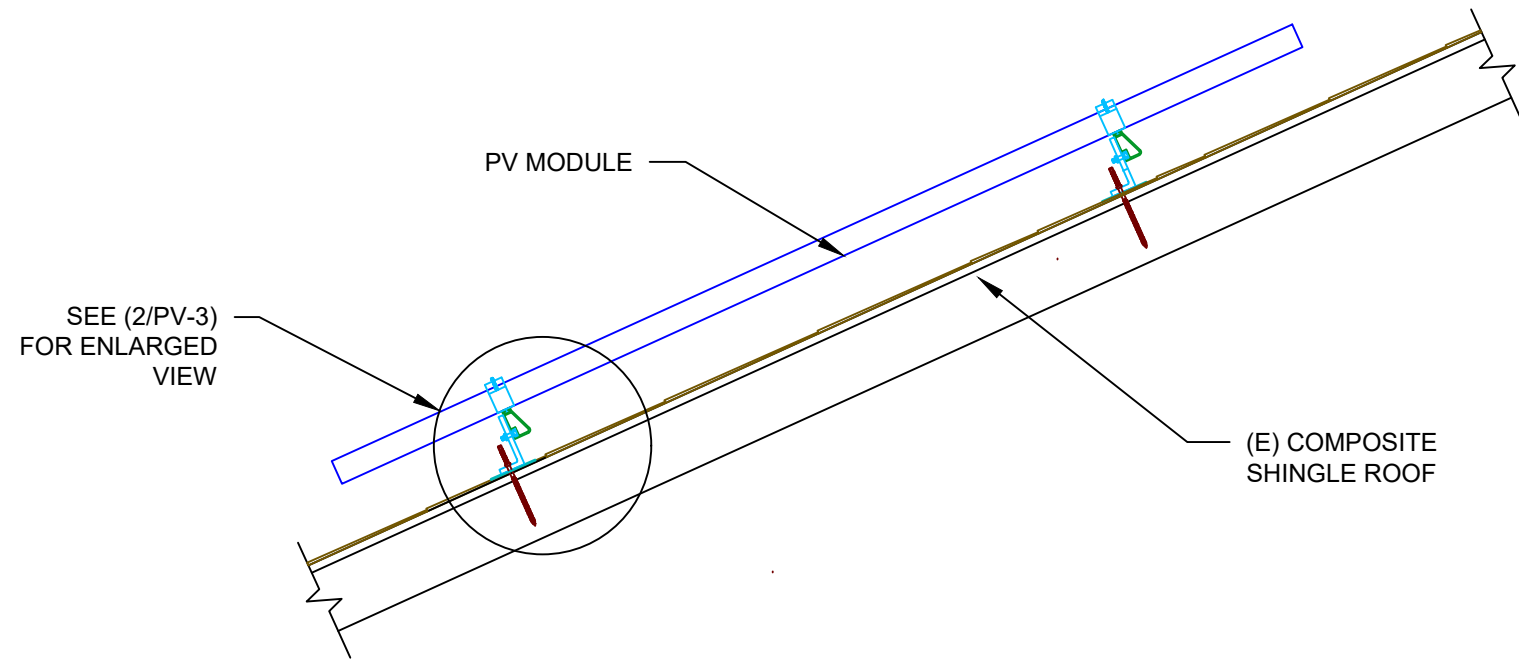

1 ATTACHMENT DETAIL

PV-3 SCALE: 1" = 1'-0"

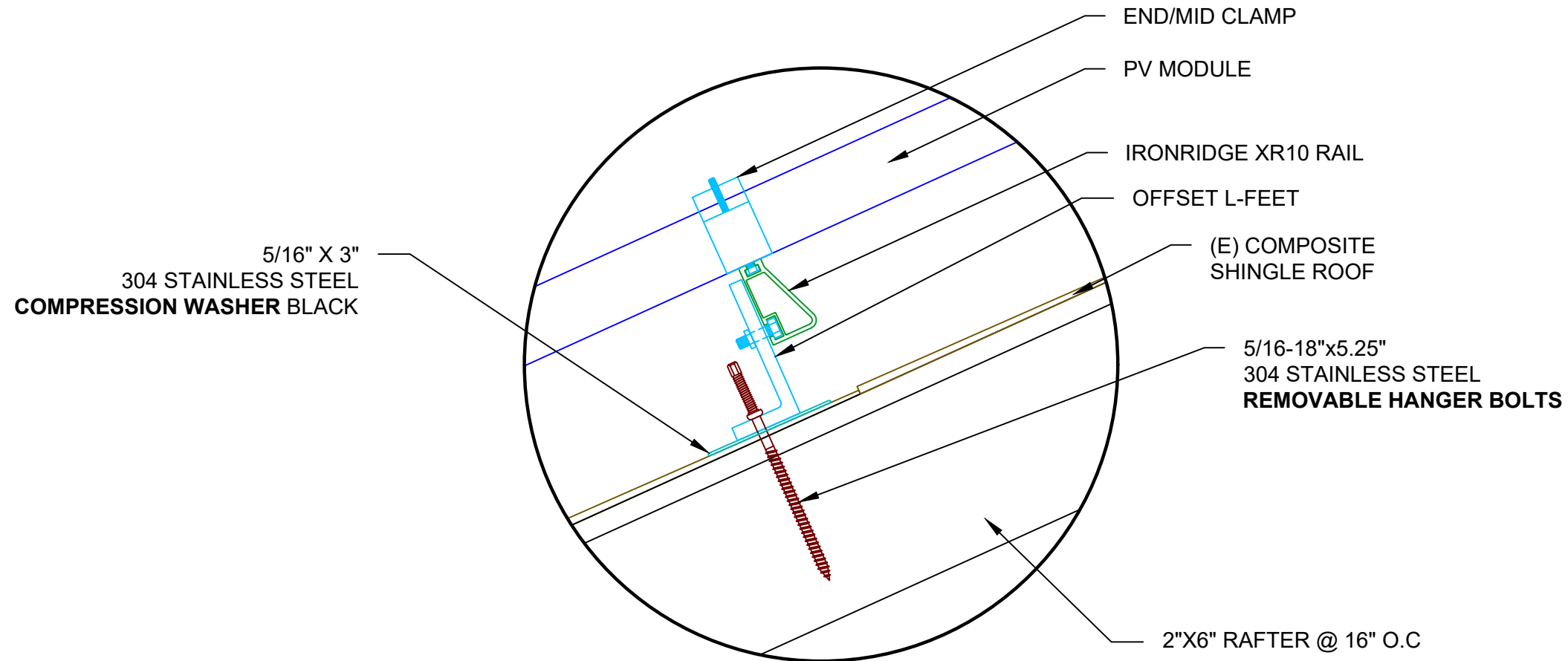

2 ATTACHMENT DETAIL (enlarged view)

PV-3 SCALE: NTS

POWERHOME SOLAR & ROOFING
 POWER HOME SOLAR, LLC
 "POWER YOUR FUTURE"
 919 N. MAIN ST.
 MOORESVILLE, NC 28115
 Phone: 704-800-6591 (OFFICE)
 Email: info@powerhome.com
 Web: www.powerhome.com

REVISIONS		
DESCRIPTION	DATE	REV
INITIAL	20181812	

Signature with Seal

DATE: 12/18/2018

PROJECT NAME & ADDRESS

JEFFREY SOWELL RESIDENCE
 2861 HWY 401 S.,
 LILLINGTON, NC 27546

DESIGNED BY
PHS

SHEET NAME
ATTACHMENT DETAIL

SHEET SIZE
**ANSI B
 11" X 17"**

SHEET NUMBER
PV-3

(10) MISSION SOLAR MSE305SQT
MODULES
(1) STRING OF 10 MODULES
CONNECTED IN SERIES

SOLAREEDGE SE3800H-US (240V)
OUTPUT: 240 VAC, 16A
99% CEC WEIGHTED EFFICIENCY
NEMA 3R, UL LISTED, INTERNAL GFDI
WITH INTEGRATED DC DISCONNECT

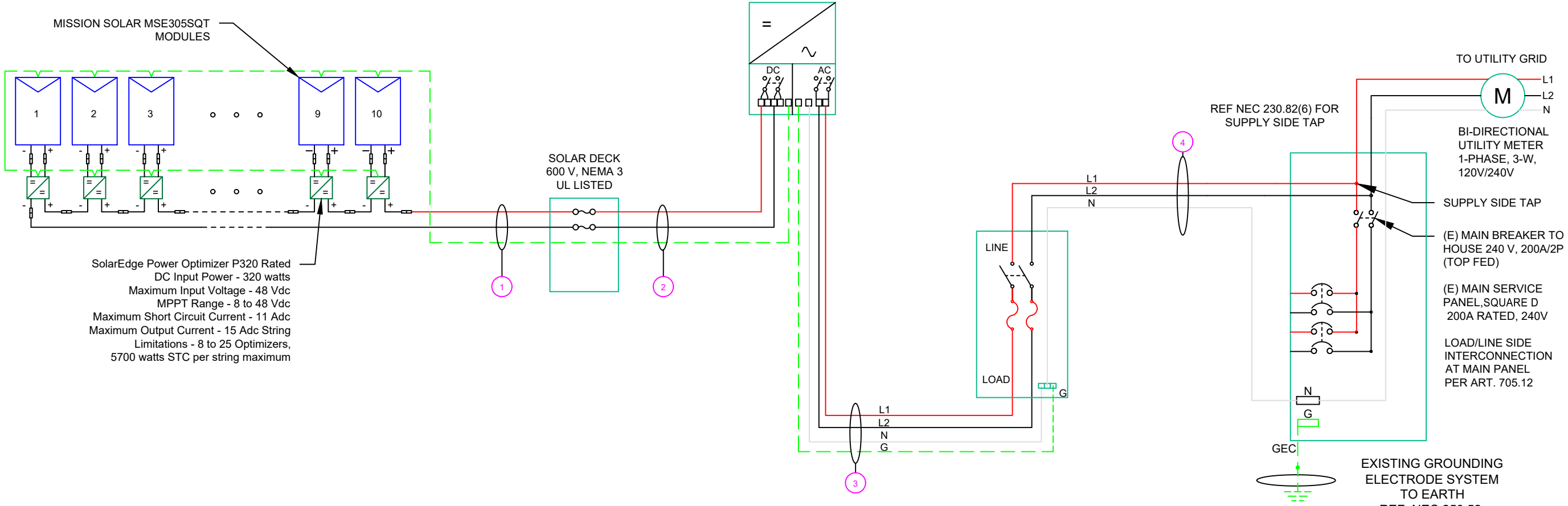

! WARNING !
PHOTOVOLTAIC
POWER SOURCE

LABEL 1
ON ALL CONDUITS SPACED AT MAX 10FT

! CAUTION !
SOLAR ELECTRIC
SYSTEM CONNECTED
AND ENERGIZED

LABEL 2
AT INVERTER

SOLAR PV SYSTEM EQUIPPED
WITH RAPID SHUTDOWN

TURN RAPID SHUTDOWN
SWITCH TO THE
'OFF' POSITION TO
SHUT DOWN PV SYSTEM
AND REDUCE
SHOCK HAZARD
IN THE ARRAY

LABEL 3
AT INVERTER

! WARNING !
PHOTOVOLTAIC
DC DISCONNECT

LABEL 4
AT EACH DC DISCONNECT

AC DISCONNECT:
30A FUSED, (2) 20A FUSES,
240V NEMA 3R, UL LISTED

! WARNING !
ELECTRIC SHOCK HAZARD
DO NOT TOUCH TERMINALS
TERMINALS ON BOTH LINE AND LOAD SIDES
MAY BE ENERGIZED IN THE OPEN POSITION

LABEL 5
AT EACH AC DISCONNECT

! WARNING !
PHOTOVOLTAIC
AC
DISCONNECT

LABEL 6
AT EACH AC DISCONNECT

! WARNING !
DUAL POWER SOURCES
SECOND SOURCE IS PV SYSTEM

LABEL 8
AT MEP

! WARNING !
SOLAR SYSTEM
CONNECTED
AND ENERGIZED

LABEL 9
AT MEP

! CAUTION !
SOLAR POINT OF
INTERCONNECTION

LABEL 10
AT UTILITY METER

! WARNING !
THE SERVICE METER IS ALSO SERVED
BY A PHOTOVOLTAIC SYSTEM

LABEL 11
AT UTILITY METER

QTY	CONDUCTOR INFORMATION	CONDUIT TYPE	CONDUIT SIZE
(2)	#10AWG - PV WIRE/USE-2	N/A	N/A
(1)	#6AWG - BARE COPPER IN FREE AIR	N/A	N/A
(2)	#10AWG - THWN-2	EMT OR FLEX IN ATTIC	3/4"
(1)	#6AWG - THWN-2 GND	EMT OR FLEX IN ATTIC	3/4"
(3)	#6AWG - THWN-2	EMT OR FLEX IN ATTIC	3/4"
(1)	#6AWG - THWN-2 GND	PVC OR LFNC	3/4"
(3)	#6AWG - THWN-2	PVC OR LFNC	3/4"

SERVICE INFO

UTILITY PROVIDER: DUKE ENERGY
MAIN SERVICE VOLTAGE: 240V
MAIN PANEL BRAND: SQUARE D
MAIN SERVICE PANEL: 200A
MAIN CIRCUIT BREAKER RATING: 200A
MAIN SERVICE LOCATION: SOUTH-EAST
SERVICE FEED SOURCE: OVERHEAD

POWERHOME SOLAR & ROOFING
POWER HOME SOLAR, LLC
"POWER YOUR FUTURE"
919 N. MAIN ST.
MOORESVILLE, NC 28115
Phone: 704-800-6891 (OFFICE)
E-mail: info@powerhome.com
Web: www.powerhome.com

REVISIONS

DESCRIPTION	DATE	REV
INITIAL	20181812	

Signature with Seal

DATE: 12/18/2018

PROJECT NAME & ADDRESS

JEFFREY SOWELL
RESIDENCE
2861 HWY 401 S.,
LILLINGTON, NC 27546

DESIGNED BY
PHS

SHEET NAME
**ELECTRICAL LINE
DIAGRAM**

SHEET SIZE
**ANSI B
11" X 17"**

SHEET NUMBER
PV-4

SOLAR MODULE SPECIFICATIONS	
MANUFACTURER / MODEL #	MISSION SOLAR MSE305SQT
VMP	32.9V
IMP	9.27A
VOC	40.25V
ISC	9.69A
TEMP. COEFF. VOC	-0.318%/°C
MODULE DIMENSION	65.51"L x 39.33"W x 1.57"D (In Inch)

INVERTER #1 SPECIFICATIONS	
MANUFACTURER / MODEL #	SOLAREEDGE SE3800H-US
NOMINAL AC POWER	3.8 KW
NOMINAL OUTPUT VOLTAGE	240 VAC
NOMINAL OUTPUT CURRENT	16A

POWER OPTIMIZER (OPTIMIZER P320-2NM4ARS)	
MAXIMUM INPUT POWER	320W
MINIMUM INPUT VOLTAGE	8 VDC
MAXIMUM INPUT VOLTAGE	48VDC
MAXIMUM MODULE ISC	11 ADC
MAXIMUM OUTPUT CURRENT	15 ADC

PERCENT OF VALUES	NUMBER OF CURRENT CARRYING CONDUCTORS IN EMT
.80	4-6
.70	7-9
.50	10-20

AMBIENT TEMPERATURE SPECS	
RECORD LOW TEMP	-7°
AMBIENT TEMP (HIGH TEMP 2%)	34°
CONDUIT HEIGHT	0.5"
ROOF TOP TEMP	56°
CONDUCTOR TEMPERATURE RATE	90°
MODULE TEMPERATURE COEFFICIENT OF Voc	-0.30%/°C

DC CONDUCTOR AMPACITY CALCULATIONS: ARRAY TO JUNCTION BOX:

EXPECTED WIRE TEMP (In Celsius)	56°
TEMP. CORRECTION PER TABLE (310.16)	0.71
NO. OF CURRENT CARRYING CONDUCTORS	2
CONDUIT FILL CORRECTION PER NEC 310.15(B)(3)(a)	1
CIRCUIT CONDUCTOR SIZE	10 AWG
CIRCUIT CONDUCTOR AMPACITY	40A

REQUIRED CIRCUIT CONDUCTOR AMPACITY PER NEC 690.8(A&B)	18.75A
1.25 X Isc	
DERATED AMPACITY OF CIRCUIT CONDUCTOR PER NEC TABLE 310.16	
CONDUIT FILL CORRECTION PER NEC 310.15(B)(3)(a) X CIRCUIT CONDUCTOR AMPACITY	40A
Result should be greater than (18.75A) otherwise less the entry for circuit conductor size and ampacity	

DC CONDUCTOR AMPACITY CALCULATIONS: FROM JUNCTION BOX TO INVERTER:

AMBIENT TEMPERATURE ADJUSTMENT FOR EXPOSED CONDUIT PER NEC 310.15(B)(2)(c)	+22°
EXPECTED WIRE TEMP (In Celsius)	34°+22° = 56°
TEMP. CORRECTION PER TABLE (310.16)	0.71
NO. OF CURRENT CARRYING CONDUCTORS	2
CONDUIT FILL CORRECTION PER NEC 310.15(B)(2)(a)	1
CIRCUIT CONDUCTOR SIZE	10AWG
CIRCUIT CONDUCTOR AMPACITY	40A

REQUIRED CIRCUIT CONDUCTOR AMPACITY PER NEC 690.8(A&B)	18.75A
1.25 X Isc	
DERATED AMPACITY OF CIRCUIT CONDUCTOR PER NEC TABLE 310.16	
CONDUIT FILL CORRECTION PER NEC 310.15(B)(2)(a) X CIRCUIT CONDUCTOR AMPACITY	40A
Result should be greater than (18.75A) otherwise less the entry for circuit conductor size and ampacity	

AC CONDUCTOR AMPACITY CALCULATIONS:

No. OF INVERTER	1
EXPECTED WIRE TEMP (In Celsius)	34°
TEMP. CORRECTION PER TABLE (310.16)	0.96
NO. OF CURRENT CARRYING CONDUCTORS	3
CONDUIT FILL CORRECTION PER NEC 310.15(B)(2)(a)	1
CIRCUIT CONDUCTOR SIZE	6 AWG
CIRCUIT CONDUCTOR AMPACITY	75A

REQUIRED CIRCUIT CONDUCTOR AMPACITY PER NEC 690.8(B)	20A
1.25 X MAX INVERTER OUTPUT CURRENT	
DERATED AMPACITY OF CIRCUIT CONDUCTOR PER NEC TABLE 310.16	
TEMP. CORRECTION PER TABLE (310.16) X CONDUIT FILL CORRECTION PER NEC 310.15(B)(2)(a) X CIRCUIT CONDUCTOR AMPACITY	72A
Result should be greater than (20A) otherwise less the entry for circuit conductor size and ampacity	

ELECTRICAL NOTES

- 1.) ALL EQUIPMENT TO BE LISTED BY UL OR OTHER NRTL, AND LABELED FOR ITS APPLICATION.
- 2.) ALL CONDUCTORS SHALL BE COPPER, RATED FOR 600 V AND 90 DEGREE C WET ENVIRONMENT.
- 3.) WIRING, CONDUIT, AND RACEWAYS MOUNTED ON ROOFTOPS SHALL BE ROUTED DIRECTLY TO, AND LOCATED AS CLOSE AS POSSIBLE TO THE NEAREST RIDGE, HIP, OR VALLEY.
- 4.) WORKING CLEARANCES AROUND ALL NEW AND EXISTING ELECTRICAL EQUIPMENT SHALL COMPLY WITH NEC 110.26.
- 5.) DRAWINGS INDICATE THE GENERAL ARRANGEMENT OF SYSTEMS. CONTRACTOR SHALL FURNISH ALL NECESSARY OUTLETS, SUPPORTS, FITTINGS AND ACCESSORIES TO FULFILL APPLICABLE CODES AND STANDARDS.
- 6.) WHERE SIZES OF JUNCTION BOXES, RACEWAYS, AND CONDUITS ARE NOT SPECIFIED, THE CONTRACTOR SHALL SIZE THEM ACCORDINGLY.
- 7.) ALL WIRE TERMINATIONS SHALL BE APPROPRIATELY LABELED AND READILY VISIBLE.
- 8.) MODULE GROUNDING CLIPS TO BE INSTALLED BETWEEN MODULE FRAME AND MODULE SUPPORT RAIL, PER THE GROUNDING CLIP MANUFACTURER'S INSTRUCTION.
- 9.) MODULE SUPPORT RAIL TO BE BONDED TO CONTINUOUS COPPER G.E.C. VIA WEEB LUG OR ILSCO GBL-4DBT LAY-IN LUG.
- 10.) THE POLARITY OF THE GROUNDED CONDUCTORS IS NEGATIVE



REVISIONS		
DESCRIPTION	DATE	REV
INITIAL	20181812	

Signature with Seal

DATE: 12/18/2018

PROJECT NAME & ADDRESS

JEFFREY SOWELL
RESIDENCE
2861 HWY 401 S.,
LILLINGTON, NC 27546

DESIGNED BY

PHS

SHEET NAME

WIRING
CALCULATIONS

SHEET SIZE

ANSI B
11" X 17"

SHEET NUMBER

PV-5

1-10 11-20 21-30 31-40 41-50 51-60

SOLAREEDGE OPTIMIZER CHART

1
2
3
4
5
6
7
8
9
10

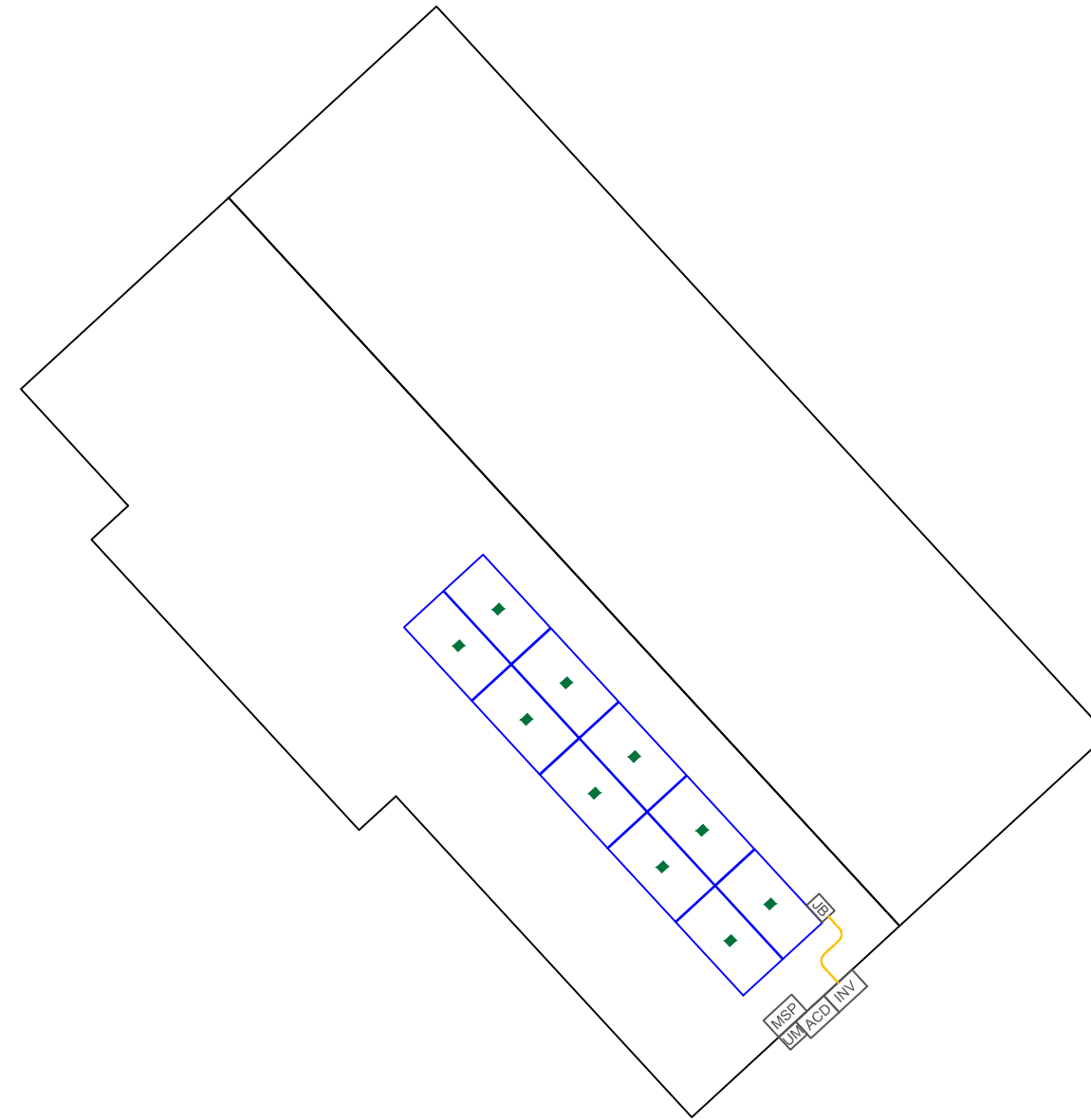

POWER HOME SOLAR, LLC
 "POWER YOUR FUTURE"
 919 N. MAIN ST.
 MOORESVILLE, NC 28115
 Phone: 704-800-6591 (OFFICE)
 Email: info@powerhome.com
 Web: www.powerhome.com

REVISIONS		
DESCRIPTION	DATE	REV
INITIAL	20181812	

Signature with Seal

DATE: 12/18/2018

PROJECT NAME & ADDRESS

**JEFFREY SOWELL
 RESIDENCE**

2861 HWY 401 S.,
 LILLINGTON, NC 27546

DESIGNED BY

PHS

SHEET NAME

**SOLAREEDGE
 OPTIMIZER CHART**

SHEET SIZE

**ANSI B
 11" X 17"**

SHEET NUMBER

PV-6

MSE PERC 60

High Power PERC Rooftop Module



Class Leading Output:
305W power



Advanced Technology:
PERC and 4 busbars drive
>18% module efficiency



Superior Aesthetics:
All-black design coupled with
outstanding power output



Certified Reliability:
3X IEC, salt mist, ammonia



5600 Pa snow load **New!**
175 mph wind rating



Buy American Act

Proudly assembled in the USA
Mission Solar Energy is headquartered in San Antonio, TX with module facilities onsite. Our hardworking team calls Texas home and is devoted to producing high quality solar products and services. Our supply chain includes local and domestic vendors increasing our impact to the U.S. economy.



Superior Aesthetics

MSE PERC 60's slick all-black design coupled with outstanding power output makes it ideal for DG installations including commercial and rooftop systems.

Outstanding performance with PERC

Passivated Emitter Rear Contact (PERC) technology provides excellent power output through advanced cell structure.

Best in class quality

Mission Solar Energy production lines are fully automated and include multiple quality checks throughout the production process.

25-YEAR LINEAR WARRANTY



ELECTRICAL SPECIFICATIONS

Electrical parameters at Standard Test Condition (STC)

Module Type	MSE305SQ5T		
Power Output	Pmax	Wp	305
Module Efficiency	%		18.35
Tolerance			0~+3%
Short-Circuit Current	Isc	A	9.69
Open Circuit Voltage	Voc	V	40.25
Rated Current	Imp	A	9.27
Rated Voltage	Vmp	V	32.9

STC: Irradiance 1000 W/m², Cell temperature of 25°C, AM 1.5

TEMPERATURE COEFFICIENTS

Normal Operating Cell Temperature (NOCT)	44°C (±2°C)
Temperature Coefficient of Pmax	-0.427%/°C
Temperature Coefficient of Voc	-0.318%/°C
Temperature Coefficient of Isc	0.042%/°C

OPERATING CONDITIONS

Maximum System Voltage	1,000VDC
Operating Temperature Range	-40°C (-40°F) to +90°C (194°F)
Maximum Series Fuse Rating	15A
Fire Safety Classification	Type 1, Class C
Front & Back Load (UL standard)	5600 Pa (117 psf) New!
Hail Safety Impact Velocity	25mm at 23 m/s

MECHANICAL DATA

Solar Cells	P-type Mono-crystalline Silicon (156.75mm)
Cell orientation	60 cells (6x10), 4 busbar
Module dimension	1664mm x 999mm x 40mm (65.51 in. x 39.33 in. x 1.57 in.)
Weight	18.2 kg (40.1 lb)
Front Glass	3.2mm (0.126 in.) tempered, Low-iron, Anti-reflective coating
Frame	Anodized aluminum alloy
Encapsulant	Ethylene vinyl acetate (EVA)
J-Box	Protection class IP67 with 3 bypass-diodes
Cables	PV wire, 1m (39.37 in.), 4mm ² / 12 AWG
Connector	MC4 or compatible

MSE305SQ5T: 305WP, 60CELL SOLAR MODULE CURRENT-VOLTAGE CURVE

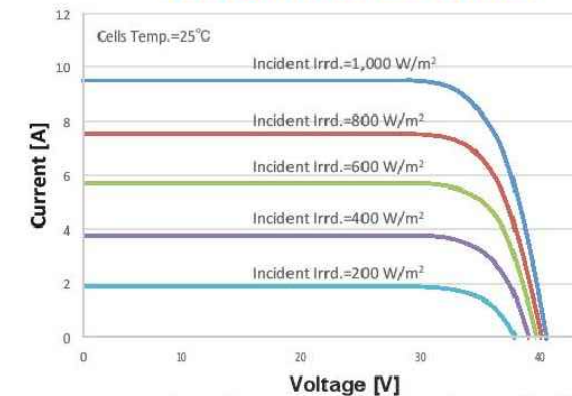

Current-voltage characteristics with dependence on irradiance and module temperature

BASIC DESIGN (UNITS: mm)

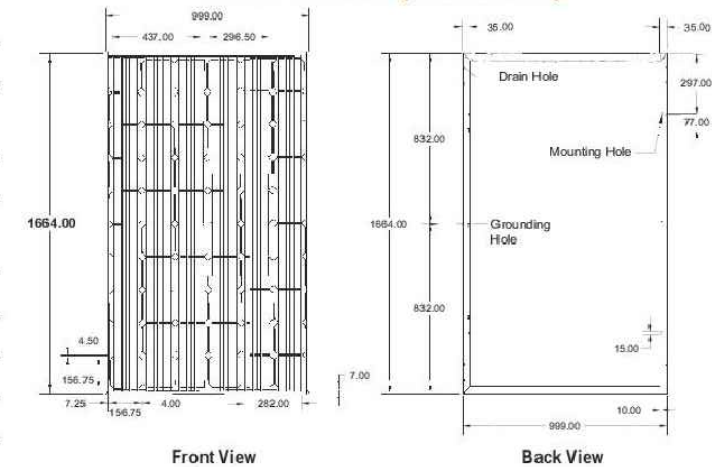

Mission Solar Energy reserves the right to make specification changes without notice.

8303 South New Braunfels Ave. | San Antonio | TX | 78235 | missionsolar.com | info@missionsolar.com | (210) 531-8600



POWERHOME SOLAR, LLC
"POWER YOUR FUTURE"
919 N. MAIN ST.
MOORESVILLE, NC 28115
Phone: 704-800-6591 (OFFICE)
Email: info@powerhome.com
Web: www.powerhome.com

REVISIONS

DESCRIPTION	DATE	REV
INITIAL	20181812	

Signature with Seal

DATE: 12/18/2018

PROJECT NAME & ADDRESS

JEFFREY SOWELL
RESIDENCE
2861 HWY 401 S.,
LILLINGTON, NC 27546

DESIGNED BY

PHS

SHEET NAME
EQUIPMENT
SPECIFICATION

SHEET SIZE

ANSI B
11" X 17"

SHEET NUMBER

PV-7



Single Phase Inverter with HD-Wave Technology for North America

SE3000H-US / SE3800H-US / SE5000H-US / SE6000H-US / SE7600H-US / SE10000H-US / SE11400H-US



Optimized installation with HD-Wave technology

- Specifically designed to work with power optimizers
- Record-breaking efficiency
- Fixed voltage inverter for longer strings
- Integrated arc fault protection and rapid shutdown for NEC 2014 and 2017, per article 690.11 and 690.12
- UL1741 SA certified, for CPUC Rule 21 grid compliance
- Extremely small
- High reliability without any electrolytic capacitors
- Built-in module-level monitoring
- Outdoor and indoor installation
- Optional: Revenue grade data, ANSI C12.20 Class 0.5 (0.5% accuracy)



www.solaredge.us

INVERTERS



Single Phase Inverter with HD-Wave Technology for North America

SE3000H-US / SE3800H-US / SE5000H-US / SE6000H-US / SE7600H-US / SE10000H-US / SE11400H-US

	SE3000H-US	SE3800H-US	SE5000H-US	SE6000H-US	SE7600H-US	SE10000H-US	SE11400H-US		
OUTPUT									
Rated AC Power Output	3000	3800 @ 240V 3300 @ 208V	5000	6000 @ 240V 5000 @ 208V	7600	10000	11400	VA	
Max. AC Power Output	3000	3800 @ 240V 3300 @ 208V	5000	6000 @ 240V 5000 @ 208V	7600	10000	11400	VA	
AC Output Voltage Min.-Nom.-Max. (183 - 208 - 229)	-	✓	-	✓	-	-	-	Vac	
AC Output Voltage Min.-Nom.-Max. (211 - 240 - 264)	✓	✓	✓	✓	✓	✓	✓	Vac	
AC Frequency (Nominal)					59.3 - 60 - 60.5 ⁽¹⁾			Hz	
Maximum Continuous Output Current @208V	-	16	-	24	-	-	-	A	
Maximum Continuous Output Current @240V	12.5	16	21	25	32	42	47.5	A	
GFDI Threshold					1			A	
Utility Monitoring, Islanding Protection, Country Configurable Thresholds					Yes				
INPUT									
Maximum DC Power @240V	4650	5900	7750	9300	11800	15500	17650	W	
Maximum DC Power @208V	-	5100	-	7750	-	-	-	W	
Transformer-less, Ungrounded					Yes				
Maximum Input Voltage					480			Vdc	
Nominal DC Input Voltage					400			Vdc	
Maximum Input Current @208V	-	9	-	13.5	-	-	-	Adc	
Maximum Input Current @240V	8.5	10.5	13.5	16.5	20	27	30.5	Adc	
Max. Input Short Circuit Current					45			Adc	
Reverse-Polarity Protection					Yes				
Ground-Fault Isolation Detection					600µS Sensitivity				
Maximum Inverter Efficiency	99			99.2				%	
CEC Weighted Efficiency					99			%	
Nighttime Power Consumption					< 2.5			W	
ADDITIONAL FEATURES									
Supported Communication Interfaces					RS485, Ethernet, ZigBee (optional), Cellular (optional)				
Revenue Grade Data, ANSI C12.20					Optional ⁽²⁾				
Rapid Shutdown - NEC 2014 and 2017 690.12					Automatic Rapid Shutdown upon AC Grid Disconnect				
STANDARD COMPLIANCE									
Safety					UL1741, UL1741 SA, UL1699B, CSA C22.2, Canadian AFCEI according to T.I.L. M-07				
Grid Connection Standards					IEEE1547, Rule 21, Rule 14 (HI)				
Emissions					FCC Part 15 Class B				
INSTALLATION SPECIFICATIONS									
AC Output Conduit Size / AWG Range					3/4" minimum / 14-6 AWG		3/4" minimum / 14-4 AWG		
DC Input Conduit Size / # of Strings / AWG Range					3/4" minimum / 1-2 strings / 14-6 AWG		3/4" minimum / 1-3 strings / 14-6 AWG		
Dimensions with Safety Switch (HxWxD)					17.7 x 14.6 x 6.8 / 450 x 370 x 174		21.3 x 14.6 x 7.3 / 540 x 370 x 185		
Weight with Safety Switch	22 / 10	25.1 / 11.4	26.2 / 11.9	38.8 / 17.6				lb / kg	
Noise					< 25		< 50		dBA
Cooling					Natural Convection		Natural convection		
Operating Temperature Range					-13 to +140 / -25 to +60 ⁽³⁾ (-40°F / -40°C option) ⁽⁴⁾				°F / °C
Protection Rating					NEMA 3R (Inverter with Safety Switch)				

⁽¹⁾ For other regional settings please contact SolarEdge support
⁽²⁾ Revenue grade inverter P/N: SExxxxH-US000MUC
⁽³⁾ For power de-rating information refer to: <https://www.solaredge.com/sites/default/files/se-te-temperature-derating-note-na.pdf>
⁽⁴⁾ -40 version P/N: SExxxxH-US000NNU4



© SolarEdge Technologies, Inc. All rights reserved. SOLAREEDGE, the SolarEdge logo, OPTIMIZED BY SOLAREEDGE are trademarks or registered trademarks of SolarEdge Technologies, Inc. All other trademarks mentioned herein are trademarks of their respective owners. Date: 07/2018/V01/ENG NAM. Subject to change without notice.



POWER HOME SOLAR, LLC
 "POWER YOUR FUTURE"
 919 N. MAIN ST.
 MOORESVILLE, NC 28115
 Phone: 704-800-6591 (OFFICE)
 Email: info@powerhome.com
 Web: www.powerhome.com

REVISIONS

DESCRIPTION	DATE	REV
INITIAL	20181812	

Signature with Seal

DATE: 12/18/2018

PROJECT NAME & ADDRESS

JEFFREY SOWELL
 RESIDENCE
 2861 HWY 401 S.,
 LILLINGTON, NC 27546

DESIGNED BY

PHS

SHEET NAME
 EQUIPMENT
 SPECIFICATION

SHEET SIZE

ANSI B
 11" X 17"

SHEET NUMBER

PV-8



Power Optimizer

P320 / P370 / P400 / P405 / P505



POWER OPTIMIZER

PV power optimization at the module-level

- Specifically designed to work with SolarEdge inverters
- Up to 25% more energy
- Superior efficiency (99.5%)
- Mitigates all types of module mismatch losses, from manufacturing tolerance to partial shading
- Flexible system design for maximum space utilization
- Fast installation with a single bolt
- Next generation maintenance with module-level monitoring
- Compliant with arc fault protection and rapid shutdown NEC requirements (when installed as part of the SolarEdge system)
- Module-level voltage shutdown for installer and firefighter safety

www.solaredge.us



Power Optimizer

P320 / P370 / P400 / P405 / P505

OPTIMIZER MODEL (typical module compatibility)	P320 (for high-power 60-cell modules)	P370 (for higher-power 60 and 72-cell modules)	P400 (for 72 & 96-cell modules)	P405 (for thin film modules)	P505 (for higher current modules)	
INPUT						
Rated Input DC Power ⁽¹⁾	320	370	400	405	505	W
Absolute Maximum Input Voltage (Voc at lowest temperature)	48	60	80	125	83	Vdc
MPPT Operating Range	8 - 48	8 - 60	8 - 80	12.5 - 105	12.5 - 83	Vdc
Maximum Short Circuit Current (Isc)	11		10.1		14	Adc
Maximum DC Input Current	13.75		12.63		17.5	Adc
Maximum Efficiency			99.5			%
Weighted Efficiency			98.8		98.6	%
Overvoltage Category			II			
OUTPUT DURING OPERATION (POWER OPTIMIZER CONNECTED TO OPERATING SOLAREGE INVERTER)						
Maximum Output Current			15			Adc
Maximum Output Voltage	60				85	Vdc
OUTPUT DURING STANDBY (POWER OPTIMIZER DISCONNECTED FROM SOLAREGE INVERTER OR SOLAREGE INVERTER OFF)						
Safety Output Voltage per Power Optimizer			1 ± 0.1			Vdc
STANDARD COMPLIANCE						
EMC	FCC Part 15 Class B, IEC61000-6-2, IEC61000-6-3					
Safety	IEC62109-1 (class II safety), UL1741					
RoHS	Yes					
INSTALLATION SPECIFICATIONS						
Maximum Allowed System Voltage	1000					Vdc
Compatible inverters	All SolarEdge Single Phase and Three Phase inverters					
Dimensions (W x L x H)	128 x 152 x 28 / 5 x 5.97 x 1.1	128 x 152 x 36 / 5 x 5.97 x 1.42	128 x 152 x 50 / 5 x 5.97 x 1.96	128 x 152 x 59 / 5 x 5.97 x 2.32		mm / in
Weight (including cables)	630 / 1.4	750 / 1.7	845 / 1.9	1064 / 2.3		gr / lb
Input Connector	MC4 ⁽²⁾					
Output Wire Type / Connector	Double Insulated; MC4					
Output Wire Length	0.95 / 3.0				1.2 / 3.9	m / ft
Operating Temperature Range	-40 - +85 / -40 - +185					°C / °F
Protection Rating	IP68 / NEMA6P					
Relative Humidity	0 - 100					%

⁽¹⁾ Rated STC power of the module. Module of up to +5% power tolerance allowed.

⁽²⁾ For other connector types please contact SolarEdge

PV SYSTEM DESIGN USING A SOLAREGE INVERTER ⁽³⁾⁽⁴⁾	SINGLE PHASE HD-WAVE		SINGLE PHASE	THREE PHASE 208V	THREE PHASE 480V	W
	P320, P370, P400 P405 / P505					
Minimum String Length (Power Optimizers)	8		10	18		
Maximum String Length (Power Optimizers)	6		8	14		
	25		25	50 ⁽⁵⁾		
Maximum Power per String	5700 (6000 with SE7600-US - SE11400- US)	5250	6000	12750		
Parallel Strings of Different Lengths or Orientations	Yes					

⁽³⁾ For detailed string sizing information refer to: http://www.solaredge.com/sites/default/files/string_sizing_na.pdf.

⁽⁴⁾ It is not allowed to mix P405/P505 with P320/P370/P400/P600/P700/P800 in one string.

⁽⁵⁾ A string with more than 30 optimizers does not meet NEC rapid shutdown requirements; safety voltage will be above the 30V requirement



© SolarEdge Technologies, Inc. All rights reserved. SOLAREGE, the SolarEdge logo, OPTIMIZED BY SOLAREGE are trademarks or registered trademarks of SolarEdge Technologies, Inc. All other trademarks mentioned herein are trademarks of their respective owners. Date: 07/2018/VD1/ENG NAM. Subject to change without notice.



POWER HOME SOLAR, LLC
"POWER YOUR FUTURE"
919 N. MAIN ST.
MOORESVILLE, NC 28115
Phone: 704-800-6591 (OFFICE)
Email: info@powerhome.com
Web: www.powerhome.com

REVISIONS		
DESCRIPTION	DATE	REV
INITIAL	20181812	

Signature with Seal

DATE: 12/18/2018

PROJECT NAME & ADDRESS

JEFFREY SOWELL
RESIDENCE
2861 HWY 401 S.,
LILLINGTON, NC 27546

DESIGNED BY
PHS

SHEET NAME
EQUIPMENT
SPECIFICATION

SHEET SIZE
ANSI B
11" X 17"

SHEET NUMBER
PV-9

XR Rail Family

Solar Is Not Always Sunny

Over their lifetime, solar panels experience countless extreme weather events. Not just the worst storms in years, but the worst storms in 40 years. High winds capable of ripping panels from a roof, and snowfalls weighing enough to buckle a panel frame.

XR Rails are the structural backbone preventing these results. They resist uplift, protect against buckling and safely and efficiently transfer loads into the building structure. Their superior spanning capability requires fewer roof attachments, reducing the number of roof penetrations and the amount of installation time.

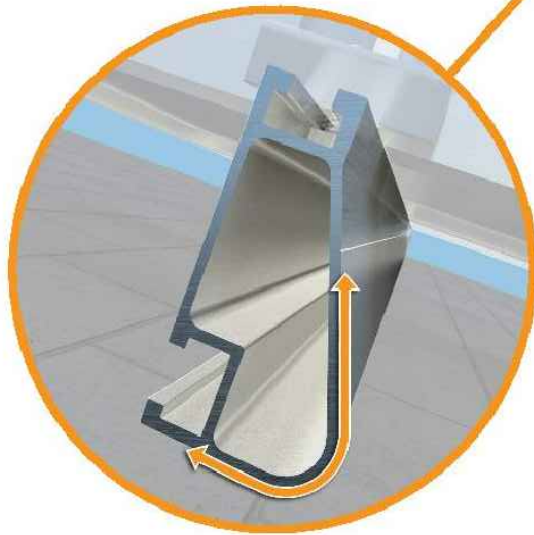
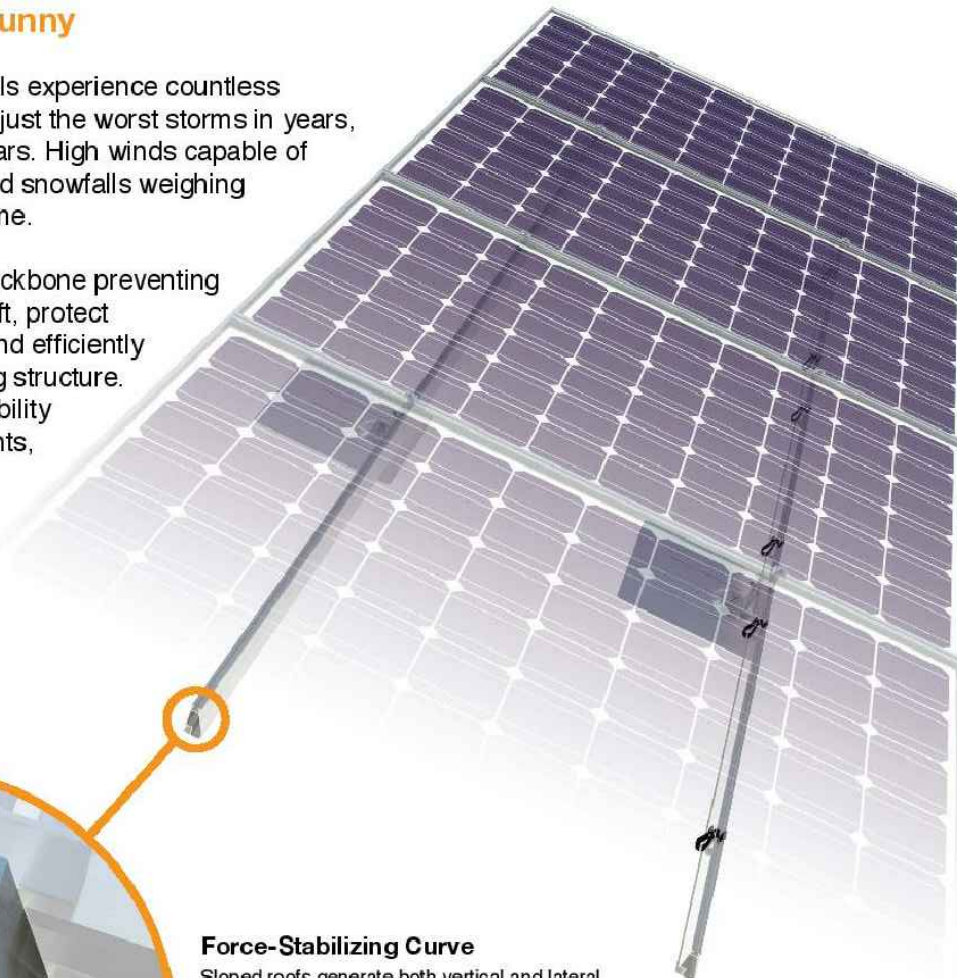

Force-Stabilizing Curve

Sloped roofs generate both vertical and lateral forces on mounting rails which can cause them to bend and twist. The curved shape of XR Rails is specially designed to increase strength in both directions while resisting the twisting. This unique feature ensures greater security during extreme weather and a longer system lifetime.

Compatible with Flat & Pitched Roofs



XR Rails are compatible with FlashFoot and other pitched roof attachments.



IronRidge offers a range of tilt leg options for flat roof mounting applications.

Corrosion-Resistant Materials

All XR Rails are made of marine-grade aluminum alloy, then protected with an anodized finish. Anodizing prevents surface and structural corrosion, while also providing a more attractive appearance.



XR Rail Family

The XR Rail Family offers the strength of a curved rail in three targeted sizes. Each size supports specific design loads, while minimizing material costs. Depending on your location, there is an XR Rail to match.



XR10

XR10 is a sleek, low-profile mounting rail, designed for regions with light or no snow. It achieves 6 foot spans, while remaining light and economical.

- 6' spanning capability
- Moderate load capability
- Clear anodized finish
- Internal splices available



XR100

XR100 is the ultimate residential mounting rail. It supports a range of wind and snow conditions, while also maximizing spans up to 8 feet.

- 8' spanning capability
- Heavy load capability
- Clear & black anodized finish
- Internal splices available



XR1000

XR1000 is a heavyweight among solar mounting rails. It's built to handle extreme climates and spans 12 feet or more for commercial applications.

- 12' spanning capability
- Extreme load capability
- Clear anodized finish
- Internal splices available

Rail Selection

The following table was prepared in compliance with applicable engineering codes and standards. Values are based on the following criteria: ASCE 7-10, Roof Zone 1, Exposure B, Roof Slope of 7 to 27 degrees and Mean Building Height of 30 ft. Visit IronRidge.com for detailed span tables and certifications.

Load		Rail Span					
Snow (PSF)	Wind (MPH)	4'	5' 4"	6'	8'	10'	12'
None	100						
	120						
	140	XR10		XR100		XR1000	
	160						
10-20	100						
	120						
	140						
	160						
30	100						
	160						
40	100						
	160						
50-70	160						
80-90	160						

REVISIONS

DESCRIPTION	DATE	REV
INITIAL	20181812	

Signature with Seal

DATE: 12/18/2018

PROJECT NAME & ADDRESS

JEFFREY SOWELL
 RESIDENCE
 2861 HWY 401 S.,
 LILLINGTON, NC 27546

DESIGNED BY

PHS

SHEET NAME

EQUIPMENT
 SPECIFICATION

SHEET SIZE

ANSI B
 11" X 17"

SHEET NUMBER

PV-10

Simplified Grounding for Every Application

The UFO family of components eliminates the need for separate grounding hardware by bonding solar modules directly to IronRidge XR Rails. All system types that feature the UFO family—Flush Mount, Tilt Mount and Ground Mount—are fully listed to the UL 2703 standard.

UFO hardware forms secure electrical bonds with both the module and the rail, resulting in many parallel grounding paths throughout the system. This leads to safer and more reliable installations.

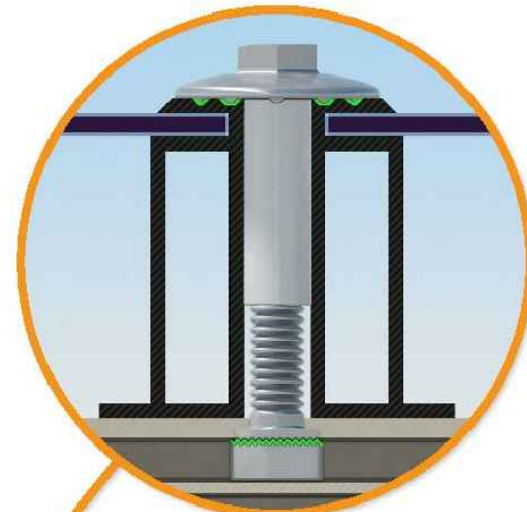

Universal Fastening Object (UFO)
The UFO securely bonds solar modules to XR Rails. It comes assembled and lubricated, and can fit a wide range of module heights.



Stopper Sleeve
The Stopper Sleeve snaps onto the UFO, converting it into a bonded end clamp.



Bonded Splice
Each Bonded Splice uses self-drilling screws to form a secure connection. No bonding strap needed.



Grounding Lug
A single Grounding Lug connects an entire row of PV modules to the grounding conductor.



Bonded Attachments
The bonding bolt attaches and bonds the L-foot to the rail. It is installed with the same socket as the rest of the system.

System Diagram

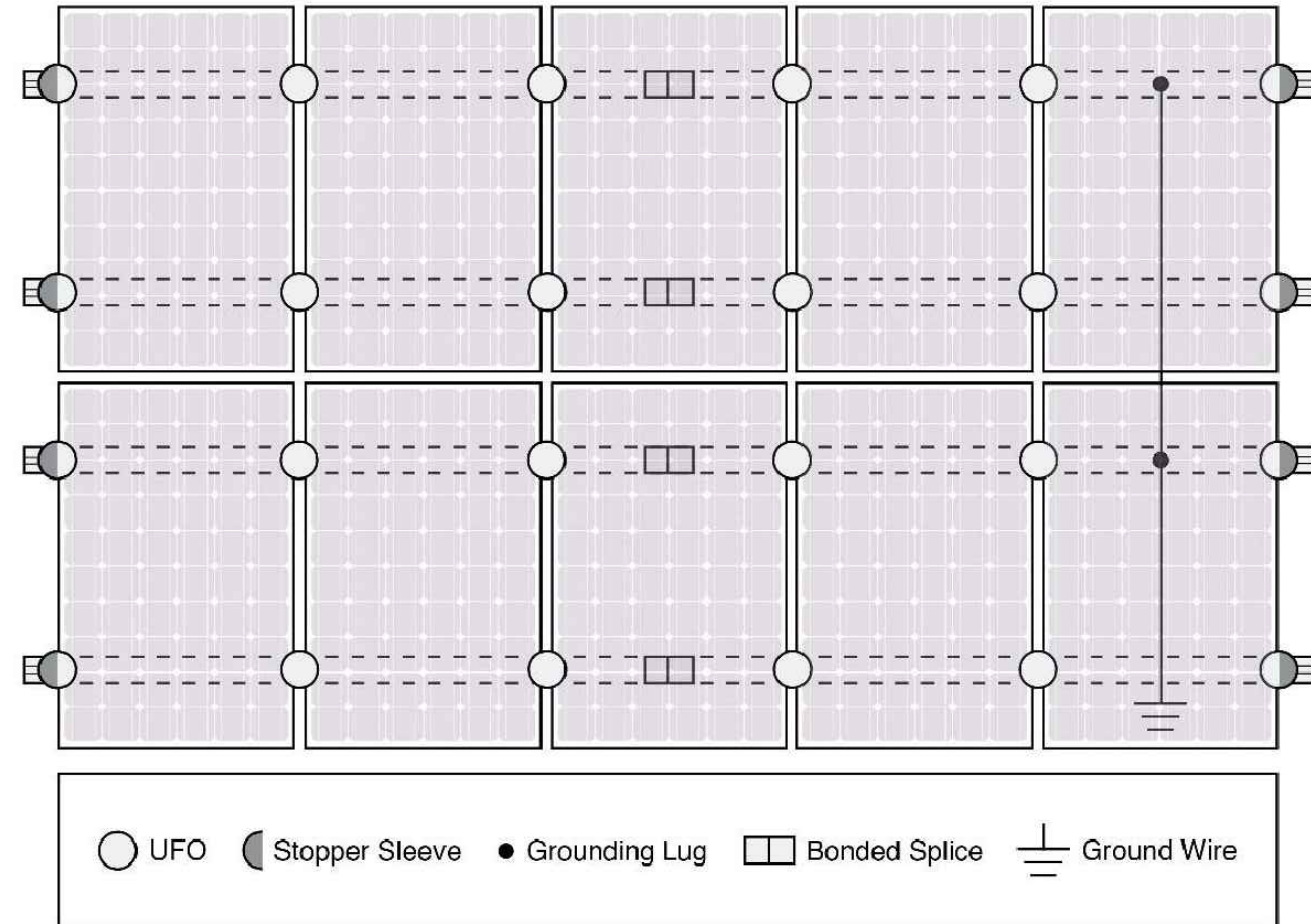

⚠ Approved Enphase microinverters can provide equipment grounding of IronRidge systems, eliminating the need for grounding lugs and field installed equipment ground conductors (EGC). A minimum of two microinverters mounted to the same rail and connected to the same Engage cable is required. Refer to installation manuals for additional details.

UL Certification

The IronRidge Flush Mount, Tilt Mount, and Ground Mount Systems have been listed to UL 2703 by Intertek Group plc.

UL 2703 is the standard for evaluating solar mounting systems. It ensures these devices will maintain strong electrical and mechanical connections over an extended period of time in extreme outdoor environments.

[Go to IronRidge.com/UFO](http://www.ironridge.com/UFO)

Cross-System Compatibility			
Feature	Flush Mount	Tilt Mount	Ground Mount
XR Rails	✓	✓	XR1000 Only
UFO/Stopper	✓	✓	✓
Bonded Splice	✓	✓	N/A
Grounding Lugs	1 per Row	1 per Row	1 per Array
Microinverters & Power Optimizers	Enphase - M250-72, M250-60, M215-60, C250-72 Darfon - MIG240, MIG300, G320, G640 SolarEdge - P300, P320, P400, P405, P600, P700, P730		
Fire Rating	Class A	Class A	N/A
Modules	Tested or Evaluated with over 400 Framed Modules Refer to installation manuals for a detailed list.		

REVISIONS		
DESCRIPTION	DATE	REV
INITIAL	20181812	

Signature with Seal

DATE: 12/18/2018

PROJECT NAME & ADDRESS

JEFFREY SOWELL
RESIDENCE
2861 HWY 401 S.,
LILLINGTON, NC 27546

DESIGNED BY
PHS

SHEET NAME
EQUIPMENT SPECIFICATION

SHEET SIZE
ANSI B
11" X 17"

SHEET NUMBER
PV-11

Low Profile QuickBOLT™



Part #	Box Quantity	Size
17667	10 Washers; 10 Bolts; 10 Offset L-Foots; 10 Serrated Hex Flange Nuts	5/16" x 3"; 5/16" x 5.25"; NA; 5/16"



LOW PROFILE QUICKBOLT™ INSTALLATION INSTRUCTIONS

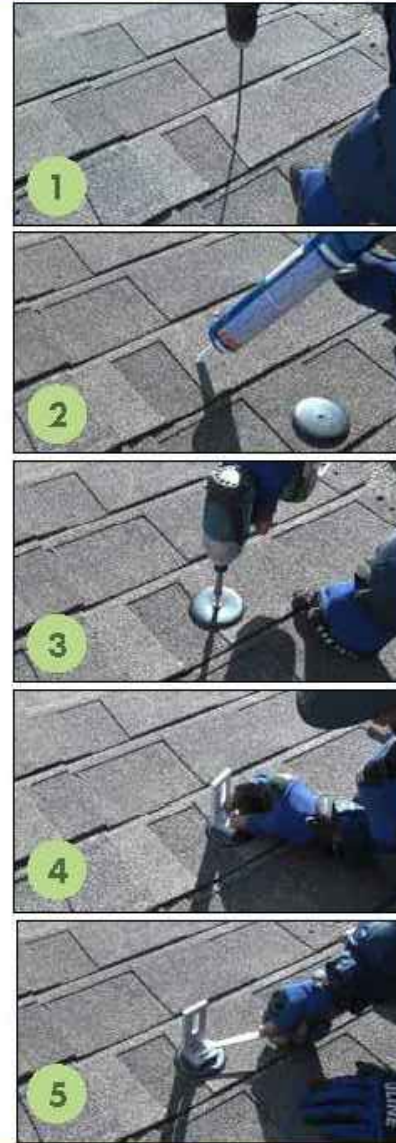

RECOMMENDED MATERIALS

- Rafter locator
- Chalk or crayon
- 3/16" Drill Bit
- Roofing Manufacturer's approved sealant

INSTALLATION INSTRUCTIONS

1. Locate and mark the rafters.
2. Pre-drill the hole with the 3/16" Drill Bit.
3. Fill the pre-drilled hole with sealant.
*We also recommend creating a circle of sealant on the back of the washer.
4. Place the EPDM Washer & drive the Bolt until the Washer compresses to the roof.
5. Place the L-Foot & Nut.
6. Tighten the Nut until the L-Foot is secure.

WHERE IS MY FLASHING?

The Stainless Steel backed EPDM Washer is fully Code-Compliant and does not require additional Sheet Metal Flashing. The collar on the QuickBOLT™ compresses the washer down onto the roof, forming a 100% leak-proof seal.

5830 Las Positas Road, Livermore, California 94551 | 3948 Airway Drive, Rock Hill, South Carolina 29732
 Phone: (844)-671-6045 | Fax: (800)-689-7975 | www.solarroofhook.com
 SolarRoofHook is a division of Quickscrews International Corp.

INSTALLATION VIDEOS, SPEC SHEETS, & TEST RESULTS AVAILABLE ON
WWW.SOLARROOFHOOK.COM

POWERHOME SOLAR & ROOFING
 POWER HOME SOLAR, LLC
 "POWER YOUR FUTURE"
 919 N. MAIN ST.
 MOORESVILLE, NC 28115
 Phone: 704-800-6591 (OFFICE)
 Email: info@powerhome.com
 Web: www.powerhome.com

REVISIONS		
DESCRIPTION	DATE	REV
INITIAL	20181812	

Signature with Seal

DATE: 12/18/2018

PROJECT NAME & ADDRESS

**JEFFREY SOWELL
 RESIDENCE**
 2861 HWY 401 S.,
 LILLINGTON, NC 27546

DESIGNED BY

PHS

SHEET NAME

**EQUIPMENT
 SPECIFICATION**

SHEET SIZE

**ANSI B
 11" X 17"**

SHEET NUMBER

PV-11