



Initial Application Date: 11/15/18

Application # ERES1811-0024

CU# _____

COUNTY OF HARNETT RESIDENTIAL LAND USE APPLICATION

Central Permitting 108 E. Front Street, Lillington, NC 27546 Phone: (910) 893-7525 ext:2 Fax: (910) 893-2793 www.harnett.org/permits

A RECORDED SURVEY MAP, RECORDED DEED (OR OFFER TO PURCHASE) & SITE PLAN ARE REQUIRED WHEN SUBMITTING A LAND USE APPLICATION

LANDOWNER: Nathan Teach Mailing Address: 734 Wire Road

City: Bunnlevel State: NC Zip: 28323 Contact No: 334-406-1283 Email: nate.teach81@ymail.com

APPLICANT: Energy Conservation Solutions Mailing Address: 116 Gasoline Alley Suite 105

City: Mooresville State: NC Zip: 28117 Contact No: 704-230-0498 Email: mloper@ecs.solar

*Please fill out applicant information if different than landowner

CONTACT NAME APPLYING IN OFFICE: Marianne Loper - ECS Solar Phone # 704-230-0498 ext.127

ADDRESS: 734 Wire Rd PIN: 0566-07-5035.000

DEED OR OTP: 3356/348

PROPOSED USE:

SFD: (Size ___x___) # Bedrooms:___ # Baths:___ Basement(w/wo bath): Garage: Deck: Crawl Space: Slab: Monolithic Slab:
(Is the bonus room finished? yes no w/ a closet? yes no (if yes add in with # bedrooms)

Mod: (Size ___x___) # Bedrooms___ # Baths___ Basement (w/wo bath) Garage: Site Built Deck: On Frame Off Frame
(Is the second floor finished? yes no Any other site built additions? yes no

Manufactured Home: SW DW TW (Size ___x___) # Bedrooms: ___ Garage: (site built? Deck: site built?

Duplex: (Size ___x___) No. Buildings: _____ No. Bedrooms Per Unit: _____

Home Occupation: # Rooms: _____ Use: _____ Hours of Operation: _____ #Employees: _____

Addition/Accessory/Other: (Size 36.4ft x 10ft) Use: Ground Mounted Solar Panel Array Closets in addition? yes no

Water Supply: County _____ Existing Well _____ New Well (# of dwellings using well _____) *Must have operable water before final
(Need to Complete New Well Application at the same time as New Tank)

Sewage Supply: _____ New Septic Tank _____ Expansion _____ Relocation Existing Septic Tank _____ County Sewer
(Complete Environmental Health Checklist on other side of application if Septic)

Does owner of this tract of land, own land that contains a manufactured home within five hundred feet (500') of tract listed above? yes no

Does the property contain any easements whether underground or overhead yes no

Structures (existing or proposed): Single family dwellings: Manufactured Homes: _____ Other (specify): Solar array

If permits are granted I agree to conform to all ordinances and laws of the State of North Carolina regulating such work and the specifications of plans submitted. I hereby state that foregoing statements are accurate and correct to the best of my knowledge. Permit subject to revocation if false information is provided.

Marianne Loper - Marianne Loper 11/15/18
Signature of Owner or Owner's Agent Date

It is the owner/applicants responsibility to provide the county with any applicable information about the subject property, including but not limited to: boundary information, house location, underground or overhead easements, etc. The county or its employees are not responsible for any incorrect or missing information that is contained within these applications.

This application expires 6 months from the initial date if permits have not been issued

APPLICATION CONTINUES ON BACK

strong roots • new growth

strong roots • new growth



****This application expires 6 months from the initial date if permits have not been issued****

This application to be filled out when applying for a septic system inspection.

County Health Department Application for Improvement Permit and/or Authorization to Construct

IF THE INFORMATION IN THIS APPLICATION IS FALSIFIED, CHANGED, OR THE SITE IS ALTERED, THEN THE IMPROVEMENT PERMIT OR AUTHORIZATION TO CONSTRUCT SHALL BECOME INVALID. The permit is valid for either 60 months or without expiration depending upon documentation submitted. (Complete site plan = 60 months; Complete plat = without expiration)

Environmental Health New Septic System

- **All property irons must be made visible.** Place "pink property flags" on each corner iron of lot. All property lines must be clearly flagged approximately every 50 feet between corners.
- Place "orange house corner flags" at each corner of the proposed structure. Also flag driveways, garages, decks, out buildings, swimming pools, etc. Place flags per site plan developed at/for Central Permitting.
- Place orange Environmental Health card in location that is easily viewed from road to assist in locating property.
- If property is thickly wooded, Environmental Health requires that you clean out the undergrowth to allow the soil evaluation to be performed. Inspectors should be able to walk freely around site. **Do not grade property.**
- **All lots to be addressed within 10 business days after confirmation. \$25.00 return trip fee may be incurred for failure to uncover outlet lid, mark house corners and property lines, etc. once lot confirmed ready.**

Environmental Health Existing Tank Inspections

- Follow above instructions for placing flags and card on property.
- Prepare for inspection by removing soil over **outlet end** of tank as diagram indicates, and lift lid straight up (if possible) and then **put lid back in place.** (Unless inspection is for a septic tank in a mobile home park)
- **DO NOT LEAVE LIDS OFF OF SEPTIC TANK**

"MORE INFORMATION MAY BE REQUIRED TO COMPLETE ANY INSPECTION"

SEPTIC

If applying for authorization to construct please indicate desired system type(s): can be ranked in order of preference, must choose one.

- Accepted Innovative Conventional Any
 Alternative Other _____

The applicant shall notify the local health department upon submittal of this application if any of the following apply to the property in question. If the answer is "yes", applicant **MUST ATTACH SUPPORTING DOCUMENTATION**:

- YES NO Does the site contain any Jurisdictional Wetlands?
 YES NO Do you plan to have an irrigation system now or in the future?
 YES NO Does or will the building contain any drains? Please explain. _____
 YES NO Are there any existing wells, springs, waterlines or Wastewater Systems on this property?
 YES NO Is any wastewater going to be generated on the site other than domestic sewage?
 YES NO Is the site subject to approval by any other Public Agency?
 YES NO Are there any Easements or Right of Ways on this property?
 YES NO Does the site contain any existing water, cable, phone or underground electric lines?

If yes please call No Cuts at 800-632-4949 to locate the lines. This is a free service.

I Have Read This Application And Certify That The Information Provided Herein Is True, Complete And Correct. Authorized County And State Officials Are Granted Right Of Entry To Conduct Necessary Inspections To Determine Compliance With Applicable Laws And Rules. I Understand That I Am Solely Responsible For The Proper Identification And Labeling Of All Property Lines And Corners And Making The Site Accessible So That A Complete Site Evaluation Can Be Performed.



ECS Solar
Energy Conservation Solutions

CONTRACTOR INFORMATION:

ENERGY CONSERVATION SOLUTIONS
116 GASOLINE ALLEY, SUITE 105
MOORESVILLE, NC 28117

SITE INFORMATION:

Nathan Teach
734 Wire Rd, Bunnlevel, North Carolina 28323
DC SYSTEM SIZE: 5.8 kW DC

(20) Sunmodule Plus SWA 290M PV MODULES
(20) Enphase IQ6-60-2-US MICRO INVERTER(S)

DATE: November 15, 2018

PAGE: SHEET NAME:
PV02 PROPERTY PLAN
DRAWN BY: VERSION:
SoloCAD 0

EQUIPMENT LEGEND:

- UTILITY METER
- MAIN SERVICE PANEL
- VISIBLE, LOCKABLE, LABELED AC DISCONNECT
- METER SOCKET (FOR UTILITY PV METER)
- INVERTER
- COMBINER BOX
- LOAD CENTER
- FIRE SETBACK (3' TYP)
- PROPERTY LINE

VISIBLE, LOCKABLE, LABELED AC DISCONNECT LOCATED WITHIN 10' OF UTILITY METER

TRENCHING THROUGH DIRT APPROX. 78' 1" PVC, MIN 18" DEEP

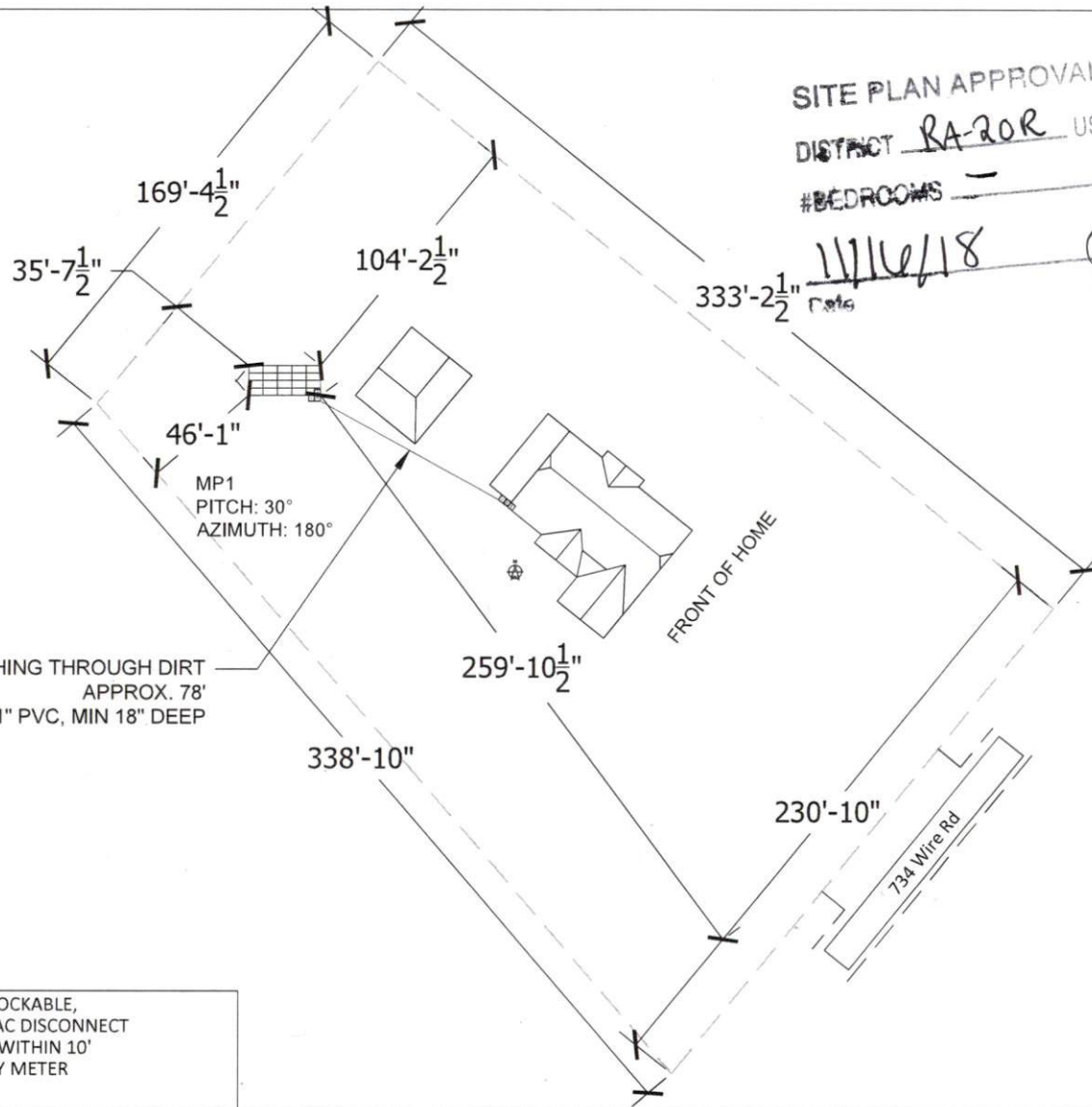

SITE PLAN APPROVAL

DISTRICT RA-20R USE Solar Array

#BEDROOMS -

11/16/18
Date

Grand Mant Solar Array

[Signature]
Zoning Administrator

Application # _____

Harnett County Central Permitting
PO Box 65 Lillington, NC 27546 - Ph: 910-893-7525 - Fx: 910-893-2793 - www.harnett.org/permits
Certification of Work Performed By Owner/Contractor
(Individual Trade Application)

Owner (s) of Structure: Nathan Teach Phone: 334-406-1283

Owner (s) Mailing Address: 734 Wire Road
Bunnlevel, NC 28323

Land Owner Name (s): Nathan Teach Phone: 334-406-1283

Construction or Site Address: 734 Wire Road Bunnlevel, NC 28323

PIN # 0566-07-5035 Parcel # 120566 0162 01

Job Cost: \$36,005.00 Description of Work to be done Installation ~~and wiring~~ of 20 solar modules in a ground mounted array structure

Mechanical: New Unit With Ductwork New Unit Without Ductwork Gas Piping Other

Electrical*: 200 Amp <200 Amp Service Change Service Reconnect Other
* For Progress Energy customers we need the premise number

Plumbing: Water/Sewer Tap Number of Baths Water Heater

Specific Directions to Job from Lillington:
West on E Front St toward S 1st St. Left on US401S, Right on McNeill Hobbs Road, Left onto Wire Road.
Destination will be on right

Subdivision: _____ Lot #: _____

I Kelly Miles will provide the building labor on this structure.
(Contractors Name) (Trade)

I am the building owner or my NC state license number is 79319, which entitles me to perform such work on the above structure legally. All work shall comply with the State Building Code and all other applicable State and local laws, ordinances and regulations.

Energy Conservation Solutions
Contractor's Company Name
116 Gasoline Alley Suite 105 Mooresville, NC 28117
Address
79319
License #

704-230-0498
Telephone
mloper@ecs.solar
Email Address

Structure Owner / Contractor Signature: *K Kelly Miles* Date: 11/15/18

By signing this application you affirm that you have obtained permission from the above listed license holder to purchase permits on their behalf. If doing the work as owner you understand that you cannot rent, lease or sell the listed property for 12 months after completion of the listed work.

***Company name, address, & phone must match information on license**

Application # _____

Harnett County Central Permitting

PO Box 65 Lillington, NC 27546 - Ph: 910-893-7525 - Fx: 910-893-2793 - www.harnett.org/permits
Certification of Work Performed By Owner/Contractor
(Individual Trade Application)

Owner (s) of Structure: Nathan Teach Phone: 334-406-1283

Owner (s) Mailing Address: 734 Wire Road
Bunnlevel, NC 28323

Land Owner Name (s): Nathan Teach Phone: 334-406-1283

Construction or Site Address: 734 Wire Road Bunnlevel, NC 28323

PIN # 0566-07-5035 Parcel # 120566 0162 01

Job Cost: \$950.00 Description of Work to be done Wiring of 20 solar modules in a
ground mounted array structure

Mechanical: New Unit With Ductwork New Unit Without Ductwork Gas Piping Other

Electrical*: 200 Amp <200 Amp Service Change Service Reconnect Other
* For Progress Energy customers we need the premise number

Plumbing: Water/Sewer Tap Number of Baths Water Heater

Specific Directions to Job from Lillington:
West on E Front St toward S 1st St. Left on US401S, Right on McNeill Hobbs Road, Left onto Wire Road.
Destination will be on right

Subdivision: _____ Lot #: _____

I Jason Rogers will provide the Electrical labor on this structure.
(Contractors Name) (Trade)

I am the building owner or my NC state license number is L32644, which entitles me to perform such work on the above structure legally. All work shall comply with the State Building Code and all other applicable State and local laws, ordinances and regulations.

Thompson and Son Energy Solutions
Contractor's Company Name
852 Turning Point Lane Concord, NC 28027
Address
L32644
License #

704-526-9303
Telephone
info@thompsonandsonenergy.com
Email Address

Structure Owner / Contractor Signature: Jason Rogers Date: 11/15/2018 3:21:54 PM EST

By signing this application you affirm that you have obtained permission from the above listed license holder to purchase permits on their behalf. If doing the work as owner you understand that you cannot rent, lease or sell the listed property for 12 months after completion of the listed work.

***Company name, address, & phone must match information on license**