

II IMPROVEMENT PERM

Be it ordained by the Harnett County Board of Health as follows: Section III, Item B. "No Person shall begin construction of any building at which a septic tank system is to be used for disposal of sewage without first obtaining a written permit from the Harnett County Health Department."

Name: (owner) Rodger Early ☒ New Installation ☒ Septic Tank
Property Location: SR# 1106 ☐ Repairs ☒ Nitrification Line
Hillmon Grove Rd.

Subdivision _____ Lot # 2

Tax ID # _____ Quadrant # _____

Number of Bedrooms Proposed: 3 Lot Size: 4.48 AC.

Basement with Plumbing: ☐ Garage: ☐

Water Supply: ☐ Well ☒ Public ☐ Community

Distance From Well: _____ ft.

Following is the minimum specifications for sewage disposal system on above captioned property. Subject to final approval.

Type of system: ☒ Conventional ☐ Other _____

Size of tank: Septic Tank: 900 gallons Pump Tank: _____ gallons

Subsurface No. of exact length width of depth of
Drainage Field ditches 2 of each ditch 75 ft. ditches 3 ft. ditches 36 in.

French Drain Required: _____ Linear feet

Date: 7-19-97

This permit is subject to revocation if site plans or intended use change.

Signed: Jeff Early
Environmental Health Specialist

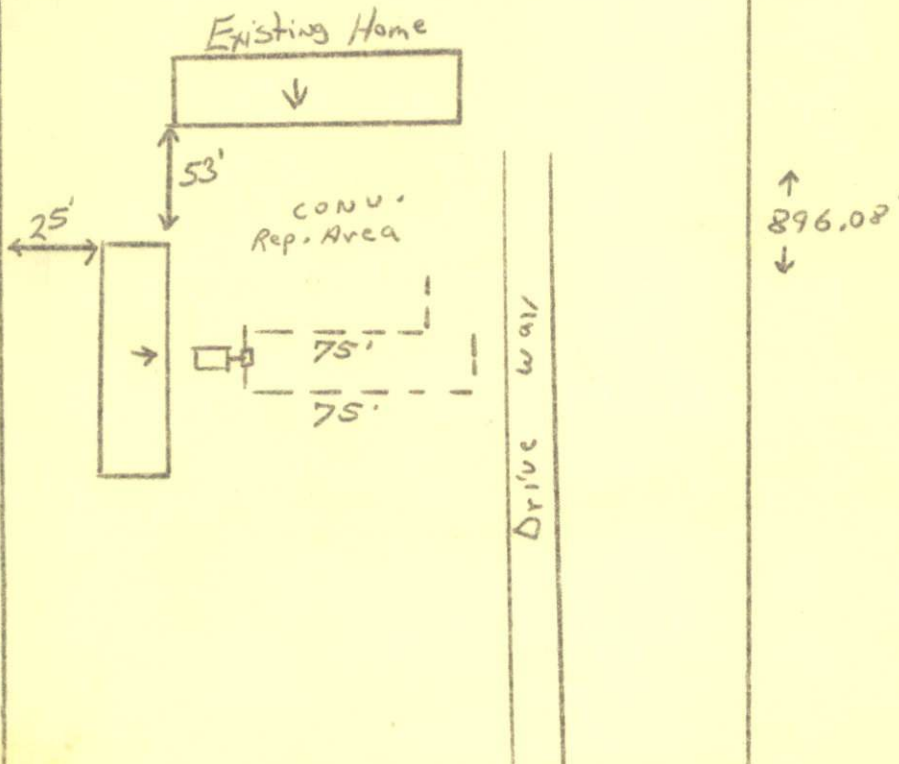

Hwy

HARNETT COUNTY HEALTH DEPARTMENT
AUTHORIZATION TO CONSTRUCT

Authorization is hereby given to construct a wastewater system to the specifications described by Harnett County Health Department Improvement Permit # 12341. This authorization shall be valid for a period not to exceed five (5) years from the date of issuance. This authorization will be invalid if ownership, site plans, or intended use change.

Owner or Authorized Agent Rodger Early

Name: _____ Telephone # 499-9309

Address: Cameron N.C.

Property Location: SR # 1106 Road Name Hillman Grove Rd.

New Installation ☒ Repair ☐ Septic Tank ☒ Nitrification Lines ☒

Subdivision _____ Lot # 2

Number of Bedrooms Proposed: 3 Lot size: 4.48

Basement ☐ With Plumbing ☐ Without Plumbing ☐

Water Supply: Well ☐ Public ☒ Minimum Well Setback: _____ ft.

Type of System: Conventional ☒ Other ☐

Tank Volume: Septic Tank 900 gallons Pump Chamber _____ gallons

Nitrification Field Specifications

Number of fields 1 Number of Lines per Field 3 Length of lines 2 at 75'

Width of ditches 3 ft. Depth of ditches 36 inches

French Drain: Linear feet required _____ Depth of gravel _____

No wastewater system shall be covered or placed into use by any person until an inspection by the Harnett County Health Department has determined that the system has been installed according to the conditions of the improvement permit and that a valid operations permit has been issued.

Authorized Agent for Harnett County Health Department

Name: Jeff Eudy Date: 7-19-97