

ARNETT COUNTY HEALTH DEPARTMENT

ENVIRONMENTAL HEALTH SECTION, PO BOX 09, LILLINGTON, NC 27546
APPLICATION FOR REPAIR

Repair

DATE JAN 13, 1997

NAME MANUEL J ENOS TELEPHONE NO. 497-2467

ADDRESS (current) 4122 HAY 210N SPRING LAKE NC 27390

PROPERTY OWNER SELF

SUBDIVISION NAME _____ LOT NO. _____

STATE ROAD NAME _____ STATE ROAD NO. NC 210

LOCATION OF PROPERTY:

SIZE OF LOT OR TRACT 100' X ¹⁶⁰/₃₀'

DIRECTIONS NORTH ON NC 210 FROM SPRING LAKE NC
(4 MILES) SOUTH ON NC 210 FROM LILLINGTON NC (14 MILES)
past Ray Rd about 4 houses on left - across flea market

brick & cream & dark trim house
Type of dwelling BRICK VENEER Basement with plumbing NO
Number of bedrooms 3 Garage NO
Dishwasher NO Garbage disposal NO

WATER SUPPLY: PRIVATE WELL _____ COMMUNITY SYSTEM _____ COUNTY ✓

1) A surveyed and recorded map must be attached to this application along with a site plan showing: 1) Location of dwelling, 2) Location of driveway, 3) Location of any wells and other existing structures. A copy of the deed must also be attached.

2) The outlet end of the tank and distribution box will need to be uncovered and property lines marked. After the tank is uncovered and property lines are marked, you will need to call us at 893-7547 or 893-7548 and let us know that it is ready.

3) The system must be repaired in the set time of violation letter or if there is no violation letter, then it needs to be repaired within 30 days.

This certifies that all of the above information is correct to the best of my knowledge. False information will result in the denial of the permit. The permit is subject to revocation if the site plan, intended use, or ownership change.

Signature of Owner or
Authorized Agent ONLY

Manuel Enos

dogs!

Call En - 2-2298

JW

copy #281
1-14-98

met Owner onsite 2-7-98 - Soil test - started repairing well call back when sun shines

Homeowner Interview Form

Name: _____ Date: _____

Address: _____ Phone: (H) _____

(W) _____

Installer of System: _____

Septic Tank Pumper: _____

Designer of System: _____

1. Number of people who live in the house: 2

How many adults: 2 How many children: _____

2. What is your average daily water usage? _____

3. Do you have a garbage disposal? NO

How often do you use it? _____

4. When was the septic tank last pumped? JAN 12, 1998

How often do you have it pumped? _____

5. Do you have a dishwashing machine? NO

How often do you use it? _____

6. Do you have a clothes washing machine? YES

How often do you use it? 2 TIMES A WEEK

7. Do you have a water softener or water treatment system? NO

Where does it drain? _____

8. Do you use an "in the tank" toilet bowl sanitizer? NO

9. Is any family member using a (long term) prescription drug, antibiotics or chemotherapy? NO

What kinds? _____

10. Are any household cleaning chemicals put down the drain? YES

What kinds? WAX, DETERGENT

11. Are any chemicals (paints, thinners, etc.) disposed down the drain? NO

What kinds? _____

12. Have any new water using fixtures been added since the system was installed? NO

What kinds? _____

List plumbing fixtures (like spas, whirlpools) other than sinks, lavatories,
bath/showers and toilets: _____

13. Do you have an underground lawn-watering system? NO

14. Has any site work been done to the house since you moved in, such as underground roof
gutter drains, basement/foundation drains, landscaping, etc.? NO

What kinds? _____

15. Are there any underground utilities on your lot? YES

Check which types:

Power ☒ Phone _____ Cable _____ Gas _____ Water _____

16. Describe what happens when you have a problem with your septic tank system.

DRAIN FIELD IS CLOGGED.

When did you first notice the problem? JAN 12, 1998

Does the problem seem to be linked to a specific event (washing clothes, heavy rains, company
coming over, etc.)?

NO

Mail To:

WARRANTY DEED-Form WD-601

Printed and for sale by James Williams & Co., Inc., Yadkinville, N. C.

STATE OF NORTH CAROLINA, Harnett County.

THIS DEED, Made this 29 day of May, 19 75, by and between ELIZABETH J. BURCH

and state of North Carolina, hereinafter called Grantor, and MANUEL JOSEPH ENOS and wife, County

NELLIE RUTH ENOS of Cumberland County and State of North Carolina, hereinafter called Grantee.

WITNESSETH: That the Grantor, for and in consideration of the sum of Ten (\$10.00) Dollars and other good and valuable considerations to him in hand paid by the Grantee, the receipt whereof is hereby acknowledged, has given, granted, bargained, sold and conveyed, and by these presents does give, grant, bargain, sell, convey and confirm unto the Grantee, his heirs and/or successors and assigns, premises in Anderson Creek Township, Harnett County, North Carolina, described as follows:

BEING Lot #11, Block A, Resurvey of Lots 11, 12, 13 and 15, Block A, Section I, of the Harnett Lakes Subdivision, as surveyed by J. P. McMillan, Jr., and as recorded in Map Book 11, Page 83, office of the Register of Deeds of Harnett County.

As a part of the consideration for this conveyance, the party of the second part herein assumes and agrees to pay the outstanding balance of that certain note secured by a deed of trust to Curtis E. Martin, Inc. in the original amount of \$13,500.00, dated September 27, 1965, and recorded in Book 473, page 23, Harnett County Registry.

TRANSFER RECORDED IN THE
OFFICE OF HARNETT COUNTY
TAX SUPERVISOR

ON June 9, 1975
TAX SUPERVISOR

BY Thomas Allen
X



6240589

The above land was conveyed to Grantor by Sybil Judd. See Book No. 623, Page 459.
TO HAVE AND TO HOLD The above described premises, with all the appurtenances thereunto belonging, or in any wise appertaining, unto the Grantee, his heirs and/or successors and assigns forever.

And the Grantor covenants that he is seized of said premises in fee, and has the right to convey the same in fee simple; that said premises are free from encumbrances (with the exceptions above stated, if any); and that he will warrant and defend the said title to the same against the lawful claims of all persons whomsoever.

When reference is made to the Grantor or Grantee, the singular shall include the plural and the masculine shall include the feminine or the neuter.

IN WITNESS WHEREOF, The Grantor has hereunto set his hand and seal, the day and year first above written.

[Signature] (SEAL) Elizabeth J. Burch (SEAL)

STATE OF NORTH CAROLINA CUMBERLAND COUNTY.

I, Annie Grace Jones

Elizabeth J. Burch

, a Notary Public of said County, do hereby certify that

Grantor, personally appeared before me this day and acknowledged the execution of the foregoing deed.

Witness my hand and notarial seal, this the 30th day of May

My Commission Expires: February 11, 1978

Annie Grace Jones, N.P. (SEAL)

STATE OF NORTH CAROLINA Harnett COUNTY.

I, _____, a Notary Public of said County, do hereby certify that

Grantor, personally appeared before me this day and acknowledged the execution of the foregoing deed.

Witness my hand and notarial seal, this the _____ day of _____

My Commission Expires: _____

, N.P. (SEAL)

STATE OF NORTH CAROLINA, Harnett COUNTY.

The foregoing certificate(s) of Annie Grace Jones

is (are) certified to be correct. This instrument was presented for registration this 9 day of June

show
 water line
 check fee
 mail permit

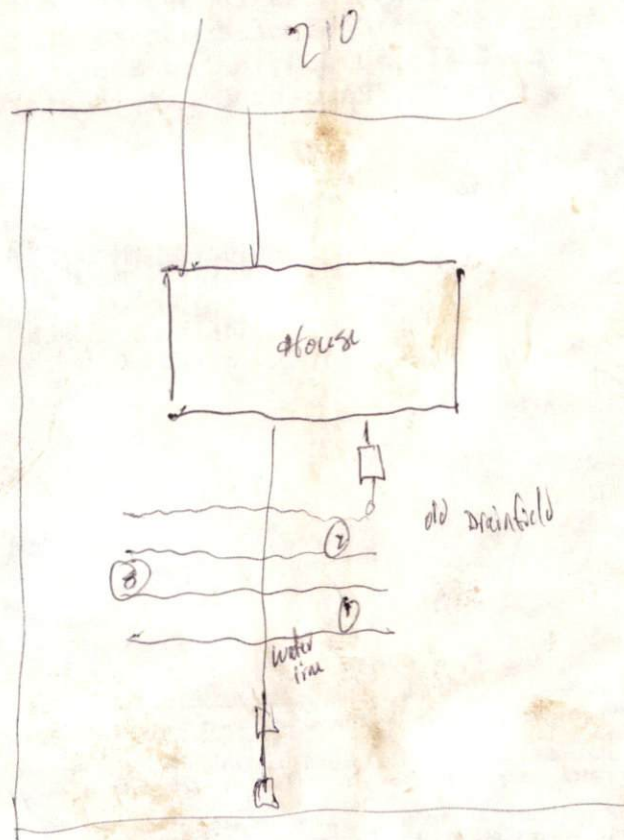

① 0-24LS
 24-36 SCL

② 0-24LS .5-.6
 24-36 SCL

③ 0-28LS
 28-36 SCL

150-180
 9000 GSS
 18-24"