

## IMPROVEMENT PERM

Be it ordained by the Harnett County Board of Health as follows: Section III, Item B. "No Person shall begin construction of any building at which a septic tank system is to be used for disposal of sewage without first obtaining a written permit from the Harnett County Health Department."

Name: (owner) Roger Dupree ☒ New Installation ☒ Septic Tank  
 Property Location: SR# 1505 ☐ Repairs ☒ Nitrification Line

Subdivision \_\_\_\_\_ Lot # \_\_\_\_\_

Tax ID # \_\_\_\_\_ Quadrant # \_\_\_\_\_

Number of Bedrooms Proposed: 23, avg cost camp @ 60g = 1680gpd Lot Size: 36.18 ac

Basement with Plumbing: ☐ Garage: ☐

Water Supply: ☐ Well ☒ Public ☐ Community

Distance From Well: 50ft ft.

Following is the minimum specifications for sewage disposal system on above captioned property. Subject to final approval.

Type of system: ☒ Conventional 1500 Pump Tank ☒ Other Pressure Manifold

Size of tank: Septic Tank: 1000 Septic gallons Pump Tank: 1500 gallons

Subsurface No. of exact length width of depth of  
 Drainage Field ditches 5 of each ditch 150 ft. ditches 3 ft. ditches 18-24 in.

French Drain Required: \_\_\_\_\_ Linear feet

This permit is subject to revocation if site plans or intended use change.

Date: 12-9-97

Signed: Thomas J. Boyer, D.S.

Environmental Health Specialist

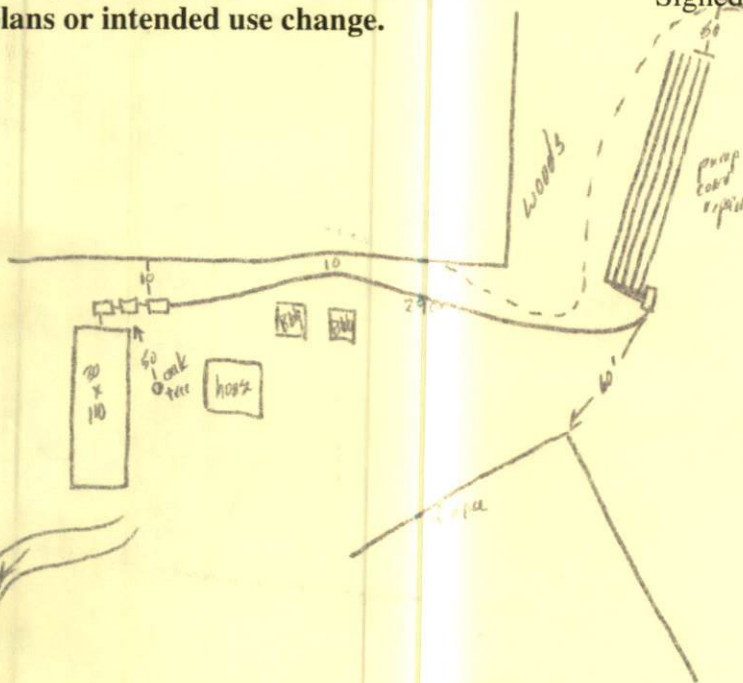

Maintain Setbacks  
 Contractor to meet on site  
 prior to installing  
 System flagged  
 Follow design specifications  
 Use a pump tank and  
 a septic tank in series  
 to make up for a large  
 septic tank

**HARNETT COUNTY HEALTH DEPARTMENT  
AUTHORIZATION TO CONSTRUCT**

Authorization is hereby given to construct a wastewater system to the specifications described by Harnett County Health Department Improvement Permit # 12449. This authorization shall be valid for a period not to exceed five (5) years from the date of issuance. This authorization will be invalid if ownership, site plans, or intended use change.

Owner or Authorized Agent Roger Dupree

Name: Roger Dupree Telephone # 639-6795

Address: Rt 7 Box 131 Angier NC 27501

Property Location: SR # 1505 Road Name Pearidge Rd

New Installation ☒ Repair ☐ Septic Tank ☒ Nitrification Lines ☒

Subdivision \_\_\_\_\_ Lot # \_\_\_\_\_

Number of Bedrooms Proposed: <sup>26 migrants</sup> x60 gal = 1680 gpd Lot size: 36.18 ac

Basement \_\_\_\_\_ With Plumbing \_\_\_\_\_ Without Plumbing \_\_\_\_\_

Water Supply: Well \_\_\_\_\_ Public ☒ Minimum Well Setback: 50+ ft.

Type of System: Conventional ☒ Other Pump to pressure manifold

Tank Volume: Septic Tank <sup>1500 pump tank</sup> 1000 gallons Pump Chamber 1500 gallons

**Nitrification Field Specifications**

Number of fields 1 Number of Lines per Field 5 Length of lines 150

Width of ditches 3 ft. Depth of ditches 18-24 inches

French Drain: Linear feet required \_\_\_\_\_ Depth of gravel \_\_\_\_\_

No wastewater system shall be covered or placed into use by any person until an inspection by the Harnett County Health Department has determined that the system has been installed according to the conditions of the improvement permit and that a valid operations permit has been issued.

Authorized Agent for Harnett County Health Department

Name: Theresa S. Faye L.S. Date: 12-9-97



Friction Head

$$\frac{4.58 \text{ ft}}{100'}$$

300' sch 40 2"

90° x 5' - 35

check - 19

gate - 1.3

enlarger - 55.3'

$$300 \times 55.3 = 355.3 \times \frac{4.58}{100} = 16.27 \text{ FH}$$

Pressure Head  $\rightarrow$  2'

Elev. Head  $\rightarrow$  10'

$$\text{T.D.H} = 28.27$$

Field Flow

$$5 \left( \frac{3}{4}'' \text{ tops} \right) \times 10.1 = 50.5 \text{ gpm}$$

Pump Requirements 28.27 total dynamic head  
at 50.5 gpm

roller 16'



