

HTE# Repair

## Hallett County Department of Public Health

23928

PERMIT # 28442

## Operation Permit

☐ New Installation ☐ Septic Tank ☒ Nitrification Line ☒ Repair ☐ ExpansionPROPERTY LOCATION: 395 Antioch Church RdName: (owner) Rachel Miller SUBDIVISION \_\_\_\_\_ LOT # \_\_\_\_\_System Installer: Tommy Coley Registration # \_\_\_\_\_Basement with plumbing: ☐ Garage ☐ Number of Bedrooms 4Type of Water Supply: ☐ Community ☐ Public ☒ Well Distance from well 50 feetSystem Type: III b Types V and VI Systems expire in 5 years.

(In accordance with Table V a)

Owner must contact Health Department 6 months prior to expiration for permit renewal.

This system has been installed in compliance with applicable North Carolina General Statutes, Rules for Sewage Treatment and Disposal, and all conditions of the Improvement Permit and Construction Authorization.

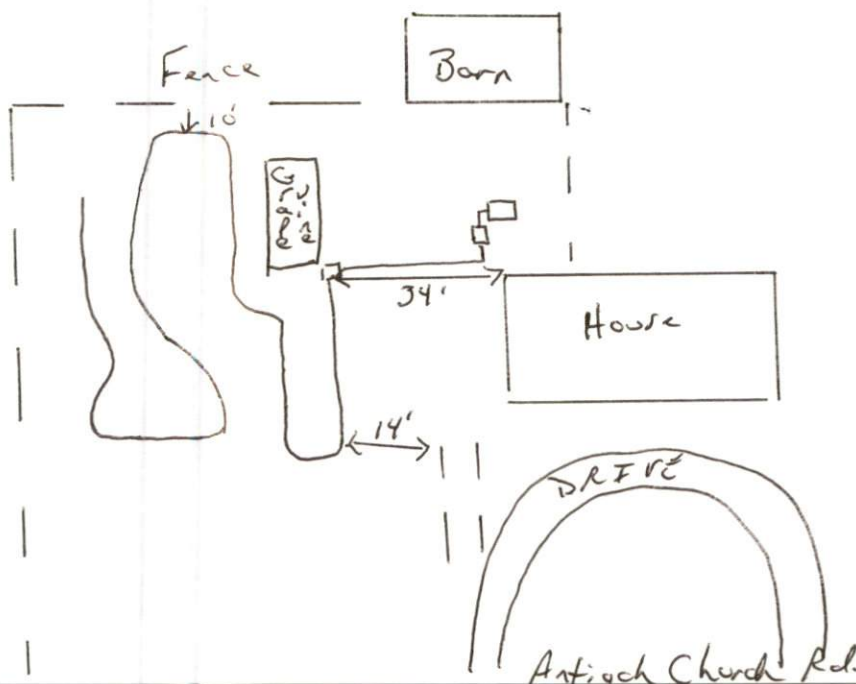

## PERMIT CONDITIONS:

I. Performance: System shall perform in accordance with Rule .1961.

II. Monitoring: As required by Rule .1961.

III. Maintenance: As required by Rule .1961. Other: \_\_\_\_\_

Subsurface system operator required? Yes ☐ No ☐

If yes, see attached sheet for additional operation conditions, maintenance and reporting.

IV. Operation: \_\_\_\_\_

V. Other: \_\_\_\_\_

☐ D-Box ☐ Pump ☐ Alarm ☐ H2O Line ☐ PWR Line

Following are the specifications for the sewage disposal system on the above captioned property.

Type of system: ☐ Conventional ☒ Other Pump to EZFlow Septic Tank: Existing gallons Pump Tank: 1000 gallonsSubsurface Drainage Field No. of ditches 1 exact length of each ditch 400 feet width of ditches 3 feet depth of ditches 18-22 inches

French Drain Required: \_\_\_\_\_ Linear feet

Authorized State Agent Guy McLean, R.E.H.S.Date 12/18/2015