

HTE# Repair

Harnett County Department of Public Health

Improvement Permit

27801

A building permit cannot be issued with only an Improvement Permit

PROPERTY LOCATION: 402 Lucas RdISSUED TO: James + Carolyn Dorman

SUBDIVISION _____

LOT # _____

NEW ☐ REPAIR ☒ EXPANSION ☐

Site Improvements required prior to Construction Authorization Issuance: _____

Type of Structure: SFDProposed Wastewater System Type: Pump to 25% Reduction SystemProjected Daily Flow: 360 GPDNumber of bedrooms: 3 Number of Occupants: 6 maxBasement ☐ Yes ☒ NoPump Required: ☒ Yes ☐ No ☐ May be required based on final location and elevations of facilitiesType of Water Supply: ☐ Community ☒ Public ☐ Well Distance from well _____ feet

Permit valid for:

☒ Five years☐ No expiration

Permit conditions: _____

Authorized State Agent: Bryan McLean, RCHSDate: 1/24/2014

SEE ATTACHED SITE SKETCH

The issuance of this permit by the Health Department in no way guarantees the issuance of other permits. The permit holder is responsible for checking with appropriate governing bodies in meeting their requirements. This site is subject to revocation if the site plan, plat, or the intended use changes. The Improvement Permit shall not be affected by a change in ownership of the site. This permit is subject to compliance with the provisions of the Laws and Rules for Sewage Treatment and Disposal and to conditions of this permit.

Construction Authorization

(Required for Building Permit)

The construction and installation requirements of Rules .1950, .1952, .1954, .1955, .1956, .1957, .1958, and .1959 are incorporated by references into this permit and shall be met. Systems shall be installed in accordance with the attached system layout.

ISSUED TO: James + Carolyn DormanPROPERTY LOCATION: 402 Lucas Rd

SUBDIVISION _____

LOT # _____

Facility Type: SFD ☐ New ☐ Expansion ☒ RepairBasement? ☐ Yes ☐ No Basement Fixtures? ☐ Yes ☐ NoType of Wastewater System** _____ (Initial) Wastewater Flow: 360 GPD(See note below, if applicable ☐)Pump to 25% Reduction System (Repair)

Installation Requirements/Conditions

Septic Tank Size Existing gallonsPump Tank Size 1000 gallonsNumber of trenches 5Exact length of each trench 60 feet

Trenches shall be installed on contour at a

Maximum Trench Depth of: 18 inches(Trench bottoms shall be level to $\pm 1/4"$

in all directions)

Trench Spacing: 9 Feet on CenterSoil Cover: 6 inches

(Maximum soil cover shall not exceed 36" above the trench bottom)

Pump Requirements: _____ ft. TDH vs. _____ GPM

Aggregate Depth: _____ inches below pipe
_____ inches above pipe
_____ inches total

Conditions: _____

WATER LINES (INCLUDING IRRIGATION) MUST BE 10FT. FROM ANY PART OF SEPTIC SYSTEM OR REPAIR AREA.
NO UTILITIES ALLOWED IN INITIAL OR REPAIR DRAIN FIELD AREA.

**If applicable: I understand the system type specified is different from the type specified on the application. I accept the specifications of this permit.

Owner/Legal Representative Signature: _____

Date: _____

This Construction Authorization is subject to revocation if the site plan, plat, or the intended use changes. The Construction Authorization shall not be transferred when there is a change in ownership of the site. This Construction Authorization is subject to compliance with the provisions of the Laws and Rules for Sewage Treatment and Disposal and to the conditions of this permit.

SEE ATTACHED SITE SKETCH

Authorized State Agent: Bryan McLean, RCHSDate: 1/24/2014Construction Authorization Expiration Date: 1/24/2019

HTE# Repair

Permit # 27801

Harnett County Department of Public Health Site Sketch

ISSUED TO: James + Carolyn Dorman PROPERTY LOCATOR: 402 Lucas Rd
SUBDIVISION _____ LOT # _____

Authorized State Agent: Greg McSwain, REHS Date: 1/24/2014

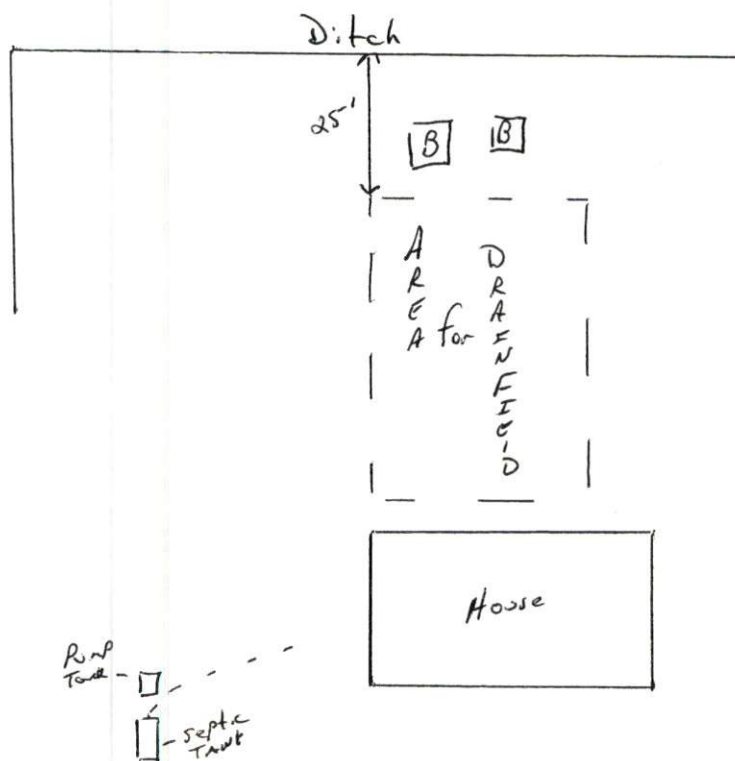

DRAINAGE