

IMPROVEMENT PERMIT

Be it ordained by the Harnett County Board of Health as follows: Section III, Item B. "No Person shall begin construction of any building at which a septic tank system is to be used for disposal of sewage without first obtaining a written permit from the Harnett County Health Department."

Name: (owner) Wendy Bensley New Installation Septic Tank
 Property Location: SR# 1799 Repairs Nitrification Line

Subdivision - Lot # 7

Tax ID # _____ Quadrant # _____

Number of Bedrooms Proposed: 2 Lot Size: 14.99 acres

Basement with Plumbing: Garage:

Water Supply: Well Public Community

Distance From Well: 50' ft.

Following is the minimum specifications for sewage disposal system on above captioned property. Subject to final approval.

Type of system: Conventional Other _____

Size of tank: Septic Tank: 1000 gallons Pump Tank: _____ gallons

Subsurface No. of exact length width of depth of
 Drainage Field ditches 2 of each ditch 120 ft. ditches 3 ft. ditches 18-20 in.

French Drain Required: - Linear feet

Date: 5-22-97

***This permit is subject to revocation if site plans or intended use change.**

Signed: James E. Merchant
 Environmental Health Specialist

**Maintain all setbacks*

VOID AFTER 5 YEARS

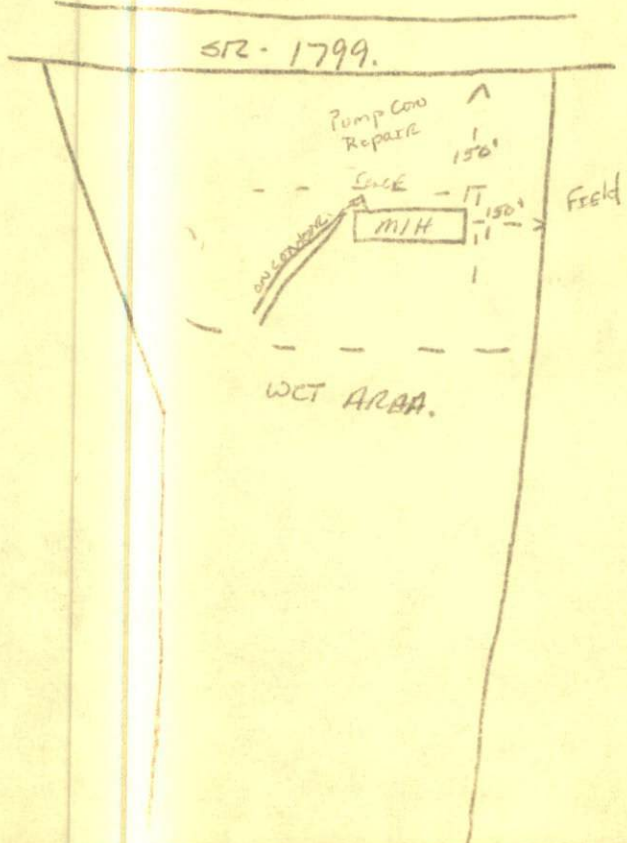

HARNETT COUNTY HEALTH DEPARTMENT
AUTHORIZATION TO CONSTRUCT

Authorization is hereby given to construct a wastewater system to the specifications described by Harnett County Health Department Improvement Permit # 17002. This authorization shall be valid for a period not to exceed five (5) years from the date of issuance. This authorization will be invalid if ownership, site plans, or intended use change.

Owner or Authorized Agent Wendy Beasley

Name: Wendy Beasley Telephone # 892-8701

Address: Rt 2 Box 271 Dunn NC 28334

Property Location: SR # 1799 Road Name _____

New Installation Repair _____ Septic Tank Nitrification Lines

Subdivision James W. Johnson Lot # 7

Number of Bedrooms Proposed: 2 Lot size: 14.99 Acres

Basement _____ With Plumbing _____ Without Plumbing _____

Water Supply: Well Public _____ Minimum Well Setback: 20' ft.

Type of System: Conventional Other _____

Tank Volume: Septic Tank 1000 gallons Pump Chamber _____ gallons

Nitrification Field Specifications

Number of fields 2 Number of Lines per Field 2 Length of lines 120

Width of ditches 3 ft. Depth of ditches 18-20 inches

French Drain: Linear feet required _____ Depth of gravel _____

No wastewater system shall be covered or placed into use by any person until an inspection by the Harnett County Health Department has determined that the system has been installed according to the conditions of the improvement permit and that a valid operations permit has been issued.

Authorized Agent for Harnett County Health Department

Name: James E. Marshall, P.E. Date: 5-22-97