



Conf# 70'  
11-30-98

# LAND USE PERMIT

Harnett County Planning Department  
102 E. Front Street, Lillington, NC 27546  
Phone: (910) 893-7525 Fax: (910) 893-2793

Fee \$20.00  
Receipt  
Permit **009477**  
Date 11-30-98

### LANDOWNER INFORMATION:

Name Showxcase Construction Co.  
Address 5468 Yadkin Road  
Fayetteville, NC 28303  
Phone H 864-0247 W

### APPLICANT INFORMATION:

Name Same  
Address \_\_\_\_\_  
Phone \_\_\_\_\_ H \_\_\_\_\_ W

### PROPERTY LOCATION:

Street Address Assigned 56 Sandy Bluff Court  
SR # 1115 Rd. Name Buffalo Lake Township 03 Panel 75  
Tax Map No. 9587-51-3708 PIN 03-9587-0020-58  
Subdivision Peachtree Crossing Lot # 24 Lot/Tract Size 19942 sf  
Zoning District 1111 Flood Plain \_\_\_\_\_ Deed Book OPPER Page 2 Purchase  
Watershed District 1111 Water District \_\_\_\_\_ Plat Book ON Page FILE  
Give Directions to the Property from Lillington: 210 to 87 toward Sanford, Right on  
Buffalo Lake Road go approx 3 miles, Left on Peachtree Lane  
Right on Sandy Bluff

*OPPER  
MACHS  
How  
10/11/98*

### PROPOSED USE:

- Sg. Family Dwelling (Size 28 x 56) # of Bedrooms 3 Basement n/a  
Garage X Deck \_\_\_\_\_ (Size x)
- Mutli-Family Dwelling No. Units \_\_\_\_\_ No. Bedrooms/Unit \_\_\_\_\_
- Manufactured Home (Size x) # of Bedrooms \_\_\_\_\_ Garage \_\_\_\_\_  
Deck \_\_\_\_\_ (Size x)
- Number of persons per household \_\_\_\_\_
- Business Sq. Ft. Retail Space \_\_\_\_\_ Type \_\_\_\_\_
- Industry Sq. Ft. \_\_\_\_\_ Type \_\_\_\_\_
- Home Occupation No. Rooms/Size \_\_\_\_\_ Use \_\_\_\_\_
- Accessory Building Size \_\_\_\_\_ Use \_\_\_\_\_
- Addition to Existing Building Size \_\_\_\_\_ Use \_\_\_\_\_
- Sign Size \_\_\_\_\_ Type \_\_\_\_\_ Location \_\_\_\_\_
- Other \_\_\_\_\_

Water Supply:  County  Well (No. dwellings \_\_\_\_\_)  Other  
Sewer:  Septic Tank (Existing? No)  County  Other  
Erosion & Sedimentation Control Plan Required? Yes \_\_\_\_\_ No X  
Are there any wells not on this lot but within 40 ft. of the property line? No (Show on site plan)

NOTE: A site plan must be attached to this Application. drawn to scale on an 8.5 by 11 sheet, showing: existing and proposed buildings, garages, driveways, decks, accessory buildings, wells, and any wells within 40 feet of your property line.

\*LAND USE PERMIT IS REQUIRED WHEN PICKING UP SEPTIC, BUILDING AND SET-UP PERMITS\*

N 10°53'36"W 103.49'

25

24

23

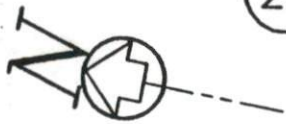

SITE PLAN APPROVAL  
DISTRICT WKA USE SFD  
#BEDROOMS 3  
11-30-98  
Shane Stunt  
Zoning Administrator

S 77°46'42"E 197.65'

N 79°05'28"E 197.57'

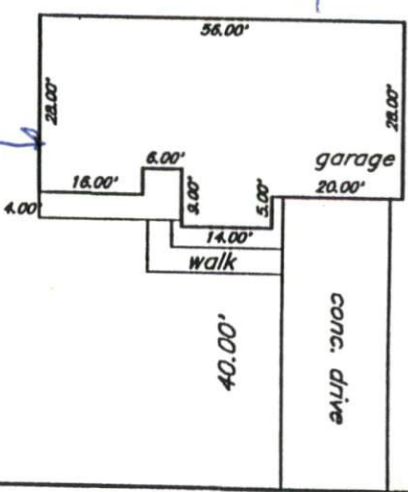
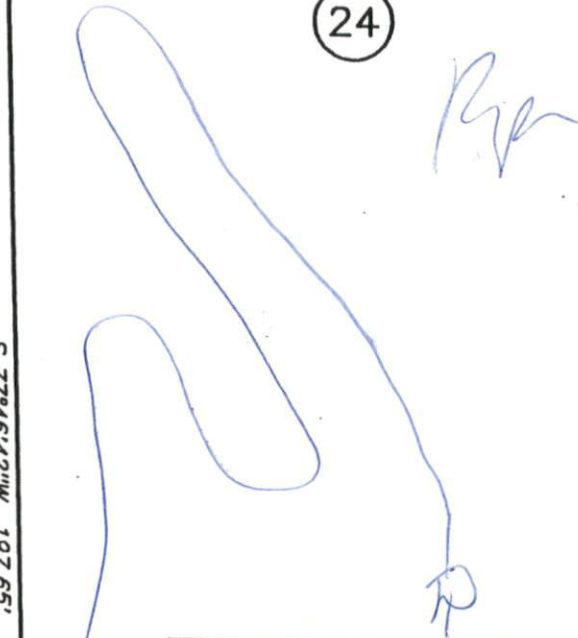

1x200  
18-30"  
Not met  
has 21  
Behr  
Lot  
25/24  
P/L  
4  
1-10-98

S 10°54'32"E 98.96'

Sandy Bluff Court 50'R/W

### Plot Plan

Owner: Showcase Realty & Construction Co.

Subdivision: Peachtree Crossing Phase One

Map Cab: F Slide: 747 D

Harnett County North Carolina

Scale 1" = 30' Date: 11-17-98 House No. \_\_\_\_\_

George L. Lott Surveyors