

IMPROVEMENT PERMIT

Be it ordained by the Harnett County Board of Health as follows: Section III, Item B. "No person shall begin construction of any building at which a septic tank system is to be used for disposal of sewage without first obtaining a written permit from the Harnett County Health Department".

Name: (owner) Benson Building Supply New Installation Septic Tank
 Property Location: 301 N from Benson rd Repairs Nitrification Line
4 miles on left across from Farming Carpet
 Number of Bedrooms Proposed: 18 → 450 gal Lot Size: 5.83 acres

Basement with Plumbing: Garage:
 Water Supply: Well Public Community
 Distance From Well: 100' ft. any existing

Following is the minimum specifications for sewage disposal system on above captioned property. Subject to final approval.

Type of system: Conventional Other _____
 Size of tank: 2 Septic Tank: 1000 gallons Pump Tank: _____ gallons
 Subsurface Drainage Field No. of ditches 2 exact length of each ditch 250 ft. width of ditches 3 ft. depth of ditches 24 in.
 French Drain required: _____ Linear feet

This permit is subject to revocation if site plans or intended use change.

Date: 9-3-93
 Signed: Hal Owa
 Environmental Health Specialist

VOID AFTER 5 YEARS

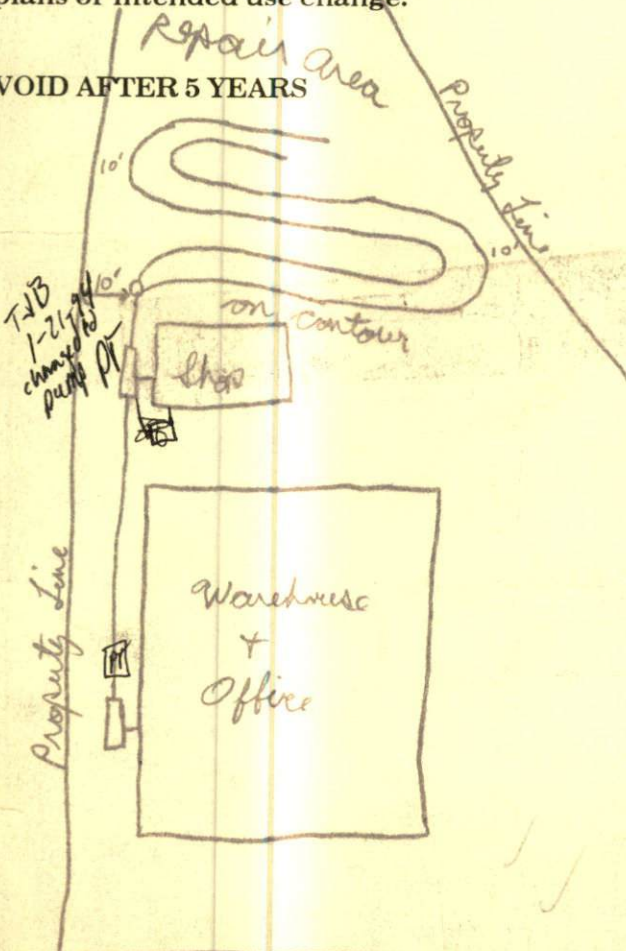

- Maintain 10' setback from property lines + 5' from building foundations
- Pull terrace up hill to smooth area of drainfield but create as little disturbance as possible
 - not more than 6" soil layer to be moved
- install load bearing tank beside warehouse due to potential for vehicle ~~traffic~~ traffic
- install sch. 40 PVC or equivalent pipe between tanks with a minimum fall of 1/8" in 10'. This pipe must be installed at least 5' from the building but must be out of the roadway. Use ductile ~~iron~~ iron pipe under all traffic areas. PVC pipe will not be approved in areas subject to vehicle traffic.