

IMPROVEMENT PERM

Be it ordained by the Harnett County Board of Health as follows: Section III, Item B. "No Person shall begin construction of any building at which a septic tank system is to be used for disposal of sewage without first obtaining a written permit from the Harnett County Health Department."

Name: (owner) Brian Stohler New Installation Septic Tank
Property Location: SR# 1769 OLD STAGE Repairs Nitrification Line

Subdivision _____ Lot # _____

Tax ID # _____ Quadrant # _____

Number of Bedrooms Proposed: 2 BR - 240 GPD Lot Size: .6 AC

Basement with Plumbing: Garage:

Water Supply: Well Public Community

Distance From Well: 50' ft.

Following is the minimum specifications for sewage disposal system on above captioned property. Subject to final approval.

Type of system: Conventional Other 75% Reduction System

Size of tank: Septic Tank: EXISTING gallons Pump Tank: _____ gallons

Subsurface Drainage Field No. of ditches 1 exact length of each ditch 200 ft. width of ditches 3 ft. depth of ditches 20-24 in.

French Drain Required: _____ Linear feet

Date: 5-30-06

This permit is subject to revocation if site plans or intended use change.

Signed: James E. Markanfer
Environmental Health Specialist

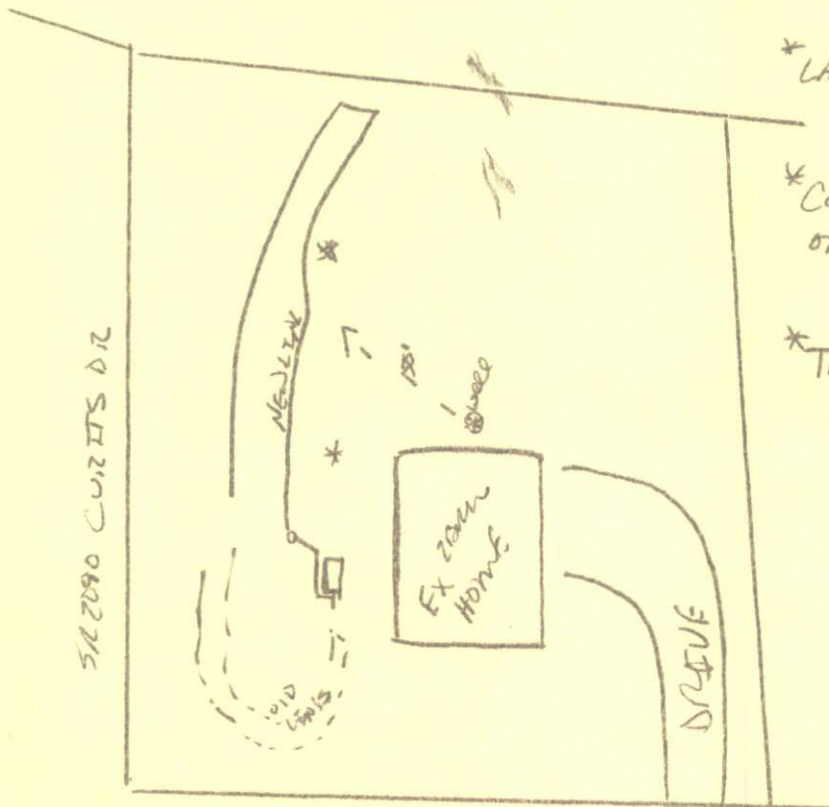

* LAYOUT MAY CHANGE.

* Contractor to MEET ON SITE Before Installation!

* TANK NEEDS FILTER + RISER!

NCSK - 1769 - OLD STAGE.

HARNETT COUNTY DEPARTMENT OF PUBLIC HEALTH AUTHORIZATION TO CONSTRUCT

Authorization is hereby given to construct a wastewater system to the specifications described by Harnett County Department of Public Health, Improvement Permit # 14318. This authorization shall be valid for a period not to exceed five (5) years from the date of issuance. *This authorization will be invalid if ownership, site plans, or intended use change.*

Name Brian Stohler Telephone # 919-625-7231

Address 2191 Old Stage Rd South Greenville N.C. 28339

Property Location SR# 1769 Road Name Old Stage

Subdivision _____ Lot # 200-2406D # Bedrooms Proposed 16 Lot Size _____

TYPE OF SYSTEM

New Installation Repair Septic Tank Nitrification Lines

Conventional Other 25% Reduction Syst

Basement With Plumbing Without Plumbing

Water Supply: Well Public Water Supply Minimum Well Setback: 50 Ft.

Septic Tank 1700 gal Pump Chamber _____ gal

NITRIFICATION FIELD SPECIFICATIONS

Number of fields 1 # of lines per field 1 Length of lines 200 Ft.

Width of ditches 3 ft. Depth of ditches 20-18 inches

French Drain: Linear feet required - Depth of gravel -

No wastewater system shall be covered or placed into use by any person until an inspection by the Harnett County Health Department has determined that the system has been installed according to the conditions of the Improvement Permit and that a valid Operations Permit has been issued.

James S. Manhart
Signature of Authorized Agent for Harnett County

5-30-06
Date