

Improvement Permit

A building permit cannot be issued with only an Improvement Permit

ISSUED TO: Sonya Swayney PROPERTY LOCATION: 617 Bailey Rd.
 NEW REPAIR EXPANSION SUBDIVISION _____ LOT # C
 Type of Structure: Existing Home Site Improvements required prior to Construction Authorization Issuance: _____
 Proposed Wastewater System Type: 25% Reduction System
 Projected Daily Flow: 360 GPD
 Number of bedrooms: 3 Number of Occupants: 6 max
 Basement Yes No
 Pump Required: Yes No May be required based on final location and elevations of facilities
 Type of Water Supply: Community Public Well Distance from well 70 feet
 Permit conditions: _____ Permit valid for: Five years No expiration

Authorized State Agent: Bryan McSwain, CEHS Date: 3/30/2010 SEE ATTACHED SITE SKETCH
 The issuance of this permit by the Health Department in no way guarantees the issuance of other permits. The permit holder is responsible for checking with appropriate governing bodies in meeting their requirements. This site is subject to revocation if the site plan, plat, or the intended use changes. The Improvement Permit shall not be affected by a change in ownership of the site. This permit is subject to compliance with the provisions of the Laws and Rules for Sewage Treatment and Disposal and to conditions of this permit.

Construction Authorization

(Required for Building Permit)

The construction and installation requirements of Rules .1950, .1952, .1954, .1955, .1956, .1957, .1958, and .1959 are incorporated by references into this permit and shall be met. Systems shall be installed in accordance with the attached system layout.

ISSUED TO: Sonya Swayney PROPERTY LOCATION: 617 Bailey Rd.
 Facility Type: Existing Home New Expansion Repair
 Basement? Yes No Basement Fixtures? Yes No
 Type of Wastewater System** (See note below, if applicable) _____ (Initial) Wastewater Flow: _____ GPD
25% Reduction System (Repair)
 Installation Requirements/Conditions
 Septic Tank Size 1000 gallons Number of trenches 1
 Pump Tank Size _____ gallons Exact length of each trench 370 feet Trench Spacing: 9 Feet on Center
 Trenches shall be installed on contour at a Soil Cover: 12-18 inches
 Maximum Trench Depth of: 24-30 inches (Maximum soil cover shall not exceed 36" above the trench bottom)
 (Trench bottoms shall be level to +1-1/4" in all directions)
 Pump Requirements: _____ ft. TDH vs. _____ GPM Aggregate Depth: _____ inches below pipe
 Conditions: System Flagged out. Maintain all setbacks. Run drainlines on contour. _____ inches above pipe
 _____ inches total

**If applicable: I understand the system type specified is different from the type specified on the application. I accept the specifications of this permit.

Owner/Legal Representative Signature: _____ Date: _____

This Construction Authorization is subject to revocation if the site plan, plat, or the intended use changes. The Construction Authorization shall not be transferred when there is a change in ownership of the site. This Construction Authorization is subject to compliance with the provisions of the Laws and Rules for Sewage Treatment and Disposal and to the conditions of this permit. SEE ATTACHED SITE SKETCH

Authorized State Agent: Bryan McSwain, CEHS Date: 3/30/2010
 Construction Authorization Expiration Date: 3/30/2015

HTE# Attempt to Repair

Permit # 25960

Harnett County Department of Public Health Site Sketch

ISSUED TO: Sonya Swain PROPERTY LOCATION: 617 Bailey Rd.
SUBDIVISION _____ LOT # C
Authorized State Agent: Bryan McLean, RCHS Date: 3/30/2010

*Contractor to call prior
installing system

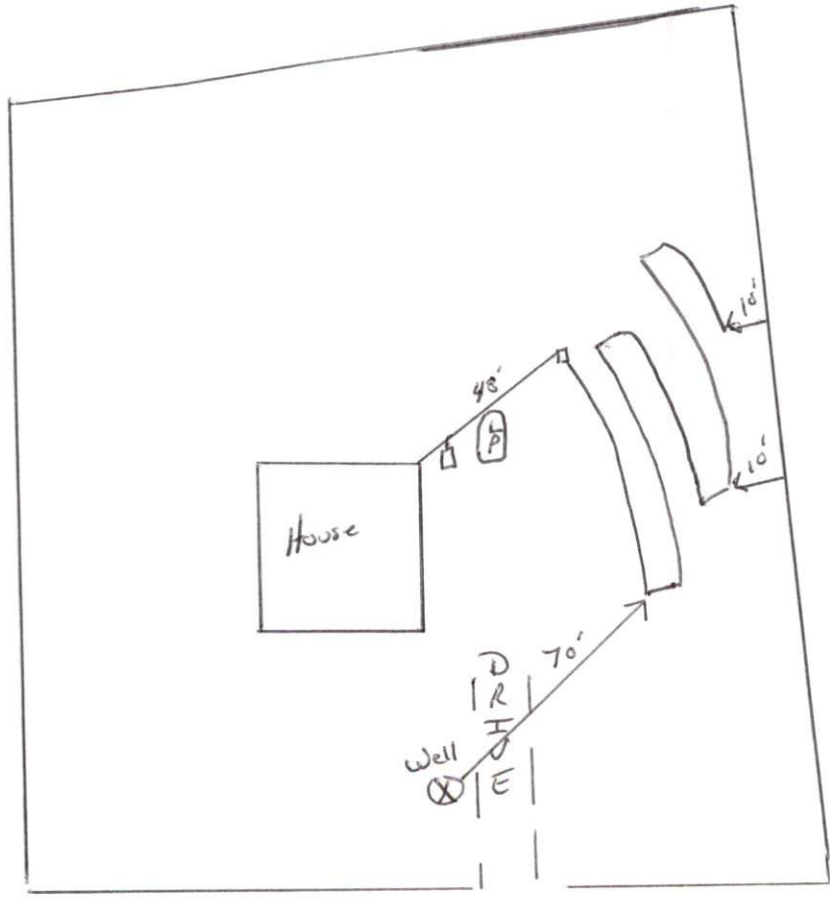

*Not to scale

Bailey Rd.