

# OPERATIONS PERMIT

Name: (owner) Weaver Dev. Co.  New Installation  Septic Tank  
 Property Location: SR# 1141  Repairs  Nitrification Line  
 Subdivision Sunset Ridge Lot # 88  
 TAX ID# \_\_\_\_\_ Quadrant # \_\_\_\_\_  
 Contractor: Johnny Faircloth Registration # \_\_\_\_\_

Basement with Plumbing:  Garage:

Water Supply:  Well  Public  Community

Distance From Well: 50+ ft.

Following are the specifications for the sewage disposal system on above captioned property.

Type of system:  Conventional  Other Pump to conv. lines

Size of tank: Septic Tank: 1000 gallons Pump Tank: 1000 gallons

Subsurface Drainage Field No. of ditches 1 exact length of each ditch 200 ft. width of ditches 3 ft. depth of ditches 24 in.

French Drain: \_\_\_\_\_ Linear feet

Date: \_\_\_\_\_

PERMIT NO. 13284 Inspected by: \_\_\_\_\_  
Environmental Health Specialist

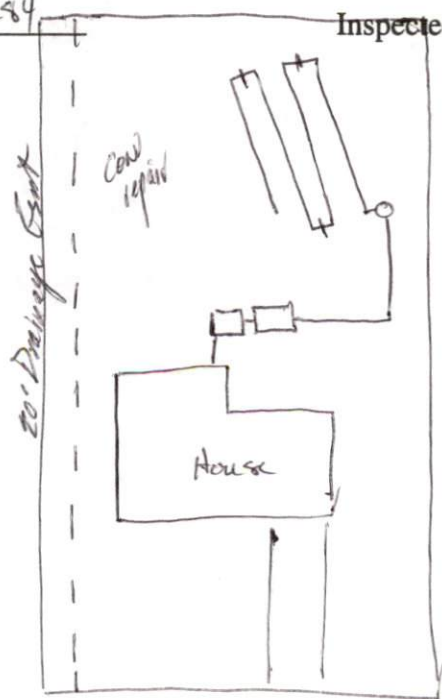

4-20-96  
 lines, tanks pump checked  
 need alarm + electrical box  
 wired

Rd