

HARNETT COUNTY HEALTH DEPARTMENT

IMPROVEMENT PERMIT

21958

HTE _____

Be it ordained by the Harnett County Board of Health as follows: Section III, Item B. "No Person shall begin construction of any building at which a septic tank system is to be used for disposal of sewage without first obtaining a written permit from the Harnett County Health Department."

Name: (owner) Karl F. Steinbrecher New Installation Septic Tank
 Property Location: SR# 1411 Wagstaff Rd. Repairs Nitrification Line

Subdivision _____ Lot # 5

Tax ID # _____ Quadrant # _____

Number of Bedrooms Proposed: Existing Lot Size: _____

Basement with Plumbing: Garage:

Water Supply: Well Public Community

Distance From Well: 50 ft.

Following is the minimum specifications for sewage disposal system on above captioned property. Subject to final approval.

Type of system: Conventional Other _____

Size of tank: Septic Tank: Existing gallons Pump Tank: _____ gallons

Subsurface No. of exact length width of depth of
 Drainage Field ditches 1 of each ditch 200 ft. ditches 3 ft. ditches 24-36 in.

French Drain Required: _____ Linear feet

Date: 4/22/2005

This permit is subject to revocation if site plans or intended use change.

Signed: [Signature]
 Environmental Health Specialist

- * Maintain all setbacks
- * Use a Bull Run valve between old & new system
- * Recommend that gutters be rerouted around system area
- * H₂O + phone line will need to be routed
- * H₂O line must be 10 ft. from any part of septic system

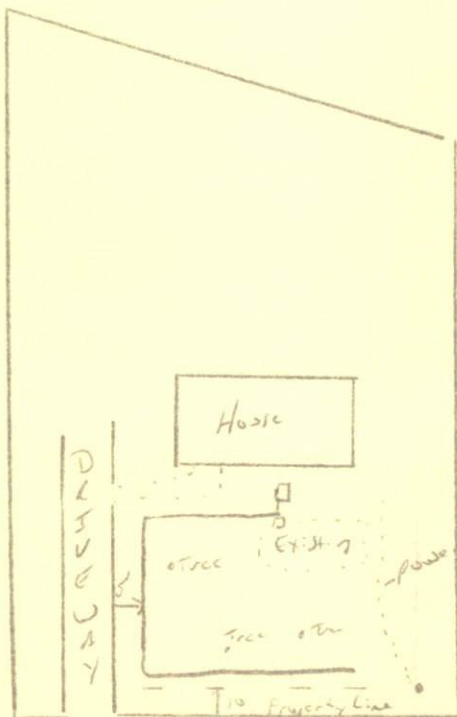

SR 1411

HARNETT COUNTY DEPARTMENT OF PUBLIC HEALTH
AUTHORIZATION TO CONSTRUCT

Authorization is hereby given to construct a wastewater system to the specifications described by Harnett County Department of Public Health, Improvement Permit # 21958. This authorization shall be valid for a period not to exceed five (5) years from the date of issuance. *This authorization will be invalid if ownership, site plans, or intended use change.*

Name Karl F. Steinbrecher Telephone # 919 632 7790

Address 425 Petts Rd. Fuquay Varina, N.C. 2726

Property Location SR# 1411 Road Name Weyhuff

Subdivision _____ Lot # 5 # Bedrooms Proposed 3 existing Lot Size _____

TYPE OF SYSTEM

New Installation Repair Septic Tank Nitrification Lines

Conventional Other _____

Basement With Plumbing Without Plumbing

Water Supply: Well Public Water Supply Minimum Well Setback: 50 Ft.

Septic Tank existing gal Pump Chamber _____ gal

NITRIFICATION FIELD SPECIFICATIONS

Number of fields 1 # of lines per field 1 Length of lines 200 Ft.

Width of ditches 3 ft. Depth of ditches 24.36 inches

French Drain: Linear feet required _____ Depth of gravel _____

No wastewater system shall be covered or placed into use by any person until an inspection by the Harnett County Health Department has determined that the system has been installed according to the conditions of the Improvement Permit and that a valid Operations Permit has been issued.

[Signature]
Signature of Authorized Agent for Harnett County

4/22/2008
Date