

HARNETT COUNTY HEALTH DEPARTMENT

Septic Tank Inspection Certificate

No 5037

Owner Walter R.S. #137 Address 20 #1  
(MUST BE FILLED IN) (MAILING ADDRESS)

Contractor Center Address Day  
(MAILING ADDRESS)

Location of Premises DL  
(SUBDIVISION, STREET OR ROAD NAME OR NUMBER, LOT NO.)

Details of Septic Tank System

Kind of Material for Tank:  Concrete  Other \_\_\_\_\_

Size of Tank: Length \_\_\_\_\_ Ft. Width \_\_\_\_\_ Ft. Depth \_\_\_\_\_ Ft. Capacity 1000 Gallons

Subsurface Drainage Field No. of Ditches 1 Exact Length of each Ditch 100 Width of Ditches 6 Depth of Ditches \_\_\_\_\_ Inches

Square Feet in Absorption Field 600 Surface Drainage Required \_\_\_\_\_ Linear Ft.

Approved by [Signature]  
(SANITARIAN)

Permit No. \_\_\_\_\_ Date 2-24-75

# SEPTIC TANK PERMIT

No 1296

Be it ordained by the Harnett County Board of Health as follows:  
Section III, Item B. "No person shall begin construction of any building at which a septic tank system is to be used for disposal of sewage without first obtaining a written permit from the Harnett County Health Department."

Name: (owner) William Smith  New Installation  Septic Tank  
Property Location: 06622 Maple Dr Rolling Spring  Repairs  Nitrification Line

Number of Bedrooms Proposed: \_\_\_\_\_ Number of Bathrooms proposed: \_\_\_\_\_

Lot Size: W \_\_\_\_\_ D 12,000 sqft Water Supply:  Well  City  Community  
Distance From Well?

Above information certified by: \_\_\_\_\_  
Following is the minimum specifications for sewage disposal system on above captioned property. Subject to final approval.

Kind of Material for Tank:  Concrete  Other \_\_\_\_\_

Size of Tank: Length \_\_\_\_\_ Ft. Width \_\_\_\_\_ Ft. Depth \_\_\_\_\_ Ft. Capacity \_\_\_\_\_ Gallons  
Subsurface No. of Drainage Field Ditches 4 Exact Length of each Ditch 40 Width of Ditches 3 Depth of Ditches 30 Inches

Permit Granted: \_\_\_\_\_ Date: \_\_\_\_\_

Permit Denied: \_\_\_\_\_ Signed: \_\_\_\_\_

- 1) 900 gallon pumping chamber
- 1) Submersible pump w. alarm system
- 1) distribution box
- 4) lines in 3' bed, 1' of undisturbed earth between
- 1) Sept Tank

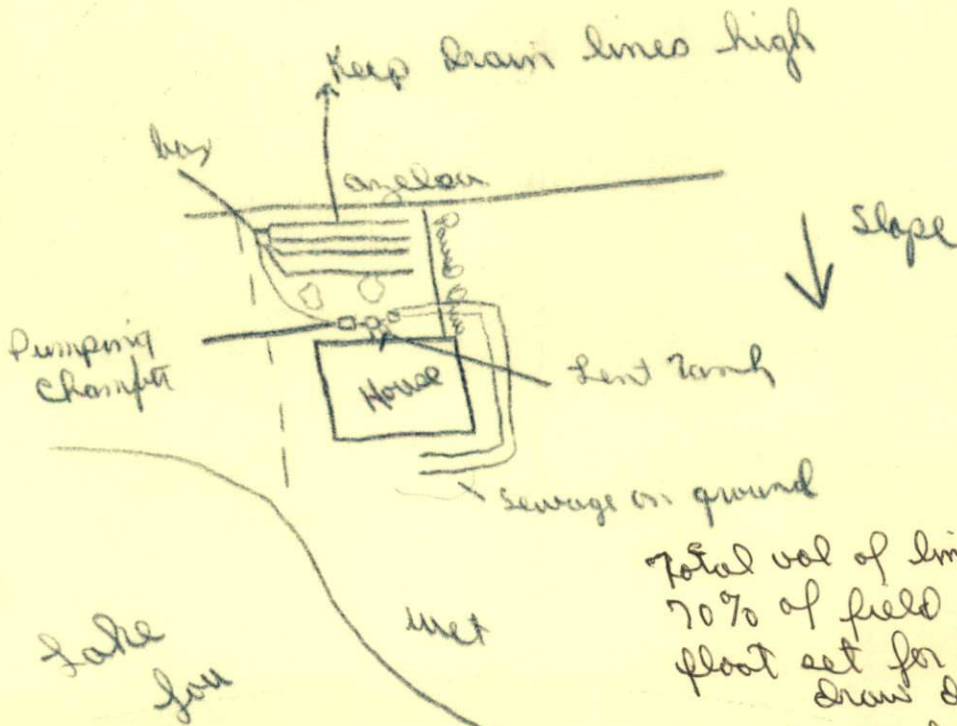

Total vol of lines 100 gal  
 70% of field is 70 gal  
 float set for app 7 inch  
 draw down  
 7 cycles per day .65-70 gal per cycles  
 15 gpm pump - runs app 3 minutes per cycle . 21 m.p.d.