

HTE# _____

H...ett County Department of Public Health

20441

PERMIT # 25136

Operation Permit

New Installation Septic Tank Repair Nitrification Line Expansion

PROPERTY LOCATION: Hwy 42

Name: (owner) OMA O'CONNELL SUBDIVISION _____ LOT # _____

System Installer: Tommy Coley Registration # _____

Basement with plumbing: Garage Number of Bedrooms 3

Type of Water Supply: Community Public Well Distance from well 150' feet

System Type: 25% REDUCTION System Type # 6 BZ Lay Types V and VI Systems expire in 5 years.

(In accordance with Table V a) Owner must contact Health Department 6 months prior to expiration for permit renewal.

This system has been installed in compliance with applicable North Carolina General Statutes, Rules for Sewage Treatment and Disposal, and all conditions of the Improvement Permit and Construction Authorization.

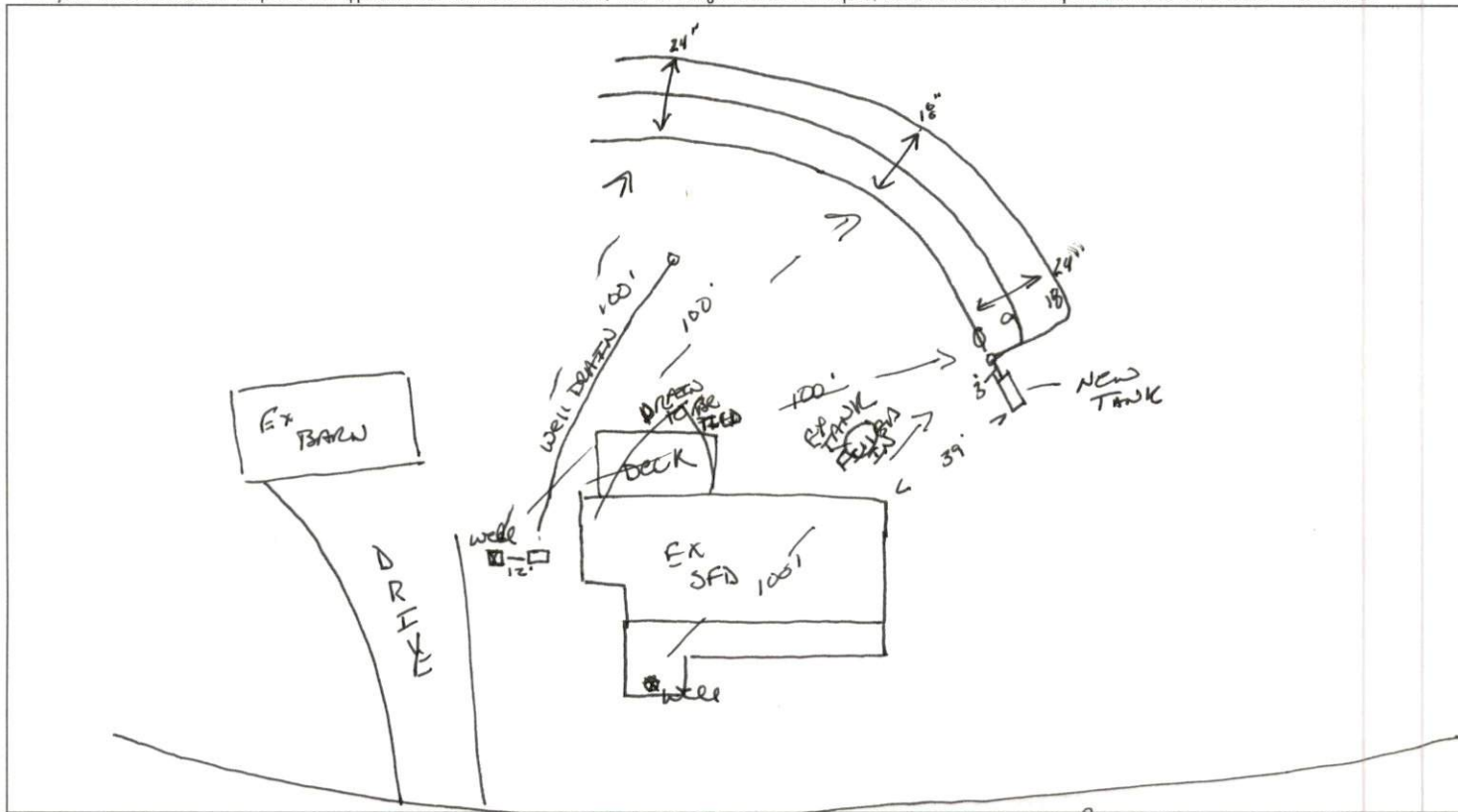

PERMIT CONDITIONS: DUNCAN Hwy 42 SANDHILL

- I. Performance: System shall perform in accordance with Rule .1961.
- II. Monitoring: As required by Rule .1961.
- III. Maintenance: As required by Rule .1961. Other: _____
Subsurface system operator required? Yes No
If yes, see attached sheet for additional operation conditions, maintenance and reporting.
- IV. Operation: _____
- V. Other: _____

Following are the specifications for the sewage disposal system on the above captioned property.

Type of system: Conventional Other 25% REDUCTION System Septic Tank: 1000 gallons Pump Tank: _____ gallons
 Subsurface No. of exact length width of depth of
 Drainage Field ditches 3 of each ditch 100 feet ditches 3 feet ditches 24 inches
 French Drain Required: _____ Linear feet

Authorized State Agent JAMES E. MANHART JR Date 4-9-09