

## SOIL/SITE EVALUATION FOR ON-SITE WASTEWATER SYSTEM

APPLICANT: Eldridge Ellis Williams OWNER: \_\_\_\_\_ AGENT: \_\_\_\_\_ PHONE: \_\_\_\_\_  
 ADDRESS: 1227 + R 24 APPLICATION DATE: \_\_\_\_\_ DATE EVALUATED: \_\_\_\_\_  
 PROPOSED FACILITY: \_\_\_\_\_  
 PROPERTY SIZE: \_\_\_\_\_

LOCATION OF SITE: \_\_\_\_\_  
 WATER SUPPLY: On-Site Well \_\_\_\_\_ Comm. Well \_\_\_\_\_ Public \_\_\_\_\_ Other \_\_\_\_\_ EVAL. METHOD: Auger Boring \_\_\_\_\_ Pit \_\_\_\_\_ Cut \_\_\_\_\_

PROFILE #	.1940 LANDSCP POS./ SLOPE %	HORIZON DEPTH (IN.)	.1941			
			(a)(1) TEXTURE	(a)(2) STRUCTURE	(a)(3) MINEROLOGY	
1		24	SL	gr		.1942 WETNES CONDITION -
		38+	SC	sbk		.1943/.1956 SAPROLITE -
						.1944 RESTRICTIVE HORIZON -
						.1948 PROFILE CLASSIFICATION -
						PROFILE LTAR - .35
2		22	SL	gr		.1942 WETNES CONDITION -
		36+	SC	sbk		.1943/.1956 SAPROLITE -
						.1944 RESTRICTIVE HORIZON -
						.1948 PROFILE CLASSIFICATION -
						PROFILE LTAR - .35
3		20	SL	gr		.1942 WETNES CONDITION -
		38	SC	sbk		.1943/.1956 SAPROLITE -
						.1944 RESTRICTIVE HORIZON -
						.1948 PROFILE CLASSIFICATION -
						PROFILE LTAR - .35
4	repair	24	SL	gr		.1942 WETNES CONDITION - 34
		34	SCL	sbk		.1943/.1956 SAPROLITE -
						.1944 RESTRICTIVE HORIZON -
						.1948 PROFILE CLASSIFICATION -
						PROFILE LTAR - .35
5	pump repair	18	SL	gr		.1942 WETNES CONDITION -
		36	SC	sbk		.1943/.1956 SAPROLITE -
						.1944 RESTRICTIVE HORIZON -
		18	SL			.1948 PROFILE CLASSIFICATION -
						PROFILE LTAR -

AVAILABLE SPACE (.1945) \_\_\_\_\_ SITE CLASSIFICATION (.1948): \_\_\_\_\_ SITE LONG-TERM ACCEPTANCE RATE: \_\_\_\_\_  
 OTHER FACTORS (.1946) \_\_\_\_\_ SYSTEM TYPE \_\_\_\_\_  
 EVALUATED BY: \_\_\_\_\_ OTHER(S) PRESENT: \_\_\_\_\_  
 COMMENTS: \_\_\_\_\_

# LEGEND

<u>LANDSCAPE POSITION</u>	<u>GROUP</u>	<u>TEXTURE</u>	<u>.1955 LTAR</u>	<u>MOIST</u>	<u>WET</u>
R - RIDGE	I	S - SAND	1.2 - 0.8	VFR - VERY FRIABLE FR - FRIABLE FI - FIRM VFI - VERY FIRM EFI - EXTREMELY FIRM	NS - NON-STICKY SS - SLIGHTLY STICKY S - STICKY VS - VERY STICKY NP - NON-PLASTIC SP - SLIGHTLY STICKY P - PLASTIC VP - VERY PLASTIC
S - SHOULDER SLOPE		LS - LOAMY SAND			
L - LINEAR SLOPE	II	SL - SANDY LOAM	0.8 - 0.6		
FS - FOOT SLOPE		L - LOAM			
N - NOSE SLOPE	III	SI - SILT	0.6 - 0.3		
H - HEAD SLOPE		SICL - SILTY CLAY LOAM			
CC - CONCAVE SLOPE		CL - CLAY LOAM			
CV - CONVEX SLOPE		SCL - SANDY CLAY LOAM			
T - TERRACE	IV	SC - SANDY CLAY	0.4 - 0.1		
FP - FLOOD PLAIN		SIC - SILTY CLAY			
		O - ORGANIC			

STRUCTURE

- SG - SINGLE GRAIN
- M - MASSIVE
- CR - CRUMB
- GR - GRANULAR
- SBK - SUBANGULAR BLOCKY
- ABK - ANGULAR BLOCKY
- PL - PLATY
- PR - PRISMATIC

MINEROLOGY

- 1:1
- 2:1
- MIXED

USE THE ABOVE STANDAR ABBREVIATIONS.

NOTES:

- HORIZON DEPTH IN INCHES BELOW NATURAL SOIL SURFACE
- DEPTH OF FILL IN INCHES FROM LAND SUFACE
- RESTRICTIVE HORIZON— THICKNESS AND DEPTH FROM LAND SURFACE
- SAPROLITE S (SUITABLE) OR U (UNSUITABLE)

NOTES:

SOIL WETNESS - INCHES FROM LAND SURFACE TO FREE WATER OR INCHES FROM LAND SURFACE TO SOIL COLORS WITH CHROMA 2 OR LESS - RECORD MUNSELL COLOR CHIP DESIGNATION. CLASSIFICATION - S (SUITABLE), PS (PROVISIONALLY SUITABLE), OR U (UNSUITABLE)

LONG-TERM ACCEPTANCE RATE: GAL/DAY/FT<sup>2</sup>

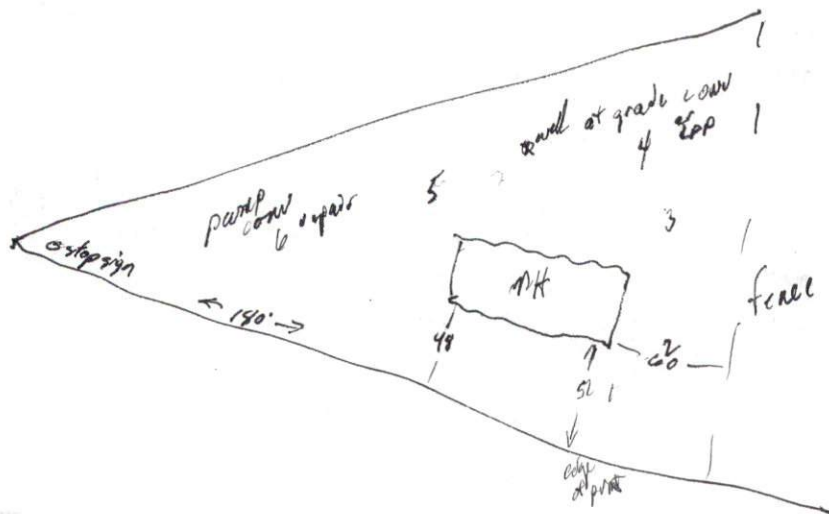

18-24  
20120

well to be properly abandoned

FACTORS	PROFILE 1	PROFILE 2	PROFILE 3	PROFILE 4	PROFILE 5
LANDSCAPE POSITION					
SLOPE (%)					
HORIZON I DEPTH					
Texture Group					
Consistence					
Structure					
Mineralogy					
HORIZON II DEPTH					
Texture Group					
Consistence					
Structure					
Mineralogy					
HORIZON III DEPTH					
Texture Group					
Consistence					
Structure					
Mineralogy					
HORIZON IV DEPTH					
Texture Group					
Consistence					
Structure					
Mineralogy					
SOIL WETNESS					
RESTRICTIVE HORIZON					
SAPROLITE					
CLASSIFICATION					
LONG-TERM ACCEPTANCE RATE					

FACTORS	PROFILE 1	PROFILE 2	PROFILE 3	PROFILE 4	PROFILE 5
LANDSCAPE POSITION					
SLOPE (%)					
HORIZON I DEPTH					
Texture Group					
Consistence					
Structure					
Mineralogy					
HORIZON II DEPTH					
Texture Group					
Consistence					
Structure					
Mineralogy					
HORIZON III DEPTH					
Texture Group					
Consistence					
Structure					
Mineralogy					
HORIZON IV DEPTH					
Texture Group					
Consistence					
Structure					
Mineralogy					
SOIL WETNESS					
RESTRICTIVE HORIZON					
SAPROLITE					
CLASSIFICATION					
LONG-TERM ACCEPTANCE RATE					

SITE CLASSIFICATION: \_\_\_\_\_  
 EVALUATED BY: \_\_\_\_\_  
 REMARKS: \_\_\_\_\_

SITE LONG-TERM ACCEPTANCE RATE: \_\_\_\_\_  
 OTHER(S) PRESENT: \_\_\_\_\_

# SANITARY SEWAGE SYSTEM

OWNER: \_\_\_\_\_ PHONE: \_\_\_\_\_ DATE REQUESTED: \_\_\_\_\_ DATE EVALUATED: \_\_\_\_\_  
 ADDRESS: \_\_\_\_\_ PROPERTY IDENTIFICATION NO.: \_\_\_\_\_  
 COUNTY: \_\_\_\_\_ PROPERTY SIZE: \_\_\_\_\_ PROPOSED FACILITY: \_\_\_\_\_  
 LOCATION OF SITE: \_\_\_\_\_  
 WATER SUPPLY: On-Site Well \_\_\_\_\_ Community \_\_\_\_\_ Public \_\_\_\_\_ EVALUATION BY: Auger Boring \_\_\_\_\_ PR \_\_\_\_\_

LANDSCAPE POSITION	Group	TEXTURE	Appl. Rate
R - Ridge	I	s - sand	1.2-0.8
S - Shoulder slope		lg - loamy sand	
L - Linear slope	II	sl - sandy loam	0.8-0.6
S - Foot slope		l - loam	
N - Nose slope	III	sl - silt	0.6-0.3
H - Head slope		sl - silt loam	
C - Concave slope		slcl - silty clay loam	
v - Convex slope		cl - clay loam	
T - Terrace	IV	sc - sandy clay loam	0.4-0.1
P - Flood Plain		sc - sandy clay	
		slc - silty clay	
		c - clay	

### LEGEND

#### MOIST

- vr - very friable
- fr - friable
- f - firm
- vff - very firm
- ff - extremely firm

#### CONSISTENCE

#### WET

- Ns - non-sticky
- Ss - slightly sticky
- S - sticky
- Vs - very sticky

- Np - non-plastic
- Sp - slightly plastic
- P - plastic
- Vp - very plastic

#### STRUCTURE

- sg - single grain
- m - massive
- cr - crumb
- gr - granular
- sbk - subangular blocky
- abk - angular blocky
- pl - platy
- pr - prismatic

Use the above standard abbreviations.

#### DEFINITIONS:

- Horizon Depth - in inches
- Depth of Fill - in inches from land surface
- Thickness of Horizon - thickness and inches from land surface
- Moisture Content - % (suitable) or U (unsuitable)

#### NOTES:

- Soil Wetness - inches from land surface to free water or inches from land surface to soil color change 2 or less - record Munsell color chip designation
- Classification - S (suitable), PS (provisionally suitable) or U (unsuitable)
- Long-Term Acceptance Rate - gals/day/ft<sup>2</sup>

SR 1221 (Revised \_\_\_\_\_)  
 District Branch (Review \_\_\_\_\_)

old well house  
 pipe will have to be pulled up  
 or abandoned AND Filled with cement if  
 it is still there.  
 SR 1229



L T A R 14

4 - 20 inch sandy loam

20 - 48 clay loam/clay

Site is unsuitable  
 due to available space.