

# IMPROVEMENT PERMIT

Be it ordained by the Harnett County Board of Health as follows: Section III, Item B. "No Person shall begin construction of any building at which a septic tank system is to be used for disposal of sewage without first obtaining a written permit from the Harnett County Health Department."

Name: (owner) Diane Newkirk  New Installation  Septic Tank  
Property Location: SR# 1215  Repairs  Nitrification Line

Subdivision \_\_\_\_\_ Lot # \_\_\_\_\_

Tax ID # \_\_\_\_\_ Quadrant # \_\_\_\_\_

Number of Bedrooms Proposed: (28x80) 4 BR Lot Size: 35.1 AC

Basement with Plumbing:  Garage:  MUST use filter & masher  
Water Supply:  Well  Public  Community MUST meet on site for Final  
Distance From Well: 50 min ft. Layout

Following is the minimum specifications for sewage disposal system on above captioned property. Subject to final approval.

Type of system:  Conventional  Other \_\_\_\_\_

Size of tank: Septic Tank: 1000 gallons Pump Tank: \_\_\_\_\_ gallons

Subsurface Drainage Field No. of ditches 3 exact length of each ditch 110 ft. width of ditches 3 ft. depth of ditches 18 in.

French Drain Required: \_\_\_\_\_ Linear feet

Date: 8-25-99

**This permit is subject to revocation if site plans or intended use change.**

Signed: [Signature]  
Environmental Health Specialist

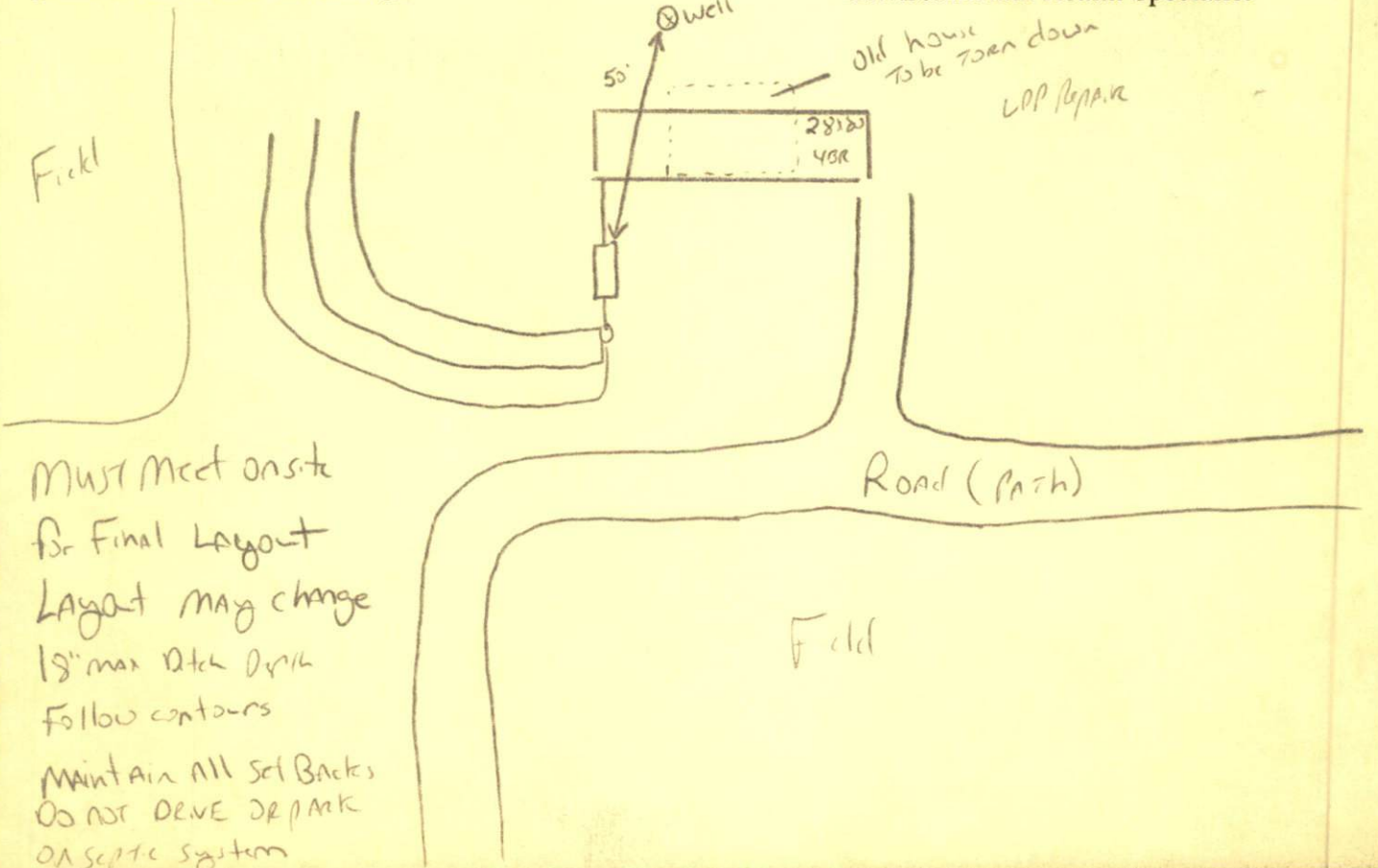

MUST meet on-site  
for Final layout  
Layout may change  
18" max ditch depth  
Follow contours  
Maintain All set Backs  
DO NOT DRIVE OR PARK  
ON SEPTIC SYSTEM

HARNETT COUNTY HEALTH DEPARTMENT  
AUTHORIZATION TO CONSTRUCT

Authorization is hereby given to construct a wastewater system to the specifications described by Harnett County Health Department Improvement Permit # 16406. This authorization shall be valid for a period not to exceed five (5) years from the date of issuance. This authorization will be invalid if ownership, site plans, or intended use change.

Owner or Authorized Agent Diane Newkirk

Name: \_\_\_\_\_ Telephone # \_\_\_\_\_

Address: \_\_\_\_\_

Property Location: SR # 1215 Road Name \_\_\_\_\_

New Installation  Repair \_\_\_\_\_ Septic Tank  Nitrification Lines

Subdivision \_\_\_\_\_ Lot # \_\_\_\_\_

Number of Bedrooms Proposed: 4 (28x80) Lot size: 35.1 ac

Basement \_\_\_\_\_ With Plumbing \_\_\_\_\_ Without Plumbing \_\_\_\_\_

Water Supply: Well  Public \_\_\_\_\_ Minimum Well Setback: 50 ft.

Type of System: Conventional  Other \_\_\_\_\_

Tank Volume: Septic Tank 1000 gallons Pump Chamber \_\_\_\_\_ gallons

**Nitrification Field Specifications**

Number of fields 1 Number of Lines per Field 3 Length of lines 110

Width of ditches 3 ft. Depth of ditches 18 inches

French Drain: Linear feet required \_\_\_\_\_ Depth of gravel \_\_\_\_\_

No wastewater system shall be covered or placed into use by any person until an inspection by the Harnett County Health Department has determined that the system has been installed according to the conditions of the improvement permit and that a valid operations permit has been issued.

Authorized Agent for Harnett County Health Department

Name: [Signature] Date: 8-25-99