

938
ELL

N 06° 00' 43" W
176.39'

This Lot
Retained By
Lot 7-B
Richard &
Barbara Koepf
0.61 AC

SITE PLAN APPROVAL
District NA Use MFH (28 x 72)
Bedrooms 4
Date 2-13-96 Tom King
Zoning Administrator

FID

131.61'

N 63° 00' 51"

15'

41'

S 28° 53' 46" W

157.97'

331.64' Total

200.03'

55'

75'

Well

FIP



EXISTING GARAGE

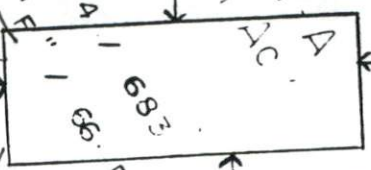

NOELL HILLS PH II
Lot 7-A
0.71 AC

30' Easement For Lot 7-B

Lot 6
974 - 689
HOLLENBECK

Lot 7A
Noell Hills PH II
Recorded Book F
Page 505-A
19 Dec 95
Harnett Co.

This lot sold to Jones

LPA
45x80
3600 sq ft

6.67 AM
5x50x7
250' total
18.24" ditch
Well

CONTROL CORNER

S 28° 53' 04" W

151.15'

200.13'

03

36

E

Sip

400.02

199.89'

Total

10'

10'

20' DRIVEWAY

FIP

25' W Distance