



529

LAND USE PERMIT

Harnett County Planning Department  
102 E. Front Street, Lillington, NC 27  
Phone: (910) 893-7525 Fax: (910) 893-2793

Receipt  
Permit 010462  
Date 6-23-99

LANDOWNER INFORMATION:

Name DONNA L. JONES  
Address LT 136 AMANDA ST  
SPRING LAKE NC 27370  
Phone 910-497-0863H SAME W

APPLICANT INFORMATION:

Name \_\_\_\_\_  
Address \_\_\_\_\_  
Phone \_\_\_\_\_ H \_\_\_\_\_ W

PROPERTY LOCATION:

Street Address Assigned \_\_\_\_\_  
SR # NC210 Rd. Name NC210 Township 01 Zoning District N/A  
MAP 052502 BLOCK 89 PIN 3802 PARCEL 01-0536-0153  
Subdivision Ruth B. Casater Lot # \_\_\_\_\_ Lot/Tract Size 5.0 ac  
Flood Plain X Panel 155 Deed Book 1286 Page 972  
Watershed District N/A Plat Book 98 Page 276

Give Directions to the Property from Lillington: HWY 210 - TOWARDS SP. LAKE  
ALMOST 6 MILES ON LEFT FROM LILLINGTON -  
PAST FIRST ANDERSON CREEK SCHOOL ROAD - 2ND  
DIRT ROAD ON LEFT - JUST BEFORE CASSITER RD.

PROPOSED USE:

- Sg. Family Dwelling (Size \_\_\_\_\_ x \_\_\_\_\_) # of Bedrooms \_\_\_\_\_ Basement \_\_\_\_\_ Garage \_\_\_\_\_ Deck \_\_\_\_\_
- Multi-Family Dwelling No. Units \_\_\_\_\_ No. Bedrooms/Unit \_\_\_\_\_
- Manufactured Home (Size 14 x 80) # of Bedrooms 3 Garage \_\_\_\_\_ Deck \_\_\_\_\_
- Number of persons per household 4
- Business Sq. Ft. Retail Space \_\_\_\_\_ Type \_\_\_\_\_
- Industry Sq. Ft. \_\_\_\_\_ Type \_\_\_\_\_
- Home Occupation No. Rooms/Size \_\_\_\_\_ Use \_\_\_\_\_
- Accessory Building Size \_\_\_\_\_ Use \_\_\_\_\_
- Addition to Existing Building Size \_\_\_\_\_ Use \_\_\_\_\_
- Sign Size \_\_\_\_\_ Type \_\_\_\_\_ Location \_\_\_\_\_
- Other \_\_\_\_\_

Water Supply:  County  Well (No. dwellings \_\_\_\_\_)  Other  
Sewer:  Septic Tank (Existing? No)  County  Other  
Erosion & Sedimentation Control Plan Required? Yes \_\_\_\_\_ No X

NOTE: A copy of the recorded survey or plat map and a copy of the recorded Deed for the property or Offer to Purchase are required to obtain Land Use Permit. A site plan must be attached to this Application, drawn to scale on an 8.5 by 11 sheet, showing: existing and proposed buildings, garages, driveways, decks, and accessory buildings.

only 529  
12 July 99  
Need to call  
possibly  
4 more home  
propose come  
repair  
area a  
question

3 BR  
2 Kids  
2 Adults  
Completed  
13 July 99





SETBACK REQUIREMENTS

ACTUAL

MINIMUM REQUIRED

Front Property Line	<u>35</u>	<u>25</u>
Side Property Line	<u>90</u>	<u>10</u>
Corner Side Line	<u>    </u>	<u>    </u>
Rear Property Line	<u>550</u>	<u>25</u>
Nearest Building	<u>    </u>	<u>    </u>
Stream	<u>    </u>	<u>    </u>
Percent Coverage	<u>    </u>	<u>    </u>

Are there any other structures on this tract of land? No  
 No. of single family dwellings \_\_\_\_\_ No. of manufactured homes \_\_\_\_\_ Other (specify) \_\_\_\_\_

Does the property owner of this tract of land own any land that contains a manufactured home within five hundred feet (500') of the tract listed above? Yes \_\_\_\_\_ No X

I hereby CERTIFY that the information contained herein is true to the best of my knowledge: and by accepting this permit shall in every respect conform to the terms of this application and to the provisions of the Statutes and Ordinances regulating development in Harnett County. **Any VIOLATION of the terms above stated immediately REVOKES THIS PERMIT.** I further understand this structure is not to be occupied until a Certificate of Occupancy is issued.

Damia L Jones  
 Landowner's Signature  
 (Or Authorized Agent)

      
 Date

**\*\*This permit expires 6 months from the date issued if no work has begun before that date\*\***

**LAND USE PERMIT IS REQUIRED WHEN PICKING UP SEPTIC, BUILDING AND SET-UP PERMITS**

.....  
**FOR OFFICE USE ONLY**

Copy of recorded final plat of subdivision on file? yes

Is the lot/tract specified above in compliance with the Harnett County  
 Subdivision Ordinance       
 Watershed Ordinance       
 Manufactured Home Park Ordinance     

ISSUED     

DENIED     

Comments:  
 \_\_\_\_\_  
 \_\_\_\_\_

M. Buckland  
 Zoning/Watershed Administrator

6.23.99  
 Date

$$\begin{array}{r} 24 \\ .725 \\ \times 40 \\ \hline 10.000 \end{array}$$
 fall required

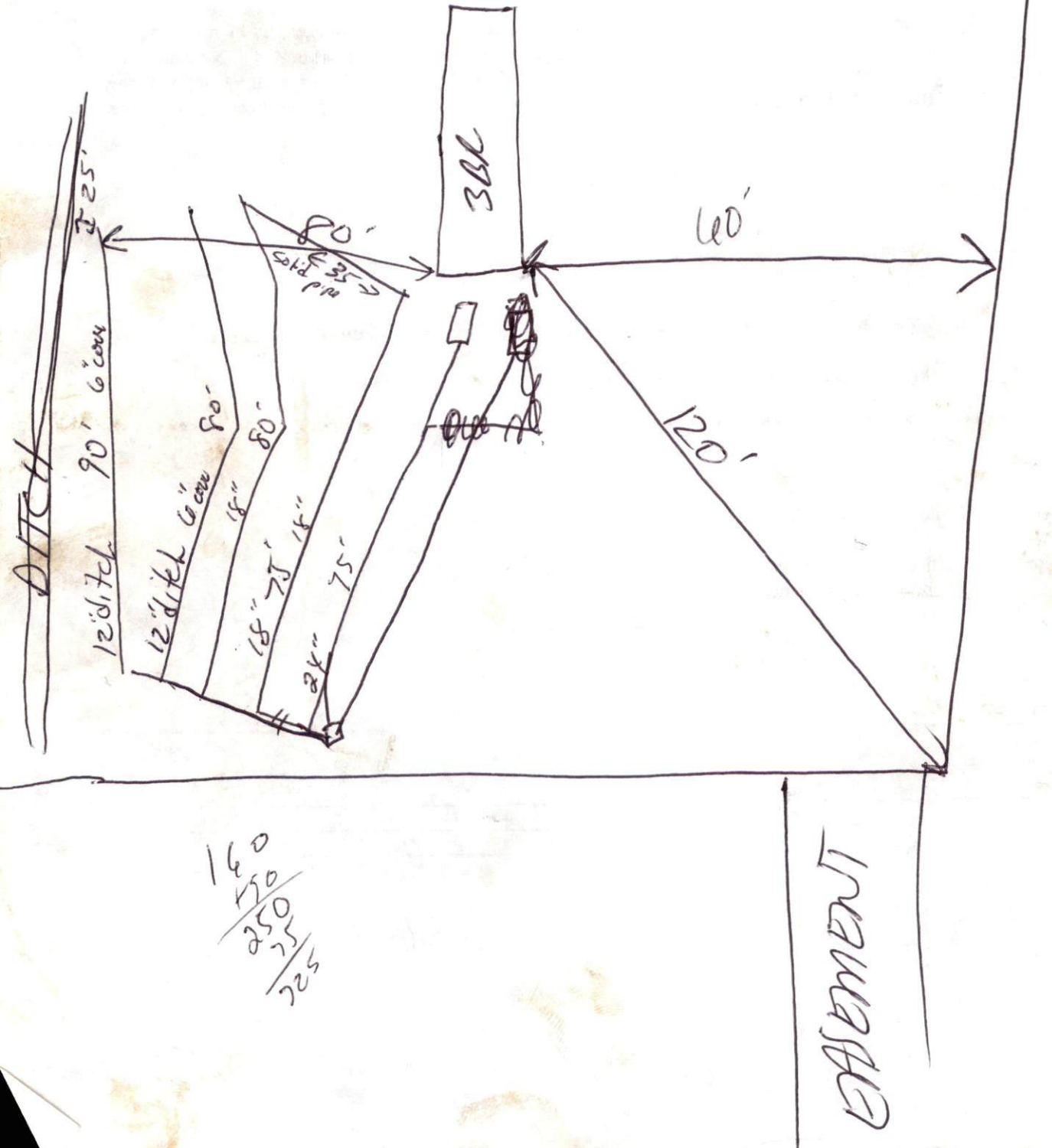

$$\begin{array}{r} 160 \\ 150 \\ \hline 250 \\ 250 \\ \hline 225 \end{array}$$