

# SOIL/SITE EVALUATION FOR ON-SITE WASTEWATER SYSTEM

APPLICANT: Bobby Johnson OWNER: \_\_\_\_\_ AGENT: \_\_\_\_\_ PHONE: \_\_\_\_\_  
ADDRESS: \_\_\_\_\_ APPLICATION DATE: \_\_\_\_\_ DATE EVALUATED: \_\_\_\_\_  
PROPOSED FACILITY: 3 beds  
PROPERTY SIZE: 29 ac

LOCATION OF SITE: 2700 Roberts Rd  
WATER SUPPLY: On-Site Well \_\_\_\_\_ Comm. Well \_\_\_\_\_ Public  Other county EVAL. METHOD: Auger Boring  Pit \_\_\_\_\_ Cut \_\_\_\_\_

| PROFILE # | .1940 LANDSCP POS./ SLOPE % | HORIZON DEPTH (IN.) | .1941          |                  |                    |                                   |
|-----------|-----------------------------|---------------------|----------------|------------------|--------------------|-----------------------------------|
|           |                             |                     | (a)(1) TEXTURE | (a)(2) STRUCTURE | (a)(3) MINEROLOGY  |                                   |
| 1         |                             | 0-18                | LS             | SG               | VFL-NS-NEXP        | .1942 WETNESS CONDITION 740 -     |
|           |                             | 18-36               | SCL            | GR               | FR-SS-NEXP         | .1943/.1956 SAPROLITE 740 -       |
|           |                             | 36-40               | SC             | SBK              | FI-S-SEXP          | .1944 RESTRICTIVE HORIZON 740 -   |
|           |                             |                     |                |                  |                    | .1948 PROFILE CLASSIFICATION PS - |
|           |                             |                     |                |                  | PROFILE LTAR - .5  |                                   |
| 2         |                             | 0-18                | LS             | SG               | VFL-NS-NEXP        | .1942 WETNESS CONDITION 740 -     |
|           |                             | 18-30               | SCL            | GR               | FR-SS-NEXP         | .1943/.1956 SAPROLITE 740 -       |
|           |                             | 30-40               | SC             | SBK              | FI-S-SEXP          | .1944 RESTRICTIVE HORIZON 740 -   |
|           |                             |                     |                |                  |                    | .1948 PROFILE CLASSIFICATION PS - |
|           |                             |                     |                |                  | PROFILE LTAR - .4  |                                   |
| 3         |                             | 0-18                | LS             | SG               | VFL-NS-NEXP        | .1942 WETNESS CONDITION 736 -     |
|           |                             | 18-36               | SCL            | GR               | FR-SS-NEXP         | .1943/.1956 SAPROLITE 736 -       |
|           |                             |                     |                |                  |                    | .1944 RESTRICTIVE HORIZON 736 -   |
|           |                             |                     |                |                  |                    | .1948 PROFILE CLASSIFICATION PS - |
|           |                             |                     |                |                  | PROFILE LTAR - .6  |                                   |
| 4         |                             | 0-18                | LS             | SG               | VFL-NS-NEXP        | .1942 WETNESS CONDITION 736 -     |
|           |                             | 18-30               | SCL            | GR               | FR-SS-NEXP         | .1943/.1956 SAPROLITE 736 -       |
|           |                             | 30-36               | SC             | SBK              | FI-S-SEXP          | .1944 RESTRICTIVE HORIZON 736 -   |
|           |                             |                     |                |                  |                    | .1948 PROFILE CLASSIFICATION PS - |
|           |                             |                     |                |                  | PROFILE LTAR - .4  |                                   |
| 5         |                             | 0-18                | LS             | SG               | VFL-NS-NEXP        | .1942 WETNESS CONDITION 740 -     |
|           |                             | 18-30               | SCL            | GR               | FR-SS-NEXP         | .1943/.1956 SAPROLITE 740 -       |
|           |                             | 30-40               | SC             | SBK              | FI-S-SEXP          | .1944 RESTRICTIVE HORIZON 740 -   |
|           |                             |                     |                |                  |                    | .1948 PROFILE CLASSIFICATION PS - |
|           |                             |                     |                |                  | PROFILE LTAR - .54 |                                   |

AVAILABLE SPACE (.1945) \_\_\_\_\_ SITE CLASSIFICATION (.1948): PS SITE LONG-TERM ACCEPTANCE RATE: .24  
OTHER FACTORS (.1946) \_\_\_\_\_ SYSTEM TYPE: Shallow concretion - 18" max ditch depth  
EVALUATED BY: JHL OTHER(S) PRESENT: 3 lines @ 100' x 3' each follow contours  
COMMENTS: \_\_\_\_\_

# LEGEND

| LANDSCAPE POSITION | GROUP | TEXTURE                | .1955 LTAR | MOIST                |                      |
|--------------------|-------|------------------------|------------|----------------------|----------------------|
|                    |       |                        |            | MOIST                | WET                  |
| R - RIDGE          | I     | S - SAND               | 1.2 - 0.8  | VFR - VERY FRIABLE   | NS - NON-STICKY      |
| S - SHOULDER SLOPE |       | LS - LOAMY SAND        |            | FR - FRIABLE         | SS - SLIGHTLY STICKY |
| L - LINEAR SLOPE   | II    | SL - SANDY LOAM        | 0.8 - 0.6  | FI - FIRM            | S - STICKY           |
| FS - FOOT SLOPE    |       | L - LOAM               |            | VFI - VERY FIRM      | VS - VERY STICKY     |
| N - NOSE SLOPE     | III   | SI - SILT              | 0.6 - 0.3  | EFI - EXTREMELY FIRM | NP - NON-PLASTIC     |
| H - HEAD SLOPE     |       | SICL - SILTY CLAY LOAM |            | SP - SLIGHTLY STICKY |                      |
| CC - CONCAVE SLOPE |       | CL - CLAY LOAM         |            | P - PLASTIC          |                      |
| CV - CONVEX SLOPE  |       | SCL - SANDY CLAY LOAM  |            | VP - VERY PLASTIC    |                      |
| T - TERRACE        | IV    | SC - SANDY CLAY        | 0.4 - 0.1  |                      |                      |
| FP - FLOOD PLAIN   |       | SIC - SILTY CLAY       |            |                      |                      |
|                    |       | O - ORGANIC            |            |                      |                      |

## STRUCTURE

- SG - SINGLE GRAIN
- M - MASSIVE
- CR - CRUMB
- GR - GRANULAR
- SBK - SUBANGULAR BLOCKY
- ABK - ANGULAR BLOCKY
- PL - PLATY
- PR - PRISMATIC

## MINEROLOGY

- 1:1
- 2:1
- MIXED

USE THE ABOVE STANDAR ABBREVIATIONS.

## NOTES:

- HORIZON DEPTH IN INCHES BELOW NATURAL SOIL SURFACE
- DEPTH OF FILL IN INCHES FROM LAND SURFACE
- RESTRICTIVE HORIZON— THICKNESS AND DEPTH FROM LAND SURFACE
- SAPROLITE S (SUITABLE) OR U (UNSUITABLE)

## NOTES:

SOIL WETNESS - INCHES FROM LAND SURFACE TO FREE WATER OR INCHES FROM LAND SURFACE TO SOIL COLORS WITH CHROMA 2 OR LESS - RECORD MUNSELL COLOR CHIP DESIGNATION. CLASSIFICATION - S (SUITABLE), PS (PROVISIONALLY SUITABLE), OR U (UNSUITABLE)

LONG-TERM ACCEPTANCE RATE: GAL/DAY/FT<sup>2</sup>

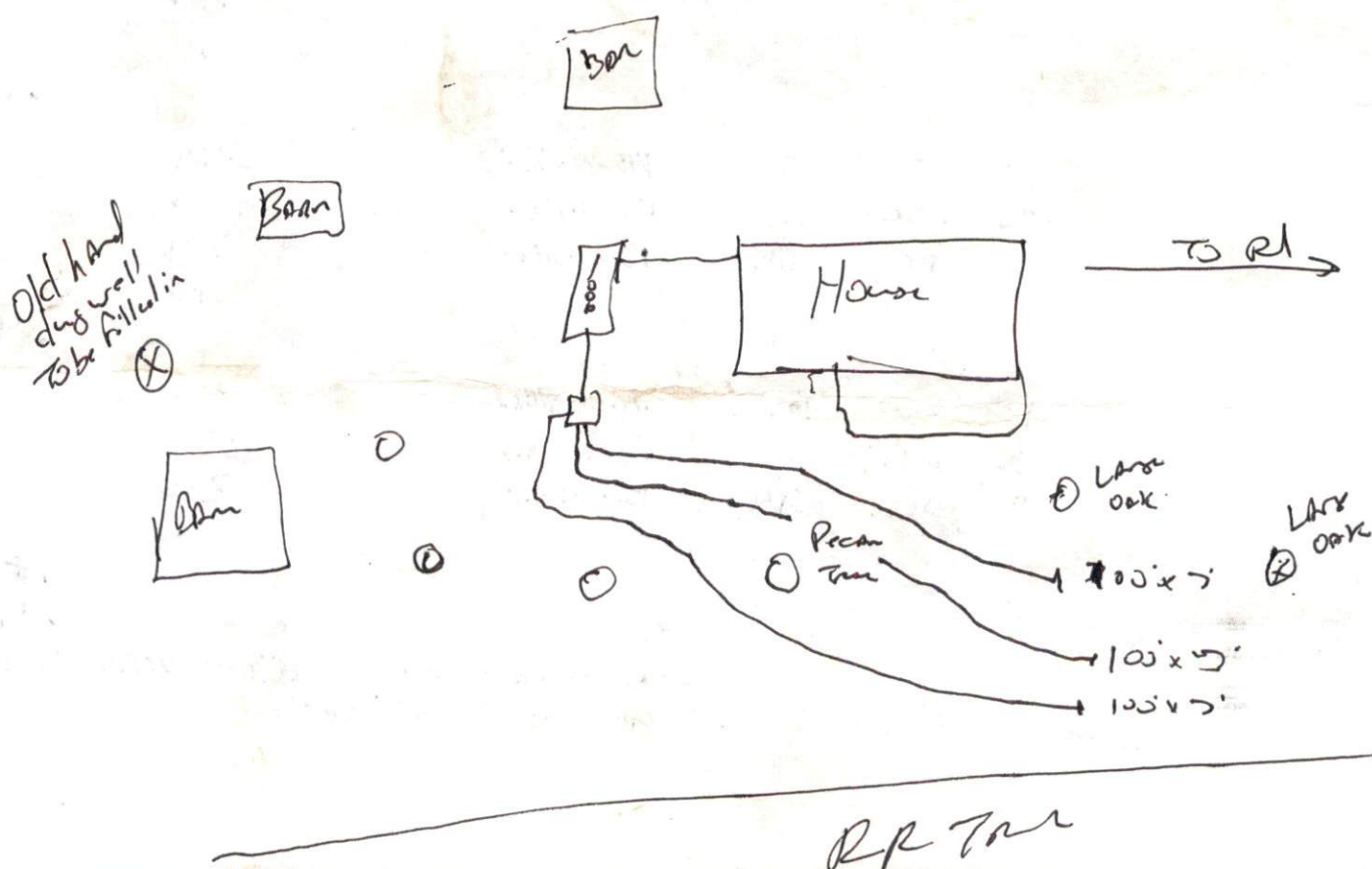

# SANITARY SEWAGE SYSTEM

OWNER: \_\_\_\_\_ PHONE: \_\_\_\_\_ DATE REQUESTED: \_\_\_\_\_ DATE EVALUATED: \_\_\_\_\_  
 ADDRESS: \_\_\_\_\_ PROPERTY IDENTIFICATION NO.: \_\_\_\_\_  
 COUNTY: \_\_\_\_\_ PROPERTY SIZE: \_\_\_\_\_ PROPOSED FACILITY: \_\_\_\_\_  
 LOCATION OF SITE: \_\_\_\_\_  
 WATER SUPPLY: On-Site Well \_\_\_\_\_ Community \_\_\_\_\_ Public \_\_\_\_\_ EVALUATION BY: Auger Boring \_\_\_\_\_ PR \_\_\_\_\_

| LANDSCAPE POSITION | Group | TEXTURE               | App. Rate |
|--------------------|-------|-----------------------|-----------|
| R - Ridge          | I     | s - sand              | 1.2-0.8   |
| S - Shoulder slope |       | ls - loamy sand       |           |
| L - Linear slope   | II    | sl - sandy loam       | 0.8-0.6   |
| S - Foot slope     |       | l - loam              |           |
| N - Nose slope     | III   | si - silt             | 0.6-0.3   |
| H - Head slope     |       | sl - silt loam        |           |
| Cc - Concave slope |       | scl - silty clay loam |           |
| Cv - Convex slope  |       | cl - clay loam        |           |
| T - Terrace        | IV    | scl - sandy clay loam | 0.4-0.1   |
| P - Flood Plain    |       | sc - sandy clay       |           |
|                    |       | c - clay              |           |

### LEGEND

#### CONSISTENCE

**MOIST**  
 vtr - very friable  
 fr - friable  
 fl - firm  
 vfl - very firm  
 sfl - extremely firm

#### WET

Ns - non-sticky  
 Ss - slightly sticky  
 S - sticky  
 Vs - very sticky  
 Np - non-plastic  
 Sp - slightly plastic  
 P - plastic  
 Vp - very plastic

#### STRUCTURE

sg - single grain  
 m - massive  
 cr - crumb  
 gr - granular  
 sbk - subangular blocky  
 abk - angular blocky  
 pl - platy  
 pr - prismatic

Use the above standard abbreviations.

- DEFINITIONS:**
- Drainage Depth - in inches
  - Depth of Fill - in inches from land surface
  - Drainage Horizon - thickness and inches from land surface
  - Drainage Profile - S (suitable) or U (unsuitable)
- IS 2501 (Revised \_\_\_\_\_)  
 Sanitation Branch (Review \_\_\_\_\_)

#### NOTES:

Soil Wetness - inches from land surface to free water or inches from land surface to soil color chroma 2 or less - record Munsell color chip designation  
 Classification - S (suitable), PS (provisionally suitable) or U (unsuitable)  
 Long-Term Acceptance Rate - gal/day/ft<sup>2</sup>

| FACTORS       | PROFILE 1 | PROFILE 2 | PROFILE 3 | PROFILE 4 | PROFILE 5 |
|---------------|-----------|-----------|-----------|-----------|-----------|
| CAPE POSITION |           |           |           |           |           |
| (%)           |           |           |           |           |           |
| DN I DEPTH    |           |           |           |           |           |
| Group         |           |           |           |           |           |
| ence          |           |           |           |           |           |
| re            |           |           |           |           |           |
| logy          |           |           |           |           |           |
| DN II DEPTH   |           |           |           |           |           |
| Group         |           |           |           |           |           |
| ence          |           |           |           |           |           |
| re            |           |           |           |           |           |
| logy          |           |           |           |           |           |
| DN III DEPTH  |           |           |           |           |           |
| Group         |           |           |           |           |           |
| ence          |           |           |           |           |           |
| re            |           |           |           |           |           |
| logy          |           |           |           |           |           |
| DN IV DEPTH   |           |           |           |           |           |
| Group         |           |           |           |           |           |
| ence          |           |           |           |           |           |
| re            |           |           |           |           |           |
| logy          |           |           |           |           |           |
| FTNESS        |           |           |           |           |           |
| CTIVE HORIZON |           |           |           |           |           |
| LITE          |           |           |           |           |           |
| IFICATION     |           |           |           |           |           |
| ERM           |           |           |           |           |           |
| ANCE RATE     |           |           |           |           |           |

| FACTORS       | PROFILE 1 | PROFILE 2 | PROFILE 3 | PROFILE 4 | PROFILE 5 |
|---------------|-----------|-----------|-----------|-----------|-----------|
| CAPE POSITION |           |           |           |           |           |
| (%)           |           |           |           |           |           |
| DN I DEPTH    |           |           |           |           |           |
| Group         |           |           |           |           |           |
| ence          |           |           |           |           |           |
| re            |           |           |           |           |           |
| ogy           |           |           |           |           |           |
| DN II DEPTH   |           |           |           |           |           |
| Group         |           |           |           |           |           |
| ence          |           |           |           |           |           |
| re            |           |           |           |           |           |
| ogy           |           |           |           |           |           |
| DN III DEPTH  |           |           |           |           |           |
| Group         |           |           |           |           |           |
| ence          |           |           |           |           |           |
| re            |           |           |           |           |           |
| ogy           |           |           |           |           |           |
| DN IV DEPTH   |           |           |           |           |           |
| Group         |           |           |           |           |           |
| ence          |           |           |           |           |           |
| re            |           |           |           |           |           |
| ogy           |           |           |           |           |           |
| FTNESS        |           |           |           |           |           |
| CTIVE HORIZON |           |           |           |           |           |
| LITE          |           |           |           |           |           |
| ICATION       |           |           |           |           |           |
| ERM           |           |           |           |           |           |
| ANCE RATE     |           |           |           |           |           |

CLASSIFICATION: \_\_\_\_\_ SITE LONG-TERM ACCEPTANCE RATE: \_\_\_\_\_  
 REASONED BY: \_\_\_\_\_ OTHER(S) PRESENT: \_\_\_\_\_  
 \_\_\_\_\_  
 \_\_\_\_\_  
 \_\_\_\_\_  
 \_\_\_\_\_