

# OPERATIONS PERMIT

Name: (owner) Thomas K. Jeffries  New Installation  Septic Tank  
 Property Location: SR# 1446  Repairs  Nitrification Line  
 Subdivision \_\_\_\_\_ Lot # \_\_\_\_\_  
 TAX ID# \_\_\_\_\_ Quadrant # \_\_\_\_\_  
 Contractor: Ricky Holland Registration # \_\_\_\_\_

Basement with Plumbing:  Garage:

Water Supply:  Well  Public  Community

Distance From Well: 50+ ft.

**Following are the specifications for the sewage disposal system on above captioned property.**

Type of system:  Conventional  Other \_\_\_\_\_

Size of tank: Septic Tank: 1250 gallons Pump Tank: \_\_\_\_\_ gallons

Subsurface Drainage Field No. of ditches 4 exact length of each ditch 100 ft. width of ditches 3 ft. depth of ditches 18-24 in.

French Drain: \_\_\_\_\_ Linear feet

Date: 2-11-99

PERMIT NO. 14/08

Inspected by: Thomas J. Boyce R.S.  
Environmental Health Specialist

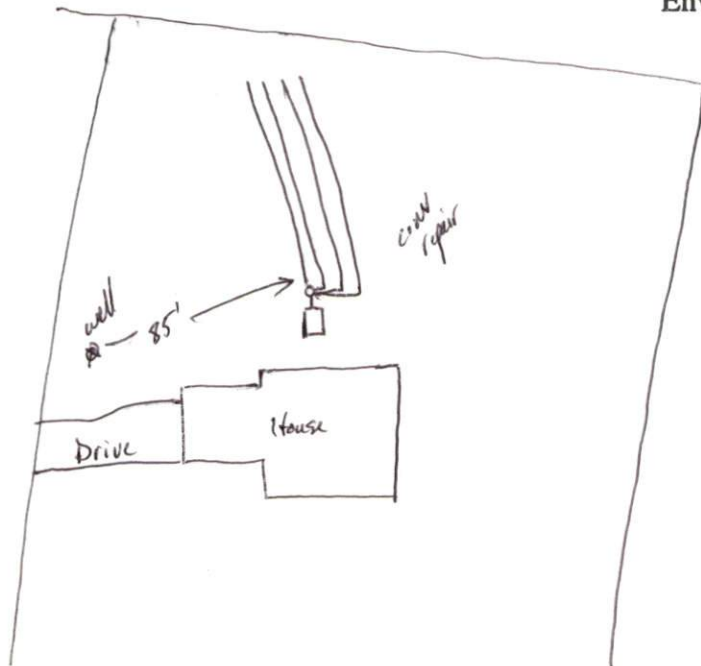

Zabel filter