

# SANITARY SEWAGE SYSTEM

OWNER: Richard K. Bullock PHONE: \_\_\_\_\_ DATE REQUESTED: \_\_\_\_\_ DATE EVALUATED: \_\_\_\_\_  
 ADDRESS: \_\_\_\_\_ PROPERTY IDENTIFICATION NO.: \_\_\_\_\_  
 COUNTY: Hartnett PROPERTY SIZE: \_\_\_\_\_ PROPOSED FACILITY: \_\_\_\_\_  
 LOCATION OF SITE: Twins Oaks Village Lot 9 SFC 1440  
 WATER SUPPLY: On-Site Well \_\_\_\_\_ Community \_\_\_\_\_ Public \_\_\_\_\_ EVALUATION BY: Auger Boring \_\_\_\_\_ PR \_\_\_\_\_

LANDSCAPE POSITION	Group	TEXTURE	App. Rate
R - Ridge	I	s - sand	1.2-0.8
S - Shoulder slope		lg - lamy sand	
L - Linear slope	II	sl - sandy loam	0.8-0.6
S - Foot slope		l - loam	
N - Nose slope	III	sl - silt	0.6-0.3
H - Head slope		sl - silt loam	
c - Concave slope		scl - silty clay loam	
v - Convex slope		cl - clay loam	
T - Terrace	IV	scl - sandy clay loam	0.4-0.1
F - Flood Plain		sc - sandy clay	
		slc - silty clay	
		c - clay	

### LEGEND

#### CONSISTENCE

- MOIST**
- vir - very friable
  - fr - friable
  - fl - firm
  - vfl - very firm
  - vf - extremely firm

- WET**
- Ns - non-sticky
  - Ss - slightly sticky
  - S - sticky
  - Vs - very sticky
  - Np - non-plastic
  - Sp - slightly plastic
  - P - plastic
  - Vp - very plastic

- STRUCTURE**
- sg - single grain
  - m - massive
  - cr - crumb
  - gr - granular
  - abk - subangular blocky
  - ab - angular blocky
  - pl - platy
  - pr - prismatic

Use the above standard abbreviations.

#### NOTES:

- NOTES:**
- Soil Wetness - inches from land surface to free water or inches from land surface to soil chroma 2 or less - record Munsell color chip designation
  - Classification - S (suitable), PS (provisionally suitable) or U (unsuitable)
  - Long-Term Acceptance Rate - gaudaym?

Soil Wetness - inches from land surface to free water or inches from land surface to soil chroma 2 or less - record Munsell color chip designation  
 Classification - S (suitable), PS (provisionally suitable) or U (unsuitable)  
 Long-Term Acceptance Rate - gaudaym?

S 2801 (Revised \_\_\_\_\_)  
 Division Branch (Review \_\_\_\_\_)

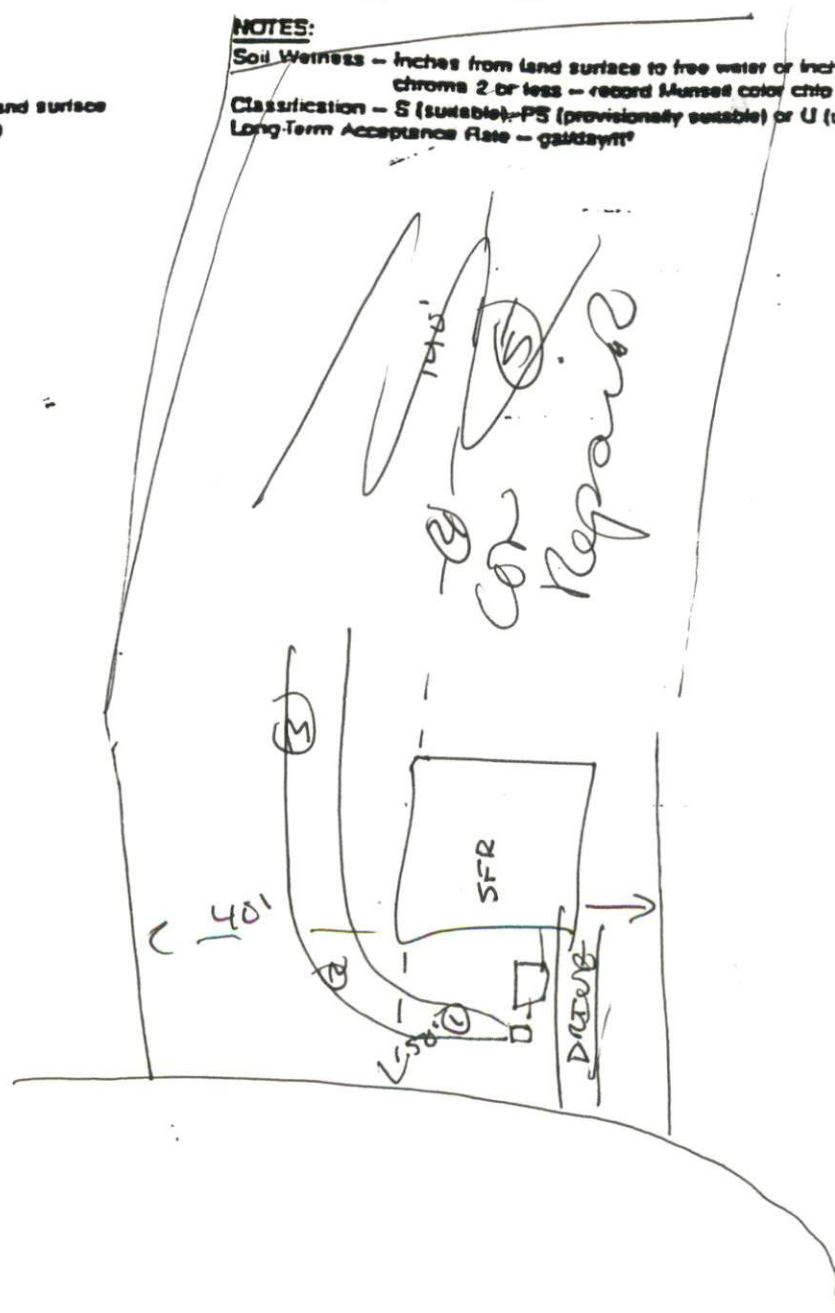

FACTORS	PROFILE 1	PROFILE 2	PROFILE 3	PROFILE 4	PROFILE 5
LANDSCAPE POSITION	L				
SLOPE (%)	0-2				
HORIZON I DEPTH	0-16				
Texture Group	SL				
Consistence	FL				
Structure	GL				
Mineralogy	181				
HORIZON II DEPTH	16- <del>20</del> 42				
Texture Group	SC				
Consistence	FL				
Structure	GL				
Mineralogy	1/1				
HORIZON III DEPTH					
Texture Group					
Consistence					
Structure					
Mineralogy					
HORIZON IV DEPTH					
Texture Group					
Consistence					
Structure					
Mineralogy					
SOIL WETNESS	36	40	40	40	40
RESTRICTIVE HORIZON					
SAPROLITE					
CLASSIFICATION					
LONG-TERM ACCEPTANCE RATE	.4	.4	.4	.4	.4

FACTORS	PROFILE 1	PROFILE 2	PROFILE 3	PROFILE 4	PROFILE 5
LANDSCAPE POSITION					
SLOPE (%)					
HORIZON I DEPTH					
Texture Group					
Consistence					
Structure					
Mineralogy					
HORIZON II DEPTH	A				
Texture Group					
Consistence					
Structure					
Mineralogy					
HORIZON III DEPTH					
Texture Group					
Consistence					
Structure					
Mineralogy					
HORIZON IV DEPTH					
Texture Group					
Consistence					
Structure					
Mineralogy					
SOIL WETNESS					
RESTRICTIVE HORIZON					
SAPROLITE					
CLASSIFICATION					
LONG-TERM ACCEPTANCE RATE	.4				

SITE CLASSIFICATION: \_\_\_\_\_

EVALUATED BY: \_\_\_\_\_

REMARKS: \_\_\_\_\_

SITE LONG-TERM ACCEPTANCE RATE: \_\_\_\_\_

OTHER(S) PRESENT: \_\_\_\_\_