

SANITARY SEWAGE SYSTEM

OWNER: Home Investments Inc PHONE: 449-5412 DATE REQUESTED: 1-7-94 DATE EVALUATED: 2-4-94
 ADDRESS: RT 2 BOX 272-B OAKBROOK PROPERTY IDENTIFICATION NO.: _____
 COUNTY: HARDETT PROPERTY SIZE: _____ PROPOSED FACILITY: 3 Bedroom
 LOCATION OF SITE: MIRIE BRANCH ESTATE Lot 27
 WATER SUPPLY: On-Site Well _____ Community _____ Public X EVALUATION BY: Auger Boring EW Pit _____ Cut _____

LANDSCAPE POSITION	Group	TEXTURE	App. Rate	LEGEND				
				MOIST	CONSISTENCE	STRUCTURE		
R - Ridge	I	s - sand	1.2-0.8	vir - very friable	WET	sg - single grain	MINER. 1:1, 2:1.	
S - Shoulder slope		lg - loamy sand		fr - friable		Ns - non-sticky		
L - Linear slope		sl - sandy loam		ff - firm		Ss - slightly sticky		
FS - Foot slope	II	l - loam	0.8-0.6	fl - firm	S - sticky	gr - granular		
N - Nose slope		sl - silt		vfl - very firm	Vs - very sticky	sbk - subangular blocky		
H - Head slope	III	sil - silt loam	0.6-0.3	efl - extremely firm	Vp - very plastic	sbk - angular blocky		
Cc - Concave slope		sicl - silty clay loam			Np - non-plastic		pl - platy	
Cv - Convex slope		cl - clay loam			Sp - slightly plastic		pr - prismatic	
T - Terrace		scl - sandy clay loam			P - plastic			
FP - Flood Plain	IV	sc - sandy clay	0.4-0.1					
		sic - silty clay						
		c - clay						

Use the above standard abbreviations.

NOTES:

- Horizon Depth - in inches
- Depth of Fill - in inches from land surface
- Restrictive Horizon - thickness and inches from land surface
- Saprolite - S (suitable) or U (unsuitable)

NOTES:

- Soil Wetness - inches from land surface to free water or inches from land surface to soil colors with chroma 2 or less - record Munsell color chip designation
- Classification - S (suitable), PS (provisionally suitable) or U (unsuitable)
- Long-Term Acceptance Rate - gal/day/ft

DHS 2501 (Revised _____)
 Sanitation Branch (Review _____)

CALCULATIONS

$$3(120) = 360 \text{ gal/day}$$

$$\frac{360 \text{ gal/day}}{6} = 60 \text{ ft}^2$$

$$200 \text{ ft} = 3 \text{ LINES } 67 \text{ ft EACH}$$

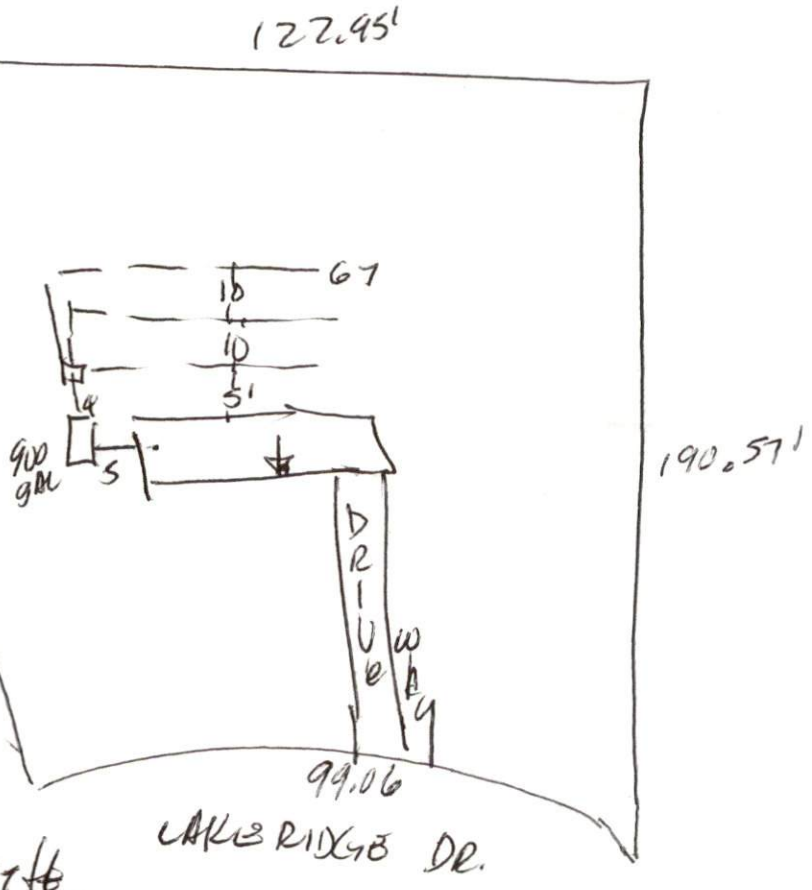

FACTORS	PROFILE 1	PROFILE 2	PROFILE 3	PROFILE 4	PROFILE 5
ESCAPE POSITION	R	R	R		
PE (%)	2%	3%	2%		
HORIZON I DEPTH	0" - 2"	0" - 2"	0" - 2"		
Texture Group	TOP SOIL	TOP SOIL	TOP SOIL		
Resistance	/	/	/		
Structure	/	/	/		
Permeability	/	/	/		
HORIZON II DEPTH	2" - 24"	2" - 28"	2" - 24"		
Texture Group	LS	LS	LS		
Resistance	EV	EV	EV		
Structure	GV	GV	GV		
Permeability	1:1	1:1	1:1		
HORIZON III DEPTH	24" - 48"	28" - 48"	24" - 48"		
Texture Group	CL	S	CL		
Resistance	EV	VFV	EV		
Structure	GV	SG	SBK		
Permeability	1:1	/	1:1		
HORIZON IV DEPTH					
Texture Group					
Resistance					
Structure					
Permeability					
REL WETNESS					
RESTRICTIVE HORIZON					
PROLITE					
CLASSIFICATION	S	S	S		
LONG-TERM ACCEPTANCE RATE	.8	.6	.6		

FACTORS	PROFILE 1	PROFILE 2	PROFILE 3	PROFILE 4	PROFILE 5
ESCAPE POSITION					
PE (%)					
HORIZON I DEPTH					
Texture Group					
Resistance					
Structure					
Permeability					
HORIZON II DEPTH					
Texture Group					
Resistance					
Structure					
Permeability					
HORIZON III DEPTH					
Texture Group					
Resistance					
Structure					
Permeability					
HORIZON IV DEPTH					
Texture Group					
Resistance					
Structure					
Permeability					
REL WETNESS					
RESTRICTIVE HORIZON					
PROLITE					
CLASSIFICATION					
LONG-TERM ACCEPTANCE RATE					

CLASSIFICATION: *S* SITE LONG-TERM ACCEPTANCE RATE: *.6*
 EVALUATED BY: *M. J. Sullivan* OTHER(S) PRESENT:
 DATE: *11/19/11* *EDMUND A. TOWERS*