

<u>LANDSCAPE POSITION</u>	<u>GROUP</u>	<u>TEXTURE</u>	<u>.1955 LTAR</u>	<u>MOIST</u>	<u>WET</u>
- RIDGE	I	S - SAND	1.2 - 0.8	VFR - VERY FRIABLE FR - FRIABLE FI - FIRM VFI - VERY FIRM EFI - EXTREMELY FIRM	NS - NON-STICKY SS - SLIGHTLY STICKY VS - VERY STICKY NP - NON-PLASTIC SP - SLIGHTLY PLASTIC P - PLASTIC VP - VERY PLASTIC
- SHOULDER SLOPE		LS - LOAMY SAND			
- LINEAR SLOPE	II	SL - SANDY LOAM	0.8 - 0.6		
- FOOT SLOPE		L - LOAM			
- NOSE SLOPE	III	SI - SILT	0.6 - 0.3		
- HEAD SLOPE		SICL - SILTY CLAY LOAM			
- CONCAVE SLOPE		CL - CLAY LOAM			
- CONVEX SLOPE		SCL - SANDY CLAY LOAM			
TERRACE	IV	SC - SANDY CLAY	0.4 - 0.1		
FLOOD FLAIN		SIC - SILTY CLAY			
		O - ORGANIC			

- STRUCTURE
- SINGLE GRAIN
 - MASSIVE
 - CRUMB
 - GRANULAR
 - SUBANGULAR BLOCKY
 - ANGULAR BLOCKY
 - FLATY
 - PRISMATIC

- MINEROLOGY
- 1:1
 - 2:1
 - MIXED

USE THE ABOVE STANDAR ABBREVIATIONS.

- NOTES:
- HORIZON DEPTH IN INCHES BELOW NATURAL SOIL SURFACE
 - DEPTH OF FILL IN INCHES FROM LAND SURFACE
 - RESTRICTIVE HORIZON— THICKNESS AND DEPTH FROM LAND SURFACE
 - SAPROLITE S (SUITABLE) OR U (UNSUITABLE)

WETNESS - INCHES FROM LAND SURFACE TO FREE WATER OR INCHES FROM LAND SURFACE TO SOIL COLORS WITH CHROMA 2 OR LESS - RECORD ALL COLOR CHIP DESIGNATION. CLASSIFICATION - S (SUITABLE), PS (PROVISIONALLY SUITABLE), OR U (UNSUITABLE)

TERM ACCEPTANCE RATE: GAL/DAY/FT²

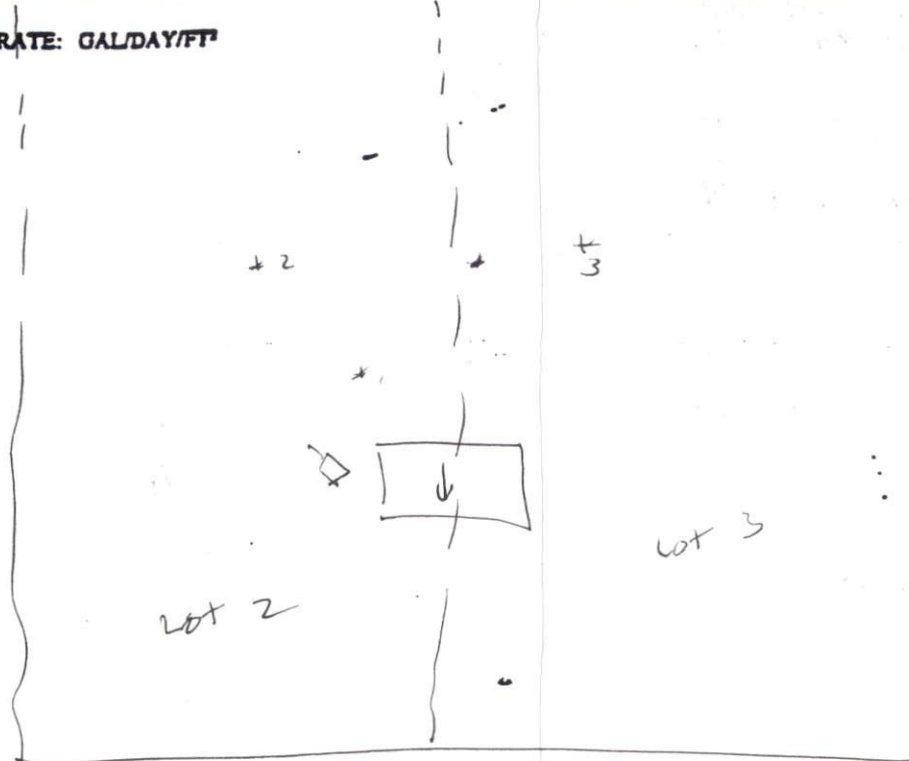

OIL/SITE EVALUATION

**FOR
ON-SITE WASTEWATER SYSTEM**

APPLICANT: DAVID EARL ELLIOT OWNER: AGENT: PHONE:
 ADDRESS: ANDERSON CREEK SCH. Rd. APPLICATION DATE: DATE EVALUATED: 3-19-95
 PROPOSED FACILITY: SFD
 PROPERTY SIZE:

LOCATION OF SITE: ANDERSON CREEK SCH. Rd
 WATER SUPPLY: On-Site Well Comm. Well Public Other EVAL. METHOD: Auger Boring Pit Cu

PROFILE #	.1940 LANDSCP POS./ SLOPE %	HORIZON DEPTH (IN.)	.1941				
			(a)(1) TEXTURE	(a)(2) STRUCTURE	(a)(3) MINEROLOGY		
1 REAR	upland 3-4%	0-24"	Group I	G		.1942 WETNESS CONDITION -	
		24-36"	Group II	SBK		.1943/1956 SAPROLITE -	
							.1944 RESTRICTIVE HORIZON -
							.1948 PROFILE CLASSIFICATION -
							PROFILE LTAR -
2		0-24"	Group I	G		.1942 WETNESS CONDITION -	
		24-36"	Group II	SBK		.1943/1956 SAPROLITE -	
							.1944 RESTRICTIVE HORIZON -
							.1948 PROFILE CLASSIFICATION -
							PROFILE LTAR -
3		0-24"	Group I	G		.1942 WETNESS CONDITION -	
		24-36"	Group II	SBK		.1943/1956 SAPROLITE -	
							.1944 RESTRICTIVE HORIZON -
							.1948 PROFILE CLASSIFICATION -
							PROFILE LTAR -
4		0-24"	Group I	G		.1942 WETNESS CONDITION -	
		24-36"	Group II	SBK		.1943/1956 SAPROLITE -	
							.1944 RESTRICTIVE HORIZON -
							.1948 PROFILE CLASSIFICATION -
							PROFILE LTAR -
5 FRONT OF LOT	3-4%	0-20"	Group I	G		.1942 WETNESS CONDITION <u>Low Chroma colour @ 28" +</u>	
		20-36"	Group II	SBK		.1943/1956 SAPROLITE -	
							.1944 RESTRICTIVE HORIZON -
							.1948 PROFILE CLASSIFICATION -
							PROFILE LTAR -

AVAILABLE SPACE (.1945) SITE CLASSIFICATION (.1948): SITE LONG-TERM ACCEPTANCE RATE:
 OTHER FACTORS (.1948) SYSTEM TYPE
 EVALUATED BY: Vincent J. Manz OTHER(S) PRESENT:
 COMMENTS: Soil borings in REAR wet to very wet below 30"
checked AREA in FRONT mottles < 2 encountered at 28"

LEGEND

<u>LANDSCAPE POSITION</u>	<u>GROUP</u>	<u>TEXTURE</u>	<u>.1955 LTAR</u>	<u>MOIST</u>	<u>WET</u>
R - RIDGE	I	S - SAND	1.2 - 0.8	VFR - VERY FRIABLE FR - FRIABLE FI - FIRM VFI - VERY FIRM EFI - EXTREMELY FIRM	NS - NON-STICKY SS - SLIGHTLY STIC S - STICKY VS - VERY STICKY NP - NON-PLASTIC SP - SLIGHTLY STIC P - PLASTIC VP - VERY PLASTIC
S - SHOULDER SLOPE		LS - LOAMY SAND			
L - LINEAR SLOPE	II	SL - SANDY LOAM	0.8 - 0.6		
FS - FOOT SLOPE		L - LOAM			
N - NOSE SLOPE	III	SI - SILT	0.6 - 0.3		
H - HEAD SLOPE		SICL - SILTY CLAY LOAM			
CC - CONCAVE SLOPE		CL - CLAY LOAM			
CV - CONVEX SLOPE		SCL - SANDY CLAY LOAM			
T - TERRACE	IV	SC - SANDY CLAY	0.4 - 0.1		
P - FLOOD FLAIN		SIC - SILTY CLAY			
		O - ORGANIC			

<u>STRUCTURE</u>	<u>MINEROLOGY</u>
G - SINGLE GRAIN	1:1
M - MASSIVE	
R - CRUMB	2:1
R - GRANULAR	
K - SUBANGULAR BLOCKY	MIXED
AK - ANGULAR BLOCKY	
L - PLATY	
R - PRISMATIC	

USE THE ABOVE STANDAR ABBREVIATIONS.

NOTES:

HORIZON DEPTH IN INCHES BELOW NATURAL SOIL SURFACE
 DEPTH OF FILL IN INCHES FROM LAND SUFAC
 RESTRICTIVE HORIZON— THICKNESS AND DEPTH FROM LAND SURFACE
 SAPROLITE S (SUITABLE) OR U (UNSUITABLE)

TESTS:

1. WETNESS - INCHES FROM LAND SURFACE TO FREE WATER OR INCHES FROM LAND SURFACE TO SOIL COLORS WITH CHROMA 2 OR LESS - RECORD INSELL COLOR CHIP DESIGNATION. CLASSIFICATION - S (SUITABLE), PS (PROVISIONALLY SUITABLE), OR U (UNSUITABLE)

2. LONG-TERM ACCEPTANCE RATE: GAL/DAY/FT

Area in rear where applicant desires system gets wetter as you go back. Soils are V. Moist to wet at 24" + & V. Wet to saturated below 30"

No Rain Fall in past 10 days, have concerns due in fact soils are Group I & Group II AND give appearance to be well-drained. Any permit issue on this lot may require a French drain. Refer back to Health Dept.

Wgm.