

# IMPROVEMENT PERMIT

Be it ordained by the Harnett County Board of Health as follows: Section III, Item B. "No Person shall begin construction of any building at which a septic tank system is to be used for disposal of sewage without first obtaining a written permit from the Harnett County Health Department."

Name: (owner) L B Hayes  New Installation  Septic Tank  
Property Location: SR# 1111  Repairs  Nitrification Line

Subdivision Sweet Briar Lot # 126

Tax ID # \_\_\_\_\_ Quadrant # \_\_\_\_\_

Number of Bedrooms Proposed: 3 Lot Size: 100 x 215 x 100 x 215

Basement with Plumbing:  Garage:

Water Supply:  Well  Public  Community

Distance From Well: 50 min ft.

Following is the minimum specifications for sewage disposal system on above captioned property. Subject to final approval.

Type of system:  Conventional  Other \_\_\_\_\_

Size of tank: Septic Tank: 1000 gallons Pump Tank: \_\_\_\_\_ gallons

Subsurface No. of exact length width of depth of  
Drainage Field ditches 3 of each ditch 70 ft. ditches 3 ft. ditches 18-24 in.

French Drain Required: \_\_\_\_\_ Linear feet

Date: 12-3-98

This permit is subject to revocation if site plans or intended use change.

Signed: [Signature]  
Environmental Health Specialist

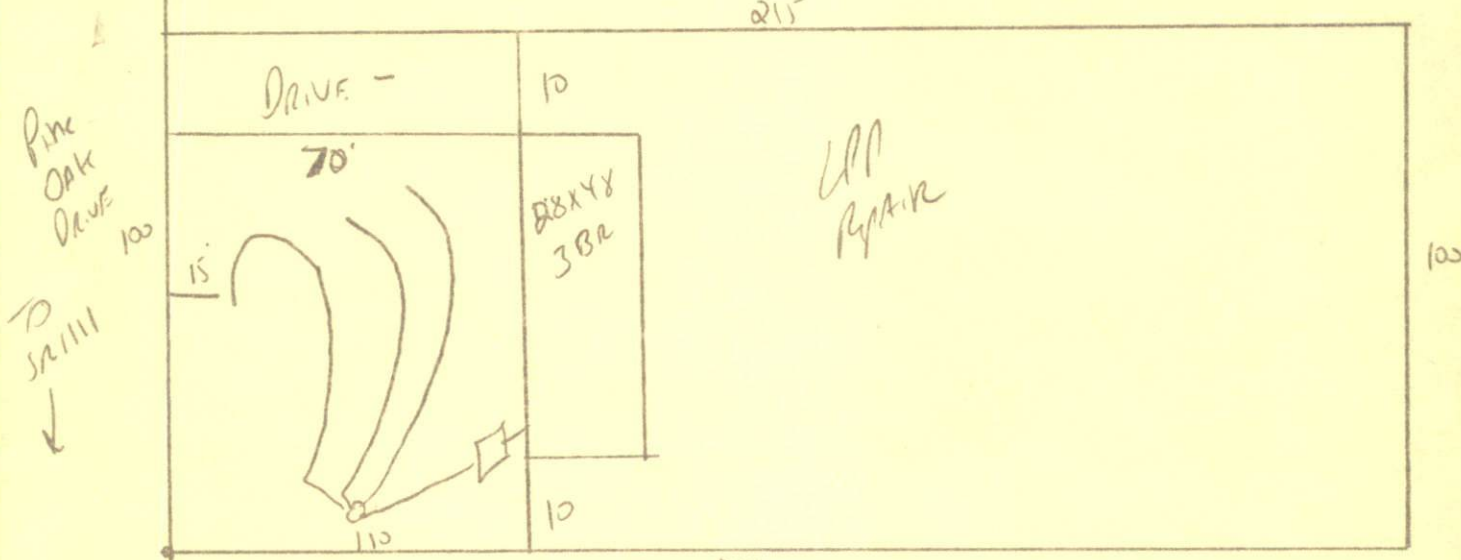

STUB out Plumbing shallow 18-24" Atk Dpths  
Maintain All Required setbacks Do not Drive or  
Park on Septic SYSTEM

HARNETT COUNTY HEALTH DEPARTMENT  
AUTHORIZATION TO CONSTRUCT

Authorization is hereby given to construct a wastewater system to the specifications described by Harnett County Health Department Improvement Permit # 15268. This authorization shall be valid for a period not to exceed five (5) years from the date of issuance. This authorization will be invalid if ownership, site plans, or intended use change.

Owner or Authorized Agent L.B. Hayes

Name: \_\_\_\_\_ Telephone # 625-5233

Address: \_\_\_\_\_

Property Location: SR # 1111 Road Name Marks Rd

New Installation  Repair \_\_\_\_\_ Septic Tank  Nitrification Lines

Subdivision Street Bann Est. Lot # \_\_\_\_\_

Number of Bedrooms Proposed: 3 Lot size: 100x215x100x211

Basement \_\_\_\_\_ With Plumbing \_\_\_\_\_ Without Plumbing \_\_\_\_\_

Water Supply: Well \_\_\_\_\_ Public  Minimum Well Setback: 50 ft.

Type of System: Conventional  Other \_\_\_\_\_

Tank Volume: Septic Tank 1000 gallons Pump Chamber \_\_\_\_\_ gallons

Nitrification Field Specifications

Number of fields 1 Number of Lines per Field 3 Length of lines 70

Width of ditches 3 ft. Depth of ditches 18-24 inches

French Drain: Linear feet required \_\_\_\_\_ Depth of gravel \_\_\_\_\_

No wastewater system shall be covered or placed into use by any person until an inspection by the Harnett County Health Department has determined that the system has been installed according to the conditions of the improvement permit and that a valid operations permit has been issued.

Authorized Agent for Harnett County Health Department

Name: [Signature] Date: 12-3-98