

IN.. ROVEMENT PERMI.

Be it ordained by the Harnett County Board of Health as follows: Section III, Item B. "No Person shall begin construction of any building at which a septic tank system is to be used for disposal of sewage without first obtaining a written permit from the Harnett County Health Department."

Name: (owner) Mike Ebers New Installation Septic Tank
 Property Location: SR# off 1111 Repairs Nitrification Line

Subdivision Seven Oaks Lot # 10

Tax ID # _____ Quadrant # _____

Number of Bedrooms Proposed: THREE Lot Size: _____

Basement with Plumbing: Garage:

Water Supply: Well Public Community

Distance From Well: 50 ft.

Following is the minimum specifications for sewage disposal system on above captioned property. Subject to final approval.

Type of system: Conventional Other _____

Size of tank: Septic Tank: 1000 gallons Pump Tank: _____ gallons

Subsurface Drainage Field No. of ditches 1 exact length of each ditch 180 ft. width of ditches 3 ft. depth of ditches 18-24 in.

French Drain Required: _____ Linear feet

Date: 16 Nov 98

Signed: Vernon D. [Signature]
 Environmental Health Specialist

This permit is subject to revocation if site plans or intended use change.

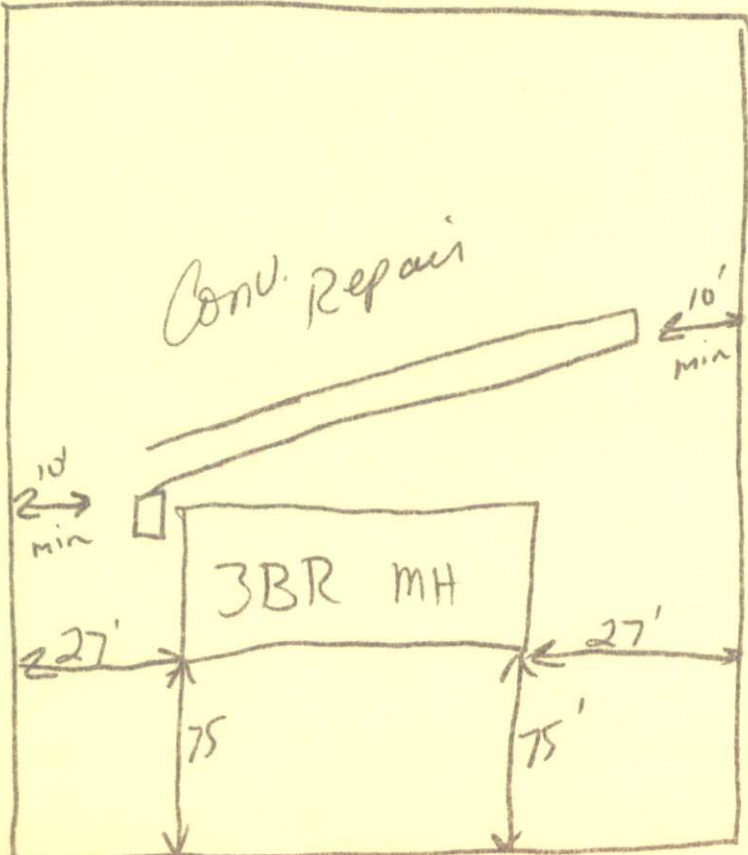

HARNETT COUNTY HEALTH DEPARTMENT
AUTHORIZATION TO CONSTRUCT

Authorization is hereby given to construct a wastewater system to the specifications described by Harnett County Health Department Improvement Permit # 14573. This authorization shall be valid for a period not to exceed five (5) years from the date of issuance. This authorization will be invalid if ownership, site plans, or intended use change.

Owner or Authorized Agent _____

Name: Mike Cahers Telephone # 8224540

Address: PO Box 9321 Fay, NC

Property Location: SR # off 1111 Road Name off Marks Rd

New Installation Repair Septic Tank Nitrification Lines

Subdivision Seven Oaks Lot # 10

Number of Bedrooms Proposed: THREE Lot size: _____

Basement With Plumbing Without Plumbing

Water Supply: Well Public Minimum Well Setback: 50 ft.

Type of System: Conventional Other

Tank Volume: Septic Tank 1000 gallons Pump Chamber _____ gallons

Nitrification Field Specifications

Number of fields 1 Number of Lines per Field 1 Length of lines 180 feet

Width of ditches 3 ft. Depth of ditches 18-24 inches

French Drain: Linear feet required _____ Depth of gravel _____

No wastewater system shall be covered or placed into use by any person until an inspection by the Harnett County Health Department has determined that the system has been installed according to the conditions of the improvement permit and that a valid operations permit has been issued.

Authorized Agent for Harnett County Health Department

Name: Vernant Doff Date: 16 Nov 95