

SITE/SOIL EVALUATION FOR ON-SITE TREATMENT

DATE _____

APPLICANT NAME _____

FACTORS		PROFILES								
		1	2	3	4	5	6	7	8	9
LANDSCAPE POSITION	.1940									
SLOPE (%)	.1940									
HORIZON 1 DEPTH		G-30	G-20							
Texture Group	.1941(A)(1)	LS	S							
Consistence	.1941	Vfr	Vfr							
Structure	.1941(A)(2)	G	G							
Mineralogy	.1941(A)(3)	Wcl	Wcl							
HORIZON 2 DEPTH		30-70	28-30							
Texture Group	.1941(A)(1)	SL	SL							
Consistence	.1941	Vfr	Vfr							
Structure	.1941(A)(2)	G	G							
Mineralogy	.1941(A)(3)	Wcl	Wcl							
HORIZON 3 DEPTH										
Texture Group	.1941(A)(1)									
Consistence	.1941									
Structure	.1941(A)(2)									
Mineralogy	.1941(A)(3)									
HORIZON 4 DEPTH										
Texture Group	.1941(A)(1)									
Consistence	.1941									
Structure	.1941(A)(2)									
Mineralogy	.1941(A)(3)									
SOIL WETNESS	.1942									
RESTRICTIVE HORIZON	.1944									
SAPROLITE	.1943/.1956									
CLASSIFICATION	.1948	S	S							
LONG TERM ACCEPTANCE RATE	.1955	0.8	0.8							

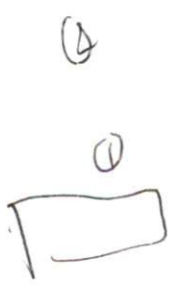

Southeastern Soil & Environmental Associates, Inc.

P.O. Box 9321
Fayetteville, NC 28311-7696
Phone/Fax (910) 822-4540

SEVEN OAKS

LOT 19

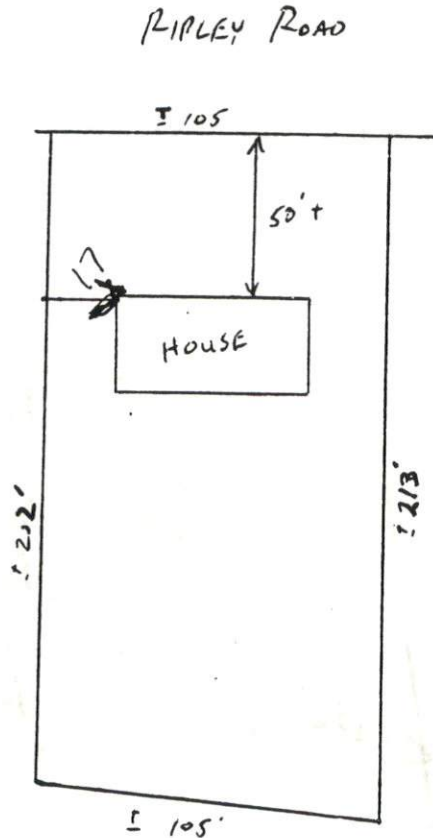

SITE PLAN APPROVAL

DISTRICT NPA USE DRMHT

#BEDROOMS 3

Date 6-11-98 [Signature]
Zoning Administrator

ADDRESS:

201 RIPLEY ROAD
CAMERON, NC 28326

1" = 60'

