



COUNTY OF HARNETT

EH

Fee 20
Revised
11118861
Date: 6-20-98

APPLICATION FOR ENVIRONMENTAL HEALTH IMPROVEMENT PERMIT

PROPERTY DESCRIPTION/LAND USE PERMIT

LANDOWNER INFORMATION:

NAME MAK Development Co. LLC.
ADDRESS 72 Overlook Ct.
Asheville, NC 27501
PHONE 639-7424 W 639-7424 H

APPLICANT INFORMATION:

NAME _____
ADDRESS _____
PHONE _____ W _____ H _____

ORIGINAL

PROPERTY LOCATION:

Street Address Assigned 07-0680-0021
or NC27 RD. NAME NC27 TOWNSHIP 07 FIRE _____ RESIDE _____
TAX MAP NO. 68053 PARCEL NO. 436 FLOOD PLAIN X PANEL 105
SUBDIVISION Arbor Crest LOT # 28 LOT/TRACT SIZE .7258
ZONING DISTRICT RA-30 DEED BOOK 1751 PAGE 612
WATER DIST. H WATER DIST. _____ PLAT BOOK NOT PAGE RECORDED

Give Directions to the Property from Lillington: Hwy. 421 toward Erwin turn left on Hwy. 27 approx. 2 miles on right. Look for Arbor Crest sign.

- Proposed Use**
 2g Family Dwelling (Size 40 x 40) # of Bedrooms 3 Basement _____
 Garage _____ Deck _____
 Multi-Family Dwelling No. Units _____ (size 10 x 10)
 Manufactured Home (Size _____ x _____) No. Bedrooms/unit _____
 Deck _____ (size _____ x _____) # of Bedrooms _____ Garage _____
 Number of persons per household _____
 Business Soft Retail Space _____ Type _____
 Industry Soft _____ Type _____
 Home Occupation No. Rooms/size _____ Type _____
 Accessory Bldg. Size _____ Use _____
 Addition to Existing Bldg. Size _____ Use _____
 Sign Size _____ Type _____ Use _____
 Other _____ Type _____ Location _____

Water Supply: County Well (No. dwellings _____) Other
Sewer: Septic Tank (Existing? No) County Other
Erosion & Sedimentation Control Plan Required? Yes No _____
Are there any wells not on this lot but within 40 ft of the property line (show on Site Plan).

NOTE: A Site Plan must be attached to this Application, drawn to scale on an 8.5 by 11 sheet, showing: existing and proposed buildings, garages, driveways, decks, accessory buildings, well, and any wells within 40 feet of your property line.

Conf# 349
6-22-98

FORMERLY NCSR # 1006
N.C. HWY 27

367.2' + - TO INT OF
NC 27 & NCSR # 2002

0.71 ACRES

34

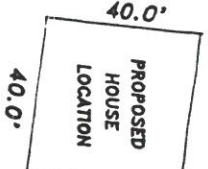

ARBOR CREST LANE 50' R/W

0.58 ACRES

2

3

140.55'

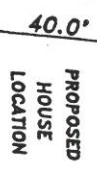

SITE PLAN APPROVAL
DISTRICT 21A-30 USE SPD
#BEDROOMS 3

6-22-18

[Signature]
Zoning Administrator

223.28'

146.46'

35

88.48'

129.95'

35

46.0'

40.0'

35

46.0'

40.0'

R=434.59'
A=94.19'

88.48'

R=484.59'
A=50.14'

140° 142.70'

53.45'

73.28'

R=25.00'
A=44.51'

1

4

7

8

9

10

11

12

13

14

15

FORMERLY NCSR # 1006

N.C. HWY 27

367.2' + - TO INT OF NC 27 & NCSR # 2002

1

0.71 ACRES

34

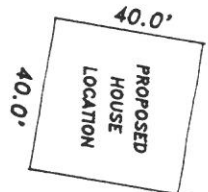

ARBOR CREST LANE

50' R/W

2

0.58 ACRES

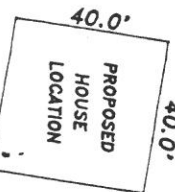

180.00'

3

33

SITE PLAN APPROVAL

DISTRICT 21A-30 USE SPD

BEDROOMS 3

6-22-18 [Signature]

Zoning Administrator

223.28'

146.46'

73.28'

R=25.00'
A=44.31'

53.45'

R=434.59'
A=94.19'

45.0'

75.0'

88.48'

142.70'

R=484.59'
A=50.14'

45.0'

70.0'

129.95'

140.55'