

# IMPROVEMENT PERMIT

Be it ordained by the Harnett County Board of Health as follows: Section III, Item B. "No Person shall begin construction of any building at which a septic tank system is to be used for disposal of sewage without first obtaining a written permit from the Harnett County Health Department."

Name: (owner) Terri Cieri  New Installation  Septic Tank  
Property Location: SR# NC 24/27  Repairs  Nitrification Line

Subdivision Sherwood Forest Lot # 31

Tax ID # \_\_\_\_\_ Quadrant # \_\_\_\_\_

Number of Bedrooms Proposed: 3 Lot Size: 100 x 200

Basement with Plumbing:  Garage:

Water Supply:  Well  Public  Community

Distance From Well: 50 min ft.

Following is the minimum specifications for sewage disposal system on above captioned property. Subject to final approval.

Type of system:  Conventional  Other \_\_\_\_\_

Size of tank: Septic Tank: 1000 gallons Pump Tank: \_\_\_\_\_ gallons

Subsurface Drainage Field No. of ditches 1 exact length of each ditch 200 ft. width of ditches 3 ft. depth of ditches 18-24 in.

French Drain Required: \_\_\_\_\_ Linear feet

Date: 3-3-98

This permit is subject to revocation if site plans or intended use change.

Signed: J. W. ARS  
Environmental Health Specialist

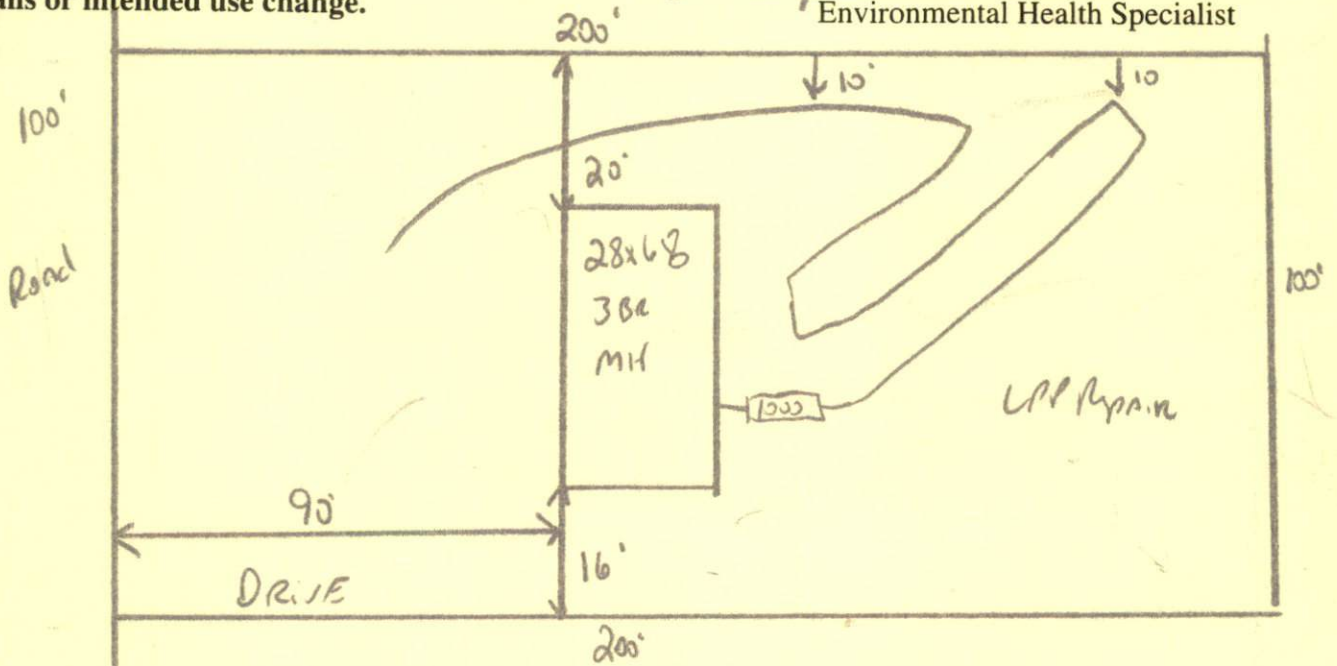

Meet onsite Before Installing STUB out Plumbing shallow 18-24" Ditch Depth Follow contours MAINTAIN ALL Required Set Backs

HARNETT COUNTY HEALTH DEPARTMENT  
AUTHORIZATION TO CONSTRUCT

Authorization is hereby given to construct a wastewater system to the specifications described by Harnett County Health Department Improvement Permit # 14059. This authorization shall be valid for a period not to exceed five (5) years from the date of issuance. This authorization will be invalid if ownership, site plans, or intended use change.

Owner or Authorized Agent Terri Cicci

Name: \_\_\_\_\_ Telephone # \_\_\_\_\_

Address: \_\_\_\_\_

Property Location: SR # NC 24/27 Road Name \_\_\_\_\_

New Installation  Repair \_\_\_\_\_ Septic Tank  Nitrification Lines

Subdivision Sherwood Forest Lot # 31

Number of Bedrooms Proposed: 3 Lot size: 100x200

Basement \_\_\_\_\_ With Plumbing \_\_\_\_\_ Without Plumbing \_\_\_\_\_

Water Supply: Well \_\_\_\_\_ Public  Minimum Well Setback: 50' ft.

Type of System: Conventional  Other \_\_\_\_\_

Tank Volume: Septic Tank 1000 gallons Pump Chamber \_\_\_\_\_ gallons

Nitrification Field Specifications

Number of fields 1 Number of Lines per Field 1 Length of lines 200

Width of ditches 3 ft. Depth of ditches 18-24 inches

French Drain: Linear feet required \_\_\_\_\_ Depth of gravel \_\_\_\_\_

No wastewater system shall be covered or placed into use by any person until an inspection by the Harnett County Health Department has determined that the system has been installed according to the conditions of the improvement permit and that a valid operations permit has been issued.

Authorized Agent for Harnett County Health Department

Name: [Signature] Date: 2-3-98